

Quick Start Guide

- A** Connect to WACS7000
- B** Connect to WAK3300
- C** Enjoy



What's in the box



Wireless Range Extender

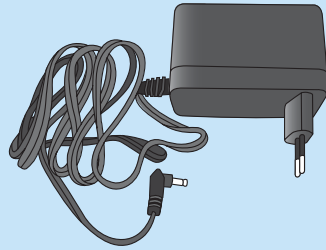

Power Adapter



Antenna



Quick Start Guide

Supported Philips Wireless Music Center/Station



WACS7000



WAK3300

Connect to WACS7000

Connect WARI900 to WACS7000

1

Place the **Center**, **Station(s)** and **Extender** side by side on a flat and firm surface

2

Connect the **Center** and **Station(s)** to power supply
→ HD screen appears on the Station when the Station is connected to the Center

3

Mount on the antenna and then connect the **Extender** to power supply.
→ When the Extender is ready for connection, both **Power** and **Wireless** indicators light up in blue (it takes 10-15 seconds),

IMPORTANT!

- Make sure the selector is set at **AP** position.

4

On the **Center**, press and hold **SAME ARTIST** until the display shows “OK for Extender...”

5

On the **Station(s)**, press and hold **SAME ARTIST** until the display shows “OK for Extender...”
→ Connecting via the **Extender** starts (please ignore the screen message “Center temporarily not available”)
→ **HD** screen appears on the **Station** when the Station is connected to the **Center** via the **Extender**

Note:

- The **SAME ARTIST** button on the 2-way remote control that comes with WACS7000 doesn't have this function

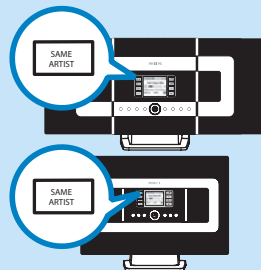
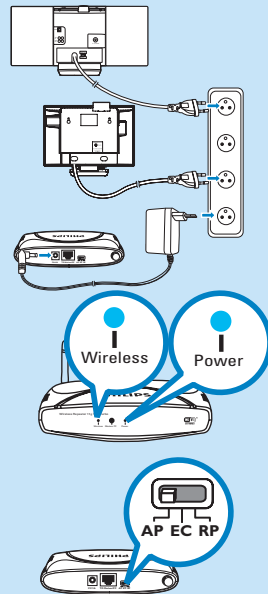

Relocate

1

Unplug the **Center**, **Station(s)** and the **Extender**

2

Place the **Extender**, **Center** and **Station(s)** as shown at the right side:

a. For Center and one Station

b. For Center and more than one Station

In this case, the maximum distance between the Extender and Center/Station is about 50m, depending on the actual environment in your house.

3

Connect the **Extender** to power supply

→ **Wireless** indicator lights up blue when the **Extender** is ready for connection

4

Connect the **Center** and **Station(s)** to power supply, first the **Center** and then the **Station(s)**

→ **HD** screen appears on the **Station** when the Station has connected the **Center**



– indicates maximum reception



– indicates minimum reception

Tips!

- Adjust the distance between the **Extender** and the **Center/Station(s)** according to the Wi-Fi reception status

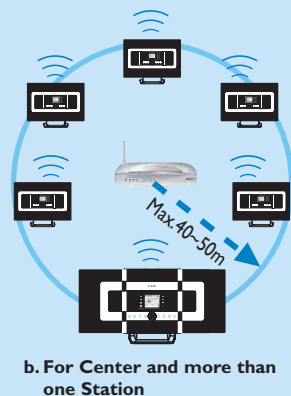
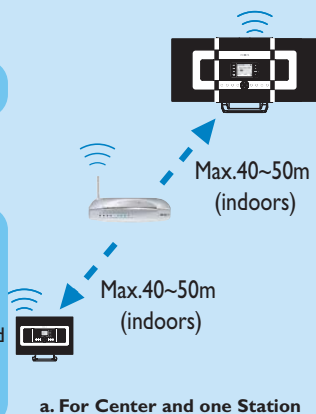

Connect to WAK3300

Connect WAK3300 to WAC7000

1

Place WAK3300 side by side with the WAK3300 and its connected device WAC7000 on a flat and firm surface

2

Mount on the antenna and then connect the WAK3300 to power supply

→ Both Power and Wireless indicators light up blue (takes 10-15 seconds), when Extender is ready for connection

IMPORTANT!

- Make sure the selector is set at **AP** position.

3

On WAC7000, press and hold **SAME ARTIST** until the display shows "OK for Extender..."

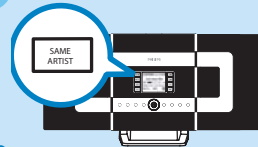
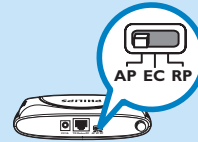
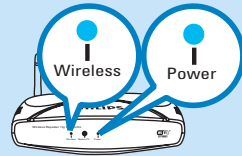
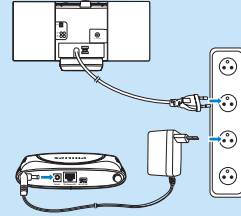

Connecting WAK3300 to WAC7000

1

Place the WAK3300 beside the WAC7000

2

Connect the WAK3300's power cord to a wall outlet

3

Press the navigation controls ▲ or ▼ and ► to set language and clock, then select "Philips Music Center"

4

Check that the WAC7000 is switched on and is already in the HD mode

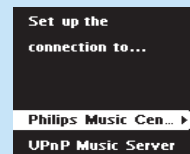
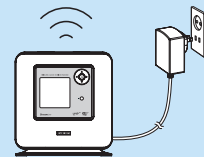

Connect to WAK3300

5

On WAC7000

- Press **MENU** to enter the menu screen
- Press the navigation controls ▲ or ▼ and ► to enter Station Mgmt menu
- Press ▲ or ▼ and ► to select **Add New Station**
→ You will enter Installation Mode. Searching for the new station starts

On WAK3300

- Press **HOME** to enter the main menu, and then select the **Settings** menu by pressing the navigation controls ▲ or ▼ and ►
- Use the navigation controls ▲ or ▼ and ► to select **Network** followed by **Quick Setup**
→ The Select Network screen appears
- Select "Philips Music Center"



6

On WAC7000, press STOP ■ after all the Stations are found

Relocate

1

Unplug the WAR1900, the WAK3300 and its connected device WAC7000

2

Place your Extender, WAK3300 and WAC7000 as shown

3

Connect WAR1900 to power supply
→ Wireless indicator lights up blue when it is ready for connection

4

Connect WAK3300 and WAC7000 to power supply

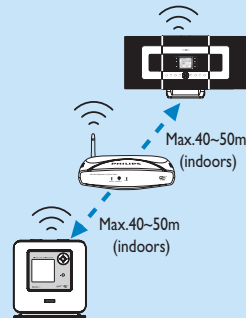



Enjoy

Enjoy wireless freedom

The Extender allows you to stream music from Center to Station(s) within a longer distance. With the connected Wi-Fi extender in between, you can effectively increase the distance between Center and Station from the max. 30m to about 100m (depending on the actual environment in your house).

Enjoy the freedom of the wireless networking.

For information on how to operate your Center and or Station(s), please refer to their user manual.

Reset

In case there is problem in setting up connection between WAR1900 and WACS7000 or WAK3300, press **RESET** button for at least 5 seconds to reset the extender to its factory default settings



Default Settings

Password	
Default password	No password
Network Setting	
AP IP address	192.168.1.3
DHCP Server	Enabled
Wireless	
Wireless	Enabled
SSID	PHILIPS-EXTENDER
Channel	6
Extend Range	Enabled
Wireless Security	
Security	Enabled
WEP mode	128 bits
Key Entry method	HEX
WEP	5048494C495053313233358595A
Router Information	
Current Mode	Access Point



Enjoy

Frequently Asked Questions

Q: Why can't I see the message "Ok for Extender ..."

A: Please check if the Extender is set at "AP" mode.

Q: How do I know if the Extender is working?

A: You may check the connection by pressing Menu > Information > Wireless > SSID.

Q: Why it's still hard to create connection between my Center and Station(s) after used the Extender?

A: Please adjust the distance between the Extender and the Center/Station(s) (refer to "Relocate" step 2)

Important safety information

- Please install and connect the product in the order as described in the 'Quick Start Guide' booklet only. This assures best installation results with the least technical hassles.
- Please read the 'Quick Start Guide' booklet carefully before using the Wireless Range Extender (WAR1900); and keep these documents for future reference.
- The most recent downloads and information on this product will be available through our web site www.philips.com/support

Safety Precautions

- Radio equipment for wireless applications is not protected against disturbance from other radio services.
- Do not expose the system to excessive moisture, rain, sand or heat sources.
- The product should not be exposed to dripping or splashing. No object filled with liquids, such as vases, should be placed on the product.
- Keep the product away from domestic heating equipment and direct sunlight
- Allow a sufficient amount of free space all around the product for adequate ventilation.
- Do not open this product. Contact your Philips retailer if you experience technical difficulties.

Environmental information

All redundant packing material has been omitted. We have done our utmost to make the packaging easily separable into two mono materials: cardboard (box) and polyethylene (bags, protective foam sheet). Your set consists of materials that can be recycled if disassembled by a specialized company. Please observe the local regulations regarding the disposal of packing materials and old equipment.

Disposal of your old product

Your product is designed and manufactured with high quality materials and components, which can be recycled and reused.



When this crossed-out wheeled bin symbol is attached to a product it means the product is covered by the European Directive 2002/96/EC

Please inform yourself about the local separate collection system for electrical and electronic products.

Please act according to your local rules and do not dispose of your old products with your normal household waste. The correct disposal of your old product will help prevent potential negative consequences for the environment and human health.

Disclaimer

This product is provided by 'Philips' 'as is' and without any express or implied warranty of any kind of warranties, including, but not limited to, the implied warranties of merchantability and fitness for a particular purpose are disclaimed.

In no event shall Philips be liable for any direct, indirect, incidental, special, exemplary, or consequential damages (including, but not limited to, procurement of substitute goods or services; loss of information, data, or profits; or business interruption) howsoever caused and on any theory of liability, whether in contract, strict liability, or tort (including negligence or otherwise) arising in any way out of the use of inability to use this product, even if advised of the possibility of such damages.

Philips further does not warrant the accuracy or completeness of the information, text, graphics, links or other items transmitted by this product.

Need help?

Country	Helpdesk	Tariff / min	Keep ready
österreich	0820 901115	€0.20	Das Kaufdatum, Modellnummer und Seriennummer
Belgique	070 253 010	€0.17	La date d'achat la référence et le numéro de série du produit
Canada	1-800-661-6162 (Francophone) 1-888-744-5477 (English / Spanish)	Free	Date of Purchase, Model number and Serial number
Danmark	3525 8761	Local tariff	Forbrugeren's indkøbsdato, type/model-og serienummer
Suomi	09 2290 1908	Local tariff	Ostopäivä ja tarkka mallinnumero ja sarjanumero
France	08 9165 0006	€0.23	La date d'achat la référence et le numéro de série du produit
Deutschland	0180 5 007 532	€0.20	Das Kaufdatum, Modellnummer und Serial nummer
Ελλάδα	0 0800 3122 1223	Free	Την ημερομηνία αγοράς και Τον ακριβή κωδικό μοντέλου και Τον αριθμό σειράς του προϊόντος σας
Ireland	01 601 1161	Local tariff	Date of Purchase, Model number and Serial number
Italia	199 404 042	€0.21	La data di acquisto, numero di modello e numero di serie
Luxembourg	26 84 30 00	Local tariff	La data d'achat, la référence et le numéro de série du produit
Nederland	0900 0400 063	€0.20	De datum van aankoop, modelnummer en serienummer
Norge	2270 8250	Local tariff	Datoen da du kjøpte produktet & modellnummer & serienummeret
Portugal	2 1359 1440	Local tariff	A data de compra, número do modelo e número de série
España	902 888 785	€0.15	Fecha de compra e número del modelo e número de serie
Sweden	08 632 0016	Local tariff	Inköpsdatum, modellnummer och serienummer
Schweiz	02 2310 2116		Das Kaufdatum und Modellnummer und Seriennummer
UK	0906 1010 017	£0.15	Date of Purchase, Model number and Serial number
USA	1-888-744-5477	Free	Date of Purchase, Model number and Serial number



Be responsible
Respect copyrights



© Royal Philips Electronics N.V. 2006
All rights reserved.

Eng

www.philips.com