

EN Instructions

1. Slide stem into base
2. Slip antenna into top of stem and connect coax cable
3. Connect the coaxial cable from the antenna to your TV's coax connector input

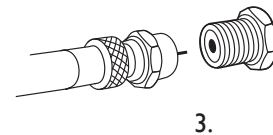
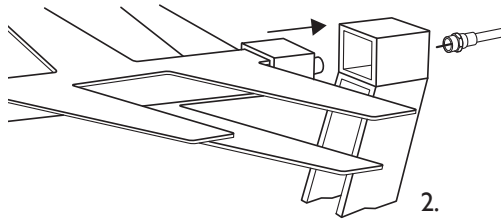
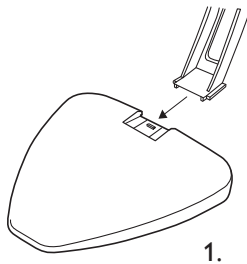

ES Instrucciones

1. Deslice el vástago dentro de la base.
2. Inserte suavemente la antena por la parte superior del vástago y conecte el cable coaxial.
3. Conecte el cable coaxial de la antena a la entrada para conector coaxial de la TV.

Need help setting up your antenna?
Call our customer support help line: 919-573-7854