

# PHILIPS

Ultinon drive  
LED lightbar



UD5001LXI 10 inch LED lightbar

UD5002LXI 20 inch LED lightbar

UD5004LXI 30 inch LED lightbar

UD5050LXI 10 inch boost LED lightbar

UD5003LXI 20 inch dual-row LED lightbar



## User manual



The Philips LED Lightbar bears the official Philips Automotive Grade Quality seal. Philips Automotive Grade Quality products are designed and developed following strict quality-control processes (including applicable ISO norms), leading to consistently high production standards.

## **Important**

**Please read this user guide carefully before using your LED Lightbar. This guide contains important health and safety information.**

If you need further assistance, please visit our website:

**[www.philips.com/support](http://www.philips.com/support)**

Or visit your local Philips Dealer

**For more information visit**

**<https://www.philips.com/Ultinon-Drive-5000>**

1



UD5001LX1;UD5002LX1;UD5004LX1



UD5003LX1

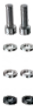

UD5050LX1



2

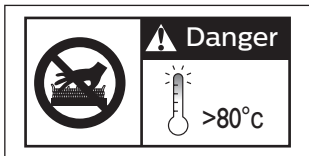
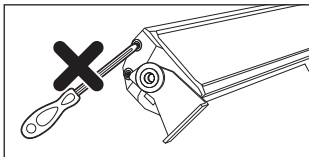
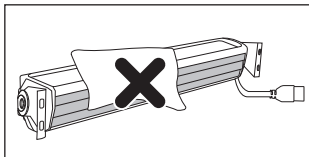
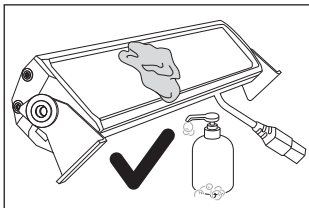
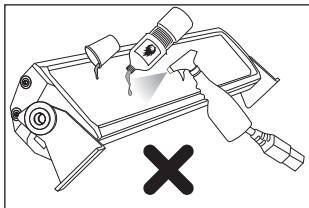
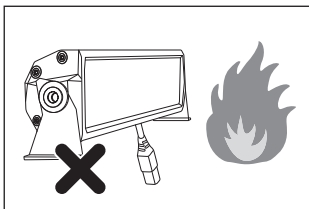
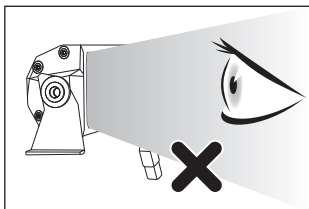

**3****i**



## UD5003LX1; UD5050LX1

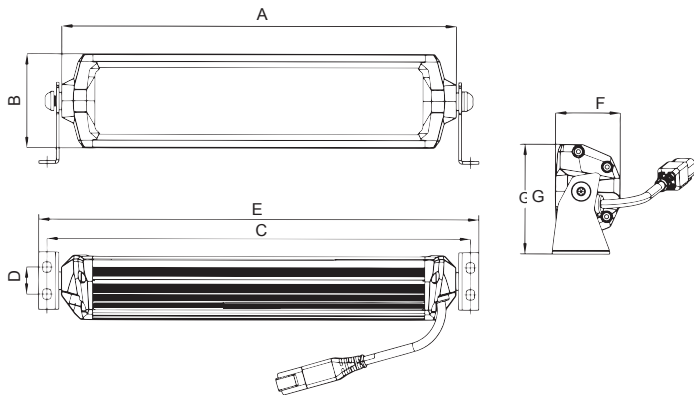

Type	A-mm	B-mm	C-mm	D-mm	E-mm	F-mm	G-mm
UD5050LX1	304±2	72±2	326±3	21±2	339±3	49±2	84±2
UD5003LX1	558±2	72±2	580±3	21±2	593±3	49±2	84±2



UD5001LX1; UD5002LX1; UD5004LX1

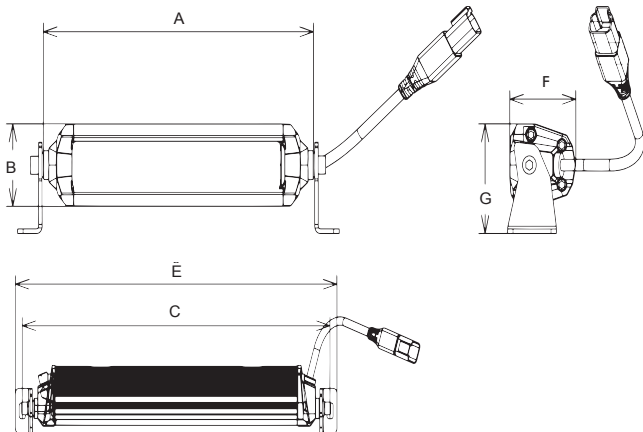

Type	A-mm	B-mm	C-mm	E-mm	F-mm	G-mm
UD5001LX1	304±2	46±2	325±3	339±3	49±2	61±2
UD5002LX1	558±3	46±2	579±3	593±3	49±2	61±2
UD5004LX1	811±3	46±2	833±4	847±4	49±2	61±2

5



UD5001LXI;UD5002LXI;UD5004LXI



UD5003LXI;UD5050LXI

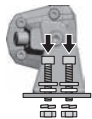





- EN It is your own responsibility to ensure that the use of the LED lightbar complies with applicable local legal requirements.
- FR Il est de votre responsabilité d'utiliser les LED Lightbars conformément aux exigences légales locales applicables.
- GER Sie selbst sind für die Einhaltung gesetzlicher Vorschriften in Bezug auf die Verwendung der LED-Zusatzscheinwerfer verantwortlich.
- ES Es su propia responsabilidad usar las luces LED lightbars conforme con los requisitos legales aplicables.
- PT Utilizar as luzes LED Lightbar em conformidade com os requisitos legais aplicáveis é da inteira responsabilidade do proprietário.
- DA Det er dit eget ansvar, at brugen af LED-lysbar opfylder gældende lovkraft.
- FIN On käyttäjän omalla vastuulla, että LED lisävaloja käytetään sovellettavan lain mukaisesti
- SU Det är ditt eget ansvar att användningen av LED-Lightbar överensstämmer med tillämpliga rättsliga krav.
- NOR Det er ditt eget ansvar å sikre at bruk av LED-lysbaren følger med gjeldende lokale lovkraft.
- PL Odpowiedzialność za to, by użytkowanie LED Lightbar było zgodne z odpowiednimi przepisami, spoczywa na użytkowniku.
- IT È responsabilità dell'utente utilizzare le luci LED Lightbar in modo conforme ai requisiti legali applicabili.
- NL Het is uw eigen verantwoordelijkheid om ervoor te zorgen dat het gebruik van de LED-lichtbalk voldoet aan de toepasselijke lokale wettelijke vereisten.
- RO Este responsabilitatea dvs să vă asigurați că utilizarea LED lightbar respectă cerințele legale locale aplicabile
- HUG Az Ön felelőssége annak biztosítása, hogy a LED-lámpák használatát megfelelően a vonatkozó helyi törvényi előírásoknak-
- RUS Вы несете ответственность за использование этой светодиодной продукции в соответствии с местным законодательством



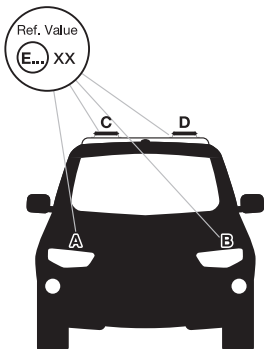

5

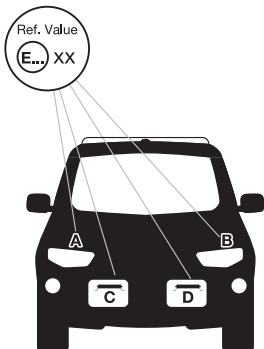
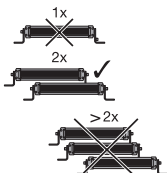

  
Ref. Value  
 $xx \leq 100$

A: xx
+ B: xx
+ C: xx
+ D: xx
<u><u><math>\leq 100</math></u></u>



  
Ref. Value  
 $xx \leq 100$

A: xx
+ B: xx
+ C: xx
+ D: xx
<u><u><math>\leq 100</math></u></u>

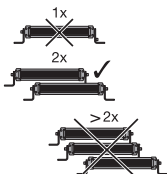

5

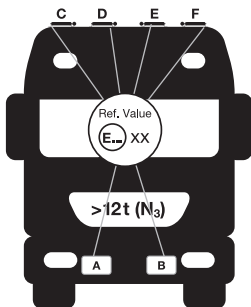

Ref. Value  $xx \leq 100$

**A:** xx  
**+ B:** xx  
**+ C:** xx  
**+ D:** xx  
**+ E:** xx  
**+ F:** xx  
 $\leq 100$

~~1x~~

~~3x~~

~~>4x~~

2x ✓

4x ✓

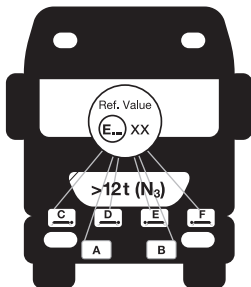

Ref. Value  $xx \leq 100$

**A:** xx  
**+ B:** xx  
**+ C:** xx  
**+ D:** xx  
**+ E:** xx  
**+ F:** xx  
 $\leq 100$

~~1x~~

~~3x~~

~~>4x~~

2x ✓

4x ✓

# 6



UD5001LX| 10 inch LED lightbar  
UD5002LX| 20 inch LED lightbar  
UD5003LX| 20 inch dual-row LED lightbar

UD5004LX| 30 inch LED lightbar

9-30V DC

Red +  
Black -



①



②

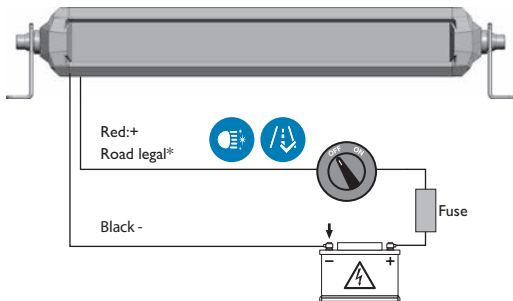

③





Language				
EN	Red + Black	Road-legal	Yellow + Black	Boosted light beam, not for use on public road*
FR	Rouge + Noir	Route-légal	Jaune + Noir	Faisceau lumineux renforcé, ne pas utiliser sur la voie publique
GER	Rot + Schwarz	Straßenzulassung	Gelb + Schwarz	Verstärkter Lichtstrahl, nicht für den Einsatz auf öffentlichen Straßen
ES	Rojo + Negro	Uso legal en carretera	Amarillo + Negro	Haz de luz intenso, uso fuera de carretera
PT	vermelho + Preto	Uso legal em vias públicas	Amarelo + Preto	Feixe de luz intenso, não use em vias públicas
DA	Red + Sort	Lovlig på offentlig vej	Gul + Sort	Boost-lysstråle, ikke til brug på offentlig vej
FIN	Punainen + Musta	Hyväksytyt tieliikennekäyttöön	Keltainen + Musta	Tehostettu valokeila, ei saa käyttää yleisillä teilla
SV	Röd + Svart	Godkänd för bruk på allmänna vägar	Gul + Svart	Förstärkt ljuskäglä, inte för användning på allmänna vägar
NOR	Red + Svart	Lovlig på offentlig vei	Gul + Svart	Boost-lysstråle, ikke til bruk på offentlig vei
PL	Czerwony + Czarny	Drogowo-prawny	Zółty + Czarny	Wzmocniony strumień światła, nie do użytku na drogach publicznych
IT	Rosso + Nero	Stradale-legale	Giallo + Nero	Fascio di luce amplificato, non utilizzare su strade pubbliche
NL	Rode + Zwart	Weg-legale	Geel + Zwart	Versterkte lichtbundel, niet te gebruiken op de openbare weg
RO	Roșu + Negru	Rutier-legal	Galben + Negru	Fascicul de lumină intensificat, nu se utilizează pe drumurile publice
HUG	Piros + Fekete	Közúti-legális	Sárga + Fekete	Erősített fényugár, nem használható közúton
RUS	красный + Черный	Разрешение на использование	Желтый + Черный	Мощный световой луч, не для использования на дорогах общей сети

# 6



## UD5050LX1 10 inch boost LED lightbar

9-30V DC

Red: +

Black: -

Yellow: +(Boosted light beam)

Blue: n/a

①

ON

OFF

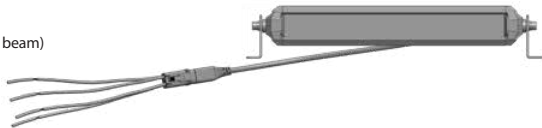

②

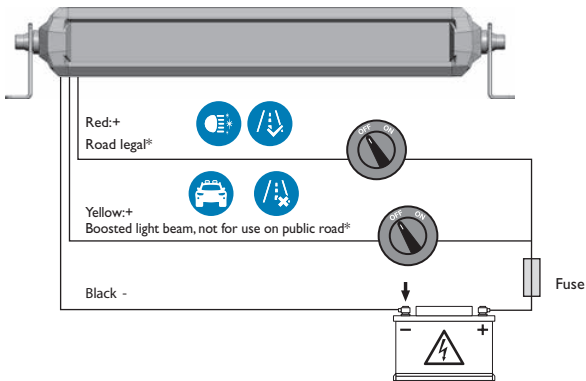

③







+



=





Language				
EN	Red + Black	Road-legal	Yellow + Black	Boosted light beam, not for use on public road*
FR	Rouge + Noir	Route-légal	Jaune + Noir	Faisceau lumineux renforcé, ne pas utiliser sur la voie publique
GER	Rot + Schwarz	Straßenzulassung	Gelb + Schwarz	Verstärkter Lichtstrahl, nicht für den Einsatz auf öffentlichen Straßen
ES	Rojo + Negro	Uso legal en carretera	Amarillo + Negro	Haz de luz intenso, uso fuera de carretera
PT	vermelho + Preto	Uso legal em vias públicas	Amarelo + Preto	Feixe de luz intenso, não use em vias públicas
DA	Rød + Sort	Lovlig på offentlig vej	Gul + Sort	Boost-lysstråle, ikke til brug på offentlig vej
FIN	Punainen + Musta	Hyväksytyt tieliikennekäyttöön	Keltainen + Musta	Tehostettu valokeila, ei saa käyttää yleisillä teillä
SV	Röd + Svart	Godkänd för bruk på allmänna vägar	Gul + Svart	Förstärkt ljuskägla, inte för användning på allmänna vägar
NOR	Rød + Svart	Lovlig på offentlig vei	Gul + Svart	Boost-lysstråle, ikke til bruk på offentlig vei
PL	Czerwony + Czarny	Drogowo-prawny	Żółty + Czarny	Wzmocniony strumień światła, nie do użytku na drogach publicznych
IT	Rosso + Nero	Stradale-legale	Giallo + Nero	Fascio di luce amplificato, non utilizzare su strade pubbliche
NL	Rode + Zwart	Weg-legale	Geel + Zwart	Versterkte lichtbundel, niet te gebruiken op de openbare weg
RO	Roșu + Negru	Rutier-legal	Galben + Negru	Fascicul de lumină intensificat, nu se utilizează pe drumurile publice
HUG	Piros + Fekete	Közúti-legális	Sárga + Fekete	Erősített fényugár, nem használható közutakon
RUS	красный + Черный	Разрешение на использование	Желтый + Черный	Мощный световой луч, не для использования на дорогах общей сети



Item	Symbol-[unit]	UD5001LX1	UD5002LX1	UD5003LX1	UD5004LX1	UD5050LX1	
Beam		Road legal	Road legal	Road legal	Road legal	Road legal	Boosted light beam
Operating voltage	U [V]	9-30V DC	9-30V DC	9-30V DC	9-30V DC	9-30V DC	
Power-13.2V	P [W]	38±15%	40±15%	38±15%	42±15%	49±15%	56±15%
Power-28V	P [W]	39±15%	44±15%	42±15%	48±15%	53±15%	62±15%
Flux (@1 min lighting)	Φ [lm]	2500±15%	2900±15%	3600±15%	3200±15%	3300±15%	4000±15%
Color temperature	T [K]	6500±15%	6500±15%	6500±15%	6500±15%	6500±15%	
Beam shape	/	Combo	Combo	Combo	Combo	Combo	
Beam length(1 lux)	m	387±10%	427±10%	436±10%	458±10%	425±10%	448±10%
Beam Width(1 lux)	m	70±10%	70±10%	90±10%	70±10%	90±10%	90±10%
ECE Ref. No		37.5	40	45	50	40	Off-road use only
Operating temperature	[°C]	-40°C+80°C	-40°C+80°C	-40°C+80°C	-40°C+80°C	-40°C+80°C	
Storage temperature	[°C]	-40°C+80°C	-40°C+80°C	-40°C+80°C	-40°C+80°C	-40°C+80°C	
Weight	[g]	730±15%	1180±15%	1620±15%	1600±15%	1010±15%	
Ingress protection	/	IP68 & IP69K	IP68 & IP69K	IP68 & IP69K	IP68 & IP69K	IP68 & IP69K	
Shock resistance	/	IK07	IK07	IK07	IK07	IK07	
Cable length	cm	50	50	50	50	50	

8



---

## WARRANTY

[www.philips.com/support](http://www.philips.com/support)

Name: \_\_\_\_\_

Address: \_\_\_\_\_

Phone number: \_\_\_\_\_

Product name: \_\_\_\_\_

Purchasing date: \_\_\_\_\_