

**PHILIPS**

***NORELCO***

***Vacuum  
Trimmer***



**T780**

**Rechargeable  
Cordless**

Register your product and get support at  
[www.philips.com/norelco](http://www.philips.com/norelco)

# **IMPORTANT SAFETY INSTRUCTIONS**

When using an electrical appliance, basic safety precautions should always be followed, including the following:

**Read all instructions before using this appliance.**

## **DANGER**

**To reduce the risk of electric shock:**

1. Do not reach for a Trimmer that has fallen into water. Unplug immediately.
2. Do not use while bathing or in a shower.
3. Do not place or store Trimmer where it can fall or be pulled into a tub or sink. Do not place in or drop into water or other liquid.
4. Always unplug this Trimmer from the electrical outlet immediately after (re)charging.
5. Unplug Trimmer before cleaning.
6. When discarding Trimmer, unplug Trimmer to remove rechargeable battery. See Battery Removal instructions.

## **WARNING**

**To reduce the risk of burns, fire, electric shock or injury to persons:**

1. Close supervision is necessary when this appliance is used by, on, or near children or invalids.
2. Use this Trimmer for its intended household use as described in this manual. Do not use attachments not recommended by the Philips Electronics North America Corporation.
3. Never operate this Trimmer if it has a damaged cord or plug, if it is not working properly, if it has been dropped, damaged, or dropped into water. For assistance call 1-800-243-3050.
4. Keep the Trimmer and cord away from heated surfaces.
5. Never drop or insert any object into any opening. Keep air openings free of lint, hair, etc.
6. Do not charge or plug in Trimmer outdoors or where aerosol (spray) products are being used or where oxygen is being administered.
7. Do not use this Trimmer with a damaged or broken cutter, as facial injury may occur.
8. Do not operate Trimmer with the hair collection chamber cover opened.
9. Always attach plug to Trimmer first, then into outlet. To disconnect, turn ON/OFF switch "OFF" then remove plug from outlet.
10. To prevent possible damage to the cord, do not wrap cord around the Trimmer.
11. Never put Trimmer in direct sunlight or store at a temperature above 140°F.
12. This Trimmer is for use on human facial hair only. Do not use this Trimmer for any other purpose.

## **SAVE THESE INSTRUCTIONS**

**IMPORTANT:** The power plug contains a transformer. Do not cut off the power plug to replace it with another plug as this will cause a hazardous condition.

**IMPORTANT: YOUR TRIMMER CONTAINS A NICKEL METAL HYDRIDE RECHARGEABLE BATTERY.**

See Battery Removal instructions.

## Registration

Congratulations on your purchase and welcome to Philips Norelco!

To fully benefit from the support that Philips Norelco offers, register your product at [www.philips.com/norelco](http://www.philips.com/norelco)

## Charging

Charge the Trimmer fully before you start using it for the first time or after a long period of non-use. This Trimmer will not operate corded directly from the electrical outlet.

## To Charge / Recharge

- ▶ (Re)charging requires 10 full hours.
- ▶ Use only the cord provided.
- ▶ Battery performance is best if you recharge only when the battery is (almost) completely empty.
- ▶ Charging or recharging at temperatures below 40°F or higher than 95°F adversely affects lifetime of battery.
- ▶ Continuously recharging Trimmer will reduce life of battery.

**1** Be certain Trimmer is OFF.

**2** Connect cord to Trimmer. Plug into any 120V AC outlet only. Use only the cord provided.

- ▶ The Charging Indicator light will go on to indicate the Trimmer is charging (fig. 2).
- ▶ An adaptor plug may be necessary for cord usage in some foreign countries. Use an attachment plug adaptor of the proper configuration for power outlet.

Do not charge Trimmer for more than 24 hours.

- ▶ It requires 10 hours to fully charge the battery.
- ▶ A fully charged Trimmer has a cordless trimming time of up to 40 minutes.
- ▶ If the battery is empty and you want to trim your beard, charge the Trimmer for at least 90 minutes and you will have enough power for one use.

**3** Disconnect the cord and unplug from electrical outlet.

## Optimize The Working Life Of The Battery

- ▶ After Trimmer has been charged for the first time, do not recharge Trimmer between trimming sessions. Continue using it until the battery is completely empty.
- ▶ Discharge the battery completely twice a year by letting the motor run until it stops.
- ▶ Do not charge for more than 24 hours.
- ▶ Do not keep cord permanently plugged in.
- ▶ If Trimmer hasn't been used for a long period of time, Trimmer must be recharged for full 10 hours.

## Features

- A Patented AccuControl System with Removable Guide Comb Attachment
  - B Detachable Cutting Unit with 3-Dimensional Rounded Stainless Steel Cutter Blades
  - C Flexi-Guard Hair Deflector
  - D ClearView Hair Collection Chamber and Filter
  - E ClearView Hair Collection Chamber Cover
  - F Precision Zoom Lock Hair Length Selector with 9 Pre-select Settings
  - G Selected Hair Length Setting Window
  - H ON/Off Slide Switch
  - I Charging Indicator Light
  - J Power Cord Socket
  - K Charging Plug
  - L Cleaning Brush
- Full Two-Year Warranty  
45-Day Money-Back Guarantee

## Put It To The Test

Like many new products, your Philips Norelco Vacuum Trimmer may take a little getting used to. If you are using an electric Trimmer for the first time, or if you've been using a different brand, take the time to acquaint yourself with your new Trimmer.

Your Vacuum Trimmer features the Patented AccuControl System combined with an adjustable Zoom Lock to make trimming facial hairs goofproof. Plus, the Integrated Vacuum collects cut-off hairs during use for no clean-up.

Throw your scissors away and put your new Vacuum Trimmer to the test. We guarantee precise, professional, results or Philips Norelco will refund you the full purchase price, as long as the request is received within 45 days of purchase.

## AccuControl System

The patented AccuControl System with Integrated Vacuum puts you in complete control while trimming your facial hairs with no prior experience needed. The flexing Guide Comb adjusts automatically to hug the contours of your face for a trim that is both even and accurate. And, it's easy to maneuver over those hard-to-reach areas such as the throat and chin. The patented Zoom Lock Hair Length Selector allows you to choose among 9 preset hair lengths and locks into position so you can control the exact hair length you desire or vary the length of your facial hair. The Patented AccuControl System and Zoom Lock Hair Length Selector for professional, goof-proof results every time.

## Integrated Vacuum

The Integrated Vacuum is activated automatically as soon as you switch the trimmer on. It collects cut hairs during every kind of use, i.e. trimming with or without comb attachment and contouring. The flexible hair guide follows the contours of the face and the Flexi-Guard Hair Deflector directs cut hairs towards the nozzle of the vacuum mechanism.

It is recommended that you empty the Hair Collection Chamber after each trimming session. When trimming long, dense beards it may also be necessary to empty the Hair Collection Chamber during the trimming session in order to maintain optimal suction performance (also see 'Cleaning' section, 'Hair Collection Chamber').

► To ensure optimal functioning of the Vacuum Trimmer, do not cut off more than approximately 7mm of your overall beard length at a time. If you want to cut your beard shorter, repeat the process one or more times.

## Cordless Trimming

- ▶ Use this Trimmer for its intended household use as described in this manual.
- ▶ Always comb your beard and/or moustache with a fine comb before you start trimming.
- ▶ If you are trimming for the first time, be careful. Do not move the Trimmer too fast. Make smooth and gentle movements.
- ▶ After trimming, residual hair length can vary depending on hair type.

### Trimming With AccuControl Guide Comb Attachment

---

- ▶ Guide Comb Attachment must be on Trimmer in order to use the Zoom Lock.
- 1** Turn the Zoom Lock to the desired trimming length setting (see table). The setting will appear in the window below the Zoom Lock (fig. 3).
    - ▶ If you are trimming for the first time, start by using the maximum trimming length setting #9 to prevent accidentally trimming hairs too short. As you become familiar with the settings, adjust Zoom Lock to desired trimming length. Zoom Lock will 'click' into position at each setting.
  - 2** Switch the Trimmer ON (fig. 4).
  - 3** To trim in the most effective way, move the Trimmer against the direction of hair growth. Do not move the trimmer too fast. Make smooth and gentle movements and make sure the surface of the Guide Comb always stays in contact with the skin (fig. 5).

### Trimming Length Settings Table

---

#1	Stubble Length or Closely Cropped	.06 in./1.5 mm
#2	Short	.1 in./2.5 mm
#3		.16 in./4 mm
#4		.22 in./5.5 mm
#5	Medium	.3 in./7.5 mm
#6		.38 in./9.5 mm
#7		.48 in./12 mm
#8		.6 in./15 mm
#9	Long	.72 in./18 mm

NOTE: Since all hairs do not grow in the same direction, you may want to try different trimming positions (i.e., upwards, downwards, or across). Practice is best for optimum results.

# Features

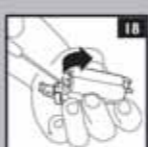
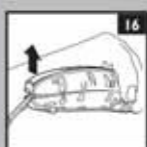
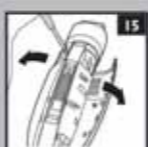
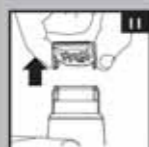
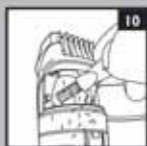
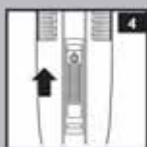
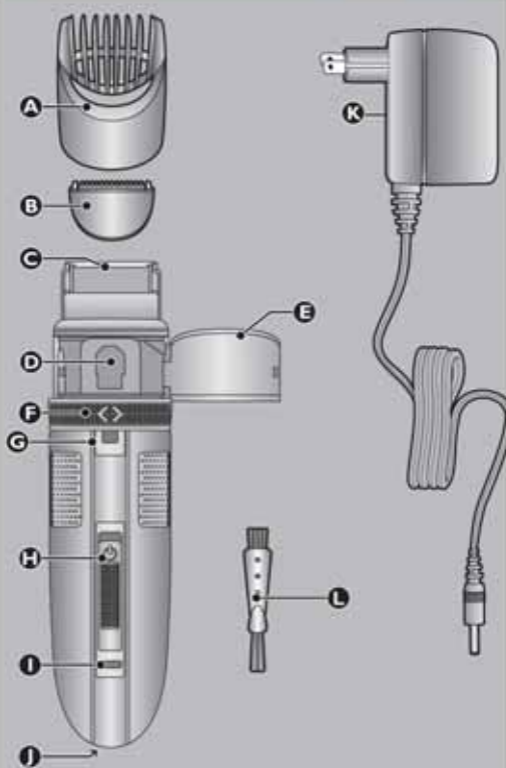

## Trimming For 'Stubble' Look

---

- 1** Be certain Guide Comb is on Trimmer and use setting #1 to result in a 'stubble' look (fig. 6).

## Trimming Without Guide Comb Attachment

---

Remove Guide Comb Attachment if you are:

- ▶ Defining hair lines
- ▶ Trimming nape of neck
- ▶ Removing single, unwanted hairs

- 1** Be certain Trimmer is in the OFF position.
- 2** Remove the Guide Comb Attachment by pulling it off the Trimmer (fig. 7).

Never pull off the Guide Comb Attachment by grasping the flexible top portion. Always pull off by the bottom part of attachment.

- 3** Switch the Trimmer ON.
- 4** Make well-controlled movements. Touch the hair lightly with the Trimmer (fig. 8).

## Replacing Guide Comb Attachment On Trimmer

---

- 1** Be certain Trimmer is in OFF position.
- 2** Replace Guide Comb Attachment until it 'clicks' into position. The Guide Comb Attachment can be placed on Trimmer only one way by properly aligning it to slide into the tracks on sides of Trimmer head. If it does not fit properly, reverse it.

NOTE: The Zoom Lock can be on any setting when removing or replacing Attachment.

## Cleaning

- ▶ Always switch Trimmer OFF before cleaning.
- ▶ Do not use abrasive, scourers or liquids such as alcohol, benzene, bleach or acetone to clean the Trimmer.
- ▶ Never clean, remove or replace Guide Comb Attachment with motor ON.
- ▶ Do not apply pressure to cutters.
- ▶ Do not touch cutters with hard objects as this may damage them.
- ▶ Do not use while bathing, showering or immerse the Trimmer in water or other liquids as damage to Trimmer may occur.
- ▶ Never use sharp or hard objects to clean the filter to avoid damaging it.
- ▶ If cut hairs have accumulated in the Guide Comb area, turn Trimmer off, pull Guide Comb Attachment off Trimmer and remove hairs by shaking and/or blowing.

### Hair Collection Chamber

---

- 1** Switch the Trimmer OFF.
  - 2** Open the ClearView Hair Collection chamber cover. The cover opens from the left side of the Trimmer to the right side (fig. 9).
  - 3** Remove the hairs by carefully shaking them out or by brushing them out with the cleaning brush supplied (fig. 10).
- ▶ When trimming extremely long, dense beards, it may be necessary to empty the Hair Collection Chamber during the trimming session in order to maintain optimal suction performance.
  - ▶ If suction performance is not as strong as usual, Hair Collection Chamber may require emptying to restore optimal performance.
  - ▶ It is recommended that the Hair Collection Chamber be emptied and cleaned out after each use.
  - ▶ Do not operate the Trimmer with the Hair Collection Chamber cover opened.

### Trimmer

---

- 1** Make sure the Trimmer is switched OFF and disconnected from the electrical outlet.
- 2** Remove the Guide Comb Attachment (fig. 7).
- 3** Remove the cutting unit (fig. 11).
- 4** Clean the cutting unit and the inside of the Trimmer with the brush supplied (fig. 12).
- 5** Re-attach the cutting unit and the Guide Comb into place on the Trimmer (fig. 13).



**PHILIPS****NORELCO****45-DAY MONEY-  
BACK GUARANTEE**

If you are not fully satisfied with your Philips Norelco Turbo Vacuum Trimmer, send the product back along with dated sales receipt and we'll refund you the full purchase price.

*The Trimmer must be shipped prepaid by insured mail, insurance prepaid, and have the original sales receipt, indicating purchase price and the date of purchase, enclosed. We cannot be responsible for lost mail. The Trimmer must be postmarked no later than 45 days after the date of purchase. Philips Norelco reserves the right to verify the purchase price of the Trimmer and limit refunds not to exceed suggested retail price.*

To obtain money-back guarantee return authorization form, call 1-800-243-3050 for assistance. Please allow 4-6 weeks for delivery of check.

**Full Two-Year Warranty**

Philips Electronics North America Corporation warrants each new Philips Norelco product, Model T780 against defects in materials or workmanship for a period of two years (cutters for up to four years) from the date of purchase, and agrees to repair or replace any defective product without charge.

**IMPORTANT:** This warranty does not cover damage resulting from accident, misuse or abuse, lack of reasonable care, the affixing of any attachment not provided with the product or loss of parts or subjecting the product to any but the specific voltage.\* Use of unauthorized replacement parts will void this warranty.

**PHILIPS ELECTRONICS NORTH AMERICA CORPORATION WILL NOT PAY FOR WARRANTY SERVICE PERFORMED BY A NON-AUTHORIZED REPAIR SERVICE AND WILL NOT REIMBURSE THE CONSUMER FOR DAMAGE RESULTING FROM WARRANTY SERVICE PERFORMED BY A NON-AUTHORIZED REPAIR SERVICE.**

**NO RESPONSIBILITY IS ASSUMED FOR ANY SPECIAL, INCIDENTAL OR CONSEQUENTIAL DAMAGES.**

In order to obtain warranty service, simply go to [www.philips.com/norelco](http://www.philips.com/norelco) or call 1-800-243-3050 for assistance. It is suggested that for your protection you return shipments of product by insured mail, insurance prepaid. Damage occurring during shipment is not covered by this warranty.

**NOTE:** No other warranty, written or oral, is authorized by Philips Electronics North America Corporation. This warranty gives you specific legal rights, and you may also have other rights which vary from state to state. Some states do not allow the exclusion or limitation of incidental or consequential damages, so the above exclusion and limitations may not apply to you.

\*Read enclosed instructions carefully.

Manufactured for:

Philips Consumer Lifestyle

A Division of Philips Electronics North America Corporation

1600 Summer Street - 5th Floor, Stamford, CT 06905-5125



This symbol on the product's nameplate means it is listed by Underwriters Laboratories, Inc.

Norelco is a Registered Trademark of Philips Electronics North America Corporation.

ClearView, AccuControl, Flexi-Guard and Zoom Lock are Trademarks of Philips Electronics North America Corporation.

PHILIPS is a Registered Trademark of Koninklijke Philips Electronics N.V.

© 2009 Philips Electronics North America Corporation. All Rights Reserved.