

Register your product and get support at  
[www.philips.com/welcome](http://www.philips.com/welcome)

Portable Notebook  
Power Adaptor

SPJ7100



IT Manuale utente

**PHILIPS**

## EN Notebook tips specification table

| IT   | Numero adattatore   | Tensione             | Dimensioni adattatore  | Marca di notebook                  | Serie   | Polarità |
|--|---|----------------------|--|------------------------------------|---------|----------|
| 1  | 19V   | 4.75/1.7 x 12mm      | HP Pavilion dv2-1000(dv2-1004ax), 1000(dv2-1005ax), 1000(dv2-1006ax), 1115ea, 1125ea, 1127ea   | HP Pavilion dv2                    | Centre+ |          |
|  |   |                      | HP Touchsmart tx2-1012au(NK927PA), tx2-1013au(NK928PA), tx2Z   | HP Touchsmart                      |         |          |
|  |   |                      | HP Compaq 510(VX573PA), 510(VX574PA), 510(WB228PA), 510(WB229PA), 510(WB230PA), 510(WB231PA), 515(VF593PA), 515(VF938PA), 515(VF939PA), 515(VF940PA), 515(VF941PA)   | HP Compaq                          |         |          |
|  |   |                      | HP Pavilion dm1-1020ea, 1030sa, 1101sa, 1020sa, 1102sa<br>HP Pavilion dm3- 1112sa, 1025sa, 1101ea, 1020ea, 1100sa, 1101sa, 1105ea  | HP Pavilion dm1<br>HP Pavilion dm3 |         |          |
| 2  | 19V   | 5.5/1.7 x 12mm       | Acer Aspire Timeline 5810T, 4810T  | Acer Aspire timeline               | Centre+ |          |
|  |   |                      | Acer Aspire 1410, 2930, 2930Z, 3410, 3935, 4330, 4530, 4535, 4540, 4730Z, 4732Z, 4736, 4736Z, 4930, 4935, 4937, 5410, 5532, 5534, 5535, 5536, 5538, 5542, 5732Z, 5735, 5738, 5738Z, 5740, 5935G, 7736Z, 7740   | Acer Aspire                        |         |          |
|  |   |                      | Acer Extensa 4130, 4230, 4430, 4630Z, 5235   | Acer Extensa                       |         |          |
|  |   |                      | Acer TravelMate 4330, 4530, 4730, 5330, 5530, 5730, 6293, 6493, 7730, 8331, 8371, 8431, 8471, 8531   | Acer TravelMate                    |         |          |
|  |   |                      | Acer TravelMate Timeline 8571  | Acer TravelMate Timeline           |         |          |
|  |   |                      | Acer Ferrari 1100, 1200  | Acer Ferrari                       |         |          |
|  |   |                      | Fujitsu LB 770   | Fujitsu Lifebook 700               |         |          |
| 3  | 16V   | 6.5/4.3 (1.4) x 12mm | Fujitsu LBP 8010-AC03250F1, 8010-AC03350E1, 8010-AC06450F1, 8010-AC08850E1, 8020-AC00550E1, LOP8020-ACSOE10083, 8020   | Fujitsu Lifebook P                 | Centre+ |          |
|  |   |                      | Fujitsu LBT 2010-AC04750E1, 2010-AC12250E1, 2020-AC02150E1, LOT2020-ACSOE10040   | Fujitsu Lifebook T                 |         |          |
|  |   |                      | Fujitsu Stylistic ST5010, ST5020, ST5030, ST6012, ST5112-AC10450F1, ST5112-AC20750F1   | Fujitsu Stylistic                  |         |          |
|  |   |                      | Sony TT VGN-TT13, TT17N, TT18N, TT23, TT27D, TT28D, TT36GG, TT45G, TT46GG, TT47GG, TT45I   | Sony TT                            |         |          |
| 4  | 16V   | 6.5/4.3 (1.4) x 12mm | Sony TX VGN-TX37GP, TX45C, TX46C, TX56C, TX57CN, TX58CN  | Sony TX                            | Centre+ |          |
|  |   |                      | Sony TZ VGN-TZ121, TZ13, TZ131N, TZ132N, TZ16N, TZ17N, TZ18N, TZ27N, TZ28N, TZ33, TZ37N, TZ38N   | Sony TZ                            |         |          |
|  |   |                      | Sony G VGN-G118CN, G218N, G218TN   | Sony G                             |         |          |
|  |   |                      | ASUS Versatile performance A2H, A3Ac, A3E, A3Fc, A3G, A3H, A3N/L, A5E, A5Eb, A5Ec, A6G, A6J, A6jc-, A6K, A6L, A6M, A6Ne, A6R, A6Rp, A6Tc, A6U, A6Vc, A6Vm, A8E, A8F-, A8He, A8jc, A8Le, F2F-, F2je, F3F-, F3H, F52Q, F6E, F7Sr, F80Cr, F80L, F83Cr, F83T, K40Jj, K40IN, K50JJ, K50IN, M3N, M3Np, N20A, V6j-, V6V, V6Va, W1Ga, W1Gc, W1N, W1Na, W3N, W3V, M9V, X51L, X51R, X51RL, X58C, X58L, X58Le, X61GX, X80Le   | ASUS Versatile performance         |         | Centre+  |
| ASUS special edition VX1 ASUS-LAMBORGHINI VX1  | ASUS special edition VX1  |                      |  |                                    |         |          |
| ASUS Business B50A, B80A, F5GL, F5M, F5R, F5RI   | ASUS Business   |                      |  |                                    |         |          |
| ASUS Multimedia entertainment M5A, M6A, M6N/Ne, M6R, M6V, M6Va   | ASUS Multimedia entertainment   |                      |  |                                    |         |          |
| ASUS Superior mobility F9E, F9F, N10E, N10J, N10Jc, N10jh, R1E, S6F, S6F leather collection, S6Fm, S7F, U1E, U1F, U2E, U5A, U5F-, U6E, U6Ep, UL50Ag, UL50Vg, UL50Vs, UL50Vt, UL80V, UX50V, W5A, W5F, W5Fe, W5Fm, W6A, W6Fp-, W7F, Z35H, Z35L   | ASUS Superior mobility  |                      |  |                                    |         |          |
| Lenovo G450L-TTH, M-TFO  | Lenovo G450   |                      |  |                                    |         |          |
| Lenovo IdeaPad U150-SFO(Black star), U150-SFO(Black star)(R), U150-SFO(Phantom), U150-SFO(Colourful matrix), U150-STW(P)(Black star), U150-STW(Black star), U150-STW(black star)(R), U150-STW(Red star), U150-STW(Red star)(R), U350, U350-SSE(8H)(Light texture), U350-SSE(R)(White leather), U350-SSE(R)(Light texture), U350-SSE(R)(Lizard leather), U350-STW(H)(Charming black), U350-STW(H)(Champagne gold), U350-STW(H)(Vigor red), U450A-SNI, U450A-SSE, U450A-STW, U450  | Lenovo IdeaPad U  |                      |  |                                    |         |          |
| Lenovo B450L-TFO(A), TTH(A)  | Lenovo B450   |                      |  |                                    |         |          |
| MSI Classic CR400, CR420, CR500, CR600, CR610, CR700, CX420, CX500, CX600, CX605, CX620, CX700   | MSI Classic   |                      |  |                                    |         |          |
| MSI Entertainment EX460, EX465, X350, X400, X420, X600, X600 pro, X610, X620   | MSI Entertainment   |                      |  |                                    |         |          |
| MSI Wind12 U210, U230  | MSI Wind Netbook  |                      |  |                                    |         |          |
| Toshiba Satellite A500-ST5607, A505-S6004, A505-S6005, A505-S6007, A505-S6012, A505-S6015, A505-S6016, A505-S6017, L455D-S5976, L455-S5000, L455-S5975, L455-S5980, L455-S5989, L500-ST5507, L505-ES5015, L505-ES5016, L505-ES5018, L505-ES5033, L505-ES5034, L505-GS5035, L505-GS5037, L505-GS5038, L505-GS6002, L505-L55017, L515-S4960, L525, L550-ST5707, L550-ST5708, L555-S7002, M500-ST5408, M505-S4020, M505-S4022, L450-137, L450-16Q, L450-181, L450-188, L450-18D, L500-1DT, L500-1WG, L500-1XC, L500-1XD, L500-1XJ, L500-1XL, L500-1XM, L500-207, L500-1UR, T110-107, T110-10J, T110-11U, T110-12T, T110-12U, T130-11H, T130-13M, T130-13Q, T130-16W, T130-170, U500-1EX, T110-121, T115D-S1120, T115D-S1120RD, T115D-S1125, T115D-S1125RD, T115-S1100, T115-S1105, T115-S1108, T135D-S1320, T135D-S1324, T135D-S1325, T135D-S1325RD, T135D-S1325WH, T135D-S1326, T135D-S1327, T135-S1300, T135-S1300RD, T135-S1300WH, T135-S1305, T135-S1305RD, T135-S1305WH, T135-S1307, T135-S1309, T135-S1310, T135-S1310RD, T135-S1300WH, U500-ST5307, U505-S2002, U505-S2005, U505-S2005RD, U505-S2005WH, U505-S2008, U505-S2950, U505-S2950WH, U505-S2960, U505-S2960PK, U505-S2961, U505-S2970, U505-S2975 | Toshiba Satellite   |                      |  |                                    |         |          |
| Toshiba Satellite Pro L450-EZ1510, L450-EZ1541, L450-EZ1542, L450-EZ1543, L500-EZ1520, L500-EZ1530, L550-EZ1702, T110-13H, T130-14M, T130-14Q, T130-14U, T130-15F, U500-1DK, U500-1E4, U500-EZ1311   | Toshiba Satellite Pro   |                      |  |                                    |         |          |
| Dell Inspiron 1000, 1200, 1300, 2200, B120, B130   | Dell Inspiron   |                      |  |                                    |         |          |
| Dell Latitude 110L, 120L   | Dell Latitude   |                      |  |                                    |         |          |
| Fujitsu LBP 8110   | Fujitsu Lifebook P  |                      |  |                                    |         |          |
| 6  | 19V   | 5.5/3.0 (1.0) x 12mm | Samsung P P410, P460, P560-AA01, P560-AA02, P560-AA03, P560-AA04, P560-AA05, P560-AA0A, P560-HS01  | Samsung P                          | Centre+ |          |
|  |   |                      | Samsung Q Q1, Q1U, Q1U-000, Q1U-A000, Q1U-AP01, Q1U-AY01, Q1-Ultra, Q1-Ultra-HSDPA, Q1U-SD1, Q1U-Y01, Q1V-000, Q1V-002, Q210, Q210-FA02, Q310, Q318, Q318-D50N, Q318-DS0P, Q318-DSON, Q318-PSO1, Q318-PSOP, Q320, Q320-AS02, Q320-BS02, Q320-BS03, Q320E, Q320-EXT, Q320-FS01, Q320-FS05, Q320-FS08, Q320-FS09, Q320-JS01, Q320-JS02, Q320-JS43W, Q320-PS01, Q320-PS32S, Q320-PS3LA, Q320-PS55B  | Samsung Q                          |         |          |
|  |   |                      | Samsung R R408, R410, R410-FB02, R410-FB03, R418, R418-DA03, R418-DA04, R418-DA04TH, R420, R420-AA11S, R420-AA23D, R420-FA02, R420-JA12S, R420-JA41D, R420-JA43, R420-XA02, R420-XA03, R428-DA02, R428-DS01, R428-DS04, R428-DS05, R428-DS06, R428-DS07, R428-DS08, R428-DS09, R428-DS0A, R428-DS0D, R430, R430-JA01, R430-JA05, R430-JA12S, R430-JA42D, R430-JA43, R430-JS04, R430-JS05, R430-JS4DA, R430-JS4MA, R430-JS4SA, R430-PS3LA, R430-PS3MA, R458, R460, R460-AS02, R463-DS01, R466-DS09, R466-DS0A, R467-DT03, R467-DT08, R467-DT09, R467-DT0A, R467-DT0B, R467-DT0C, R467-DT0E, R467-DT0F, R468, R468-DS03, R469-JS01, R469-JS42D, R469-JT01, R469-JT02, R469-XS01, R469-XS02, R470, R470-AT02, R470-FT01, R470-FT02, R470-JA04, R519-FA01, R519-FA02, R519-FA03, R519-FA04, R519-JA06, R519-JA12S, R519-JA42, R519-JA43, R519-JS01, R519-JS02, R519-JS03, R519-JS04, R519-JS41D, R519-JS42S, R519-JS43L, R519-JS43M, R519-JS45M, R519-XA01, R519-XA02, R519-XA03, R519-XA07, R519-XA08, R519-XS01, R520, R520-FA01, R520-FA02, R520-FS01, R520-FS02, R520-FS03, R520-JA01, R520-JA02, R520-JA03, R520-JA42D, R520-JS01, R520-JS02, R520-PS32S, R520-PS53S, R520-XA03, R520-XA04, R520-XA05, R520-XA06, R520-XA07, R520-XS01, R520-XS02, R520-XS03, R522, R522-AA02, R522-AS01, R522-AS02, R522-AS03, R522E, R522E-FS0C, R522E-FA01, R522E-FS01, R522E-FS02, R522E-FS03, R522E-FS04, R522E-FS05, R522E-FS06, R522E-FS07, R522E-FS09, R522E-FS0A, R522E-FS0E, R522E-FS0F, R522-JA01, R522E-JS01, R522E-JS02, R522E-JS03, R522E-JS04, R522E-JS42J, R522E-JS43, R522E-PS33M, R522E-PS55, R522E-XA02, R522E-XA05, R522E-XS02, R530, R530-JA03uk, R530-JA05, R530-JA12S, R530-JA42, R530-JA42S, R530-JA4DA, R530-JA4JA, R530-JS02, R530-JS03, R530-JS06, R530-JS42, R530-JS4DA, R530-PS3JA, R530-PS3LA, R530-PS3SA, R530-PS5MA, R580, R60E, R60-Ext, R60FE06/S, R60FE08/S, R60FE09/S, R60FE0A/S, R60FE0B/S, R60FS01/S, R60FS02/S, R60FS03/S, R60-Int, R60PLUS, R610, R620-64BR, R620-64G, R620-AS01, R620-FS02, R620-FS03, R620-JS01, R717-DA01, R717-DA02, R719-FA01, R719-JA01, R719-JA02, R719-JA03, R719-JS01, R719-JS02, R719-JS03, R719-JS04, R720, R720-EXT, R720-FS02, R720-FS03, R720-FS04, R720-FS05, R720-FS06, R720-JS02, R720-JS03, R720-PS01, R720-PS55S, R728-DS05, R728-DS06 | Samsung R                          |         |          |
|  |   |                      | Samsung X X360, X360-AA01, X360-AA02, X360-AA03, X360-AA04, X360-AA05, X360-AA06, X360-AA07, X360-AA31R, X460-41S, X460-42PW, X460-43P, X460-43PW, X460-AA01, X460-AS01, X460-AS02, X460-AS04, X460-AS05, X460-AS06, X460-AS0A, X460-AS31B, X460-W50   | Samsung X                          |         |          |
| HP Compaq 2710p, 610, 615, 6530b, 6730b GB987EA, 6730b, 6735b<br>HP Compaq Presario CQ40-500(CQ40-506AU), CQ40-500(CQ40-507AU), CQ40-500(CQ40-522TU), CQ61-402EA, CQ61-401SA, CQ61-405SA, CQ61-406SA, CQ61-422SA, CQ61-425EA, CQ61-402SA, CQ71-402SA, G62-1055A<br>HP EliteBook 2530p, 6930p, 8530w mobile workstation, 8730w mobile workstation<br>HP Envy 13-1100<br>HP Mini 5101<br>HP Pavilion dv6-2112sa<br>HP ProBook 4310s, 4510s, 4515s, 4710s, 5310m, 5310m(VT180PA), 5310m(VT181PA), 5310m(VT214PA), 5310m(WC634PA), 5310m(WC635PA)<br>HP Touchsmart tm2-1000, tx2-1300  | HP Compaq<br>HP Compaq Presario<br>HP EliteBook<br>HP Envy<br>HP Mini<br>HP Pavilion dv6<br>HP ProBook<br>HP Touchsmart |                      |  |                                    |         |          |
| 8  | 16V   | 6.5/3.0 x 12mm       | Toshiba Portege A600-16N, R600-102, R600-10T, R600-11B, R600-12Z, R600-13X, R600-13Z, R600-140, R600-147, R600-149, R600-S4203, R600-S4211, R600-S4212, R600-S4213   | Toshiba Portege                    | Centre+ |          |
| 9  | 19V   | 7.9/5.5 (0.9) x 12mm | Lenovo ThinkPad X200 7454GHC, X200 74574UC, X200 7457AC1, X200 7457CH1, X200 7457CH2, X200 7458AJ2, X200 7458AJ3, X200 7458AJ4, X200 7458AJ5, X200 7458AJ6, X200 7458AJ7, X200 7458AJ8, X200 7458AJ9, X200 7458E48, X200 7458E49, X200 7458E51, X200 7458E69, X200 7458EA1, X200 7458EE7, X200 7458EE9, X200 7458EU6, X200 7458F16, X200 7458FA1, X200, X200s, X201, X201S, X200 tablet, X201 tablet, X100e, X301 2774HF2, X301 2774HF3, X301 2774HF4, X301 2774HF5, X301 2774HG1, X301 2774HH1, X301 2774HH2, X301 2774HH6, X301 2774HH7, X301 4182HE1, X301  | Lenovo ThinkPad X                  | Centre+ |          |
|  |   |                      | Lenovo ThinkPad Edge 13, 13 Glossy Red Cover, 13 Matte Black Cover   | Lenovo ThinkPad Edge               |         |          |
| 10   | 19V   | 7.4/5.1 (0.6) x 12mm | Dell Adamo 13  | Dell Adamo                         | Centre+ |          |
|  |   |                      | Dell Inspiron 11z, 13, 13z, 1401, 1410, 1420, 14z, 15, 15 intel core i, 1501, 1520, 1521, 1525, 1526, 15z, 17 intel core i, 300m, 500m, 6000, 630m, 700m, 710m   | Dell Inspiron                      |         |          |
|  |   |                      | Dell Latitude 131L, 2100, D410, D420, D430, D530, D531, D620, D630, D631, D830, E4200, E4300, E5500 & Mini 9, XT, XT2, XT2 XFR, Z  | Dell Latitude                      |         |          |
|  |   |                      | Dell Precision M20 mobile workstation, M2300, M4300, M70 mobile workstation  | Dell Precision                     |         |          |
|  |   |                      | Dell Studio 14z, 15(LED), 1536, 1555, 1747, XPS 13   | Dell Studio                        |         |          |
|  |   |                      | Dell Vostro 1000, 1014, 1015, 1220, 1310, 1320, 1400, 1500, 1510, 1710, 2510, V13<br>Dell XPS M140   | Dell Vostro<br>Dell XPS            |         |          |

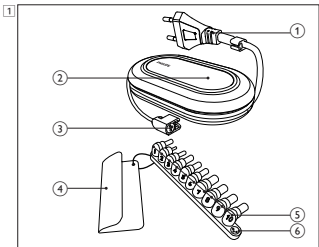

2

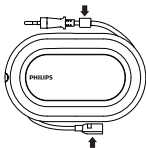
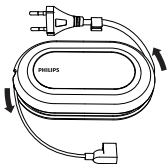
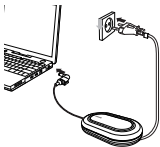
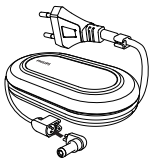

## 1 Panoramica del prodotto (Fig. 1)

- ① Spina di alimentazione CA
- ② Spia a LED
- ③ Cavo di collegamento per notebook
- ④ Elenco degli adattatori per notebook
- ⑤ Adattatori di collegamento per notebook
- ⑥ Porta-adattatori di collegamento

## 2 Guida introduttiva (Fig. 2)

- 1 Dall'elenco degli adattatori per notebook, selezionare quello adatto al proprio modello.
- 2 Collegare l'adattatore di collegamento al cavo di collegamento per notebook.
- 3 Collegare il cavo di alimentazione alla presa di alimentazione del proprio notebook e a una presa CA.  
↳ La spia a LED si illumina.

### **Declinazioni di responsabilità:**

Per evitare danni al notebook, selezionare un adattatore compatibile. Fare riferimento alla guida rapida (Tabella delle specifiche degli adattatori per notebook), alla brochure all'interno della confezione oppure visitare il sito [www.philips.com](http://www.philips.com) (cercare la sigla SPJ7100) per trovare l'adattatore corretto.

Questo prodotto è destinato solo alla vendita al di fuori degli Stati Uniti. Solo per la vendita al di fuori degli Stati Uniti.

### 3 Risoluzione dei problemi

| Problemi   | Cause   | Soluzioni   |
|--|---|---|
| L'adattatore di alimentazione per notebook non funziona correttamente (oppure la spia a LED è accesa ma il notebook non viene caricato correttamente).                                     | L'adattatore selezionato potrebbe non essere compatibile con il notebook a cui viene collegato.                                 | Assicurarsi di collegare l'adattatore corretto seguendo l'elenco di riferimento posto sul porta-adattatori, la brochure all'interno della confezione oppure andare sul sito <a href="http://www.philips.com">www.philips.com</a> (Search > SPJ7100) per l'elenco degli adattatori aggiornato. |
| L'adattatore di alimentazione portatile per notebook si surriscalda e il notebook non viene caricato correttamente (oppure la spia a LED lampeggia mentre viene fornita alimentazione CA). | L'adattatore di alimentazione portatile per notebook è collegato a un notebook con alimentazione in entrata superiore (> 65 W). | Il notebook viene comunque caricato. L'adattatore di alimentazione portatile per notebook funzionerà nuovamente dopo essersi raffreddato.   |
| Non sono sicuro che la tensione dell'adattatore sia compatibile con il mio notebook.   | N/D   | Sugli adattatori vengono riportate le tensioni (ad esempio 16V, 19 V, ecc...)   |

### 4 Riciclaggio

Questo prodotto è stato progettato e realizzato con materiali e componenti di alta qualità, che possono essere riciclati e riutilizzati. Se su un prodotto si trova il simbolo di un bidone con ruote, ricoperto da una X, vuol dire che il prodotto soddisfa i requisiti della Direttiva Comunitaria 2002/96/CE:



Non smaltire questo prodotto con i rifiuti domestici. Informarsi sui regolamenti locali per la raccolta differenziata dei prodotti elettrici ed elettronici. Il corretto smaltimento dei prodotti usati contribuisce a prevenire potenziali effetti negativi sull'ambiente e sulla salute.



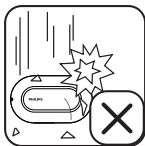
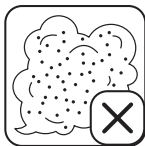
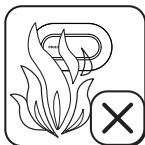
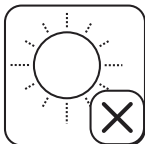
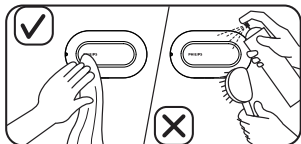



© 2010 Koninklijke Philips Electronics N.V.  
All rights reserved.

Specifications are subject to change without notice. Trademarks are the property of Koninklijke Philips Electronics N.V. or their respective owners.

Служба підтримки споживачів

тел.: 0-800-500-697

(дзвінки зі стаціонарних телефонів на території України безкоштовні)

для більш детальної інформації завітайте на [www.philips.ua](http://www.philips.ua)

Компанія Philips встановлює строк служби на даний виріб – не менше 3 років

Изготовитель

Хийжоу Скай Форчун Електроникс Ко.

Лтд Донжуань Индастриал Эстейт,

Шуилоу Стрит, ХийЖу, Гуаньдун, Китай

SPJ7100\_10\_V1.1



100% recycled paper  
100% papier recyclé