

# Quick start guide

EN

Philips Tapster

Bluetooth stereo headset

SHB7110



## Welcome!

Spend 2 minutes with this Quick Start Guide for the fastest path to wireless music and calls.

For the full user manual, please check the CD.

## Enjoy!

# Pair your headset before you use it

1

Charge your new Philips headset. Make sure the power is turned off.

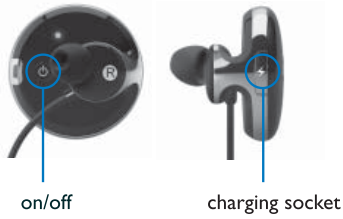

2

Turn your mobile phone on. Make sure *Bluetooth* is enabled.

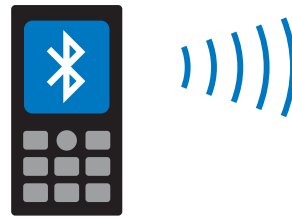

3

Press and hold  on the right earpiece until the LED starts blinking red and blue alternately.



4

Pair the headset with your mobile phone. A sample pairing is shown below. Enter "0000" if a PIN number is needed.

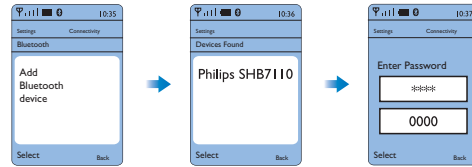

Check your phone's user manual for specific details.

# Fit your headset

1

Select your cap size for the best fit and optimum sound performance.

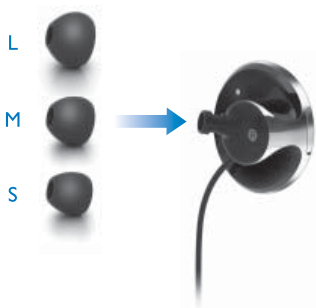

2

Place the earbud in your ear, and rotate the headset backward for a snug fit.

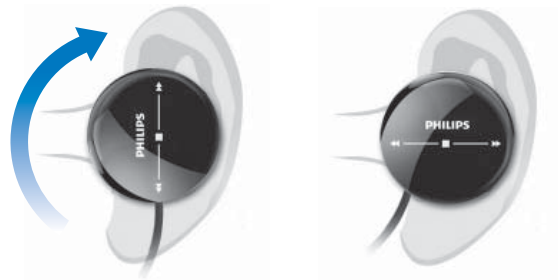

3

Bring the connecting wire to the back of the neck, and insert the second earpiece.



## Optional

For an extra-secure fit, attach the earhook.



A. Insert the ball joint.  
B. Rotate the hook to fit your ear. Slide the hook over your ear. Follow steps 2 and 3 as above.

# Using the touch controls

1

Turn on the headset.  
(Press  on the right earpiece until the LED lights up blue.)

2

Put on your headset.

3

The touch sensors are only active when the earbuds are in your ears.  
Listen for the activation tone.

4

Touch the surface of the left or right earpiece to control the headset.

## Touch sensitive surface



## Motions

- Tap  
Tap the surface
- Double tap  
Tap the surface twice quickly
- Press  
Press and hold for approximately 1 second

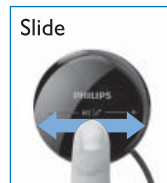

- ↔ Slide your finger forward or backward across the surface of the earpiece

## Left



## Right



## Power

N/A

On/off

Press 

## Music

Stop	—
Next song / previous song	↔
FullSound (natural / dynamic bass)	•• while music is playing

Play / Pause	•
Volume up / down	↔

## Calls

N/A

Answer call	•
Hang up / Reject call	—
Volume up / down	↔
Redial last no.	••
Activate voice dial	—
Transfer call to phone / headset	Remove / insert earpiece
Mute mic	•• during call

Issue	Problem	Tip
<b>Bluetooth headset does not switch on.</b>	Battery is very low.	Charge your Bluetooth headset.
<b>No connection to mobile phone.</b>	Bluetooth disabled.	Enable Bluetooth on your mobile phone and turn the headset on after turning on the phone.
<b>Headset falls out of ear / does not fit properly.</b>	Earbud does not fit.	Fit the correct ear bud size for each ear and check page 2 for the "insert & twist" fitting motion. Try the earhook for an extra-stable fit.
<b>Touch controls do not work.</b>	Out-of-ear autolock engaged.	Touch controls will only work after the headset is inserted into your ear. Listen for the ascending activation sound when inserting each earbud. Try to re-insert your earbud if you did not hear the activation sound.
<b>Touch controls are too sensitive / not sensitive enough.</b>	Familiarity with touch controls.	For the first few minutes you may find the headsets touch controls too sensitive or not sensitive enough. The sensitivity of the touch controls has been set to suit a range of customers. It may require a few minutes of "training" with your headset to get used to the new controls.
<b>Mobile phone cannot find headset.</b>	The headset may be connected to another previously paired device.	Turn the currently connected device off or move it out of range.
	Pairings may have been reset or headset has been previously paired with other device.	Start the pairing process as described in this user manual.
<b>Voice dial or redial does not work.</b>	Your mobile phone may not support this feature.	
<b>The headset is connected to a Bluetooth stereo (A2DP profile) enabled phone, but music will play on the phone's speaker only.</b>	Phone may have option to listen to music via speaker or headset.	Check your phone's user guide on how to transfer the music to the headset.
<b>Audio quality when streaming from phone is very low or audio streaming does not work at all.</b>	Phone may not be Bluetooth Stereo (A2DP profile) compatible and only support Bluetooth mono (HSP/HFP profile).	Check your phone's compatibility.
<b>Audio quality is poor and crackling noises can be heard.</b>	Bluetooth audio source is out of range.	Reduce the distance between the headset and the Bluetooth audio source, or remove obstacles between them.
<b>I hear but cannot control the music on my device (e.g. skip forward / backward).</b>	The music device does not support this feature (AVRCP profile).	Check the user manual of your audio source.

The Bluetooth word mark and logos are owned by the Bluetooth SIG, Inc. and any use of such marks by Philips Electronics N.V. is under license. Other trademarks and trade names are those of their respective owners.

For an optimal experience register your product at [www.philips.com/welcome](http://www.philips.com/welcome)

© 2009 Koninklijke Philips Electronics N.V. All rights reserved.

Specifications are subject to change without notice. Trademarks are the property of Koninklijke Philips Electronics N.V. or their respective owners.