

PHILIPS

Replacement
shaving heads

Shaver series 7000,
5000

SteelPrecision blades

Fits all S7000

Fits angular-shaped S5000

Not compatible w/ older S5000



SH71/50



Reset your shaver to new

Change heads every 2 years for 100% performance

Within two years, your shaver heads cut 9 million hairs on your face. Replace the shaver heads and get back to 100% performance.

Compatibility

- Compatible with all S7xxx and angular-shaped S5xxx

Powerful shaver, gentle on skin

- Powerful performance in every pass

Easy to use

- Reset your shaver very simply
- Replace the shaver heads and get back to 100% performance

Highlights

Compatible with S7000, S5000



SH71 replacement heads are compatible with all Shavers Series 7000 (S7xxx) and angular-shaped Series 5000 (S5xxx). They are not compatible with the rounded Series 5000, which use SH50 replacement heads instead.

SteelPrecision blades



With up to 90.000 cutting actions per minute, the SteelPrecision blades shave close, cutting more hair per stroke*. The 45 high-performance blades are self-sharpening and made in Europe.

Simple replacement

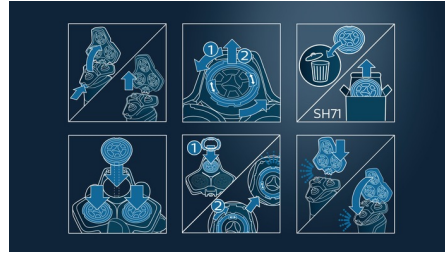

1. Press the release buttons and detach the shaving head holder. 2. Turn the retaining rings counterclockwise and remove them. 3. Remove old shaving heads and insert replacement (notches should fit exactly onto the projections). 4. Place retaining rings back and turn them clockwise until you hear a click. 5. Insert the shaving holder back and close.

Reset your shaver to new

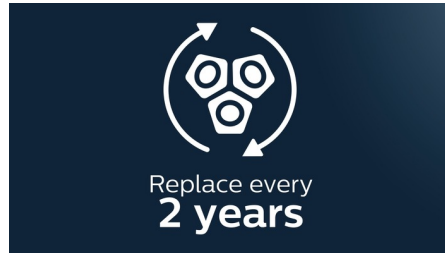

Replace the shaver heads and get back to 100% performance.

Specifications

Shaving heads

Fits product type: All Shaver series 7000, Angular-shaped Series 5000
Shaving heads per packaging: 3

