

Philips GoGear audio player

SA1300  
SA1330  
without FM tuner

SA1305  
SA1333  
SA1335  
with FM tuner

# Quick start guide



- 1** Install
- 2** Connect and charge
- 3** Transfer
- 4** Enjoy

**PHILIPS**

# Need help?

Look up our Support Centre website

[www.philips.com/support](http://www.philips.com/support)

or

Call our Customer Care helpline in your country

# Besoin d'aide ?

Visitez la page Web de notre centre  
d'assistance à l'adresse

[www.philips.com/support](http://www.philips.com/support)

ou

Appelez le centre client de votre pays

# ¿Necesita ayuda?

Consulte nuestra página Web de Soporte técnico,

[www.philips.com/support](http://www.philips.com/support)

o

Llame a nuestra Línea de atención al cliente de su país

# Support?

Besuchen Sie unser Support Center auf

[www.philips.com/support](http://www.philips.com/support)

oder

wenden Sie sich einfach an den telefonischen Kundendienst  
Ihres jeweiligen Landes

Country	Helpdesk	Tariff / min	Keep ready
<b>Europe</b>			
Austria	0820 901115	€0.20	Das Kaufdatum, Modellnummer und Seriennummer
Belgium	070 253 010	€0.17	La date d'achat la référence et le numéro de série du produit
Denmark	3525 8761	Local tariff	Forbrugeren's indkøbsdato, type/model-og serienummer
Finland	09 2290 1908	Paikallinen hinta	Ostopäivä ja tarkka mallinnumero ja sarjanumero
France	08 9165 0006	€0.23	La date d'achat la référence et le numéro de série du produit
Germany	0180 5 007 532	€0.12	Das Kaufdatum, Modellnummer und Serial number
Greek	0 0800 3122 1223	Δωρεάν	Την ημερομηνία αγοράς και Τον ακριβηκωδικό μοντέλου και Τον αριθμό σειράς του προϊόντος σας
Ireland	01 601 1161	Local tariff	Date of Purchase, Model number and Serial number
Italy	199 404 042	€0.25	La data di acquisto, numero di modello e numero di serie
Luxemburg	26 84 30 00	Local tariff	La date d'achat, la référence et le numéro de série du produit
Netherlands	0900 0400 063	€0.20	De datum van aankoop, modelnummer en serienummeret
Norway	2270 8250	Local tariff	Datoen da du kjøpte produktet & modellnummer & serienummeret
Portugal	2 1359 1440	Local tariff	A data de compra, número do modelo e número de série
Spain	902 888 785	€0,15	Fecha de compra y número del modelo y número de serie
Sweden	08 632 0016	Local tariff	Inköpsdatum, modellnummer och serienummer
Switzerland	02 2310 2116	Local tariff	Das Kaufdatum und Modellnummer und Seriennummer
UK	0906 1010 017	£0.15	Date of Purchase, Model number and Serial number
<b>North America</b>			
Canada	1-800-661-6162 (Francophone) 1-888-744-5477 (English / Spanish)	Free	Date of Purchase, Model number and Serial number
USA	1-888-744-5477	Free	Date of Purchase, Model number and Serial number
<b>South America</b>			
Argentina	11 4544 2047	Local tariff	Fecha de compra y número del modelo y número de serie
Brazil	0800 701 02 03 (Except Sao Paulo) 2121 0203 (Sao Paulo)	Free Local tariff	A data de compra, número do modelo e número de série
Chile	600 744 5477	Local tariff	Fecha de compra y número del modelo y número de serie
Mexico	01 800 504 6200	Free	Fecha de compra y número del modelo y número de serie
<b>Asia</b>			
China	4008 800 008	Local tariff	Date of Purchase, Model number and Serial number
Hong Kong	2619 9663	Local tariff	Date of Purchase, Model number and Serial number
Korea	02 709 1200	Local tariff	Date of Purchase, Model number and Serial number

# Contents

EN

- 2 Is there a manual?
- 2 Register your product
- 2 Don't forget about upgrades
- 3 What's in the box
- 4 Overview of controls and connections
- 5 Install
- 5 Connect and charge
- 5 Transfer
- 6 Enjoy
  - 6 Power on and play
  - 6 Navigate root menu
  - 6 Navigate the menu
- 7 Music mode
- 7 Folder view
- 8 Radio mode\*
  - 8 Manual tune
  - 8 Auto tune
  - 8 Play a preset station
- 8 Recordings
  - 8 Make voice recordings
  - 9 Make FM recordings\*
  - 9 Play back recordings
- 9 Troubleshooting
  - 9 How do I reset my player?
- 9 Disposal of your old product

\* FM radio is only available to some regional versions.

# Is there a manual?

You have a detailed user manual and FAQ on the CD by-packed with your GoGear. You can also download the same file from this website: [www.philips.com/support](http://www.philips.com/support)

# Register your product

Since it is possible for you to upgrade your product, we recommend that you register your product on [www.philips.com/register](http://www.philips.com/register) so we can inform you as soon as new free upgrades become available.

# Don't forget about upgrades

We know you will enjoy your product for a long time. For best performance, we recommend that you regularly check in to [www.philips.com/support](http://www.philips.com/support) for free upgrades of the latest software and Firmware Manager for your product. These downloads will help you to optimize your product's performance and to take advantage of our future support of new audio formats.

Enjoy your new music experience.

# What's in the box



Headphones



USB extension  
cable



Neckstrap



CD-ROM



Quick Start Guide

## What else you'll need?



Computer

Computer with:  
Windows XP (SP2 or above)  
Pentium Class 300MHz processor or higher  
CD-ROM drive  
128 MB RAM  
500MB Hard Disk space  
USB Port  
Internet connection (preferable)  
Microsoft Internet Explorer 6.0 or later

# Overview of controls and connections

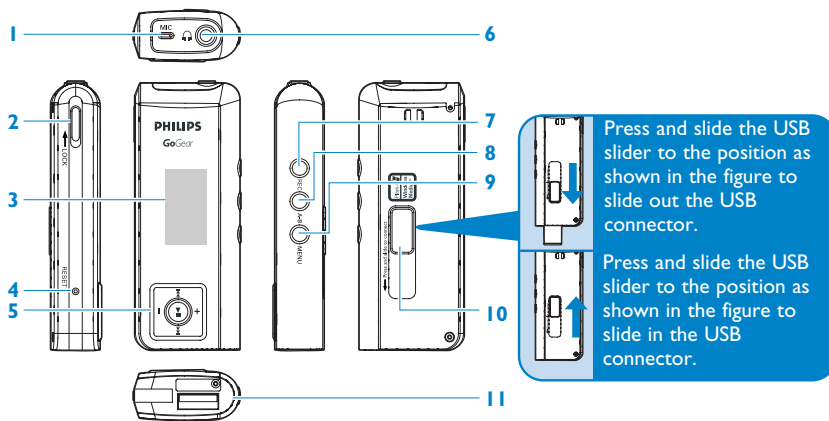

<b>1</b> Mic	Microphone	<b>6</b>	Headphones jack
<b>2</b> LOCK	Disable key press	<b>7</b> REC	Start or stop voice / FM recording
<b>3</b> Display	Dynamically display menu, options and track information	<b>8</b> A-B	Repeat or loop a sequence
<b>4</b> RESET	Reset	<b>9</b> MENU	Access menu options, press and hold to go back to the root menu.
<b>5</b> ►	Power on/off and Play / Pause, confirm a menu setting	<b>10</b> USB slider	Press and slide for USB
◀◀/▶▶	Rewind / Fast forward; Up / Down to 1 level	<b>11</b> USB	USB cable connector
+ / -	Volume control		



# 1 Install

EN

- 1 Insert the CD supplied with your product into the CD ROM drive of your PC.
- 2 Follow the onscreen instructions to complete the installation of **Windows Media Player 10** and **Philips Firmware Manager**.

# 2 Connect and charge

- 1 To charge your player, press and slide out the USB connector.
- 2 Connect your player directly to your computer's USB port.
- 3 Charge your player for 4 hours or until the battery icon  stops blinking.



# 3 Transfer

You can organize files and transfer music to your player during a USB connection session using Windows Explorer.

- 1 In Windows Explorer, select one or more songs on your computer that you want to transfer to your player.
- 2 Use drag and drop actions in Windows Explorer from your computer to your player to complete the transfer. (Ensure that you drop songs into the Media folder and data files into the Data folder only).





# 4 Enjoy

## A Power on and play

To power on, press and hold **▶||** until the PHILIPS splash screen appears.  
To power off, press and hold **▶||** again until there is no display on the screen.

## B Navigate root menu

When your player powers up, you will see the Root menu. You can also press and hold **MENU** to access the root menu. It includes:

	Music	Play your digital music tracks
	Radio	Listen to your radio presets
	Recording	Play and manage recordings
	Folder view	Browse your music tracks or recordings by folders

## C Navigate the menu

Your player has an intuitive menu navigation system to guide you through various settings and operations. Use **+**, **-**, **◀◀**, **▶▶** to browse through menus. Press **▶||** to confirm your selection.



To exit any current mode or play activity, press **MENU** or **◀◀**.

# Music mode (also applicable to playback of recordings)

From the root menu, select **Music** to enter the Music library. Your player will play the music per folder in alphabetical order. Basic operations in music mode include:

Basic operations	Controls to press
Go for next song	Press ►►
Go for previous song	Press ◄◄
Pause music	Press ►   during music playback
Go to next folder	Press and hold ►►
Go to previous folder	Press and hold ◄◄
Volume Control	Press +/-

# Folder view

From the root menu, select **Folder view** to enter the folder view. The Folder view displays your music according to how you arrange them in folders when you transfer them by drag and drop.

Folders and tracks will be listed according to alphabetical order.

Basic operations in Folder View	Controls to press
Go to next track / folder	Press +
Go to previous track / folder	Press -
Go into a folder	Press ►►
Go up one folder level	Press ◄◄
Select an item	Press ►

After selecting an item, a small pop up window comes up. Press +/- to choose **Play** to start playing all the tracks from the selected point in the chosen folder, or delete the chosen item respectively.

# Radio mode\*

(only available to some regions)

From the root menu, select Radio to enter the radio mode.

## Manual tune

- 1 Press **MENU** and select **Manual tune**.
- 2 Press **▶||** to confirm.
- 3 Press **◀◀** or **▶▶** to search the station or press and hold **▶▶** to search for the next available station.
- 4 Press **▶||** to save your preset.

## Auto tune

- 1 Press **MENU** and select **Auto tune**.
- 2 Press **▶||** to confirm.  
> *Your player will automatically select up to 30 strongest available stations.*

## Play a preset station

- 1 From the root menu, select Radio to enter into the radio mode and tune to your preferred station.
- 2 Press **◀◀** or **▶▶** to scroll up or down for your preset.  
> *The preset will be automatically played.*

# Recordings

When your player is not connected to the computer, you can make voice or radio recordings.

## Make voice recordings

- 1 Press **REC** to start voice recording.  
> *Your player shows the recording state.*
- 2 Press **REC** again to stop voice recording  
> *Your player shows the saving state. Your voice recording will be saved in your VOICE folder on your player. (Filename: MIC-XXX.wav where XXX is the track number which is automatically generated.)*

## Make FM recordings\*

- 1 In radio mode, tune to your preset station.
- 2 Press **REC** to start FM recording.
  - > Your player shows the recording state.
- 3 Press **REC** again to stop FM recording.
  - > Your player shows the saving state. Your FM recording will be saved in your FM folder on your player. (Filename: FM-XXX.wav where XXX is the track number which is automatically generated.)

## Play back recordings

You can find your voice recordings and FM recordings in the VOICE and FM folders respectively.

- 1 From the root menu, select **RECORDINGS** to enter into the VOICE / FM library. Your player will play all your recordings alphabetically in the VOICE / FM library as you press **▶||**.
- 2 Press **▶||** to pause the current playing recording.
- 3 Press **◀◀** or **▶▶** to play next or previous recordings.

**Tip** Playback of recordings functions the same way as in the Music mode. See Music mode > Playback section for more information.

# Troubleshooting

## How do I reset my player?

In the unlikely event that your player hangs, do not panic. Simply press the **Reset** button.

## Disposal of your old product



Your product is designed and manufactured with high quality materials and components, which can be recycled and reused.

When this crossed-out wheeled bin symbol is attached to a product it means the product is covered by the European Directive 2002/96/EC

■ Please inform yourself about the local separate collection system for electrical and electronic products.

Please act according to your local rules and do not dispose of your old products with your normal household waste. The correct disposal of your old product will help prevent potential negative consequences for the environment and human health.

\* FM radio is only available to some regional versions.