

PHILIPS

NORELCO



S5280
S5210
S5205

**Rechargeable Cordless
Tripleheader Shaver**

BC

Always here to help you

Register your product and get support at
www.norelco.com/register

Question?
Contact
Philips
Norelco

ENGLISH 4**S5280/S5210/S5205**

Congratulations on your purchase and welcome to Philips Norelco!

To fully benefit from the support that Philips Norelco offers, register your product at www.norelco.com/register

IMPORTANT SAFETY INSTRUCTIONS

When using an electric appliance, basic precautions should always be followed, including the following:

Read all instructions before using this appliance.

DANGER

To reduce the risk of electric shock:

1. Do not reach for a corded shaver that has fallen into water. Unplug immediately.
2. Power plug is not for immersion or for use in shower.
3. Do not use an extension cord with this appliance.
4. Always unplug this shaver from the electrical outlet immediately after use, except when shaver is (re)charging.
5. Unplug and remove power supply cord from shaver before cleaning.
6. The batteries used in this device may present a fire or chemical burn hazard if mistreated. Do not disassemble, heat above 100°C (212°F) or incinerate.

WARNING

To reduce the risk of burns, fire, electric shock, or injury to persons:

1. Close supervision is necessary when this shaver is used by, on, or near children or invalids.
2. Use this shaver for its intended household use as described in this manual. Do not use attachments not recommended by Philips Electronics North America Corporation.
3. Never operate this shaver if it has a damaged cord or charging plug, if it is not working properly, if it has been dropped or damaged, or dropped into water while plugged in. For assistance call 1-800-243-3050.

4. Keep the shaver, cord and charging plug away from heated surfaces.
5. Never drop or insert any object into any opening.
6. Do not use the adapter in or near a power outlet that contains an electric air freshener to prevent damage to the adapter.
7. Do not charge or plug in shaver outdoors or operate where aerosol (spray) products are being used or where oxygen is being administered.
8. Do not use this shaver with a damaged or broken comb, as facial injury may occur.
9. Always attach plug to shaver first, then plug into outlet. Be certain plug is inserted firmly into shaver, up to mark indicated on plug. To disconnect, remove charging plug from outlet.
10. Never put the shaver in direct sunlight or store at a temperature above 140°F (60°C).
11. Keep the cord dry at all times. Do not handle with wet hands.
12. To prevent possible damage to the cord, do not wrap cord around the shaver.
13. Only use the power plug supplied with the appliance.

SAVE THESE INSTRUCTIONS

IMPORTANT: The power plug contains a transformer. Do not cut off the power plug to replace it with another plug, as this will cause a hazardous condition.

PHILIPS

 NORELCO**45 - DAY MONEY-BACK GUARANTEE**

To enjoy the closest and most comfortable shave from your new Philips Norelco Men's Shaver, the shaver should be used **exclusively** for 3 weeks. This allows your hair and skin enough time to adapt to the Philips Norelco Shaving System. If, after that period of time, you are not fully satisfied with your Philips Norelco Men's Shaver, send the product back along with dated sales receipt and we'll refund you the full purchase price. **The shaver must be shipped prepaid by insured mail, insurance prepaid, have the original sales receipt, indicating purchase price, the date of purchase, and the money-back guarantee return authorization form enclosed. We cannot be responsible for lost mail.**

The shaver must be postmarked **no later than 45 days** from the date of purchase. Philips Norelco reserves the right to verify the purchase price of the shaver and limit refunds not to exceed suggested retail price.

To obtain money-back guarantee return authorization form, call 1-800-243-3050 for assistance. Delivery of refund check will occur 6-8 weeks **AFTER** receipt of returned product.

Table of Contents

Features	8-9
LED Display	10-11
Before First Use	11-12
Charging	12-13
Recharging	13
Quick Charge	13
Put It To The Test & Shaving Tips	13-14
How to Shave	
With An Electric Shaver	14-16
Using the SmartClick Trimmer	16-18
Travel Lock	18
Cleaning	19-23
Replacing the Shaving Heads	23-25
Storage	26
Assistance	27
Disposal	27
Accessories	28
Warranty	29

Features

MultiPrecision Blade System

Super Lift and Cut Action

Shaver Head

Release Button

- Hair Chamber captures shaven hair

Electronic On/Off Button

Cleaning Reminder Indicator

Replacement Shaving Heads Indicator

Travel Lock

'Unplug for use' Indicator

Battery Display

- Battery Charge, Full & Low Indicators

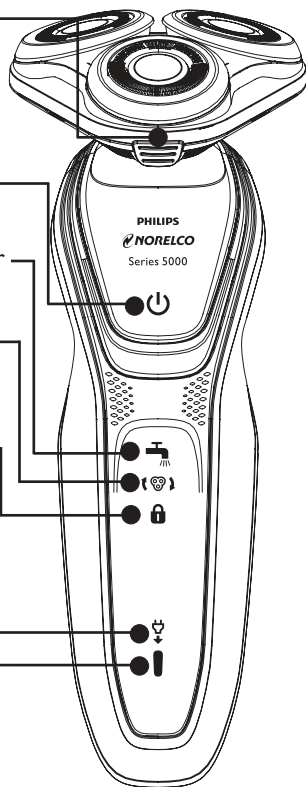

SmartClick Precision Trimmer

Automatic Worldwide Voltage 100V to 240V AC

Protective Cap

Travel Pouch (S\$280)

Rechargeable 1-hour full charge for up to 40 min. (S\$205/S\$210) or 50 min. (S\$280) of cordless shaving time

Quick Charge - For one shave

Cordless - To shave without a cord

Full 2-Year Warranty

45-Day Money-Back Guarantee

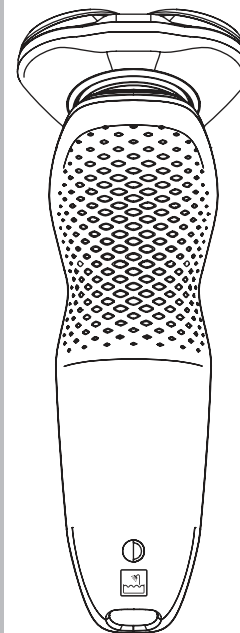

How the Unique Philips Norelco  Lift and Cut Shaving System Makes Close Comfortable:



Groove channels beard closer to cutting system

Lifter raises hair

Slots to cut long hairs

Holes to cut short hairs even closer

LED Display

- ▶ Remove any sticker or protective foil from the display before using shaver.
- ▶ The display provides the following information:

▶ Charging Indicator

- Quick charge: When the shaver does NOT contain enough energy for one shave, the charging light blinks quickly.
- If the shaver does contain enough energy for one shave, the charging light blinks slowly and will continue to blink slowly until fully charged.

▶ Full Charge Indicator

- When the battery is fully charged, the charging light lights up continuously. After approximately 30 minutes the display automatically switches off again.
- If the on/off button is pressed during or after charging, the 'unplug for use' symbol blinks indicating the shaver is still connected to the outlet.

▶ Low Battery Indicator

- When the battery is almost empty (5 or less shaving minutes left), the charging light blinks orange.

▶ 'Unplug For Use' Indicator

- The 'unplug for use' symbol will blink to remind you the shaver is connected to the outlet.

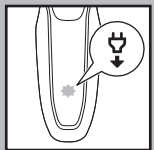
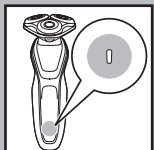
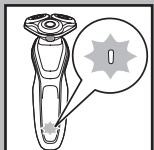

▶ Replacement Shaving Heads Indicator

Every year, depending on your shaving behavior, the replacement shaving heads indicator lights up continuously. See 'Replacing the Shaving Heads' section for instructions to reset the shaver. This reminds you that with new shaving heads you will guarantee yourself optimal shaving performance.

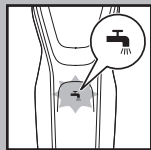

▶ Cleaning Reminder Indicator

For optimal shaving performance, we recommend cleaning the shaver after EACH use. The blinking faucet will remind you the shaving unit needs to be cleaned. This happens after each shave.

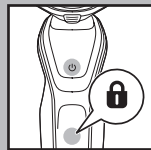

▶ Travel Lock

The shaver is equipped with a travel lock function. You can use the travel lock function when you are going to store the shaver for a longer period or if you are going to take the shaver with you when traveling. See 'Travel Lock' section for instructions on how to use this function.

Before First Use

- ▶ Charge the shaver before you start using it (see 'Charging').
- ▶ Remove any sticker or protective foil from the display before using shaver.

Important

- ▶ Only use the power cord provided to charge the shaver.
- ▶ The power plug transforms 100-240V AC to less than 24V DC.

Charging

- ▶ Charging, recharging or storing at temperatures below 40°F/4,5°C or higher than 95°F/35°C adversely affects lifetime of batteries.
- ▶ Charging or recharging requires one full hour.
- ▶ A fully charged shaver has a shaving time of up to 40 minutes (S5205/S5210) or 50 minutes (S5280).
- ▶ You may recharge when the display indicates the battery is almost empty.
- ▶ This shaver will not operate corded directly from the electrical outlet.
- ▶ Do not charge the shaver in a pouch.

- 1** Connect cord directly to shaver and connect the power plug into any 100V to 240V AC outlet. Use only the power cord provided.

- ▶ An adaptor plug may be necessary for power cord usage in some foreign countries. Use an attachment plug adaptor of the proper configuration for the power outlet.

The power cord will automatically convert to work on 100V to 240V AC systems.

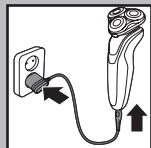

- 2** The display on the shaver will indicate shaver is charging.

- 3** Charging requires one full hour. A fully charged shaver has a cordless shaving time of up to 40 minutes (S5205/S5210) or 50 minutes (S5280).

Recharging

- 1** Recharging requires one full hour. Recharge when the display indicates the battery is almost empty.

Quick Charge

When batteries are empty, recharging the shaver for 5 minutes gives enough energy for one cordless shave.

Put It To The Test & Shaving Tips

- ▶ 21 Day Trial and Conversion Process. It is a fact that your skin and beard need time to adjust to a new shaving system.
- ▶ Use your new shaver exclusively for 3 weeks to fully enjoy the closeness of a Philips Norelco shave
- ▶ At first you may not get as close a shave as you expect, or your face may even become slightly irritated. This is normal since your beard and

skin will need time to adjust. Invest 3 weeks and you'll soon experience the full joy of your new shaver.

- ▶ Stick with it! If you alternate shaving methods during the adjustment period, it may make it more difficult to adapt to the Philips Norelco shaving system.
- ▶ If you are still not convinced after 21 days, Philips Norelco will refund you the full purchase price as long as the request is received within 45 days of purchase.

How To Shave With An Electric Shaver

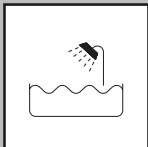

- ▶ This symbol on the shaver indicates that the shaver can be used in the bath or shower.
- ▶ For hygienic reasons, the shaver should only be used by one person.
- ▶ Use this shaver for its intended household use as described in this manual.

Shaving

- ▶ For best results on skin comfort, pre-trim your beard if you have not shaved for 3 days or longer.



- 1** Turn shaver ON by pressing the on/off button once. Shave against the direction of beard growth using only circular movements.

- 2** Stretch your skin with your free hand so blades can lift and cut whiskers. Gently press shaver to skin so the floating heads can follow the contours of your face. **DO NOT** press too hard. Too much pressure can pinch the skin into the combs.
- 3** Turn shaver OFF by pressing the on/off button once.
- 4** Clean the shaver after each use (see chapter 'Cleaning').
- 5** Put the Protective Cap on the shaver to protect shaver heads.

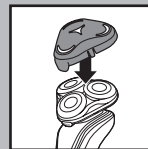

Wet Shaving

You can also use the shaver on a wet face with shaving foam or gel.

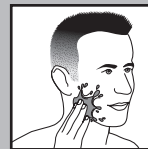

- 1** Apply some water to your skin.



- 2** Apply shaving foam or gel to your skin.



3 Rinse the shaving unit under the tap to ensure that the shaving unit glides smoothly over your skin.

4 Press the on/off button once to switch on the shaver.

5 Move the shaving heads in circular movements over your skin.

NOTE: Rinse the shaver under the tap regularly to ensure that it continues to glide smoothly over your skin.

6 Dry your face and thoroughly clean the shaver after each use (see chapter 'Cleaning').

NOTE: Make sure you rinse all foam or gel off the shaver.

7 Place the Protective Cap on the shaver to protect heads.



Using the SmartClick Trimmer

1 Pull the shaving unit straight off the shaver.
NOTE: Do not turn the shaving unit while you pull it off the shaver.

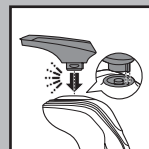

2 Insert the raised notch of the SmartClick trimmer into the slot in the top of the shaver. Press the trimmer down to attach it to the shaver. You will hear a 'click'.

3 Turn shaver ON.

4 Hold trimmer to exact hairline desired. Move trimmer downward with gentle pressure.

5 Trim beard, moustache or sideburns using the trimmer.

6 Turn shaver OFF when finished.

7 Thoroughly clean the trimmer (see 'Cleaning').

8 Pull the trimmer straight off the shaver.
NOTE: Do not turn or twist the trimmer while you pull it off the shaver.

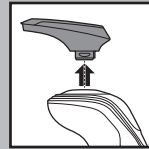

9 Insert the raised notch of the shaving unit into the slot in the top of the shaver. Press the shaving unit down to attach it to the shaver. You will hear a 'click'.



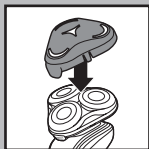

- 10** Put the Protective Shaver Head Cap on the shaver to protect the heads.

Travel Lock

If you are going to store the shaver for a longer time period or if traveling, it is possible to lock the shaver. The travel lock prevents the shaver from being switched on by accident.

Activating the travel lock

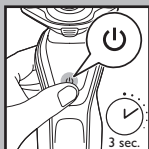

- 1** Press the ON/OFF button for 3 seconds.
 - ▶ The travel lock symbol lights up continuously and the lock symbol blinks.
- 2** The travel lock has now been activated.

Deactivating the travel lock



- 1** Press the ON/OFF button for 3 seconds.
- 2** The lock symbol blinks and then lights up continuously. The shaver is now ready for use.

Cleaning

- ▶ Always clean your shaver after each use.
- ▶ Regular cleaning guarantees better shaving results.
- ▶ Never remove or replace shaving unit while motor is on.
- ▶ Do not apply pressure to shaving head combs. Do not touch shaving heads with hard objects as this may dent or damage precision-made slotted combs.
- ▶ Do not use shaver if shaving head combs are damaged or broken. Facial injury may occur.
- ▶ Do not use abrasives, scourers or aggressive liquids such as gasoline or acetone to clean the shaver.
- ▶ Never dry the shaving unit with a towel or tissue as this may damage the shaving heads.

Cleaning the Shaving Unit

The shaving heads may be quickly cleaned after each use by rinsing with hot water. Water from the tap should be on a hot setting, BUT BE CAREFUL TO TEST WATER FIRST SO AS NOT TO BURN OR SCALD HANDS.

- ▶ Regular cleaning guarantees better shaving results.
- ▶ While rinsing shaving heads, water may drip out of the base of shaver. This is a normal occurrence.



- 1 For best results rinse the shaving unit by running under hot water for a few minutes.



- 2 Press the Shaver Head Release Button to open the shaving unit.

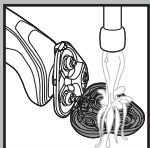

- 3 Rinse the shaving head holder under hot tap water for 30 seconds.

BE CAREFUL TO TEST WATER FIRST SO AS NOT TO BURN OR SCALD HANDS.

- 4 Carefully shake off excess water and let the shaving head holder air dry completely.

- 5 Close the shaving head holder. You will hear a 'click'.

Extra-thorough cleaning method

Do not mix up the cutters and combs as the shaving performance may be adversely affected for several weeks before optimal shaving performance is restored.

- 1 Turn shaver OFF.

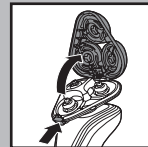

- 2 Press the shaver head release button and open the shaving unit.

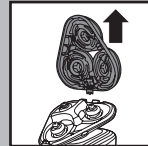

- 3 Pull the shaving head holder off the bottom part of the shaving unit.

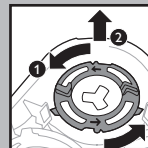

- 4 Turn the retaining ring counterclockwise (1) and lift it off the shaving head (2).

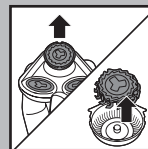

- 5 Remove one shaving head from the shaving head holder. Remove the cutter from the comb.

Do not clean more than one cutter and comb at a time, since they are all matching sets. If you accidentally put a cutter in the wrong comb, it may take several weeks before optimal shaving performance is restored.

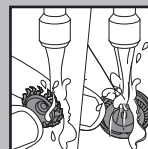

- 6 Clean the cutter and comb under warm tap water.



- 7** After cleaning, place the cutter back into the comb with the cutter legs pointing downwards.

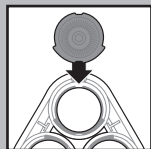

- 8** Put the shaving head back into the shaving head holder.

Make sure the projections of the shaving head fit exactly into the recesses on the shaving head holder.

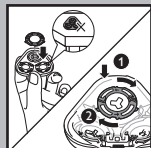

- 9** Hold the shaving head holder in your hand and place the retaining ring on the shaving head holder (1). Turn clockwise (2) to reattach the retaining ring.

Do not place the shaving head holder on a surface, as damage may occur.

- 10** Repeat the process for the other two cutters and combs.

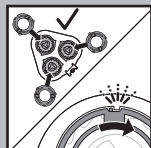

NOTE: Each retaining ring has two recesses and two projections that fit exactly in the projections and recesses of the shaving head holder. Make sure you hear a 'click' indicating the retaining ring is fixed into place.



- 11** Reinsert the hinge of the shaving head holder into the slot of the shaving unit. Close the shaving head holder (click).

Cleaning the Trimmer

Clean the trimmer after each use.

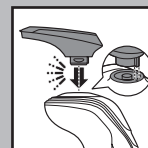

- 1** Attach the trimmer to shaver.

- 2** Turn shaver ON.

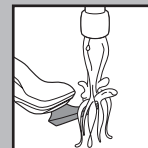

- 3** Rinse the trimmer under hot water. **BUT BE CAREFUL TO TEST WATER FIRST SO AS NOT TO BURN OR SCALD HANDS.**



- 4** Turn the shaver OFF. Shake off excess water and allow trimmer to air dry thoroughly.

Tip: For optimal trimmer performance, lubricate the trimmer teeth with one drop of mineral oil every 6 months.

Replacing the Shaving Heads

- ▶ Replace the shaving heads once a year for optimal shaving results.
- ▶ Replace damaged or worn shaving heads with model SH50 Philips Norelco shaving heads only.

Replacement Shaving Heads Indication



- ▶ The shaving unit symbol lights up continuously when the shaver is turned off to remind you to replace your shaving heads to obtain optimal shaving results.



- 1** Press the shaver head release button to open the shaving unit.

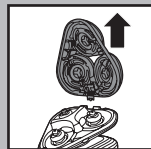

- 2** Pull the shaving head holder off the bottom part of the shaving unit.

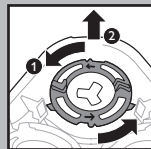

- 3** Turn the retaining ring counterclockwise (1) and lift it off the shaving head (2).

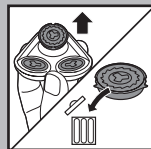

- 4** Remove the shaving heads from the shaving head holder and discard.
DO NOT discard the retaining ring.

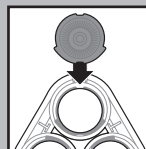

- 5** Place a new shaving head in the holder. Make sure the projections of the shaving head fit exactly into the recesses on the shaving head holder.

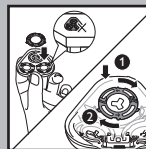

- 6** Hold the shaving head holder in your hand and place the retaining ring on the shaving head holder (1). Turn clockwise (2) to reattach the retaining ring.

Do not place the shaving head holder on a surface, as damage may occur.

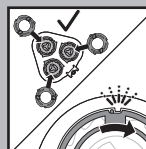

- 7** Repeat this process for the other two cutters and combs.

NOTE: Each retaining ring has two recesses and two projections that fit exactly in the projections and recesses of the shaving head holder. Make sure you hear a 'click' indicating the retaining ring is fixed into place.



- 8** Reinsert the hinge of the shaving head holder into the slot of the shaving unit. Close the shaving head holder (click).

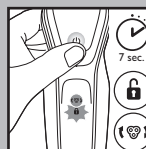

- 9** To reset the shaver, press and hold the On/Off button for approximately 7 seconds. shaving head holder and discard.

This shaver has no other user-serviceable parts. For assistance, call 1-800-243-3050.

Storage

- ▶ The shaver can be placed in the travel pouch for safe storage (S5280).
- ▶ Be sure shaver is turned off. Remove cord from outlet before storing in a safe, dry location where it will not be crushed, banged, or subject to damage.
- ▶ Do not wrap power cord around shaver when storing.
- ▶ Store cord in a safe location where it will not be cut or damaged.
- ▶ Do not place or store shaver where it can fall or be pulled into a tub or sink, water or other liquid while plugged in.
- ▶ Put the Protective Cap on shaver to protect heads.



Assistance

- ▶ For assistance, visit our website:

**www.philips.com/support or
call toll free 1-800-243-3050**

- ▶ Online information is available 24 hours a day, 7 days a week.

Disposal



- ▶ This Philips Norelco shaver contains a rechargeable lithium-ion battery which must be disposed of properly.
- ▶ Contact your local town or city officials for battery disposal information or call 1-800-8-BATTERY or www.rbrc.com for battery drop-off locations.
- ▶ For assistance, visit our website, www.philips.com/support or call toll free: 1-800-243-3050.

Accessories

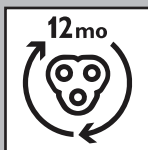

- ▶ **Replacement Shaving Heads**
Model SH50 - For maximum shaver performance, replace your Philips Norelco shaving heads once a year.
- ▶ **SmartClick Cleansing Brush**
Model RQ585 - Philips Norelco SmartClick Cleansing Brush
- ▶ **Philips Norelco Shaver Accessories may be purchased at a store near you, or on our website www.philips.com/store**

FULL TWO YEAR WARRANTY

Philips Electronics North America Corporation warrants each new Philips Norelco Product, Models S5280/S5210/S5205 (except cutters and combs) against defects in materials or workmanship for a period of two years from the date of purchase, and agrees to repair or replace any defective product without charge.

IMPORTANT: This warranty does not cover damage resulting from accident, misuse or abuse, lack of reasonable care, the affixing of any attachment not provided with the product or loss of parts or subjecting the product to any but the specified voltage.*

NO RESPONSIBILITY IS ASSUMED FOR ANY SPECIAL, INCIDENTAL OR CONSEQUENTIAL DAMAGES.

In order to obtain warranty service, simply go to www.philips.com/norelco or call 1-800-243-3050 for assistance. It is suggested that for your protection you return shipments of product by insured mail, insurance prepaid. Damage occurring during shipment is not covered by this warranty.

NOTE: No other warranty, written or oral, is authorized by Philips Electronics North America Corporation.

This warranty gives you specific legal rights, and you may also have other rights which vary from state to state. Some states do not allow the exclusion or limitation of incidental or consequential damages, so the above exclusion and limitations may not apply to you.

* Read enclosed instructions carefully.

Manufactured for:

Philips Consumer Lifestyle

A Division of Philips Electronics North America Corporation
P.O.Box 10313, Stamford, CT 06904



This symbol on the product's nameplate means it is listed by Underwriters' Laboratories, Inc.

Norelco, Tripleheader, Lift and Cut, and  are Registered Trademarks of Philips Electronics North America Corporation.



is a Trademark of Philips Electronics North America Corporation.

PHILIPS is a Registered Trademark of Koninklijke Philips N.V.