



#### Shaving unit

- V-Track Precision Blades PRO
- 8-direction ContourDetect Heads
- Fits SensoTouch 3D (RQ12xx)
- Fits Arcitec (RQ10xx)

RQ12/70

## Reset your shaver to new

Change heads every 2 years for the best results

Within two years your shaver heads cut 9 million hairs on your face. Replace the shaver heads and get back to 100% performance.

#### Benefits

##### Compatibility

- Replacement shaving unit for SensoTouch 3D shavers

##### Perfection in every pass

- Our best shaving system on 1–3-day beards
- Heads flex in 8 different directions for a superb result

##### Easy to use

- Easy to replace shaving heads
- Reset your shaver after replacing shaving heads
- Reset your shaver to new

**PHILIPS**

## Features

### Compatible with SensoTouch 3D



RQ12 shaving unit is compatible with SensoTouch 3D (RQ12xx) and Arcitec (RQ10xx) shavers.

### V-Track blade system PRO



Get the perfect close shave. The V-Track Precision PRO Blades gently position each hair in the best cutting position, from 1-day to 3-day beards, including flat-lying hairs and hairs of different lengths. Cuts 30% closer\* in fewer strokes, leaving your skin in great condition.

### 8-direction ContourDetect Heads



Follow every contour of your face and neck with 8-directional ContourDetect heads. You'll catch 20% more hairs with every pass, resulting in an extremely close, smooth shave.

### Simple replacement

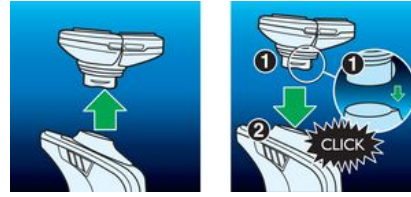

Easily renew your shaving unit using our click off, click on system.

### How to reset your shaver



The latest Philips shavers have an inbuilt replacement reminder, which will tell you when to replace the shaving heads. After replacing the shaving heads, you can reset the replacement trigger by pressing the on/off button for more than 5 seconds. Otherwise, the replacement trigger will be turned off automatically after 9 successive shaves.

### Reset your shaver to new



To get back to 100% performance, replace your shaving heads every 2 years.

## Specifications

Please note that this is a pre-sales leaflet. The contents of this leaflet reflect the best of our knowledge per date and country mentioned above. The contents of this leaflet are subject to change without notice. Philips does not accept any liability as to the contents of this leaflet.

### Shaving heads

Fits product type SensoTouch 3D (RQ12xx)  
arcitec (RQ10xx)

### Accessories

Included in pack Retaining ring holder  
Protective cap

### Packaging dimensions

Height 11.40 cm  
Width 9.90 cm  
Depth 3.80 cm  
Net weight 0.04 kg  
Gross weight 0.07 kg  
EAN 08710103790433

Number of products 1  
included  
Country of origin NL  
Harmonised Systems Code 851090

### Outer Carton

Length 12.40 cm  
Width 10.40 cm  
Height 12.40 cm  
Gross weight 0.26 kg  
EAN 18710103790430  
Number of consumer packages 3

\* Versus its Philips predecessor



data subject to change  
2019, May 23  
Version: 8.2.1  
EAN: 08710103790433

© 2019 Koninklijke Philips N.V.  
All rights reserved.

Specifications are subject to change without notice. Trademarks are the property of Koninklijke Philips N.V. or their respective owners.

[www.philips.com](http://www.philips.com)