

# PHILIPS

shaving heads

TripleTrack

Replacement unit

RQ10/50



## Keep a close shave

Change heads every 2 years for the best results

Within two years your shaver heads cut 9 million hairs on your face. Replace the shaver heads and get back to 100% performance

### **Comfortably close**

- Super Lift & Cut shaving technology with dual blade system

### **A fast and close shave**

- Triple-Track shaving heads with 50% more shaving surface

### **Perfectly close, even on the neck**

- Flex and Pivot Action follows every curve

### **Simple replacement**

- Easy click off, click on

# Highlights

## Triple-Track shaving heads



The three shaving tracks of the Triple-Track shaving heads offer 50% more shaving surface than standard, single track rotary shaving heads.

## Flex and Pivot Action



Three independently flexing heads in a shaving unit that swivels with full range of motion. This unique combination ensures optimum skin contact in curved areas to catch even the most problematic neck hair.

## Super Lift & Cut technology

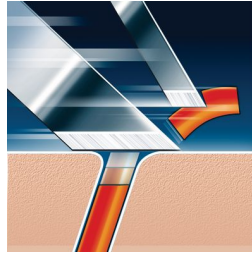

Dual-blade system of your Philips shaver: first blade lifts, second blade cuts for a comfortable close shave.

## Easy click off, click on

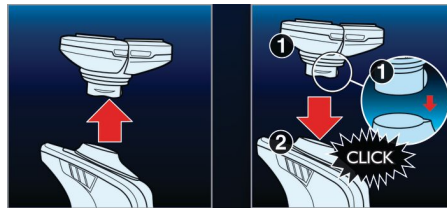

Easily renew your shaving unit using our click off, click on system.

# Specifications

## Shaving heads

Fits product types: RQ1050, RQ1060, RQ1075, RQ1085, RQ1095, RQ1051, RQ1052, RQ1053, RQ1061, RQ1062, RQ1076, RQ1077, RQ1087, RQ1090

Shaving units per packaging: 1

