

# Quick start guide

Register your product and get support at  
[www.philips.com/welcome](http://www.philips.com/welcome)

## 1 Charge the battery

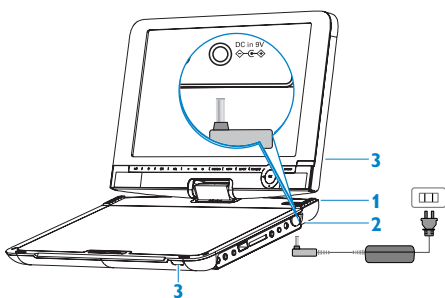

- 1 Turn **OFF** the set.
- 2 Connect the supplied AC adaptor to the set and to the AC outlet.
  - The **CHG** indicator turns red. It takes about 5 hours to fully charge the battery.
  - When the battery is fully charged, the indicator turns off.

### TIP

Your battery will continue to charge while the player is in use. However, the charge indicator will not turn off and it will take approximately 12 hours to fully charge the battery pack.

## 2 Enjoy DVD

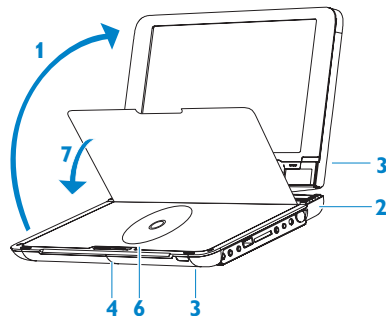

- 1 Open the lid of the player.
- 2 Press **POWER**.
  - The **POWER** indicator turns on.
- 3 Slide **OPEN** to open the disc door.
- 4 Remove protective card (if any) and load a disc with the label side facing up.
- 5 Close the disc door.
  - Play starts automatically.
  - To stop, press ■.

## 3 Setup DTTV



- 1 Before you start searching TV channels, connect your player to the antenna as shown.
- 2 Press **SETUP** > **TV & Radio** > **Country**.
- 3 Press **SETUP** > **Channel Setup** > **Auto Search**.
- 4 Enjoy the TV program by using the control key on the remote.

**TIPS** Auxiliary antenna is used when there is excellent signal coverage. There is magnet at the bottom of the auxiliary antenna. For better reception, fix it onto a metallic surface. For best reception, connect the PET1046 to the home antenna.

No/Weak signal displayed on the screen

- 1 DVB-T signal is too weak, or product is out of the DVB-T signal covering area.
- 2 Make sure you are in an area with sufficient coverage.
- 3 Receiving DVB-T in a moving car may cause signal problems.

**NOTE** When travelling to another country, it is possible to lose current TV programs. Carry out an auto search by following the above steps.

## 4 Swiveling LCD screen

You can swivel the LCD screen of this player clockwise a maximum of 180° for use.

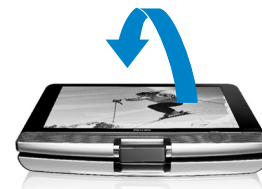

# PHILIPS