

Quick Start Guide



Step A *Connect*

Step B *Setup*

Step C *Enjoy*

What's in the Box?

You should find these items upon opening the box.



1 x AC power cable

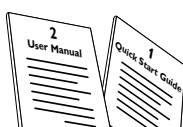

Quick start guide
User manual

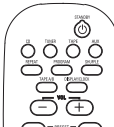

Remote control with
2 AA batteries

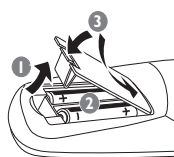

1 x FM wire antenna

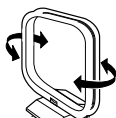

1 x MW loop antenna

PHILIPS

Step A *Connect*

- 1 Connect the speaker cables.
- 2 Connect the MW and FM antennas.
- 3 Connect the supplied AC power cable to the main unit and the wall socket.

Tip
See the User Manual on how to connect other equipment to this system.

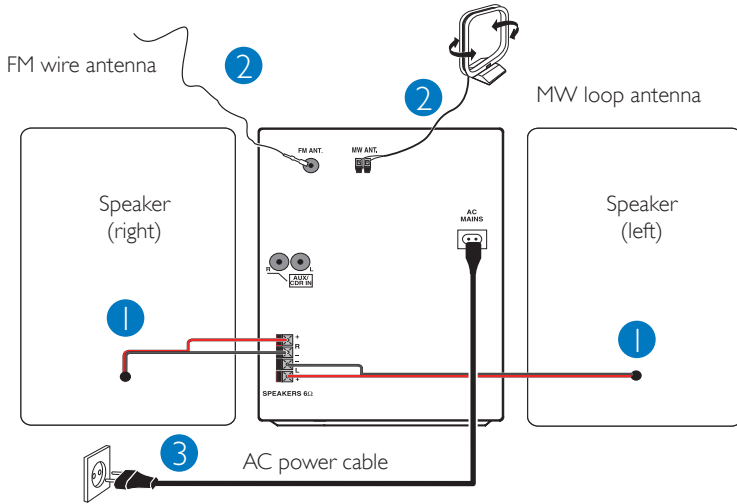

Step B *Setup*

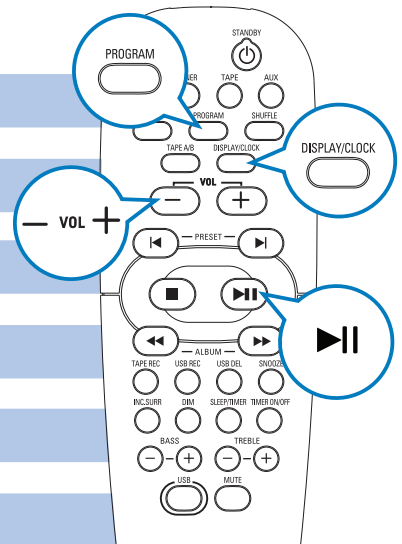

Set clock

- 1 In the standby mode, press **DISPLAY/CLOCK** to activate the clock setting mode.
- 2 Press **PROGRAM** repeatedly to select 12 hour or 24 hour format.
- 3 Press **VOL +/-** to set the hour.
- 4 Press **▶||** to confirm.
- 5 Press **VOL +/-** to set the minute.
- 6 Press **DISPLAY/CLOCK** to confirm.



Step C Enjoy

Play disc

- 1 Press **CD** to select the disc source.
- 2 Press **OPEN/CLOSE**  on the main unit to open the disc compartment.
- 3 Insert a disc with the printed side facing up, then close the disc compartment.
- 4 If the disc doesn't play, press .
- 5 To stop play, press .

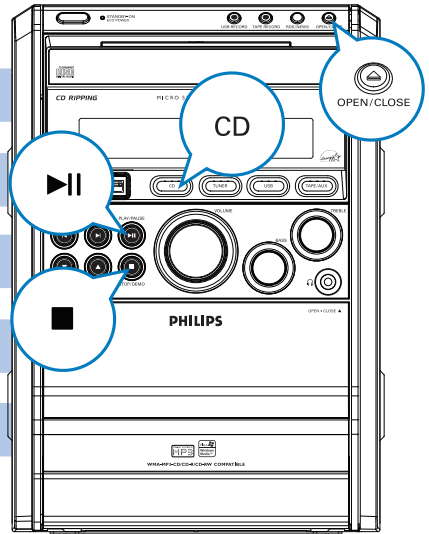

Listen to radio

- 1 Press **TUNER** repeatedly to select FM or MW.
- 2 Press **PROGRAM** for more than two seconds to program all available stations in order of waveband.
- 3 Press **PRESET**  to select a preset number.

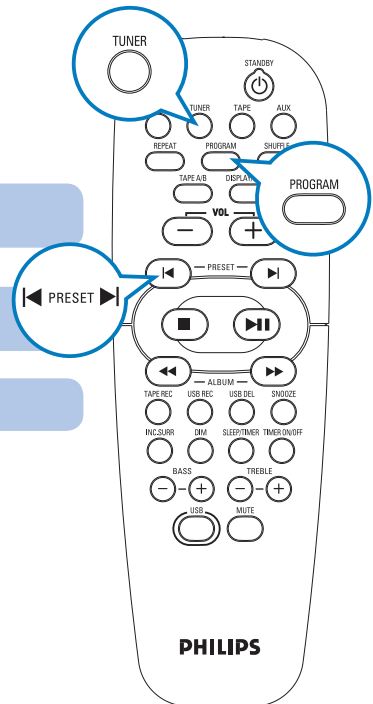

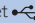

Play USB

With this Hi-Fi, you can use USB flash memory (USB 2.0 or USB1.1), USB flash players (USB 2.0 or USB1.1), memory cards (requires an additional card reader to work with this Mini Hi-Fi).

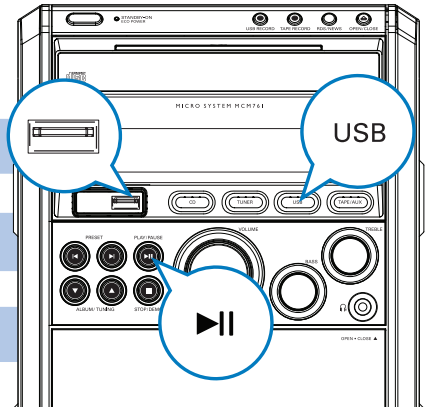
- 1 Insert the USB device into the socket  on the main unit.
- 2 Press **USB** to select the USB source.
- 3 Play the USB's audio files as you do with the albums/tracks on a CD.

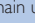

USB record

- 1 Insert the USB device into the socket  on the main unit.
- 2 Load a disc.
- 3 Press **USB RECORD** to start recording.
- 4 To stop recording, press .

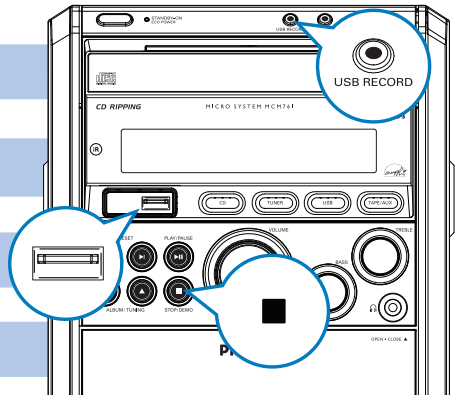

Tip

Detailed play features and additional functions are described in the supplied user manual.

