

Quick Start Guide



Step A **Install**

Step B **Prepare**

Step C **Enjoy**

What's in the Box?

You should find these items upon opening the box.

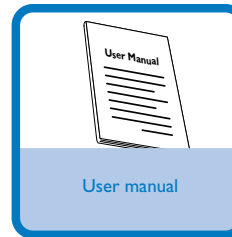
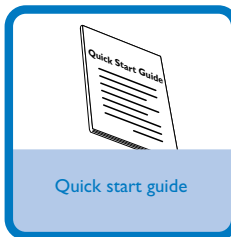
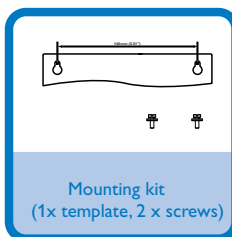
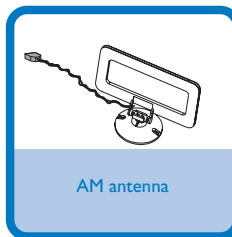
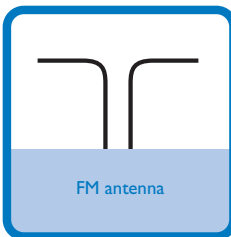
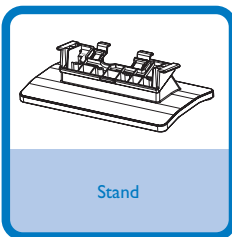

PHILIPS

Step A **Install**

Mounting stand onto the set

- 1 Put MCM276R on a flat and firm surface, rear side facing up
- 2 As shown, align the stand to the slots at set's bottom, ▼ **FRONT** facing down
- 3 Push the stand down into the slots

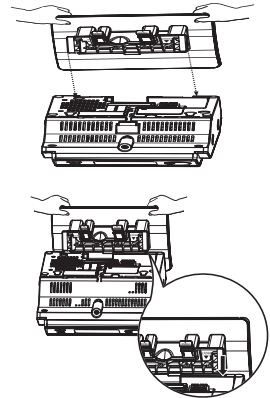

Helpful hints:

- For wall mounting, please refer to the **User Manual, Appendix: How to mount your MCM276R onto Walls**. You may need assistance from the qualified service personnel.

Rear connections

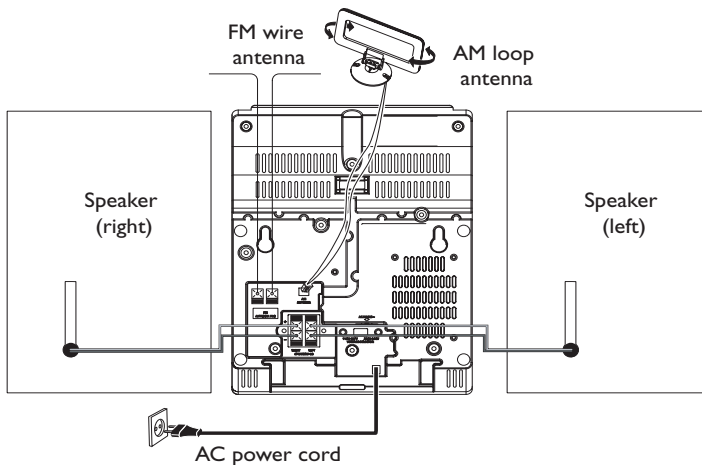

- 1 Connect the cable of the left speaker to **LEFT** (red and black) and the cable of the right speaker to **RIGHT** (red and black)
- 2 Extend the wire antenna and fit it to **FM ANTENNA**
- 3
 - a. Assemble the loop antenna
 - b. Fit the plug of the loop antenna to **AM ANTENNA**
- 4 Connect the AC power cord to the wall socket

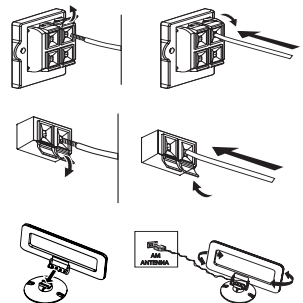

Step B Prepare

Setting the clock

- 1 Press and hold **STANDBY-ON**  to switch the set to Standby mode
→ The display shows the set time
→ --:--:-- flashes by default if you have not set the clock
- 2 In the standby mode, press and hold **DISPLAY/CLOCK** on the remote control
→ 12 HR or 24 HR appears for the initial clock setting. **To select 24-hour clock or 12-hour clock,**
a. Press **VOLUME +/-** once or more
b. Press **DISPLAY/CLOCK** to confirm
→ The hours digits start flashing
- 3 Hold down or press **VOLUME +/-** repeatedly to set the hours
- 4 Press **DISPLAY/CLOCK** to confirm
- 5 Hold down or press **VOLUME +/-** repeatedly to set the minutes
- 6 Press **DISPLAY/CLOCK** to confirm

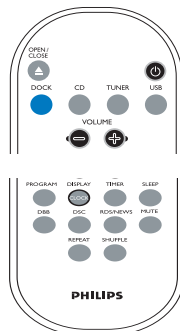

IMPORTANT!
– Remove the protective plastic tab before using the remote control

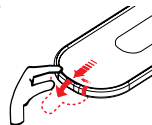



Notes for remote control:

- First, select the source you wish to control by pressing one of the source select keys on the remote control (DISC or TUNER, for example).
- Then select the desired function (▶||, ◀, ▶ for example).

Step C Enjoy

Playing discs

With this system, you can play all pre-recorded audio CDs (CDDA), all finalized audio CD-Rs and CD-RWs, MP3/WMA-CDs (CD-Rs/CD-RWs with MP3/WMA files)

- 1 Press **SOURCE** once or more to select **CD** (or **CD** on the remote control)
- 2 Press **CD OPEN•CLOSE**  to open the CD compartment
- 3 Insert a disc with the printed side facing up. Press **CD OPEN•CLOSE**  again to close the compartment
- 4 Press **▶ ||** to start playback
- 5 To stop playback, press **STOP** 

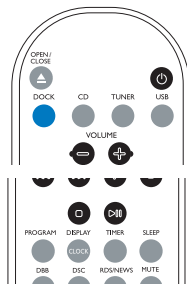
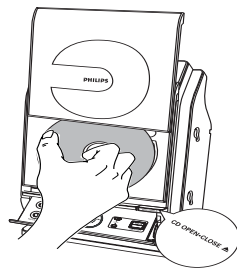

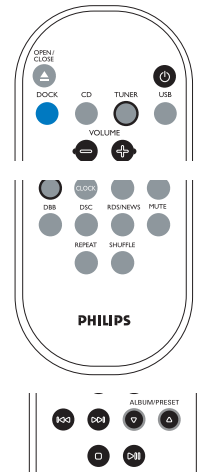

Tuning to radio stations

- 1 Press **SOURCE** once or more to select **TUNER** (or **TUNER** on the remote control)
- 2 Press and hold **PROGRAM** until **AUTO** appears
→ **PD** flashes. Available stations are programmed: FM stations followed by AM stations
- 3 Press the **ALBUM/ PRESET** buttons once or more until the desired preset station is displayed



Playing a USB mass storage device

With the Hi-Fi system, you can use USB flash memory (USB 2.0 or USB1.1), USB flash players (USB 2.0 or USB1.1), memory cards (requires an additional card reader to work with this Hi-Fi system).

- 1 Check you have unfolded the control panel
- 2 Insert the USB device's USB plug into the socket  on the set 's foldable control panel
- 3 Press **SOURCE** once or more to select **USB** (or **USB** on the remote control)
- 4 Play the USB's audio files as you do with the albums/tracks on a CD
- 5 Press **STANDBY-ON**  to switch off the set

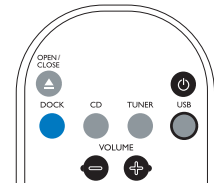
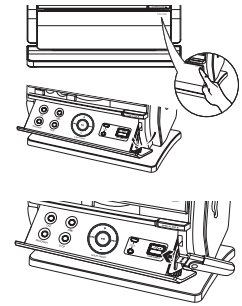

Tips

- Detailed playback features and additional functions are described in the accompanied owner's manual.
- Refer to the user manual for how to use the DOCK functions.

