

# Quick Start Guide



Step A *Setup*

Step B *Enjoy*

## What's in the Box?

You should find these items upon opening the box.

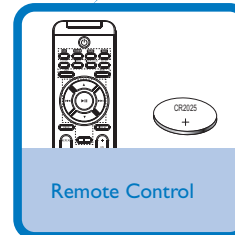
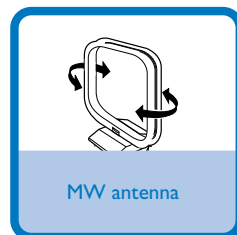
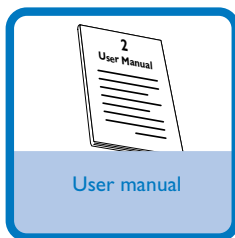
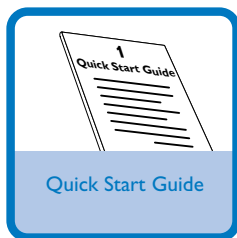

Pull out the insulation plastic sheet.

# PHILIPS



## Step B

## Enjoy

### Playing a disc

- 1 Select **CD** source.
- 2 Press **OPEN•CLOSE** on the top of the system to open the CD door.
- 3 Insert a disc with the printed side facing up and press down on **OPEN•CLOSE** to close the CD door.
- 4 Press **▶ ||** to start playback.
- 5 Press **■** to stop playback.

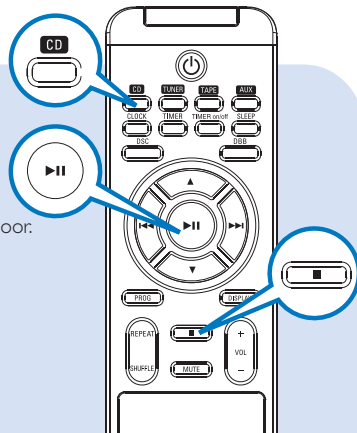

### Programming and tuning to radio stations

- 1 Select **TUNER** source.
- 2 Press **PROG** on the set for more than two seconds to program all available stations in order of waveband.
- 3 Press **ALBUM/PRESET ▼ ▲** until the desired preset station is displayed

#### Tip

Detailed playback features and additional functions are described in the accompanied owner's manual.

#### Notes for the remote control:

- First, select the source you wish to control by pressing one of the source select keys on the remote control (DISC or AUX, for example).
- Then select the desired function (▶ ||, ◀, ▶ for example).

