

# Quick Start Guide



Step A **Connect**

Step B **Setup**

Step C **Enjoy**

## What's in the Box?

You should find these items upon opening the box.

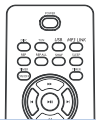

Remote Control

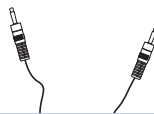

1 x MP3 link cable



Quick Start Guide



User Manual

**PHILIPS**

## Step A *Connect*

- 1 Connect the speaker cables.
- 2 Connect the AC power cord to the wall socket.

*Tip*  
See the *User Manual* on how to connect other equipment to this system.

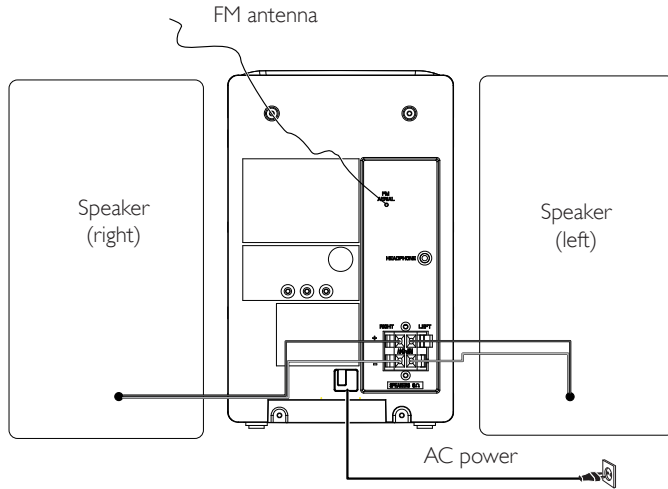

## Step B *Setup*

### Set clock

- 1 Press and hold **CLOCK** (or **CLOCK/DISPLAY** on the remote control) to activate the clock setting mode.  
→ The 12 hour or 24 hour format is displayed.
- 2 Press **PROG** repeatedly to select 12 hour or 24 hour format.
- 3 Press **CLOCK** (or **CLOCK/DISPLAY** on the remote control) to confirm.  
→ The hour digits are displayed and begin to blink.
- 4 Press **▶▶ / ◀◀** (or **◀◀ / ▶▶** on the remote control) to set the hour.
- 5 Press **CLOCK** (or **CLOCK/DISPLAY** on the remote control) to confirm.  
→ The minute digits are displayed and begin to blink.
- 6 Press **▶▶ / ◀◀** (or **◀◀ / ▶▶** on the remote control) to set the minute.
- 7 Press **CLOCK** (or **CLOCK/DISPLAY** on the remote control) to confirm.

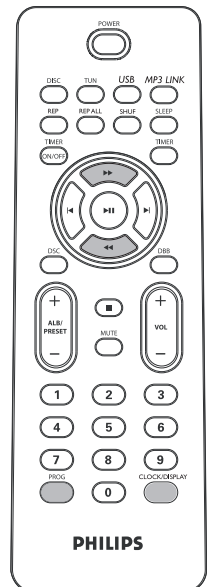

# Step C Enjoy

## Play disc

1 Press **SOURCE** (or **DISC** on the remote control) to select the disc source.

2 Lift the top panel to open the disc tray.

3 Insert a disc with the printed side facing up, then close the disc tray.

4 Press **▶||** to start play.

5 To stop play, press **■**.

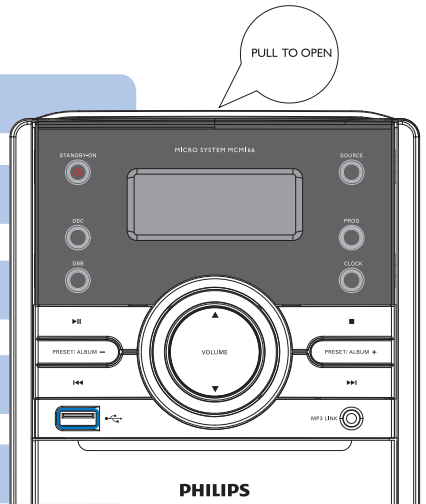

## Play USB

With the Hi-Fi system, you can use USB flash memory (USB 2.0 or USB1.1), USB flash players (USB 2.0 or USB1.1), memory cards (requires an additional card reader to work with this Hi-Fi system).

1 Insert the USB device's USB plug into the socket  on the main unit.

2 Press **SOURCE** once or more (or **USB** on the remote control) to select **USB**.

3 Play the USB's audio files as you do with the albums/tracks on a CD.

# Step C *Enjoy*

## *Listen to radio*

- 1 Press **SOURCE** (or **TUN** on the remote control) repeatedly to select FM or MW.
- 2 Press **PROG** for more than two seconds to program all available stations in order of wave-band.
- 3 Press **PRESET/ALBUM +/-** (or **ABL/PRESET +/-** on the remote control) to select a preset number.

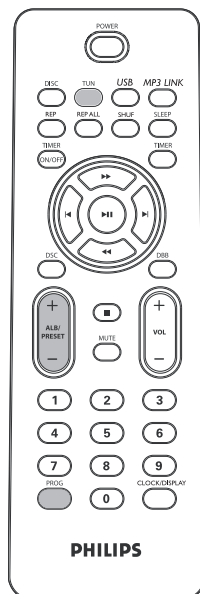

### *Tip*

*Detailed play features and additional functions are described in the supplied user manual.*



© Royal Philips Electronics N.V. 2009  
All rights reserved.

<http://www.philips.com>

