

# Quick Start Guide

Step A *Setup*

Step B *Enjoy*

## What's in the Box?

You should find these items upon opening the box.

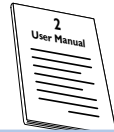

User Manual



Quick Start Guide



Pull out the insulation plastic sheet.



Remote Control

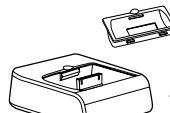

iPod Dock  
& 4 Dock Adaptors



MW Antenna

**PHILIPS**

# Step A

# Setup

## Connection

- 1 For radio reception, connect the supplied MW antenna to the **MW aerial** terminal.
- 2 Connect the speaker wires to the **SPEAKERS** terminals.
- 3 Connect the power cord of the system to the AC power outlet.

### Tip

*It is unnecessary to connect the FM pigtail antenna since it is fixed to the main unit.*

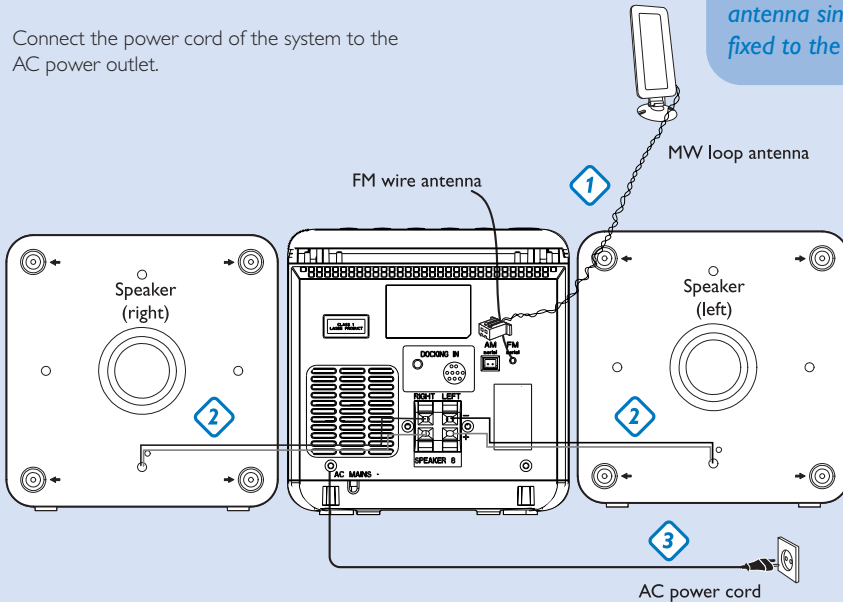

## Setting the clock

- 1 In standby mode, press **PROG/CLOCK** button. The clock digits for the hours flash.
- 2 Press **◀◀ / ▶▶** to set the hours.
- 3 Press **PROG/CLOCK** again. The clock digits for the minutes flash.
- 4 Press **◀◀ / ▶▶** to set the minutes.
- 5 Press **PROG/CLOCK** to confirm the time.

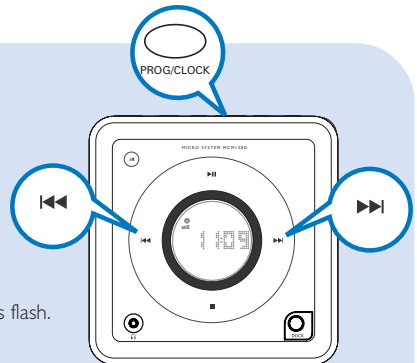

## Step B

## Enjoy

### Playing a disc

- 1 Select **CD** source.
- 2 Press **OPEN•CLOSE** on the top of the system to open the CD door:
- 3 Insert a disc with the printed side facing up and press down on **OPEN•CLOSE** to close the CD door:
- 4 Press **▶ ||** to start playback.
- 5 Press **■** to stop playback.

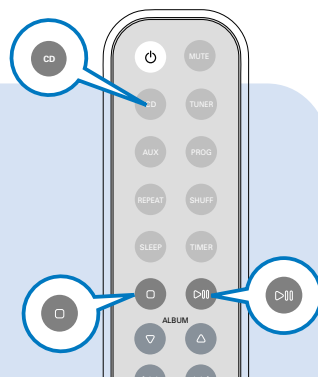

### Listening to radio

- 1 Select **TUNER** source.
- 2 Press **BAND (TUNER)** on the remote control) once or more to select your waveband.
- 3 Turn **TUNING ●** to tune to a station.

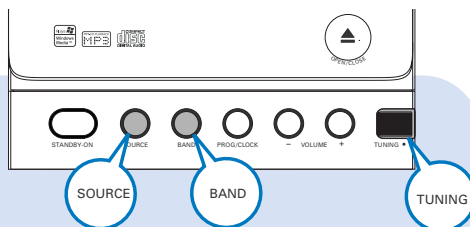

#### Tip

Detailed playback features and additional functions are described in the accompanied owner's manual.

#### Notes for the remote control:

- First, select the source you wish to control by pressing one of the source select keys on the remote control (CD or TUNER, for example).
- Then select the desired function (▶||, ◀, ▶ for example).

## Playing iPod using the dock

- 1 Select the correct dock adaptor supplied, then snap the adaptor into the dock connector (iPod) to provide a snug fit for the player.
  - The indication on the adaptor's back fits specific iPod player.
- 2 Correctly place your player in the dock connector.
- 3 Connect the cables of the dock to **DOCKING IN** jacks on the main set correspondingly.
- 4 Press **SOURCE** repeatedly or on the set (or **DOCK** on the remote) to select DOCK source.
  - The connected player will play automatically.
  - The iPod battery will be charged in either normal standby mode or power-on mode.

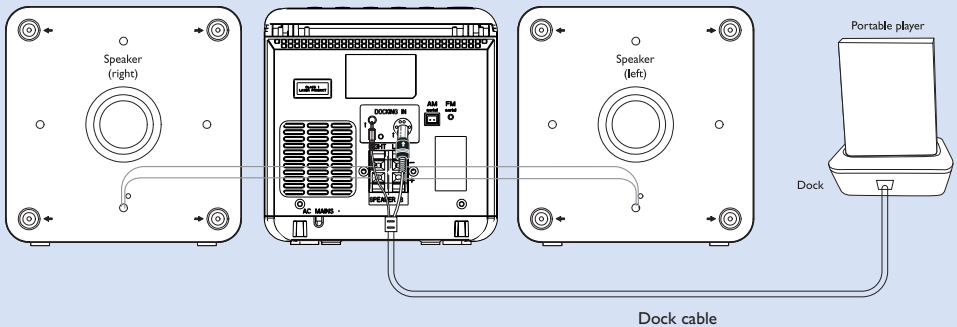

### Tip

Refer to the user manual supplied for detailed descriptions of "Compatible portable players", "Selecting the correct dock adaptor", "Installing the dock adaptor", and the important notes for dock operation.



© Royal Philips Electronics N.V. 2008  
All rights reserved.

