

# Micro Hi-Fi System

MCM118D

PHILIPS CONSUMER ELECTRONICS NORTH AMERICA  
P.O. BOX 671539, Marietta, GA. 30006-0026

Meet Philips at the Internet  
<http://www.philips.com/usasupport>



Thank you for choosing Philips.

## Need help fast?

Read your Quick Use Guide and/or Owner's Manual first for quick tips that make using your Philips product more enjoyable.

If you have read your instructions and still need assistance, you may access our online help at

[www.philips.com/support](http://www.philips.com/support)  
or call

**1-888-PHILIPS (744-5477)**  
while with your product.  
(and Model / Serial number)



Gracias por escoger Philips

## Necesita ayuda inmediata?

Lea primero la Guía de uso rápido o el Manual del usuario, en donde encontrará consejos que le ayudarán a disfrutar plenamente de su producto Philips.

Si después de leerlo aún necesita ayuda, consulte nuestro servicio de asistencia en línea en

[www.philips.com/support](http://www.philips.com/support)  
o llame al teléfono

**1-888-PHILIPS (744-5477)**  
y tenga a mano el producto.  
(y número de model / serial)

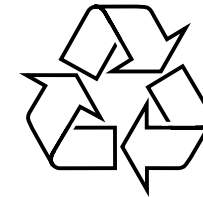

MCM118D

CLASS 1  
LASER PRODUCT

# PHILIPS



Printed in China

PDCC-JH-0625

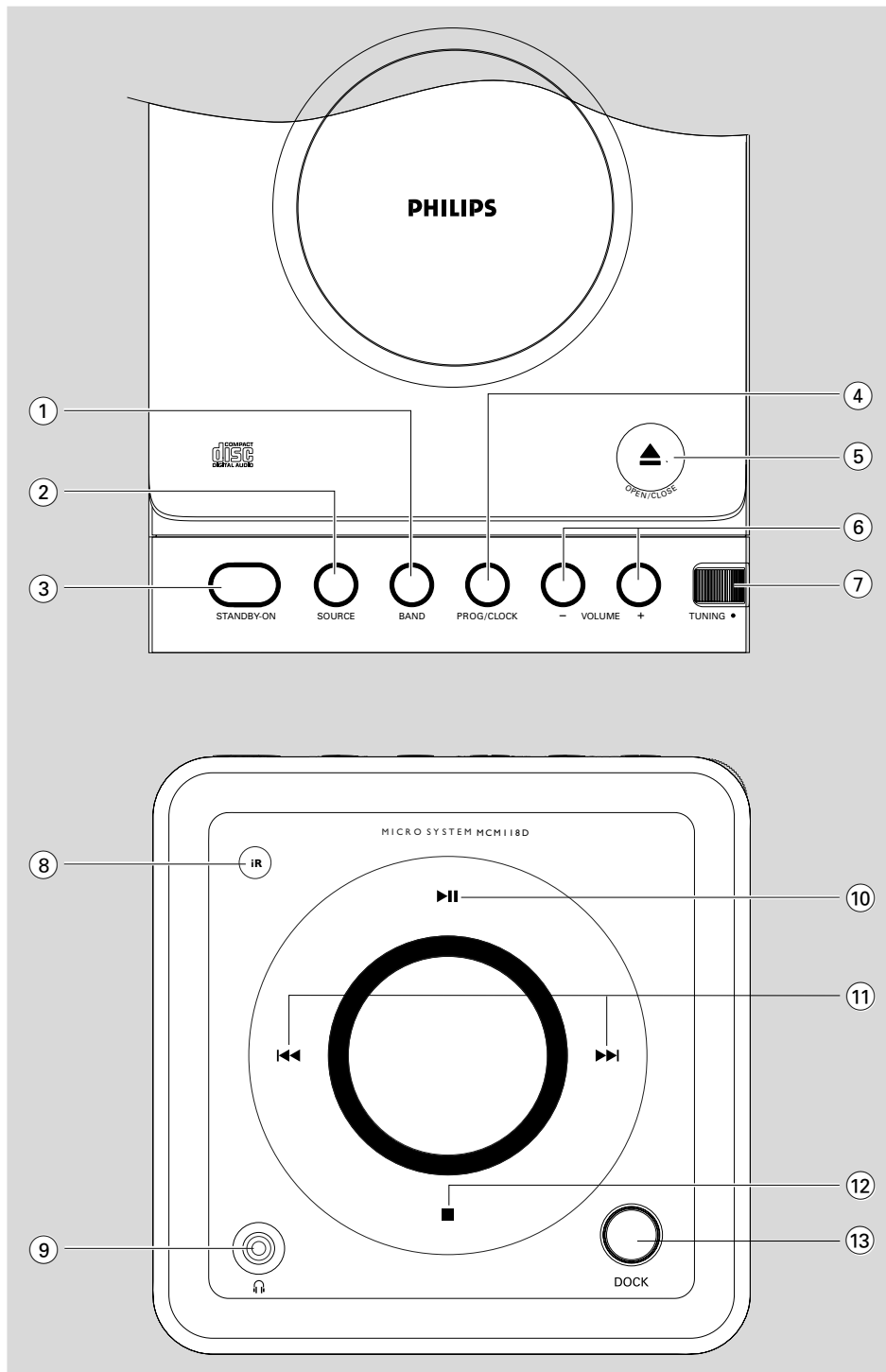

**Note :** This equipment has been tested and found to comply with the limits for a Class B digital device, pursuant to part 15 of the FCC Rules. These limits are designed to provide reasonable protection against harmful interference in a residential installation. This equipment generates, uses, and can radiate radio frequency energy and, if not installed and used in accordance with the instruction manual, may cause harmful interference to radio communications. However, there is no guarantee that interference will not occur in a particular installation. If this equipment does cause harmful interference to radio or television reception, which can be determined by turning the equipment off and on, the user is encouraged to try to correct the interference by one or more of the following measures :

- Relocate the receiving antenna.
- Increase the separation between the equipment and receiver
- Connect the equipment into an outlet on a circuit different from that to which the receiver is connected.
- Consult the dealer or an experienced radio/TV technician for help.

**IMPORTANT !**

**modifications not authorized by the manufacturer may void users authority to operate this device.**

*Nota :* Este aparato ha sido probado y cumple con los límites correspondientes a un aparato digital de Clase B, según la parte 15 de las Normas FCC. Estos límites han sido diseñados para facilitar suficiente protección frente a interferencias perjudiciales en una instalación residencial. Este aparato genera, utiliza y puede emitir energía de frecuencias de radio y, si no se instala y utiliza según el manual de instrucciones, puede provocar interferencias perjudiciales en las comunicaciones de radio. Sin embargo, no existe garantía de que las interferencias no ocurrirán en una instalación particular. Si este aparato provoca interferencias perjudiciales en la recepción de radio o televisión, que se puede identificar encendiendo y apagando el aparato, recomendamos al usuario que intente solucionar las interferencias siguiendo una o más de las siguientes medidas:

- Cambie la posición de la antena receptora.
- Aumente la separación entre el aparato y el receptor.
- Conecte el aparato a una toma de un circuito diferente al que está conectado el receptor.
- Consulte con el distribuidor o un técnico de radio/TV con experiencia para que le ayuden.

**¡IMPORTANTE!**

**modificações não autorizadas pelo fabricante, podem causar danos na operação deste aparelho.**

Return your Product Registration Card or register online at  
[www.philips.com/usasupport](http://www.philips.com/usasupport) today to get the very most from your purchase.

Registering your model with PHILIPS makes you eligible for all of the valuable benefits listed below, so don't miss out. Complete and return your Product Registration Card at once, or register online at [www.philips.com/usasupport](http://www.philips.com/usasupport) to ensure:

**\*Proof of Purchase**

Returning the enclosed card guarantees that your date of purchase will be on file, so no additional paperwork will be required from you to obtain warranty service.

**\*Product Safety Notification**

By registering your product, you'll receive notification - directly from the manufacturer - in the rare case of a product recall or safety defect.

**\*Additional Benefits**

Registering your product guarantees that you'll receive all of the privileges to which you're entitled, including special money-saving offers.

**PHILIPS**

Congratulations on your purchase, and welcome to the "family!"

Dear PHILIPS product owner:

Thank you for your confidence in PHILIPS. You've selected one of the best-built, best-backed products available today. We'll do everything in our power to keep you happy with your purchase for many years to come. As a member of the PHILIPS "family," you're entitled to protection by one of the most comprehensive warranties and outstanding service networks in the industry. What's more, your purchase guarantees you'll receive all the information and special offers for which you qualify, plus easy access to accessories from our convenient home shopping network.

Most importantly, you can count on our uncompromising commitment to your total satisfaction.

All of this is our way of saying welcome - and thanks for investing in a PHILIPS product.

**P.S. To get the most from your PHILIPS purchase, be sure to complete and return your Product Registration Card at once, or register online at:**

[www.philips.com/usasupport](http://www.philips.com/usasupport)

Know these  
**safety** symbols



This "bolt of lightning" indicates uninsulated material within your unit may cause an electrical shock. For the safety of everyone in your household, please do not remove product covering.

The "exclamation point" calls attention to features for which you should read the enclosed literature closely to prevent operating and maintenance problems.

**WARNING:** To reduce the risk of fire or electric shock, this apparatus should not be exposed to rain or moisture and objects filled with liquids, such as vases, should not be placed on this apparatus.

**CAUTION:** To prevent electric shock, match wide blade of plug to wide slot, fully insert.

**ATTENTION:** Pour éviter les choc électriques, introduire la lame la plus large de la fiche dans la borne correspondante de la prise et pousser jusqu'au fond.

**For Customer Use**

Enter below the Serial No. which is located on the rear of the cabinet. Retain this information for future reference.

Model No. \_\_\_\_\_  
 Serial No. \_\_\_\_\_

**IMPORTANT SAFETY INSTRUCTIONS**

1. **Read these instructions.**
2. **Keep these instructions.**
3. **Heed all warnings.**
4. **Follow all instructions.**
5. **Do not use this apparatus near water.**
6. **Clean only with dry cloth.**
7. **Do not block any ventilation openings. Install in accordance with the manufacturer's instructions.**
8. **Do not install near any heat sources** such as radiators, heat registers, stoves, or other apparatus (including amplifiers) that produce heat.
9. **Do not defeat the safety purpose** of the polarized or grounding-type plug. A polarized plug has two blades with one wider than the other. A grounding type plug has two blades and a third grounding prong. The wide blade or the third prong are provided for your safety. If the provided plug does not fit into your outlet, consult an electrician for replacement of the obsolete outlet.
10. **Protect the power cord** from being walked on or pinched, particularly at plugs, convenience receptacles, and the point where they exit from the apparatus.
11. **Only use attachments/accessories** specified by the manufacturer.

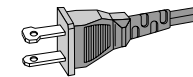

**AC Polarized Plug**

12. **Use only with the cart,** stand, tripod, bracket, or table specified by the manufacturer or sold with the apparatus. When a cart is used, use caution when moving the cart /apparatus combination to avoid injury from tip-over.

13. **Unplug this apparatus** during lightning storms or when unused for long periods of time.
14. **Refer all servicing** to qualified service personnel. Servicing is required when the apparatus has been damaged in any way, such as power-supply cord or plug is damaged, liquid has been spilled or objects have fallen into the apparatus, the apparatus has been exposed to rain or moisture, does not operate normally, or has been dropped.
15. **Battery usage CAUTION** – To prevent battery leakage which may result in bodily injury, property damage, or damage to the unit:

Install **all** batteries correctly, + and - as marked on the unit.  
 Do not mix batteries (**old** and **new** or **carbon** and **alkaline**, etc.).  
 Remove batteries when the unit is not used for a long time.

16. **Apparatus shall not be exposed to dripping or splashing.**
17. **Do not place any sources of danger on the apparatus** (e.g. liquid filled objects, lighted candles).
18. This product may contain lead and mercury. Disposal of these materials may be regulated due to environment considerations.  
**For disposal or recycling information, please contact your local authorities or the Electronic Industries Alliance: [www.eiae.org](http://www.eiae.org).**

EL 6475-S004: 03/12

**Class II equipment symbol**   
 This symbol indicates that the unit has a double insulation system

## PHILIPS LIMITED WARRANTY ONE (1) YEAR

### WARRANTY COVERAGE:

PHILIPS warranty obligation is limited to the terms set forth below.

### WHO IS COVERED:

Philips warrants the product to the original purchaser or the person receiving the product as a gift against defects in materials and workmanship as based on the date of original purchase ("Warranty Period") from an Authorized Dealer. The original sales receipt showing the product name and the purchase date from an authorized retailer is considered such proof.

### WHAT IS COVERED:

The Philips warranty covers new products if a defect arises and a valid claim is received by Philips within the Warranty Period. At its option, Philips will either (1) repair the product at no charge, using new or refurbished replacement parts, or (2) exchange the product with a product that is new or which has been manufactured from new, or serviceable used parts and is at least functionally equivalent or most comparable to the original product in Philips current inventory, or (3) refund the original purchase price of the product.

Philips warrants replacement products or parts provided under this warranty against defects in materials and workmanship from the date of the replacement or repair for ninety (90) days or for the remaining portion of the original product's warranty, whichever provides longer coverage for you. When a product or part is exchanged, any replacement item becomes your property and the replaced item becomes Philips' property. When a refund is given, your product becomes Philips' property.

**Note: Any product sold and identified as refurbished or renewed carries a ninety (90) day limited warranty.**

**Replacement product can only be sent if all warranty requirements are met. Failure to follow all requirements can result in delay.**

### WHAT IS NOT COVERED - EXCLUSIONS AND LIMITATIONS:

This Limited Warranty applies only to the new products manufactured by or for Philips that can be identified by the trademark, trade name, or logo affixed to it. This Limited Warranty does not apply to any non-Philips hardware product or any software, even if packaged or sold with the product. Non-Philips manufacturers, suppliers, or publishers may provide a separate warranty for their own products packaged with the bundled product.

Philips is not liable for any damage to or loss of any programs, data, or other information stored on any media contained within the product, or any non-Philips product or part not covered by this warranty. Recovery or reinstallation of programs, data or other information is not covered under this Limited Warranty.

This warranty does not apply (a) to damage caused by accident, abuse, misuse, misapplication, or non-Philips product, (b) to damage caused by service performed by anyone other than Philips or Philips Authorized Service Location, (c) to a product or a part that has been modified without the written permission of Philips, or (d) if any Philips serial number has been removed or defaced, or (e) product, accessories or consumables sold "AS IS" without warranty of any kind by including refurbished Philips product sold "AS IS" by some retailers.

### This Limited Warranty does not cover:

- Shipping charges to return defective product to Philips.
- Labor charges for installation or setup of the product, adjustment of customer controls on the product, and installation or repair of antenna systems outside of the product.
- Product repair and/or part replacement because of improper installation, connections to improper voltage supply, abuse, neglect, misuse, accident, unauthorized repair or other cause not within the control of Philips.
- Damage or claims for products not being available for use, or for lost data or lost software.
- Damage occurring to product during shipping.
- A product that requires modification or adaptation to enable it to operate in any country other than the country for which it was designed, manufactured, approved and/or authorized, or repair of products damaged by these modifications.
- A product used for commercial or institutional purposes (including but not limited to rental purposes).
- Product lost in shipment and no signature verification receipt can be provided.
- Failure to operate per Owner's Manual.

### TO OBTAIN ASSISTANCE IN THE U.S.A., PUERTO RICO, OR U.S. VIRGIN ISLANDS...

Contact Philips Customer Care Center at:  
1-888-PHILIPS (1-888-744-5477)

### TO OBTAIN ASSISTANCE IN CANADA...

1-800-661-6162 (French Speaking)  
1-888-PHILIPS (1-888-744-5477) - (English or Spanish Speaking)

REPAIR OR REPLACEMENT AS PROVIDED UNDER THIS WARRANTY IS THE EXCLUSIVE REMEDY FOR THE CONSUMER. PHILIPS SHALL NOT BE LIABLE FOR ANY INCIDENTAL OR CONSEQUENTIAL DAMAGES FOR BREACH OF ANY EXPRESS OR IMPLIED WARRANTY ON THIS PRODUCT. EXCEPT TO THE EXTENT PROHIBITED BY APPLICABLE LAW, ANY IMPLIED WARRANTY OF MERCHANTABILITY OR FITNESS FOR A PARTICULAR PURPOSE ON THIS PRODUCT IS LIMITED IN DURATION TO THE DURATION OF THIS WARRANTY.

Some states do not allow the exclusions or limitation of incidental or consequential damages, or allow limitations on how long an implied warranty lasts, so the above limitations or exclusions may not apply to you.

*This warranty gives you specific legal rights. You may have other rights which vary from state/province to state/province.*

Philips, P.O. Box 671539, Marietta, GA. 30006-0026

3121 233 48801

### Controls on the system and remote control

- ① **BAND**  
– for Tuner:..... (on the set only) selects waveband.
- ② **SOURCE (CD/TUNER/ DOCK)**  
– switches on the system.  
– selects the respective sound source for CD/ FM/ AM/ DOCK.
- ③ **STANDBY-ON / ⏻**  
– switches the system to standby (Eco-power standby)/on.
- ④ **PROG/CLOCK**  
for CD ..... programs tracks and reviews the program.  
for clock ..... sets the clock function.
- ⑤ **OPEN•CLOSE**  
– opens/closes the CD door.
- ⑥ **VOLUME – / +**  
– adjusts volume level.
- ⑦ **TUNING ●**  
– tunes to radio stations.
- ⑧ **iR SENSOR**  
– infrared sensor for remote control.
- ⑨ **🎧**  
– connect headphones.
- ⑩ **▶ ||**  
for CD ..... starts or pauses CD playback.
- ⑪ **◀◀ / ▶▶**  
– skips to the beginning of a current track/ previous/ next track.  
– fast searches back and forward within a track/ CD.
- ⑫ **STOP ■**  
– stops CD playback or erase a CD program.
- ⑬ **DOCK**  
– selects sound source of DOCK
- ⑭ **MUTE**  
– switches playback sound off and on.
- ⑮ **REPEAT**  
– repeats a track/disc/all programmed tracks.
- ⑯ **SHUFF (SHUFFLE)**  
– plays CD/MP3 tracks in random order.
- ⑰ **SLEEP**  
– activates/deactivates or selects the sleeper time.

- ⑱ **TIMER**  
– activates/deactivates or sets the timer function.
- ⑲ **ALBUM ▼ ▲**  
for MP3 disc ..... selects an album.
- ⑳ **DBB**  
– (Dynamic Bass Boost) enhances the bass.
- ㉑ **DSC**  
– (Digital Sound Control) selects sound characteristics; JAZZ/POP/CLASSIC/ROCK.

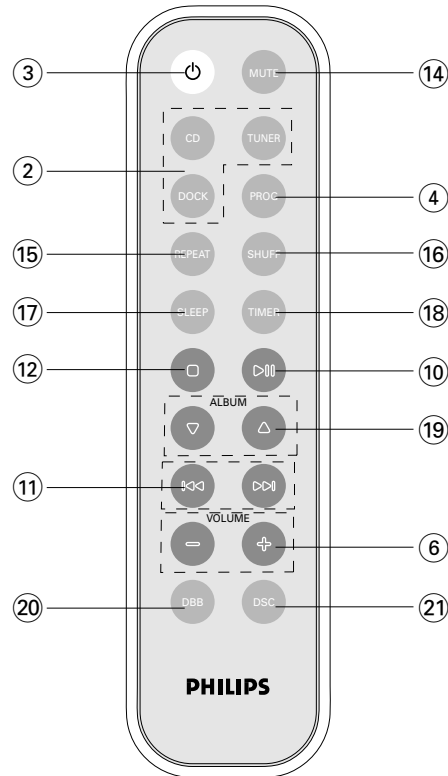

#### Notes for remote control:

- **First select the source you wish to control by pressing one of the source select keys on the remote control (for example CD , TUNER).**
- **Then select the desired function (for example ▶, ◀, ▶!).**

**This set complies with the FCC rules, Part 15 and with 21 CFR 1040.10.**

**Operation is subject to the following two conditions:**

- **This device may not cause harmful interference, and**
- **This device must accept any interference received, including interference that may cause undesired operation.**

### Supplied accessories

- 2 speaker boxes
- MCM118D remote control with battery
- AM loop antenna
- Docking kit
  - 1 Apple iPod dock and
  - 1 Philips GoGear jukebox dock
  - Dock adaptors (8 adaptors for different iPod types, and 3 adaptors for different Philips GoGear types)
  - 1 Docking cable

### Environmental Information

All unnecessary packaging has been omitted. We have tried to make the packaging easy to separate into three materials: cardboard (box), polystyrene foam (buffer) and polyethylene (bags, protective foam sheet).

Your system consists of materials which can be recycled and reused if disassembled by a specialized company. Please observe the local regulations regarding the disposal of packaging materials, exhausted batteries and old equipment.

### Safety Information

- Before operating the system, check that the operating voltage indicated on the typeplate (or the voltage indication beside the voltage selector) of your system is identical with the voltage of your local power supply. If not, please consult your dealer.
- Place the system on a flat, hard and stable surface.
- Place the system in a location with adequate ventilation to prevent internal heat build-up in your system. Allow at least 10 cm (4 inches) clearance from the rear and the top of the unit and 5 cm (2 inches) from each side.
- The ventilation should not be impeded by covering the ventilation openings with items, such as newspapers, table-cloths, curtains, etc.
- Do not expose the system, batteries or discs to excessive moisture, rain, sand or heat sources caused by heating equipment or direct sunlight.
- No naked flame sources, such as lighted candles, should be placed on the apparatus.
- No objects filled with liquids, such as vases, shall be placed on the apparatus.
- If the system is brought directly from a cold to a warm location, or is placed in a very damp room, moisture may condense on the lens of the disc unit inside the system. Should this occur, the CD player would not operate normally. Leave the power on for about one hour with no disc in the system until normal playback is possible.
- The mechanical parts of the set contain self-lubricating bearings and must not be oiled or lubricated.
- **When the system is switched to Standby mode, it is still consuming some power. To disconnect the system from the power supply completely, remove the AC power plug from the wall socket.**

## Preparations

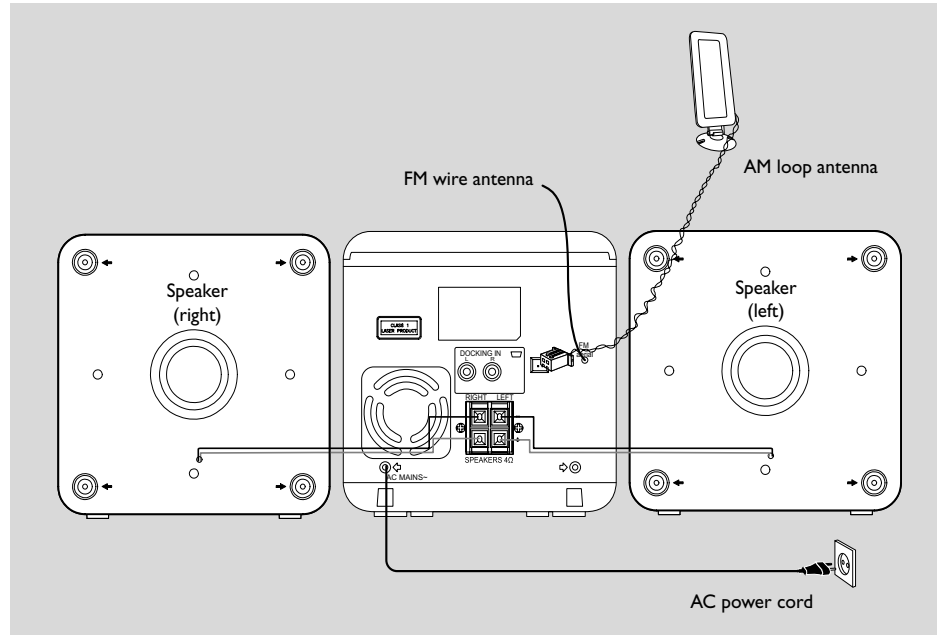

### IMPORTANT!

– Do not connect Mini-USB port both on the main unit and the supplied dock to a computer or any other USB devices. It is only for connecting the supplied dock and the main unit to let them work together. See the Dock section for dock connection.

### Rear connections

The type plate is located at the rear of the system.

#### A Power

– Before connecting the AC power cord to the wall outlet, ensure that all other connections have been made.

### WARNING!

– For optimal performance, use only the original power cable.  
– Never make or change any connections with the power switched on.

#### B Antennas Connection

##### AM (MW) antenna

- 1 Unfold the loop antenna and if necessary, use screws (not supplied) to fix it to a flat, hard and stable place:

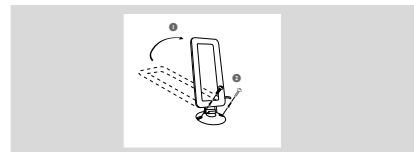

- 2 Fit the plug of the loop antenna to AM ANTENNA as shown above.
- 3 Adjust the antenna for optimal reception

##### FM Antenna

It is unnecessary to connect the FM pigtail antenna since it is fixed to the main unit.

- Position the antenna as far as possible from a TV, VCR or other radiation source.

## Preparations

#### C Speakers Connection

##### Front Speakers

Connect the speaker wires to the SPEAKERS terminals, right speaker to "RIGHT" and left speaker to "LEFT", the wire (marked red) to "+" and the wire (marked black) to "–".

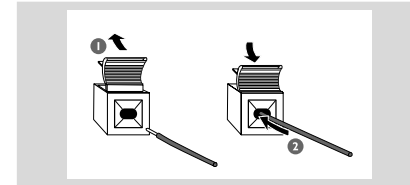

- Fully insert the stripped portion of the speaker wire into the terminal as shown.

### Notes:

– For optimal sound performance, use the supplied speakers.  
– Do not connect more than one speaker to any one pair of + / – speaker terminals.  
– Do not connect speakers with an impedance lower than the speakers supplied. Please refer to the SPECIFICATIONS section of this manual.

### Before using the remote control

- 1 Pull out the plastic protective sheet.
- 2 Select the source you wish to control by pressing one of the source select keys on the remote control (for example CD, TUNER).
- 3 Then select the desired function (for example ►, ◀, ▶).

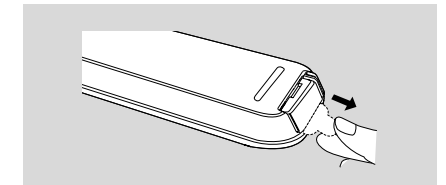

### Replacing battery (lithium CR2032) into the remote control

- 1 Pull out the knob (A) slightly to the left.
- 2 Pull out the battery compartment (B).
- 3 Replace a new battery and fully insert the battery compartment back to the original position.

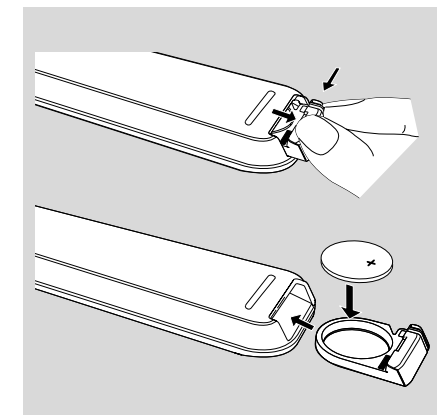

### CAUTION!

Batteries contain chemical substances, so they should be disposed off properly.

## Basic Functions

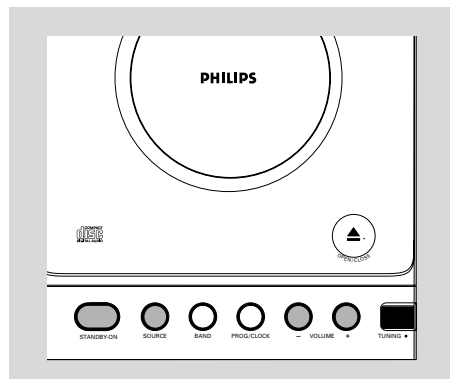

### IMPORTANT:

Before you operate the system, complete the preparation procedures.

### Switching the system on

- Press **STANDBY-ON** (⏻ on the remote control).  
→ The system will switch to the last selected source.
- Press **SOURCE** (CD, TUNER or AUX on the remote control).  
→ The system will switch to the selected source.

### To switch the system to standby mode

- Press **STANDBY-ON** (⏻ on the remote control).  
→ The clock is displayed.

### To switch the system to Eco-power standby mode

- Press and hold **STANDBY-ON** (⏻ on the remote control) for more than 2 seconds.  
→ The display will go blank.

### Power-saving automatic standby

The power-saving feature automatically switches to standby 15 minutes after a CD playback has ended and no control is operated.

### Adjusting volume and sound

- 1 Press **VOLUME - / +** to increase or decrease volume.  
→ Display shows the volume level and a number from 0-32.
  - 2 Press **DSC** repeatedly to select the desired sound effect: **JAZZ / POP / CLASSIC / ROCK**.
  - 3 Press **DBB** (on the remote control) to switch bass enhancement on or off.  
→ Display shows: if the DBB is activated.
  - 4 Press **MUTE** on the remote control to stop sound play-back instantly.  
→ Playback will continue without sound and the display shows **MUTE**.
- To start sound playback you can:
- press **MUTE** again;
  - adjust the volume controls;
  - change source.

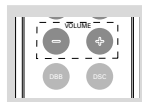

## CD/MP3 Operation

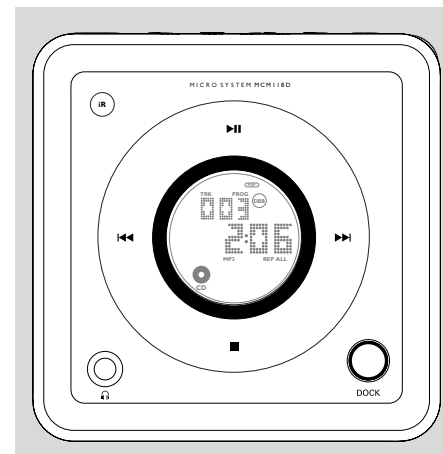

### IMPORTANT:

The lens of the CD player should never be touched.

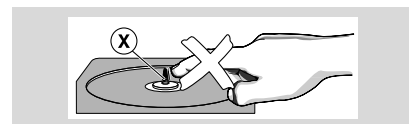

### Loading a disc

This CD player plays Audio Discs including CD-Recordables, CD-Rewritables and MP3 CD.

- CD-ROM, CD-I, CDV, VCD, DVD or computer CDs, however, are not possible.

- 1 Select **CD** source.
- 2 Press **OPEN/CLOSE** (▲) on the top of the system to open the CD compartment.  
→ **OPEN** is displayed when you open the CD compartment.

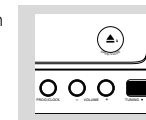

- 3 Insert a disc with the printed side facing up and press down on **OPEN/CLOSE** (▲) to close the CD door.  
→ **READY** is displayed as the CD player scans the contents of a disc, and then the total number of tracks and playing time (or the total number of albums and tracks for MP3 disc) are shown.

### Basic playback controls

#### To play a disc

- Press **▶▶** to start playback.  
→ The current track number and elapsed playing time of the track are displayed during disc playback.

#### To select a different track

- Press **◀◀ ▶▶** once or repeatedly until the desired track number appears in the display.

#### To find a passage within a track

- 1 Press and hold down on **◀◀ ▶▶**.  
→ The disc is played at high speed and low volume.
- 2 When you recognise the passage you want, release **◀◀ ▶▶**.  
→ Normal playback continues.

#### To interrupt playback

- Press **▶▶** during playback.  
→ The display freezes and the elapsed playing time flashes when playback is interrupted.  
→ To resume, press **▶▶** again.

#### To stop playback

- Press **■**.

Notes: CD play will also stop when;

- the CD door is opened.
- the disc has reached the end.
- you select another source: **TUNER** or **AUX**.
- you select standby

### Playing an MP3 disc

- 1 Load an MP3 disc.  
→ The disc reading time may exceed 10 seconds due to the large number of songs compiled into one disc.  
→ "XXXX XX" is displayed. XXXX is the current track number and XX is the current album number.
- 2 Press **ALBUM ▼ ▲** to select a desired album.

## CD/MP3 Operation

- Press **⏮** **⏭** to select a desired track.  
→ The album number will change accordingly as you reach the first track of an album by pressing **⏮** or the last track of an album by pressing **⏭**.
- Press **▶** to start playback.
- During playback, press once **ALBUM ▼ ▲** to show the current album number.

### Supported MP3 disc formats:

- ISO9660, Joliet, UDF 1.5
- Maximum title number: 256 (depending on filename length)
- Maximum album number: 99
- Supported sampling frequencies: 32 kHz, 44.1 kHz, 48 kHz
- Supported Bit-rates: 32~256 (kbps), variable bitrates

### Different play modes: SHUFFLE and REPEAT

You can select and change the various play modes before or during playback. The REPEAT modes can also be combined with PROGRAMME.

**SHUFFLE** ..... tracks of the entire disc are played in random order

**REPEAT ALL** ... repeats the entire disc/programme

**REPEAT** ..... plays the current track continuously

**REPEAT ALB** ... repeats all tracks in the current (for MP3 only) album

- To select your play mode, press the **SHUFF** or **REPEAT** on the remote control before or during playback until the display shows the desired function.
- Press **▶** (on the remote control **▶**) to start playback if in the STOP position.  
→ If you have selected SHUFFLE, playback starts automatically.
- To return to normal playback, press **SHUFF** or **REPEAT** on the remote control until the various SHUFFLE/ REPEAT modes are no longer displayed.
- You can also press **■** to cancel your play mode.

### Notes:

- The **SHUFFLE** and **REPEAT** functions cannot be used *simultaneously*.
- **SHUFFLE** play is not available in the programme mode.

### Programming track numbers

Programme in the STOP position to select and store your disc tracks in the desired sequence. If you like, store any track more than once. Up to 20 (10 for MP3 disc) tracks can be stored in the memory.

- In the stop position, use the **⏮** **⏭** to select your desired track number.
- For MP3, you may press **ALBUM ▼ ▲** to select a desired album, then press **⏮** **⏭** to select your desired track.
- Press **PROGRAM** (or **PROG/CLOCK** on the set) to store.  
→ Display: **PROG** flashes, and **⏮** **⏭** is displayed briefly, then the selected track number (and the selected album number for MP3).
- Repeat **steps 1-2** to select and store all desired tracks.  
→ **FULL** is displayed if you attempt to programme more than 20 (10 for MP3 disc) tracks.
- To start playback of your disc programme, press **▶**.

### Reviewing the programme

- Stop playback and press **PROGRAM** (or **PROG/CLOCK** on the set) repeatedly.  
→ Display first shows a programme sequence, then the stored track number (and the album number for MP3).
- To exit review mode, press **■**.

### Erasing the programme

You can erase the programme by:

- pressing **■** once in the STOP mode;
- pressing **■** twice during playback;
- opening the CD compartment;
- Select another sound source.  
→ **PROG** disappears from the display.

## Radio Reception

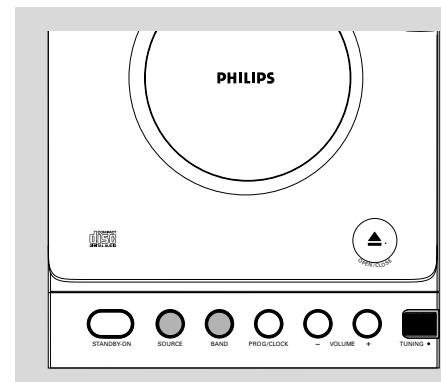

- Turn **TUNING** **●** to tune to a station.  
→ Display shows: the frequency of the tuned station.

### Helpful hints:

#### To improve radio reception:

- For **FM**, extend coil antenna at the back of the unit fully for optimum reception.

### Tuning to radio stations

- Select **TUNER** source.  
→ **TUNER** is displayed.
- Press **BAND** (**TUNER** on the remote control) once or more to select your waveband.

## Maintenance

### Cleaning the Cabinet

- Use a soft cloth slightly moistened with a mild detergent solution. Do not use a solution containing alcohol, spirits, ammonia or abrasives.

### Cleaning Discs

- When a disc becomes dirty, clean it with a cleaning cloth. Wipe the disc from the centre out.
- Do not use solvents such as benzene, thinner; commercially available cleaners, or antistatic spray intended for analogue records.



### Cleaning the disc lens

- After prolonged use, dirt or dust may accumulate at the disc lens. To ensure good playback quality, clean the disc lens with Philips CD Lens Cleaner or any commercially available cleaner. Follow the instructions supplied with cleaner.



## Clock/Timer

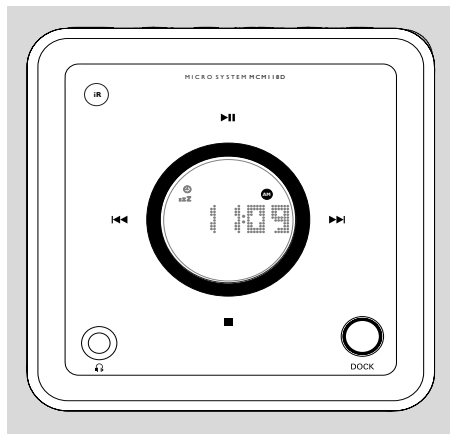

### Setting the clock

- In Standby mode, press **PROG/CLOCK** button.  
→ The clock digits for the hours flash.
- Press **◀◀/▶▶** to set the hours.
- Press **PROG/CLOCK** again.  
→ The clock digits for the minutes flash.
- Press **◀◀/▶▶** to set the minutes.
- Press **PROG/CLOCK** to confirm the time.

#### Note:

– If the clock has not been set, --:-- will be displayed.

### Setting the timer

- The system can be used as an alarm clock. CD or TUNER can be set to switch on at a preset time. The clock time needs to be set first before the timer can be used.
  - If no button is pressed within 90 seconds during timer setup, the system will exit timer setting mode automatically.
- In any mode, press **TIMER** on the remote control for more than 2 seconds.
  - Press **◀◀/▶▶** (or **CD/TUNER/DOCK** on the remote control) to select sound source.
  - Press **TIMER** to confirm your desired source.  
→ The clock digits for the hours flash.

- Press **◀◀/▶▶** to set the hours.
- Press **TIMER** again.  
→ The clock digits for the minutes flash.
- Press **◀◀/▶▶** to set the minutes.
- Press **TIMER** to confirm the time.  
→ The timer is now set and actiated.

#### Notes:

– If source **CD** is selected and no disc is in the CD tray or the disc has an error, **TUNER** will be selected automatically.

– If source **DOCK** is selected and no iPod/Philips GoGear is docked or no dock connection is made, **TUNER** will be selected automatically.

– At the set time of wake up, the set will turn on at volume level 12.

### To activate and deactivate timer

- In standby or during playback, press **TIMER** once.  
→ Display shows  if activated, and disappears if deactivated.

#### Note:

– In the Eco-power standby mode (The display goes blank. ), timer can be also be activated if timer is set.

### Activating and deactivating SLEEP

The sleep timer enables the system to switch off by itself after a set period of time. The clock time needs to be set first before the sleep timer can be used.

- Press **SLEEP** on the remote control repeatedly to select desired time before system shuts off.  
→ Display shows **SLEEP** and series of time options for selection: 60, 45, 30, 15, 0, 60...
- To deactivate, press **SLEEP** on the remote control once or more until "  " is shown, or press **STANDBY ON** on the system or remote control.



## Dock

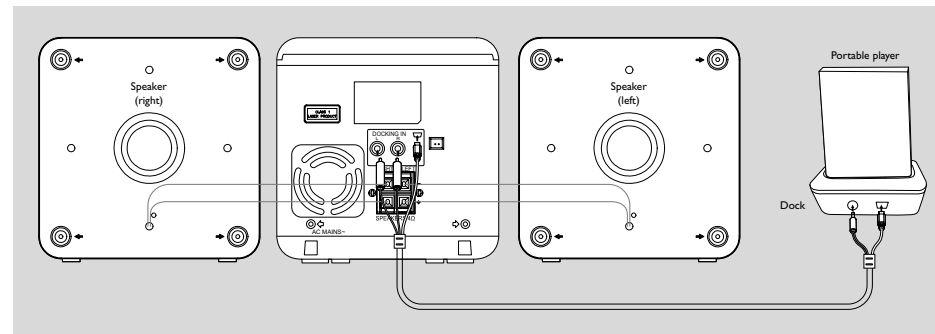

### IMPORTANT!

– **MCM118D** comes with two dock types. Use the designated dock type, as indicated on the bottom panel of the dock supplied, to work with either Philips GoGear or Apple iPod.

– Do not connect Mini-USB port both on the main unit and the supplied dock to a computer or any other USB devices. It is only for connecting the supplied dock and the main unit to let them work together.

### Playing iPod /Philips GoGear using the dock

By connecting the supplied dock to your Hi-Fi system, you can listen to the sound of the docked player through the powerful speakers of the Hi-Fi system.

### Compatible portable player

- Most Apple iPod models with 30-pin dock connector as follows:  
20GB, 40GB, 20/30GB Photo, 40/60GB Photo, 30GB Video, 60GB Video, Mini and Nano.
- Philips GoGear players with dock connectors as follows:  
– HDD1420, HDD1620, HDD1630, HDD1635, HDD1820, HDD1830, HDD1835;  
– HDD1840, 1850;  
– HDD6320, HDD6330

### Dock adaptor

Before plugging your player in the dock, snap the suitable dock adaptor into the dock to provide a snug fit for the player to be docked.

### Selecting the correct dock adaptor

- For the iPod dock, 8 dock adaptors of different type, as indicated at the back of the adaptor; are included to fit the following iPod:  
**20GB, 40GB, 20/30GB Photo, 40/60GB Photo, 30GB Video, 60GB Video, Mini and Nano.**
- For the Philips GoGear dock, 3 dock adaptors of different type are included. Each adaptor is marked a number from "1" to "3" at its back. These numbers indicate the fit Philips GoGear players as follows:  
"1" = HDD6320/6330  
"2" = HDD1420/1620/1630/1635/1820/1830/1835  
"3" = HDD1840/1850

### Installing the dock adaptor

- First align two latches and two holes on the adaptor and the dock, then gently push in the adaptor until it clicks.

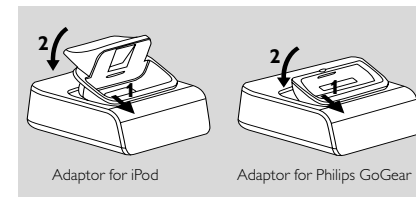

## Dock

### Removing the dock adaptor

Push the dock in the direction of the arrow shown in the figure below to un-latch the adaptor, then take it out.

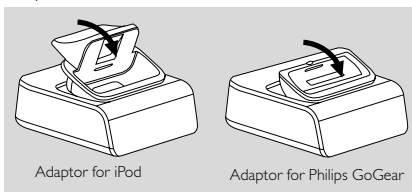

### Playing iPod /Philips GoGear

- 1 Make sure the dock type is compatibly matched with the player to be docked, as indicated on the bottom of the dock.
  - 2 Snap the dock adaptor of the correct type and size into the dock (See “**dock adaptor**”).
  - 3 Correctly place your Philips GoGear or iPod in the dock.
  - 4 Using the supplied docking cable, connect the Line-Out port (3.5 mm) and Mini-USB port on the dock to DOCKING IN jacks (L and R) and Mini-USB port on the main set, marked-red to R DOCKING IN jack and marked-white to L DOCKING IN jack.
  - 5 Press **SOURCE** repeatedly or **DOCK** on the set (or **DOCK** on the remote) to select DOCK source.
- Make sure that you have powered on Philips GoGear before selecting DOCK source.
    - On the MCM118D's display, "GoGear" is displayed if Philips GoGear is connected, or "iPod" is displayed if iPod is connected.
  - The connected player will play automatically.

### Notes:

- By using the buttons (▶||, ◀◀, ▶▶ and **VOLUME**) on the MCM118D and its remote control, the following disc playback features are available: Play/Pause, selecting next/previous track, fast forwarding/rewinding and changing volume.
- The buttons (▶||, ◀◀, ▶▶ and **VOLUME**) on the MCM118D and its remote control can work only with playback of the audio contents stored on the docked player.
- Stop (■) function of disc playback is not available to the docked player.
- For the Philips GoGear player being docked, to prevent battery consumption, power it off if it is not used longer.

### Charging iPod battery using the dock

Docking your iPod and connecting the dock to MCM118D, you can charge the iPod in the standby mode and power-on mode of MCM118D.

### Note:

- Apple iPod cannot be charged in the Eco-power standby mode of MCM118D.

## Troubleshooting

### WARNING

Under no circumstances should you try to repair the system yourself, as this will invalidate the warranty. Do not open the system as there is a risk of electric shock.

If a fault occurs, first check the points listed below before taking the system for repair. If you are unable to remedy a problem by following these hints, consult your dealer or service centre.

Problem	Solution
<b>CD OPERATION</b>	
"no cd" is displayed.	<ul style="list-style-type: none"> <li>– Insert a disc.</li> <li>– Check if the disc is inserted upside down.</li> <li>– Wait until the moisture condensation at the lens has cleared.</li> <li>– Replace or clean the disc, see "Maintenance".</li> <li>– Use a finalised CD-RW or CD-R, or a correct MP3-CD format disc.</li> </ul>
<b>RADIO RECEPTION</b>	
Radio reception is poor.	<ul style="list-style-type: none"> <li>– If the signal is too weak, adjust the antenna or connect an external antenna for better reception.</li> <li>– Increase the distance between the Micro HiFi System and your TV or VCR.</li> </ul>
<b>GENERAL</b>	
The system does not react when buttons are pressed.	<ul style="list-style-type: none"> <li>– Remove and reconnect the AC power plug and switch on the system again.</li> </ul>
Sound cannot be heard or is of poor quality.	<ul style="list-style-type: none"> <li>– Adjust the volume.</li> <li>– Disconnect the headphones.</li> <li>– Check that the speakers are connected correctly.</li> <li>– Check if the stripped speaker wire is clamped.</li> <li>– Make sure the MP3-CD was recorded within 32-256 kbps bit rate with sampling frequencies at 48 kHz, 44.1 kHz or 32 kHz.</li> </ul>
The left and right sound outputs are reversed.	<ul style="list-style-type: none"> <li>– Check the speaker connections and location.</li> </ul>
The remote control does not function properly.	<ul style="list-style-type: none"> <li>– Select the source (CD or TUNER, for example) before pressing the function button (▶, ◀, ▶).</li> <li>– Reduce the distance between the remote control and the system.</li> <li>– Insert the batteries with their polarities (+/- signs) aligned as indicated.</li> <li>– Replace the batteries.</li> <li>– Point the remote control directly toward IR sensor on the front of the system.</li> </ul>
The timer is not working.	<ul style="list-style-type: none"> <li>– Set the clock correctly.</li> <li>– Press <b>TIMER</b> to switch on the timer.</li> </ul>
The Clock/Timer setting is erased.	<ul style="list-style-type: none"> <li>– Power has been interrupted or the power cord has been disconnected. Reset the clock/timer.</li> </ul>

# Troubleshooting

## WARNING

Under no circumstances should you try to repair the system yourself, as this will invalidate the warranty. Do not open the system as there is a risk of electric shock.

If a fault occurs, first check the points listed below before taking the system for repair. If you are unable to remedy a problem by following these hints, consult your dealer or service centre.

Problem	Solution
<b>CD OPERATION</b>	
"no cd" is displayed.	<ul style="list-style-type: none"> <li>– Insert a disc.</li> <li>– Check if the disc is inserted upside down.</li> <li>– Wait until the moisture condensation at the lens has cleared.</li> <li>– Replace or clean the disc, see "Maintenance".</li> <li>– Use a finalised CD-RW or CD-R, or a correct MP3-CD format disc.</li> </ul>
<b>RADIO RECEPTION</b>	
Radio reception is poor.	<ul style="list-style-type: none"> <li>– If the signal is too weak, adjust the antenna or connect an external antenna for better reception.</li> <li>– Increase the distance between the Micro HiFi System and your TV or VCR.</li> </ul>
<b>GENERAL</b>	
The system does not react when buttons are pressed.	<ul style="list-style-type: none"> <li>– Remove and reconnect the AC power plug and switch on the system again.</li> </ul>
Sound cannot be heard or is of poor quality.	<ul style="list-style-type: none"> <li>– Adjust the volume.</li> <li>– Disconnect the headphones.</li> <li>– Check that the speakers are connected correctly.</li> <li>– Check if the stripped speaker wire is clamped.</li> <li>– Make sure the MP3-CD was recorded within 32-256 kbps bit rate with sampling frequencies at 48 kHz, 44.1 kHz or 32 kHz.</li> </ul>
The left and right sound outputs are reversed.	<ul style="list-style-type: none"> <li>– Check the speaker connections and location.</li> </ul>
The remote control does not function properly.	<ul style="list-style-type: none"> <li>– Select the source (CD or TUNER, for example) before pressing the function button (▶, ◀, ▶).</li> <li>– Reduce the distance between the remote control and the system.</li> <li>– Insert the batteries with their polarities (+/- signs) aligned as indicated.</li> <li>– Replace the batteries.</li> <li>– Point the remote control directly toward IR sensor on the front of the system.</li> </ul>
The timer is not working.	<ul style="list-style-type: none"> <li>– Set the clock correctly.</li> <li>– Press <b>TIMER</b> to switch on the timer.</li> </ul>
The Clock/Timer setting is erased.	<ul style="list-style-type: none"> <li>– Power has been interrupted or the power cord has been disconnected. Reset the clock/timer.</li> </ul>

# Troubleshooting

## DOCK OPERATION

The menu navigation or photo playback of the docked player cannot be carried out through the buttons on MCM118D or its remote control.	<ul style="list-style-type: none"> <li>– The buttons on MCM118D and its remote control can control playback of audio contents only. To navigate the menu, use the controls on the docked player.</li> </ul>
The STOP ■ and some buttons on MCM118D and its remote control have no function.	<ul style="list-style-type: none"> <li>– The playback of the docked player cannot be stopped using the <b>STOP ■</b> button on MCM118D and its remote control.</li> <li>– The buttons (▶  , ◀◀, ▶▶ and <b>VOLUME</b>) function only.</li> </ul>
The battery of my Philips GoGear in dock is drained when it is not used for playback.	<ul style="list-style-type: none"> <li>– The docked GoGear is still consuming battery. power it off if you don't use the player.</li> </ul>

# Specifications

## AMPLIFIER

Output power .....	2 × 15W
.....	30W total power
.....	2 × 12W FTC ①
Signal-to-noise ratio .....	≥ 62 dBA (IEC)
Frequency response .....	125 – 16000 Hz, ± 3 dB
Impedance loudspeakers .....	4 Ω
Impedance headphones .....	32 Ω

Note:

①(4Ω, 60Hz~12.5kHz, 10%THD)

## CD PLAYER

Frequency range .....	20 – 20000 Hz
Signal-to-noise ratio .....	62 dBA

## TUNER

FM wave range .....	87.5 – 108 MHz
AM wave range .....	530 – 1700 kHz
Sensitivity at 75 Ω	
– mono, 26 dB signal-to-noise ratio .....	3.8 μV
– stereo, 46 dB signal-to-noise ratio .....	61.4 μV
Selectivity .....	≥ 28 dB
Total harmonic distortion .....	≤ 5%
Frequency response .....	63 – 12500 Hz (± 3 dB)
Signal-to-noise-ratio .....	≥ 50 dB

## SPEAKERS

Bass reflex system  
Dimensions (w x h x d) .. 150 x 150 x 200 (mm)

## GENERAL INFORMATION

AC Power .....

120V / 60 Hz  
Dimensions (w x h x d) .. 150 x 150 x 220 (mm)  
Weight (with/without speakers) .....

..... approx. 4.9 / 2.3 kg  
ECO power consumption .....

< 1 W

## Subject to modification