

Quick Start Guide

- Step A *Setup*
- Step B *Enjoy*

What's in the Box?

You should find these items upon opening the box.

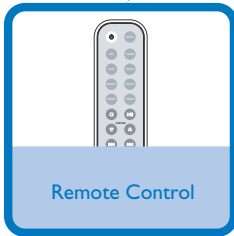
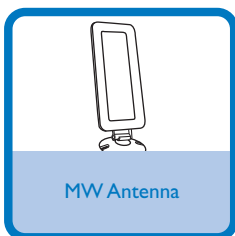
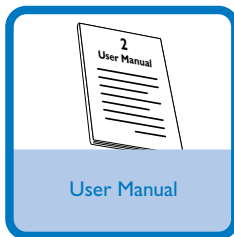
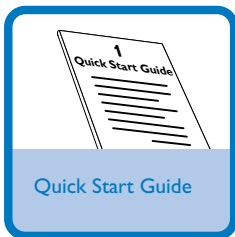

Pull out the insulation plastic sheet.

Step A

Setup

Connection

- 1 For radio reception, connect the supplied MW antenna to the **MW aerial** terminal.
- 2 Connect the speaker wires to the **SPEAKERS** terminals.
- 3 Connect the power cord of the system to the AC power outlet.

Tip

It is unnecessary to connect the FM pigtail antenna since it is fixed to the main unit.

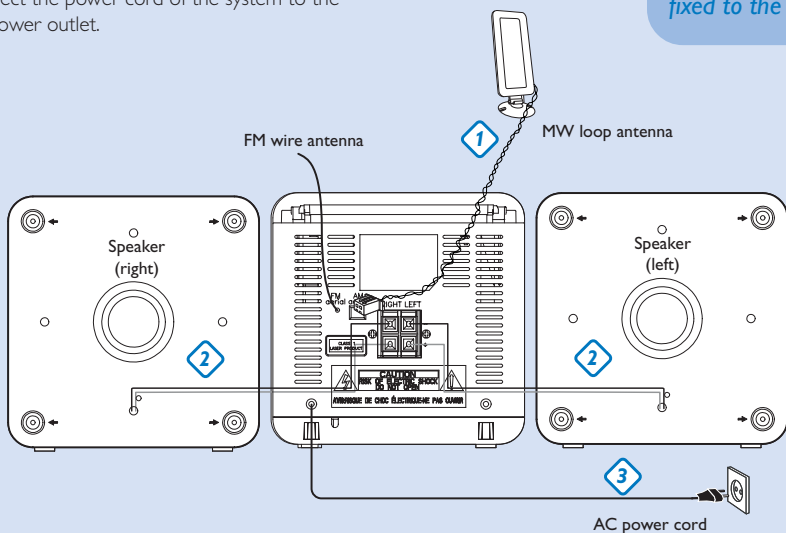

Setting the clock

- 1 In standby mode, press **PROG/CLOCK** button. The clock digits for the hours flash.
- 2 Press **◀◀/▶▶** to set the hours.
- 3 Press **PROG/CLOCK** again. The clock digits for the minutes flash.
- 4 Press **◀◀/▶▶** to set the minutes.
- 5 Press **PROG/CLOCK** to confirm the time.

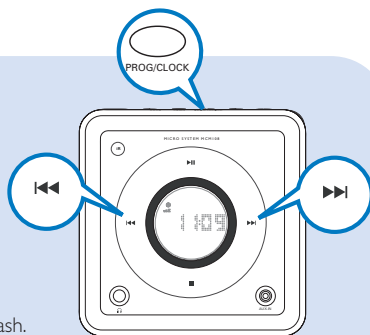

Step B **Enjoy**

Playing a disc

- 1 Select **CD** source.
- 2 Press **OPEN/CLOSE** on the top of the system to open the CD door.
- 3 Insert a disc with the printed side facing up and press down on **OPEN/CLOSE** to close the CD door.
- 4 Press **▶ ||** to start playback.
- 5 Press **■** to stop playback.

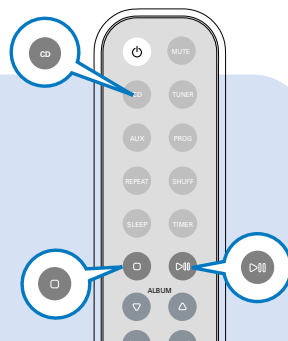

Listening to radio

- 1 Select **TUNER** source.
- 2 Press **BAND (TUNER)** on the remote control once or more to select your waveband.
- 3 Turn **TUNING ●** to tune to a station.

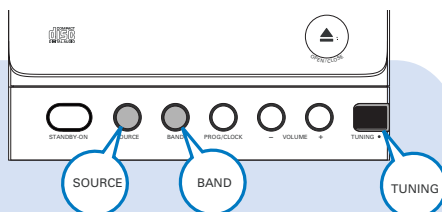

Tip

Detailed playback features and additional functions are described in the accompanied owner's manual.

Notes for the remote control:

- First, select the source you wish to control by pressing one of the source select keys on the remote control (CD or TUNER, for example).
- Then select the desired function (▶ ||, ◀, ▶ for example).

