

Micro DVD Theater

MCD802/98



# Quick start guide

**1** Connect

**2** Setup

**3** Enjoy

**PHILIPS**

EN

# What's in the box

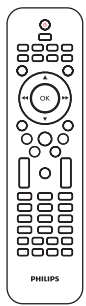

Remote Control

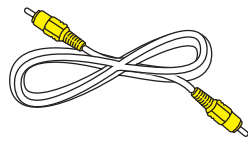

Composite video cable (yellow)

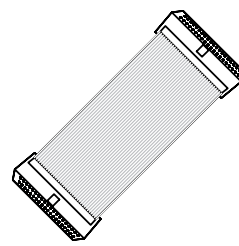

Control cable

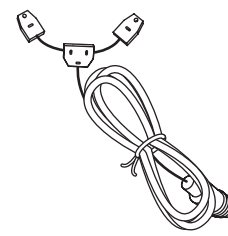

FM T-Type antenna

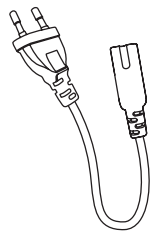

Power cord

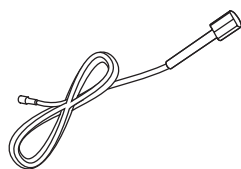

FM wire antenna

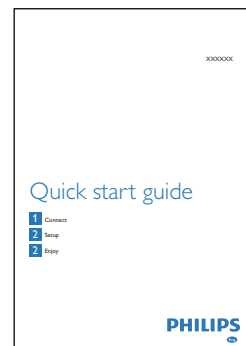

Quick Start Guide

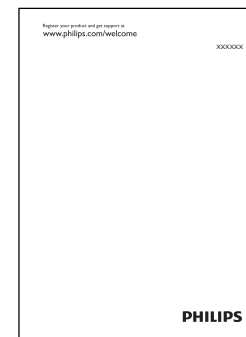

User manual

## 1 Connect

### A Install remote control batteries

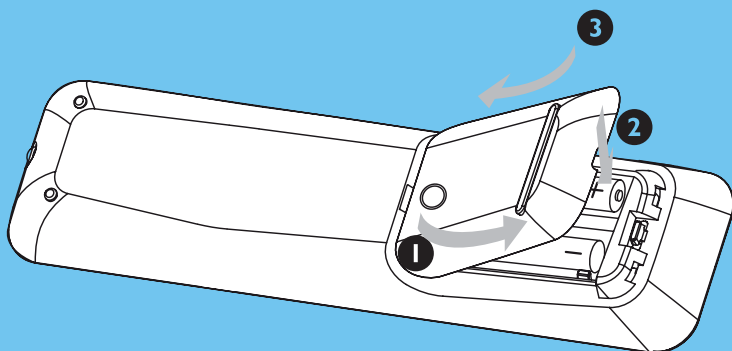

- 1 Open the battery compartment.
- 2 Insert 2 AAA batteries with correct polarity (+/-) as indicated.
- 3 Close the battery compartment.

### B Connect control cable

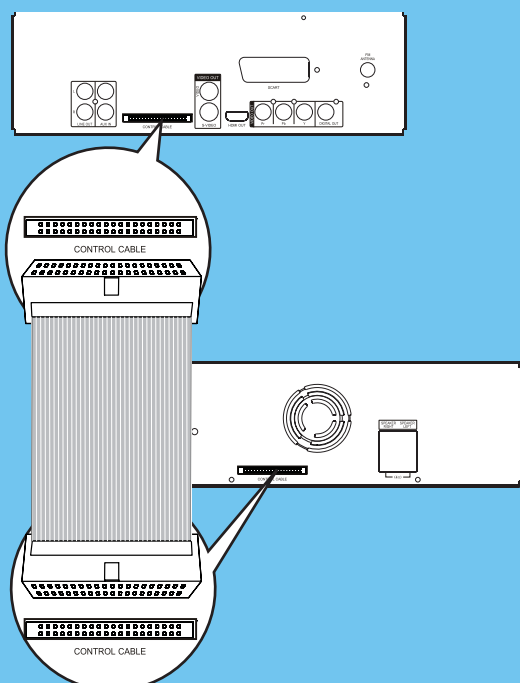

- 1 Connect the supplied control cable to the **CONTROL CABLE** jacks on the main unit.

# 1

# Connect

## C Connect speakers

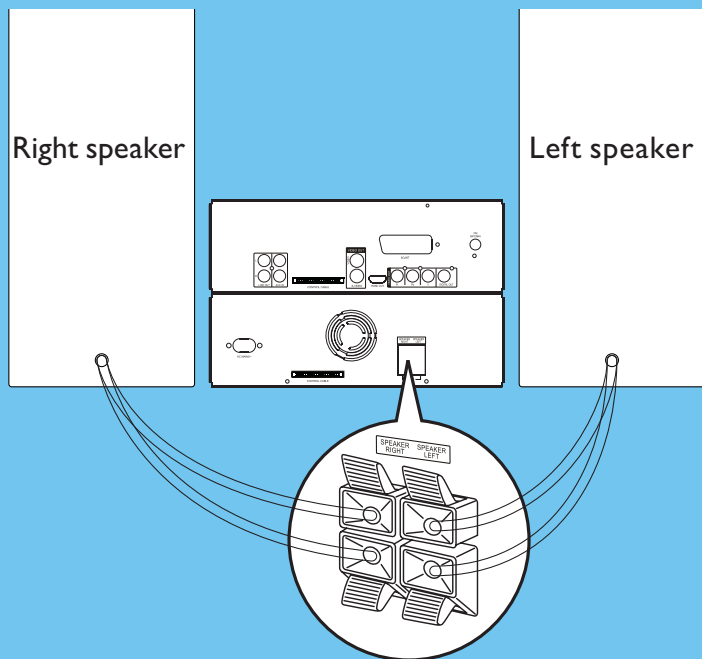

### Note

- Ensure that the colors of the speaker wires and terminals are matched.

- 1 Hold down the socket flap.
- 2 Insert the stripped part of the wire completely.
  - Insert the right speaker wires to “**SPEAKER RIGHT**”, left speaker wires to “**SPEAKER LEFT**”.
- 3 Release the socket flap.

## D Connect FM antenna

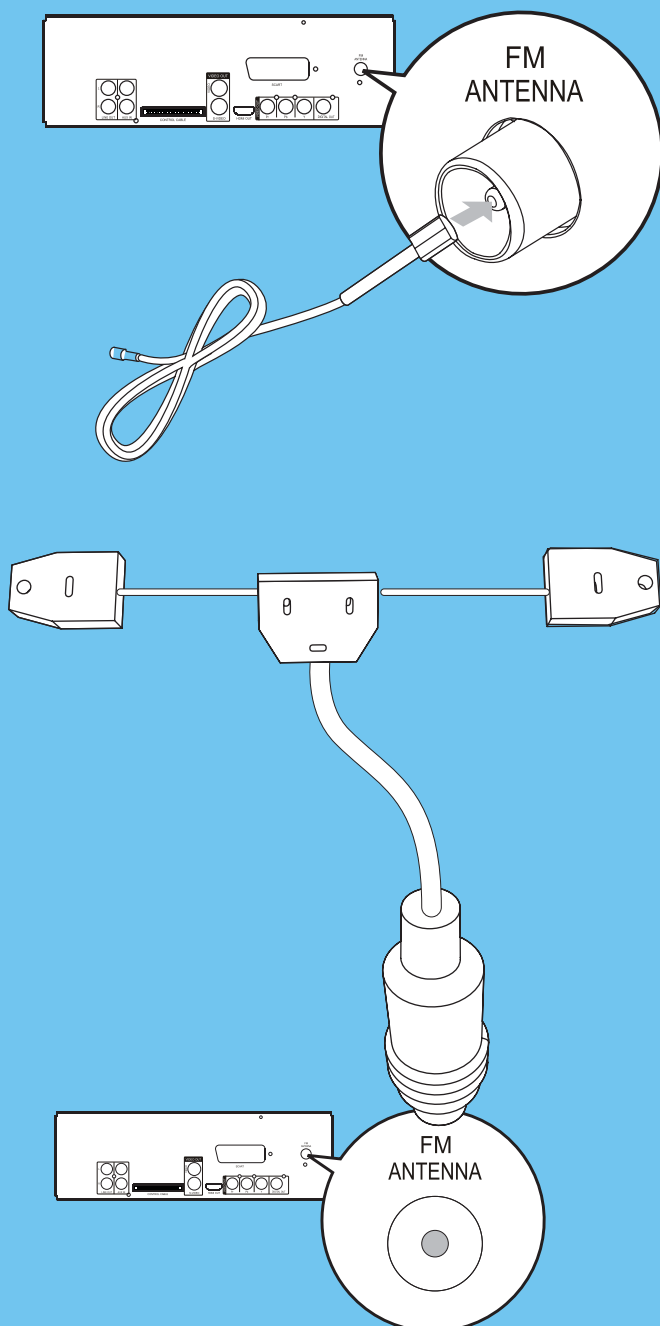

- 1 Connect the supplied FM wire antenna to the **FM ANTENNA** socket on the unit.

### For better reception, connect the **FM T-Type antenna**:

- 1 Connect the supplied FM T-Type antenna to the **FM ANTENNA** socket on the unit.
- 2 Stretch the antenna out to its full length, and affix it to the wall.

# 1

# Connect

## E Connect TV

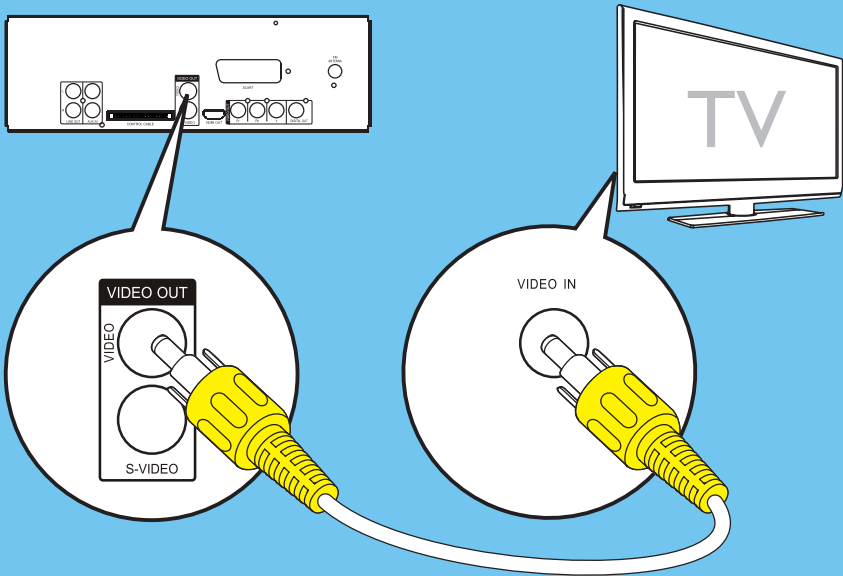

- 1 Connect the supplied composite video cable to:
  - the **VIDEO** socket on this unit.
  - the video input socket on the TV.

## F Connect power

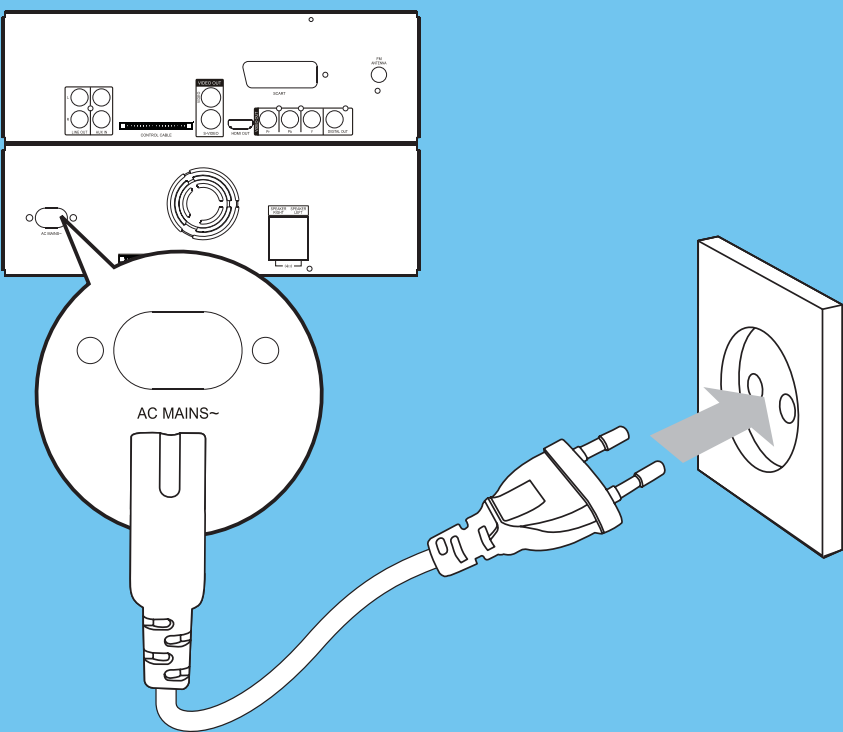

- 1 Switch the voltage selector at the bottom of the unit to the local power line voltage.
- 2 Connect the power cord to the **AC MAINS~** jack on the main unit.
- 3 Connect the power plug to the wall outlet.

### ! Caution

- Risk of product damage! Ensure that the power supply voltage corresponds to the voltage printed on the back or the underside of the unit.
- Risk of electric shock! When you unplug the AC power cord, always pull the plug from the socket. Never pull the cord.
- Before connecting the AC power cord, ensure you have completed all other connections.



### \* Tip

- See the User Manual for how to connect other devices to this system.

# 2

## Setup

### A Set the clock

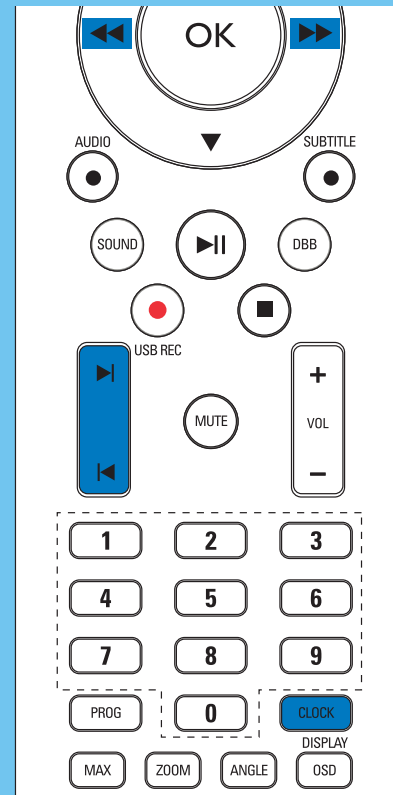

- 1 In standby mode, press **CLOCK** to activate the clock setting mode.
  - ↳ The time digits are displayed and begin to blink.
  - ↳ If the time digits are not displayed, press and hold  for more than 2 seconds to switch to standby mode, then repeat step 1.
- 2 Press  to set the hour.
- 3 Press  to set the minute.
- 4 Press and hold **CLOCK** to select 12-hour or 24-hour format.
- 5 Press **CLOCK** to confirm.



# 3



## Enjoy

### A Play disc

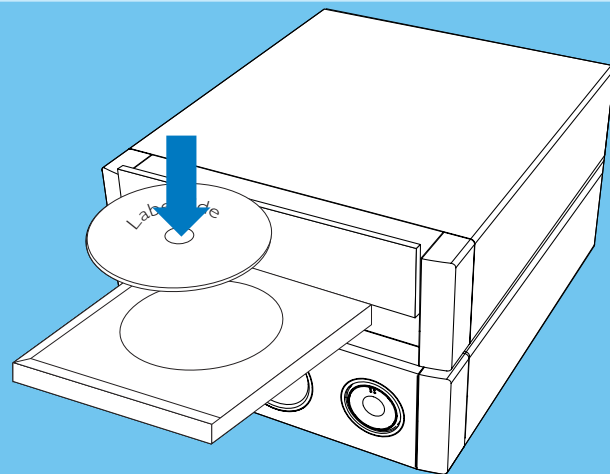
- 1 Press **DISC** to select the disc source.
- 2 Press  to open the disc compartment.
- 3 Insert a disc with the printed side facing up, then close the disc compartment.
  - ↳ Play starts automatically.
  - To pause/resume play, press .
  - To stop play, press .



### B Play from USB

- 1 Flip open the USB socket cover on the front panel.
- 2 Insert the USB plug of a USB device into the USB socket.
- 3 Press **USB** to select the USB source.
  - ↳ Play starts automatically.
  - To pause/resume play, press .
  - To stop play, press .

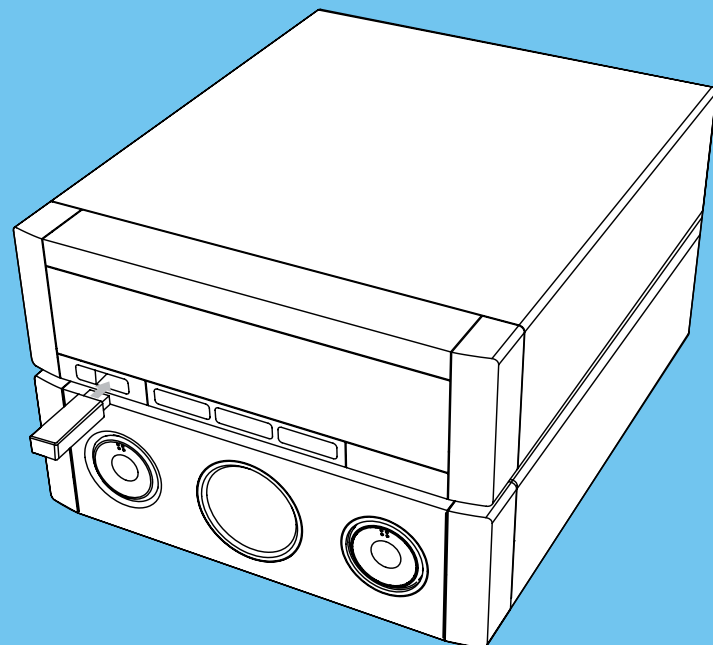

# 3

# Enjoy

## Program and tune to radio stations

### Tip

- For better FM stereo reception, connect the supplied T-Type antenna.
- For optimal reception, fully extend and adjust the position of the FM antenna.

### First time tuning

When you access to radio mode for the first time, follow the instructions to install the radio stations.

**1** Press **TUNER**.  
↳ 'AUTO INSTALL ... PRESS PLAY' is displayed.

**2** Press **▶||**.  
↳ All detected radio stations are stored.  
↳ Once complete, it tunes to the first preset radio station.

- To stop auto tuning, press **■**.

### Reinstall and listen to radio stations

- 1** Press **TUNER** to select the tuner source.
- 2** Press and hold **PROG** for more than 2 seconds to activate automatic program mode.  
↳ All available stations are programmed in the order of waveband reception strength.
- 3** Press **◀/▶** to select a preset number.

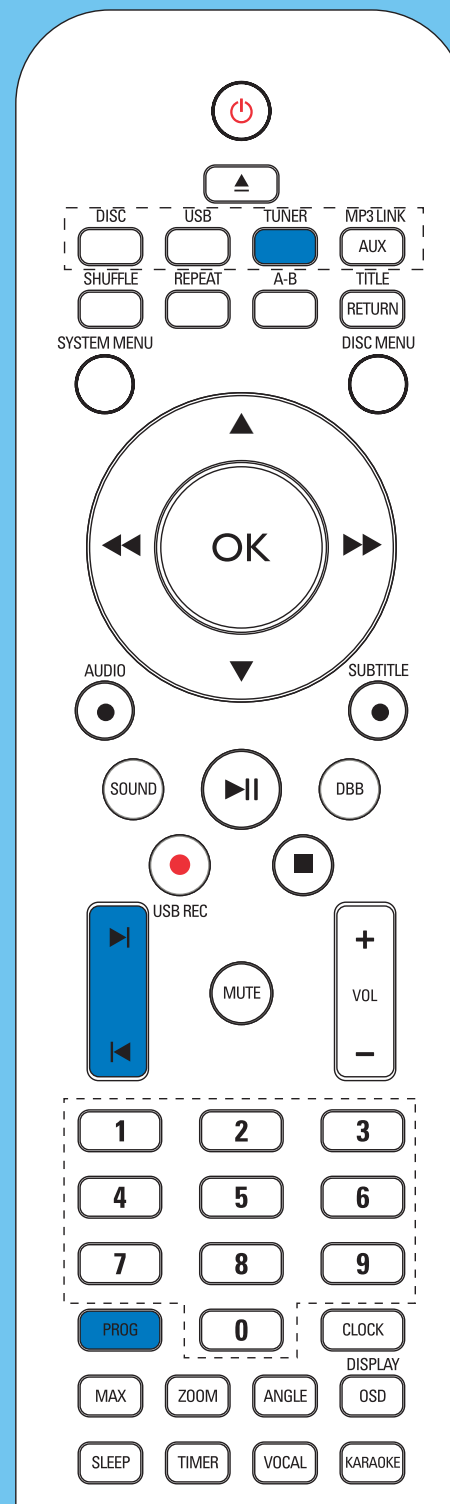

### Tip

- Detailed features and additional functions are described in the user manual.



© Royal Philips Electronics N.V. 2009  
All rights reserved.

Specifications are subject to change without notice.  
Trademarks are the property of Koninklijke Philips Electronics N.V. or their respective owners.