

Register your product and get support at  
[www.philips.com/welcome](http://www.philips.com/welcome)

MCD355



EN	User manual	3
TH	คู่มือผู้ใช้	31
ZH-TW	使用手冊	59
KO	사용 설명서	85

**PHILIPS**

# Contents

<b>1 Important</b>	4	<b>7 Adjust settings</b>	20
Safety	4	System settings	20
Notice	6	Playback settings	20
		Video settings	22
		Audio settings	22
<b>2 Your DVD Micro Theater</b>	7	<b>8 Other features</b>	24
Introduction	7	Set the sleep timer	24
What's in the box	7	Set the alarm timer	24
Overview of the main unit	8	Listen to an external device	24
Overview of the remote control	9	Listen through headphone	24
<b>3 Get started</b>	11	<b>9 Product information</b>	25
Connect speakers	11	Specifications	25
Connect FM antenna	11	Supported disc formats	26
Connect audio cables	11	USB playability information	26
Connect video cables	12	<b>10 Troubleshooting</b>	27
Connect power	12	<b>11 Glossary</b>	29
Install remote control battery	13		
Set clock	13		
Turn on	13		
<b>4 Play</b>	14		
Play discs	14		
Play from USB devices	14		
Play DivX video	14		
View pictures	15		
Play mixed contents	15		
Play control	16		
Play options	16		
<b>5 Listen to the radio</b>	18		
Tune to a radio station	18		
Program radio stations automatically	18		
Program radio stations manually	18		
Select a preset radio station	18		
<b>6 Adjust sound</b>	19		
Adjust volume	19		
Select a preset sound effect	19		
Select automatic loudness control	19		
Enhance bass	19		
Mute sound	19		

# 1 Important

## Safety

Know these safety symbols

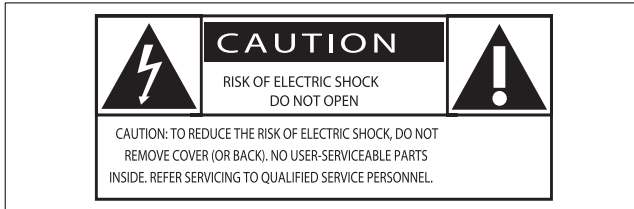

This 'bolt of lightning' indicates uninsulated material within your unit may cause an electrical shock. For the safety of everyone in your household, please do not remove product covering.

The 'exclamation point' calls attention to features for which you should read the enclosed literature closely to prevent operating and maintenance problems.

**WARNING:** To reduce the risk of fire or electric shock, this apparatus should not be exposed to rain or moisture and objects filled with liquids, such as vases, should not be placed on this apparatus.

**CAUTION:** To prevent electric shock, match wide blade of plug to wide slot, fully insert.

- ① Read these instructions.
- ② Keep these instructions.
- ③ Heed all warnings.
- ④ Follow all instructions.
- ⑤ Do not use this apparatus near water.
- ⑥ Clean only with dry cloth.

- ⑦ Do not block any ventilation openings. Install in accordance with the manufacturer's instructions.
- ⑧ Do not install near any heat sources such as radiators, heat registers, stoves, or other apparatus (including amplifiers) that produce heat.
- ⑨ Protect the power cord from being walked on or pinched, particularly at plugs, convenience receptacles, and the point where they exit from the apparatus.
- ⑩ Only use attachments/accessories specified by the manufacturer.
- ⑪ Use only with the cart, stand, tripod, bracket, or table specified by the manufacturer or sold with the apparatus. When a cart is used, use caution when moving the cart/apparatus combination to avoid injury from tip-over. 
- ⑫ Unplug this apparatus during lightning storms or when unused for long periods of time.
- ⑬ Refer all servicing to qualified service personnel. Servicing is required when the apparatus has been damaged in any way, such as power-supply cord or plug is damaged, liquid has been spilled or objects have fallen into the apparatus, the apparatus has been exposed to rain or moisture, does not operate normally, or has been dropped.
- ⑭ Battery usage **CAUTION** – To prevent battery leakage which may result in bodily injury, property damage, or damage to the unit:
  - Install all batteries correctly, + and - as marked on the unit.
  - Do not mix batteries (old and new or carbon and alkaline, etc.).
  - Remove batteries when the unit is not used for a long time.

- ⑮ Apparatus shall not be exposed to dripping or splashing.
- ⑯ Do not place any sources of danger on the apparatus (e.g. liquid filled objects, lighted candles).
- ⑰ This product may contain lead and mercury. Disposal of these materials may be regulated due to environmental considerations. For disposal or recycling information, please contact your local authorities or the Electronic Industries Alliance: [www.eiae.org](http://www.eiae.org).
- ⑱ Where the MAINS plug or an appliance coupler is used as the disconnect device, the disconnect device shall remain readily operable.



#### Warning

- Never remove the casing of this apparatus.
- Never lubricate any part of this apparatus.
- Never place this apparatus on other electrical equipment.
- Keep this apparatus away from direct sunlight, naked flames or heat.
- Never look into the laser beam inside this apparatus.
- Ensure that you always have easy access to the power cord, plug or adaptor to disconnect this apparatus from the power.

Risk of overheating! Never install this apparatus in a confined space. Always leave a space of at least four inches around this apparatus for ventilation. Ensure curtains or other objects never cover the ventilation slots on this apparatus.



#### Caution

- Use of controls or adjustments or performance of procedures other than herein may result in hazardous radiation exposure or other unsafe operation.

## Hearing safety

### Listen at a moderate volume.

- Using headphones at a high volume can impair your hearing. This product can produce sounds in decibel ranges that may cause hearing loss for a normal person, even for exposure less than a minute. The higher decibel ranges are offered for those that may have already experienced some hearing loss.
- Sound can be deceiving. Over time your hearing 'comfort level' adapts to higher volumes of sound. So after prolonged listening, what sounds 'normal' can actually be loud and harmful to your hearing. To guard against this, set your volume to a safe level before your hearing adapts and leave it there.

### To establish a safe volume level:

- Set your volume control at a low setting.
- Slowly increase the sound until you can hear it comfortably and clearly, without distortion.

### Listen for reasonable periods of time:

- Prolonged exposure to sound, even at normally 'safe' levels, can also cause hearing loss.
- Be sure to use your equipment reasonably and take appropriate breaks.

### Be sure to observe the following guidelines when using your headphones.

- Listen at reasonable volumes for reasonable periods of time.
- Be careful not to adjust the volume as your hearing adapts.
- Do not turn up the volume so high that you can't hear what's around you.
- You should use caution or temporarily discontinue use in potentially hazardous situations. Do not use headphones while operating a motorized vehicle, cycling, skateboarding, etc.; it may create a traffic hazard and is illegal in many areas.

# Notice

Any changes or modifications made to this device that are not expressly approved by Philips Consumer Lifestyle may void the user's authority to operate the equipment.

Your product is designed and manufactured with high quality materials and components, which can be recycled and reused.



When this crossed-out wheeled bin symbol is attached to a product it means that the product is covered by the European Directive 2002/96/EC. Please inform yourself about the local separate collection system for electrical and electronic products.



Please act according to your local rules and do not dispose of your old products with your normal household waste. Correct disposal of your old product helps to prevent potential negative consequences for the environment and human health.

Your product contains batteries covered by the European Directive 2006/66/EC, which cannot be disposed with normal household waste. Please inform yourself about the local rules on separate collection of batteries because correct disposal helps to prevent negative consequences for the environmental and human health.



## Environmental information

All unnecessary packaging has been omitted. We have tried to make the packaging easy to separate into three materials: cardboard (box), polystyrene foam (buffer) and polyethylene (bags, protective foam sheet.)

Your system consists of materials which can be recycled and reused if disassembled by a specialized company. Please observe the local regulations regarding the disposal of packaging

materials, exhausted batteries and old equipment.

Manufactured under license  from Dolby Laboratories. Dolby, Pro Logic, and the double-D symbol are trademarks of Dolby Laboratories.

Official DivX® Certified product. Plays all versions of DivX® video (including DivX® 6) with standard playback of DivX® media files.



Windows Media and the Windows logo are trademarks, or registered trademarks of Microsoft Corporation in the United States and/or other countries.



The making of unauthorized copies of copy-protected material, including computer programs, files, broadcasts and sound recordings, may be an infringement of copyrights and constitute a criminal offence. This equipment should not be used for such purposes.



**This apparatus includes this label:**



## Note

- The type plate is located on the back of the apparatus.

## 2 Your DVD Micro Theater

Congratulations on your purchase, and welcome to Philips! To fully benefit from the support that Philips offers, register your product at [www.philips.com/welcome](http://www.philips.com/welcome).

### Introduction



With this apparatus, you can enjoy:

- Video from DVDs, VCDs, and DivX files that are stored on USB devices.
- Audio from audio CDs, radio, external devices, and MP3/WMA files that are stored on USB devices.
- Pictures from picture discs or stored on USB devices.

The apparatus offers you multiple sound effect settings that enrich sound with Digital Sound Control (DSC) and Dynamic Bass Boost (DBB). The apparatus supports the following media formats:



You can play DVDs with the following region code:

DVD region code	Countries
	Asia Pacific, Taiwan, Korea
	Australia, New Zealand

### What's in the box

Check and identify the contents of your package:

- Main unit
- Loudspeaker boxes x 2
- Remote control with battery
- Audio/video cable
- MP3 link cable
- Quick start guide
- User Manual

# Overview of the main unit

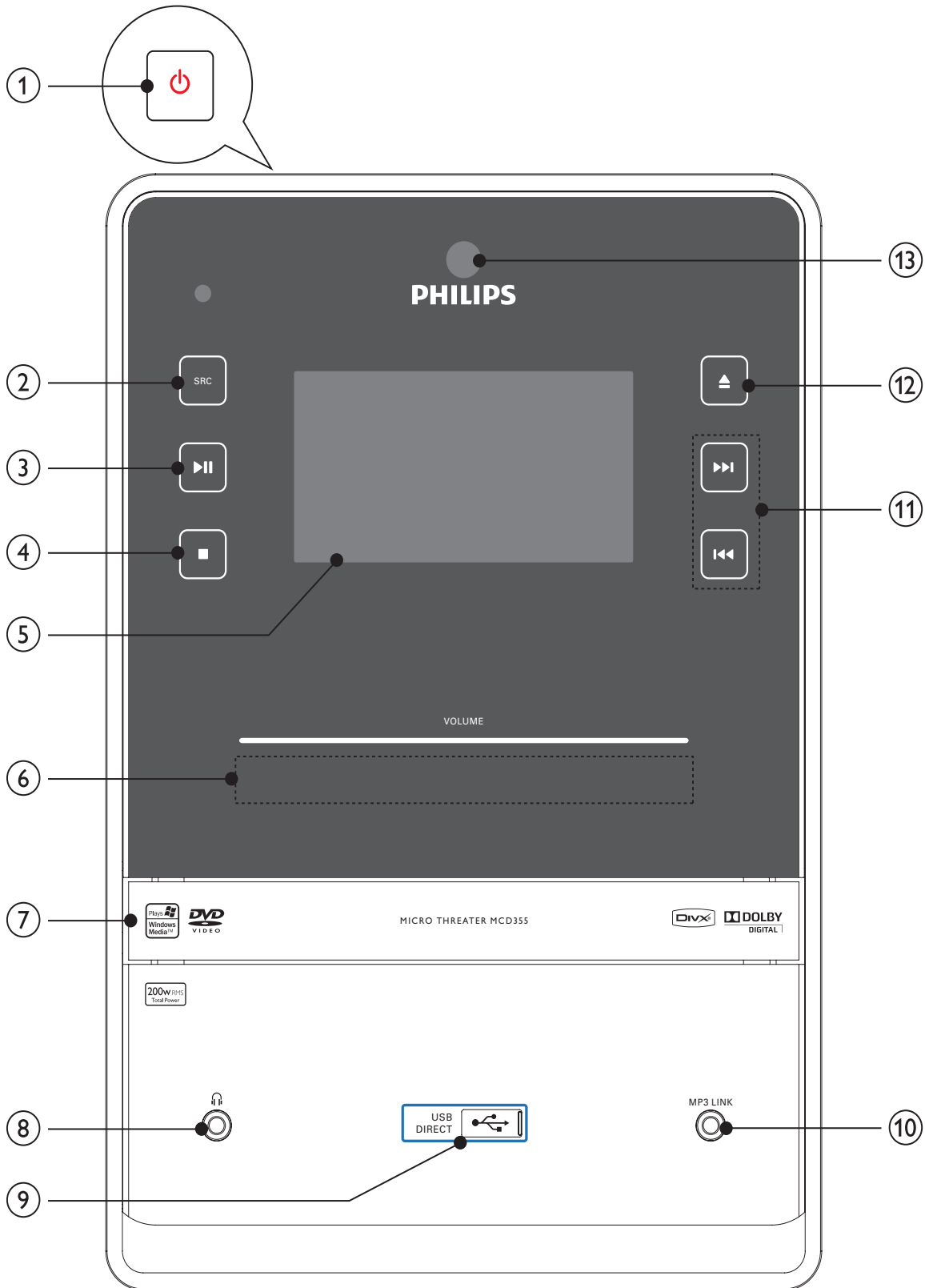





- ①  Turn on the apparatus; switch to standby mode.

- ② **SRC**  
• Select a source.

- ③  Start or pause play.

- ④  Stop play.  
• Erase a program.

- ⑤ **Display panel**
  - Display current status.
- ⑥ **Volume touch control**
  - Adjust volume.
- ⑦ **Disc compartment**
- ⑧ 
  - Connect headphone.
- ⑨ 
  - USB socket.
- ⑩ **MP3 LINK**
  - Jack for an external audio device.
- ⑪ 
  - Skip to the previous/next track.
  - Skip to the previous/next title or chapter.
  - Select a preset radio station.
- ⑫ 
  - Open or close the disc compartment.
- ⑬ **Remote control sensor**

## Overview of the remote control

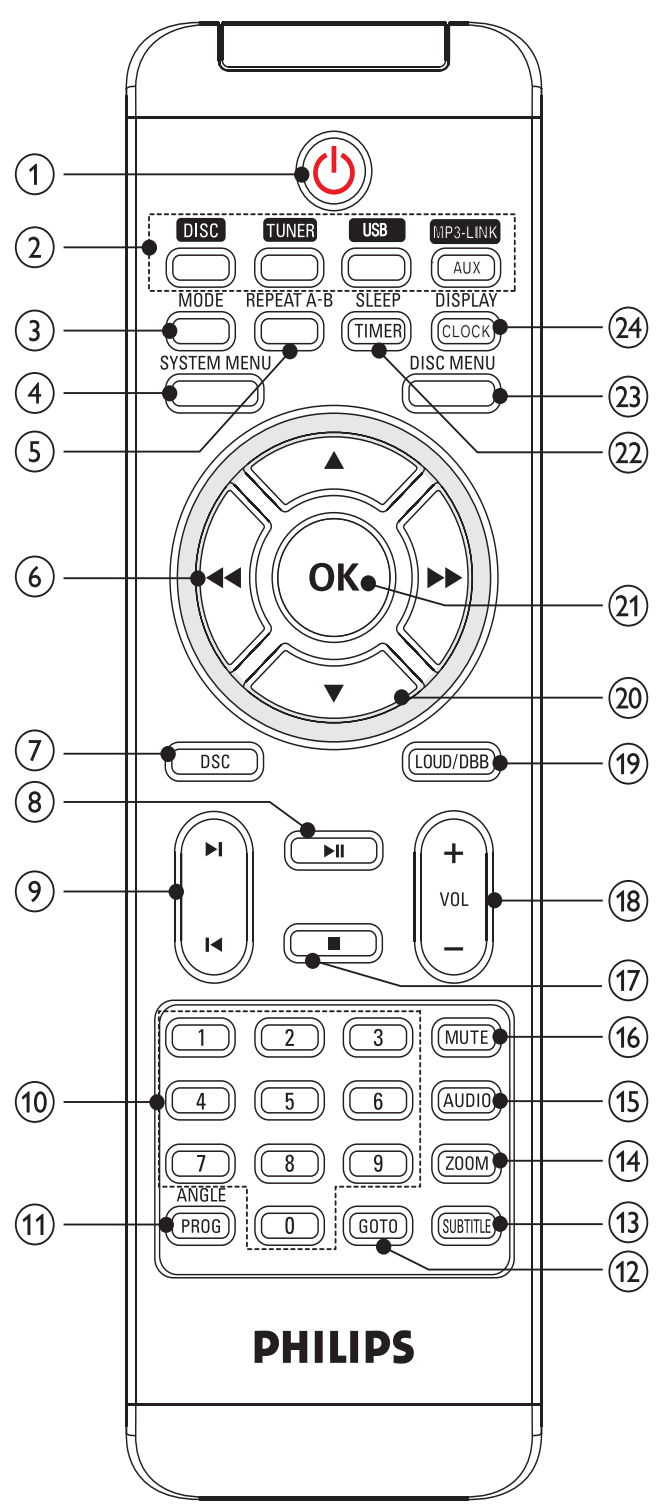

- ① 
  - Switch to standby mode.
- ② **Source selection keys**
  - Select a source.
- ③ **MODE**
  - Select a repeat/shuffle play mode.



- ④ **SYSTEM MENU**
  - Access or exit the system setup menu.
- ⑤ **REPEAT A-B**
  - Mark the section for repeat play, or turn off repeat mode.
- ⑥ **◀◀▶▶**
  - Search fast forward or fast backward.
  - Tune to a radio station.
  - Navigate left/right in the disc menu or system setup menu.
- ⑦ **DSC**
  - Select a preset sound setting.
- ⑧ **▶||**
  - Start or pause play.
- ⑨ **◀▶**
  - Skip to the previous/next track.
  - Skip to the previous/next title or chapter.
  - Select a preset radio station.
- ⑩ **Numeric keypad 0-9**
  - Select a specified title/chapter/track directly.
- ⑪ **PROG/ANGLE**
  - Program radio stations.
  - Select a DVD camera angle.
  - Program titles/chapters/tracks.
- ⑫ **GOTO**
  - Skip to a specific section of the disc during play quickly.
- ⑬ **SUBTITLE**
  - Select a subtitle language.
- ⑭ **ZOOM**
  - Zoom in or out a picture/video image on the TV screen.
- ⑮ **AUDIO**
  - For DVD/DivX video, select an audio language.
  - For VCD, select stereo, mono-left or mono-right output.
- ⑯ **MUTE**
  - Mute or restore volume.
- ⑰ **■**
  - Stop play or erase a program.
- ⑱ **VOL +/-**
  - Adjust volume.
- ⑲ **LOUD/DBB**
  - Turn on or off automatic loudness adjustment.
  - Turn on or off dynamic bass enhancement.
- ⑳ **▲▼**
  - Skip to the previous/next album.
  - Navigate up/down in the disc menu or system setup menu.
- ㉑ **OK**
  - Confirm a selection.
- ㉒ **TIMER/SLEEP**
  - Set the sleep timer.
  - Set the alarm timer.
  - Activate or deactivate timer.
- ㉓ **DISC MENU**
  - Access or exit the disc menu.
- ㉔ **CLOCK/DISPLAY**
  - Set the clock.
  - Display information on the TV screen during play.

# 3 Get started



## Caution

- Use of controls or adjustments or performance of procedures other than herein may result in hazardous radiation exposure or other unsafe operation.

Always follow the instructions in this chapter in sequence.

If you contact Philips, you will be asked for the model and serial number of this apparatus. The model number and serial number are on the back of the apparatus. Write the numbers here:

Model No. \_\_\_\_\_

Serial No. \_\_\_\_\_

## Connect speakers



## Note

- Ensure that the colors of the speaker wires and terminals are matched.

- 1 Hold down the socket flap.
- 2 Insert the stripped part of the wire completely.
  - Insert the right speaker wires to "Right L/Right H", left speaker wires to "Left L/Left H".
  - Insert the red/blue wires to "+", black wires to "-".
- 3 Release the socket flap.
- 4 Connect the subwoofer to "SUBWOOFER OUT" socket.

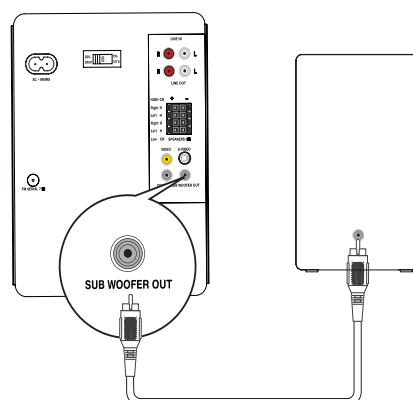
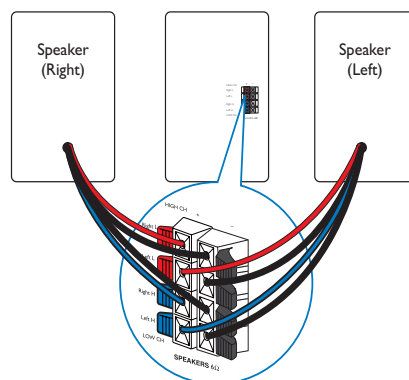
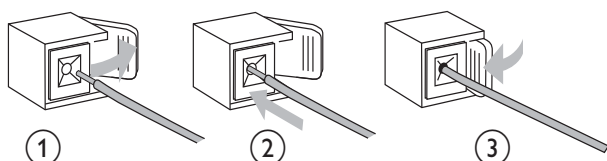

## Connect FM antenna

- 1 Connect the supplied FM antenna to the **FM AERIAL** jack on the main unit.

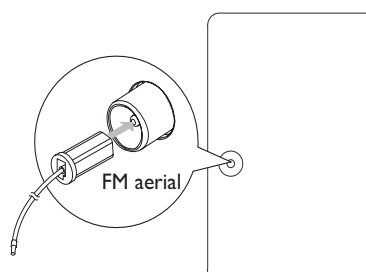

## Connect audio cables

To hear audio from other audio devices as well as the accompanied speakers, select a preferred audio connection:

- Option 1: connect a coaxial cable
- Option 2: connect analog audio cables

---

## Option 1: connect coaxial cable

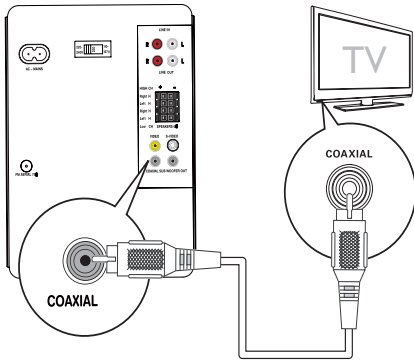

You can enjoy multi-channel surround sound from this apparatus when it is connected to a digital audio device.

- 1 Connect a coaxial cable (not supplied) to the digital input socket on the audio device.

---

## Option 2: connect analog audio cables

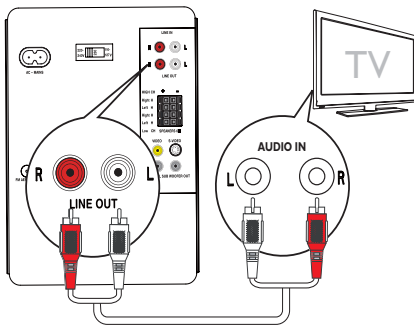

- 1 Connect an audio cable (red/white ends) to the audio input sockets on an audio device.

---

## Connect video cables

You can select the best video connection that your TV supports.

- Option 1: connect through an S-Video cable (for a standard TV).
- Option 2: connect through a the composite video (CVBS) cable (for a standard TV).

---

## Option 1: connect S-Video cable

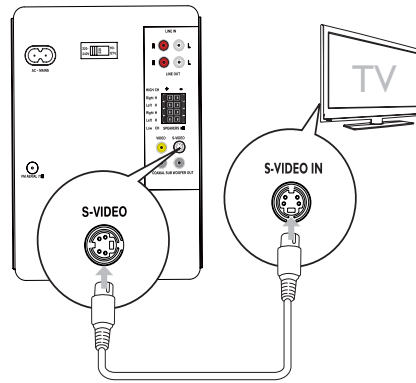

- 1 Connect an S-video cable (not supplied) to:
  - the **S-Video** socket on this unit.
  - the **S-Video** socket on the TV.

---

## Option 2: connect composite video cable

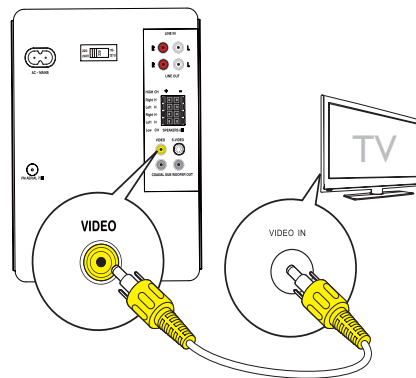

- 1 Connect the supplied composite video cable to:
  - the **VIDEO** socket on this unit.
  - the video input socket on the TV.

---

## Connect power

### ! Caution

- Risk of product damage! Ensure that the power supply voltage corresponds to the voltage printed on the back or the underside of the unit.
- Risk of electric shock! When you unplug the AC power cord, always pull the plug from the socket. Never pull the cord.
- Before connecting the AC power cord, ensure you have completed all other connections.

- 1 Switch the voltage selector to the local power line voltage.
- 2 Connect the power cord to the **AC~MAINS** jack on the main unit.
- 3 Connect the power plug to the wall outlet.

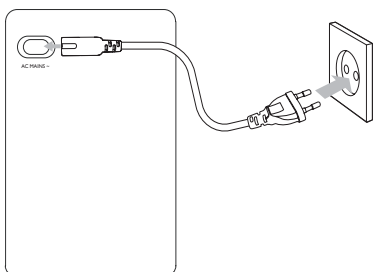

## Install remote control battery

### ! Caution

- Risk of explosion! Keep batteries away from heat, sunshine or fire. Never discard batteries in fire.
- Risk of decreased battery life! Never mix different brands or types of batteries.
- Risk of product damage! When the remote control is not used for long periods, remove the batteries.

#### For first-time use:

- 1 Remove the protective tab to activate the remote control battery.

#### To replace the remote control battery:

- 1 Open the battery compartment.
- 2 Insert 1 CR2025 battery with correct polarity (+/-) as indicated.
- 3 Close the battery compartment.

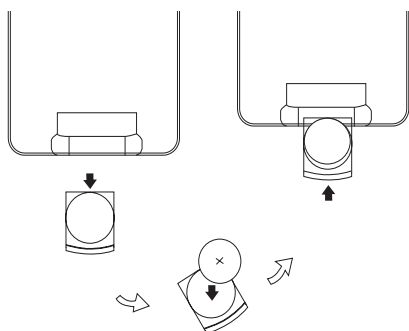

## Set clock

- 1 In standby mode, press and hold **CLOCK/DISPLAY** to activate the clock setting mode.
  - ↳ [SET CLOCK] (set clock) is displayed briefly. Then the hour digits are displayed and begin to blink.
- 2 Press **VOL +/-** to set the hour.
- 3 Press **CLOCK/DISPLAY** to confirm.
  - ↳ The minute digits are displayed and begin to blink.
- 4 Press **VOL +/-** to set the minute.
- 5 Press **CLOCK/DISPLAY** to confirm.

## Turn on

- 1 Press **⏻** on the main unit.
  - ↳ The unit switches to the last selected source.

## Switch to standby

- 1 Press **⏻** to switch the unit to standby mode.
  - ↳ The backlight on the display panel turns off.
  - ↳ The clock (if set) appears on the display panel.

# 4 Play



## Caution

- Risk of damage to the unit! During play, never move the unit.

---

## Play discs



## Caution

- Never look at the laser beam inside the unit.
- Risk of product damage! Never play discs with accessories such as disc stabilizer rings or disc treatment sheets.
- Do not push on the disc tray or put any objects other than discs on the disc tray. It may cause the disc player to malfunction.



## Note

- With some disc/file types, play may differ.
- Only the first session of a multi-sessioned CD is played.
- This unit does not support MP3PRO audio format.
- If any special characters are present in the MP3 track name (ID3) or album name, it might not be displayed correctly on the screen because these characters are not supported.

- 1 Press **DISC** to select the disc source.
- 2 Press **▲** to open the disc compartment.
- 3 Insert a disc with the printed side facing up, then close the disc door.
  - ↳ Play starts.
  - ↳ To stop play, press **■**.
  - ↳ To pause or resume play, press **▶||**.
  - ↳ For video discs, play always resumes from the point where it was last stopped.
  - ↳ To start play from the beginning, press **◀** while the message is displayed.

For MP3/WMA audio files on a recordable DVD, CD.

- Press **▲▼** or enter a folder number to select a folder.
- Press **◀/▶** to select a track or file.

You can search content fast forward or backward during play.

- Press **◀◀/▶▶** to select required speed.
- To return to normal play speed, press **▶||**.
- Press **◀/▶** to select the previous or next chapter/title/track.

You can select a subtitle language on DVDs or DivX® discs.

- During play, press **SUBTITLE**.



## Tip

- For some DVDs, the language can only be changed from the disc menu. Press **DISC MENU** to access the menu.

---

## Play from USB devices



## Note

- Ensure that the USB device contains playable audio contents for supported formats.

- 1 Insert the USB connector on the device into the  socket.
- 2 Press **USB**.
- 3 Press **▲▼** to select a folder.
- 4 Press **◀/▶** to select a file.
  - To stop play, press **■**.
  - To pause or resume play, press **▶||**.

---

## Play DivX video

You can play DivX files copied onto a CD-RW, recordable DVD or USB device.

- 1 Insert a disc or connect a USB device.

- 2 Select a source:
  - For discs, press **DISC**.
  - For USB devices, press **USB**.
- 3 Select a file to play and press **OK**.
  - To stop play, press **■**.
  - To pause or resume play, press **▶||**.
  - To change a subtitle language, press **SUBTITLE**.



#### Note

- Subtitle files with the following filename extensions (.srt, .smi, .sub, .ssa, .ass) are supported but do not appear on the file navigation menu.
- The subtitle filename has to be the same as the file name of the video.

## View pictures

You can view JPEG files as a slide show.

- 1 Insert a picture disc or connect a USB device.
- 2 Select a source:
  - For discs, press **DISC**.
  - For USB devices, press **USB**.
- 3 Press **▲▼** to select a folder.
- 4 Press **◀▶** to select a file.

### Slide show play modes

You can view pictures as slide show in different play modes.

- 1 Press **PROG/ANGLE** repeatedly.

### View from different angles

- 1 During playback, press **▲▼/◀▶** to rotate/flip the picture.

## Play mixed contents

You can play a mixed disc or USB flash disk containing MP3/WMA files, JPEG photos, or MPEG video files.

### Play photos

- 1 Press **SUBTITLE** repeatedly to navigate to media type icons.
- 2 Press **DISC MENU** or **SUBTITLE** repeatedly to select the photo icon and then press **OK**.
- 3 Press **▲**.
- 4 Press **▲▼/◀▶** to select a photo.
- 5 Press **OK** to start sequential play.
  - Press **◀▶** to skip to previous/next photo.
  - Press **▶||** to pause or resume play.
  - Press **■** to stop play.

### Play video

- 1 Press **SUBTITLE** repeatedly to navigate to media type icons.
- 2 Press **DISC MENU** or **SUBTITLE** repeatedly to select **📺** and then press **OK**.
- 3 Press **▲**.
- 4 Press **▲▼/◀▶** to select a video file.
  - Press **▶||** to start or pause play.
  - Press **■** to stop play.
  - To return to music play, stop play and then press **SUBTITLE** repeatedly to select **🎵**.

---

## Play control

---

### Repeat and random play

You can select various repeat functions during playback. The repeat play options vary depending on the disc type.

- 1 Press **MODE** repeatedly to choose a play mode.
  - For DVD
    - **[CHAPTER]** (chapter): repeat the current chapter
    - **[TITLE]** (title): repeat the current title
    - **[REP ALL]** (repeat all): repeat the disc
    - **[OFF]** (off): switch off the repeat mode
  - For VCD/MP3/CD/DivX
    - **[REP 1]** (repeat 1): repeat the current track
    - **[REP DIR]** (repeat directory) (for MP3 disc only): repeat the current folder
    - **[REP ALL]** (repeat all): repeat the disc
    - **[SHUF]** (shuffle): play the disc in random order
    - **[OFF]** (off): switch off the repeat mode
- 1 To return to normal play, press **MODE** repeatedly until play mode is no longer displayed.

 **Note**

- Shuffle play cannot be selected when you play programmed tracks.

---

## Repeat A-B (DVD/VCD/CD/MP3/WMA)

- 1 During music or video play, press **REPEAT A-B** at the start point.
- 2 Press **REPEAT A-B** at the end point.
  - ↳ The section starts to play repeatedly.
  - ↳ To cancel repeat play, press **REPEAT A-B** again.

 **Note**

- The section A and B can be set only within the same chapter/track.

---

## Search by time or scene/track number

When playing video or music discs, you can select a scene, track or a specified point.

- 1 During play, press **GOTO** until the time or chapter/track field is displayed.
  - For the time field, enter the play position in hours, minutes and seconds.
  - For the chapter/track field, enter the chapter/track number.

---

## Play options

---

### Display play information

- 1 During play, press **CLOCK/DISPLAY** repeatedly to select different play information.

---

## Program

 Note

- You cannot program picture files/discs.

You can program favourite tracks/chapters for playback in specified order.

- 1 Press **PROG/ANGLE** to enter program mode.
- 2 Press **◀▶** to select a sequence number.
- 3 Select an album (A), track (T), or title (T), chapter (C).
  - For MP3/WMA files, press **▲▼** to select an album (A) and then press **◀▶** to select a track (T).
  - For DVD discs, press **▲▼** to select a title (T) and then press **◀▶** to select a chapter (C).
- 4 Repeat steps 2-3 to program more tracks or chapters.
- 5 When the program is complete, press **▶||** to start play.
  - To change a program, repeat the steps above.
  - To clear the program, press **■** twice.

---

## Change camera angle

Some DVDs contain alternate scenes, such as scenes recorded from different camera angles. For such DVDs, you can select from the available alternate scenes.

- 1 Press **PROG/ANGLE** repeatedly to switch between camera angles.

---

## Select an audio language

You can select an audio language on DVDs, DivX video or VCDs.

- 1 During disc play, press **AUDIO**.
  - ↳ The language options appear. If the selected audio channels is unavailable, the default disc audio channel is used.

 Note

- For some DVDs, the language can only be changed from the disc menu. Press **DISC MENU** to access the menu.

---

## Zoom in/out image

- 1 During video/picture play, press **ZOOM** repeatedly to zoom in/out the image.
  - When the image is zoomed in, you can press **◀▶/▲/▼** to pan through the image.



# 5 Listen to the radio

## Tune to a radio station

### Note

- For optimal reception, fully extend and adjust the position of the FM antenna.
- The unit does not support MW radio reception.

- 1 Press **TUNER** to select the tuner source.
- 2 Press and hold **◀▶** for more than 2 seconds.
  - ↳ **[SEARCH]** (search) is displayed.
  - ↳ The radio tunes to a station with strong reception automatically.
- 3 Repeat step 2 to tune to more stations.
  - To tune to a weak station, press **◀▶** repeatedly until you find optimal reception.

## Program radio stations automatically

### Note

- You can program a maximum of 40 preset radio stations.

- 1 In tuner mode, press and hold **PROG/ANGLE** for 2 seconds to activate automatic program mode.
  - ↳ **[AUTO]** (auto) is displayed.
  - ↳ All available stations are programmed in the order of waveband reception strength.
  - ↳ The first programmed radio station is broadcast automatically.

## Program radio stations manually

### Note

- You can program a maximum of 40 preset radio stations.

- 1 Tune to a radio station.
- 2 Press **PROG/ANGLE** to activate program mode.
  - ↳ **[PROG]** (program) blinks on the display.
- 3 Press **◀▶** to allocate a number (1 to 40) to this radio station, then press **PROG/ANGLE** to confirm.
  - ↳ The preset number and the frequency of the preset station are displayed.
- 4 Repeat the above steps to program other stations.

### Note

- To overwrite a programmed station, store another station in its place.

## Select a preset radio station

- 1 In tuner mode, press **◀▶** to select a preset number.

## 6 Adjust sound

### Adjust volume

- 1 During play, to adjust volume:
  - On the remote control: press **VOL +/-**.
  - On the main unit: slide across the volume control on the front panel.

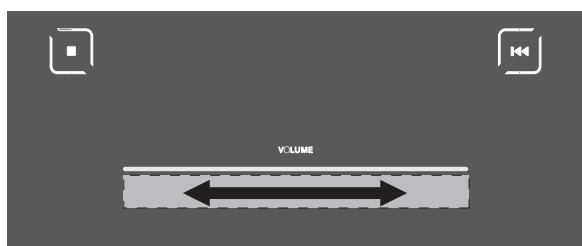

### Select a preset sound effect

- 1 During play, press **DSC** repeatedly to select:
  - [POP] (pop)
  - [CLASSIC] (classic)
  - [ROCK] (rock)
  - [JAZZ] (jazz)

### Select automatic loudness control

The loudness feature enables the system to increase the treble and bass sound effect at low volume automatically (the higher the volume, the lower the treble and bass increase).

- 1 During play, press **LOUD/DBB** to turn on/off automatic loudness control.

### Enhance bass

- 1 During play, press **LOUD/DBB** to turn on or off dynamic bass enhancement.
  - ↳ If DBB is activated, DBB is displayed.

### Mute sound

- 1 During play, press **MUTE** to mute/unmute sound.

# 7 Adjust settings

## System settings

### Change system menu language

- 1 Press **SYSTEM MENU**.
- 2 Select **[LANGUAGE SETUP]** (language setup) > **[OSD LANGUAGE]** (OSD language), and then press **▶▶**.
- 3 Select an option and then press **OK**.
- 4 Press **SYSTEM MENU** to exit.

### Set screen saver

The screen saver protects the TV screen damage due to prolonged exposure to a static image.

- 1 Press **SYSTEM MENU**.  
↳ The system setup menu is displayed.
- 2 Select **[SYSTEM SETUP]** (system setup) > **[SCREEN SAVER]** (screen saver), and then press **▶▶**.
- 3 Select an option and then press **OK**.
  - **[ON]** (on)  
Enable the screen saver.
  - **[OFF]** (off)  
Disable the screen saver.
- 4 Press **SYSTEM MENU** to exit.

### Restore default settings

You can reset all options and your personal settings to factory default settings.

- 1 Press **SYSTEM MENU**.
- 2 Select **[SYSTEM SETUP]** (system setup) > **[DEFAULT]** (default), and then press **▶▶**.
- 3 Select **[RESTORE]** (restore) and press **OK**.
- 4 Press **SYSTEM MENU** to exit.

## Playback settings

### Select preferred language



#### Note

- If the selected language is not available on the disc, the default disc language is used.

- 1 Press **SYSTEM MENU**.
- 2 Select **[LANGUAGE SETUP]** (language setup).
- 3 Select one of the following options, and then press **▶▶**.
  - **[AUDIO LANG]** (audio language)  
Select the preferred audio language for DVD play.
  - **[SUBTITLE LANG]** (subtitle language)  
Select the preferred subtitle language for DVD play.
  - **[MENULANG]** (menu language)  
Select the preferred language for on-screen display.
- 4 Select an option and then press **OK**.
- 5 Press **SYSTEM MENU** to exit.

### Select TV type

The TV format determines the aspect ratio of display according to the type of TV you have connected.

- 1 Press **SYSTEM MENU**.
- 2 Select **[SYSTEM SETUP]** (system setup) > **[TV TYPE]** (tv type), and then press **▶▶**.
- 3 Select an option, and then press **OK**.
  - **[4:3PS]**  
For 4:3 screen TV: full-height display with the trimmed sides.
  - **[4:3LB]**  
For 4:3 screen TV: wide-screen display with black bars on the top and bottom of the screen.
  - **[16:9]**  
For wide-screen TV: display ratio 16:9.

## Select TV system

Select the color system that matches the connected TV.

- 1 Press **SYSTEM MENU**.
- 2 Select **[SYSTEM SETUP]** (system setup) > **[TV SYSTEM]** (tv system), and then press **▶▶**.
- 3 Select an option and then press **OK**.
  - **[NTSC]**  
For TV with NTSC color system.
  - **[PAL]**  
For TV with PAL color system.
  - **[AUTO]** (auto)  
For TV with multiple color systems.
- 4 Press **SYSTEM MENU** to exit.

## Restrict DVD play

Some DVDs may have a parental level assigned to the complete disc or to certain scenes on the disc. You can set a playback permission level for the scenes with this setting.



### Note

- VCD, SVCD, and CD have no level indication, so parental control function has no effect on those kind of discs. Some DVDs are not encoded with a rating though the movie rating may be printed on the Disc cover. The rating level features does not work for such discs.

- 1 Press **SYSTEM MENU**.
- 2 Select **[SYSTEM SETUP]** (system setup) > **[RATING]** (rating), and then press **▶▶**.
- 3 Select an option and then press **OK**.
  - ↳ DVDs that are rated above the level you selected does not play unless you enter your four-digit password and choose a higher level rating.
  - ↳ **[1 KID SAFE]**  
Suitable for children.
  - ↳ **[2 G]**

Recommended as acceptable for viewers of all ages.

### ↳ **[3 PG]**

Parental guidance suggested.

### ↳ **[4 PG13]**

Material is unsuitable for children under age 13. Parental guidance suggested.

### ↳ **[5 PG-R], [6 R]**

Recommended that parents restrict children under 17 from viewing or allow them to view only when supervised by a parent or adult guardian.

### ↳ **[7 NC-17]**

Not recommended for children under age 17.

### ↳ **[8 ADULT]**

Viewed only by adults due to graphic sexual scenes, violence, or language.

- 4 Press **SYSTEM MENU** to exit.

## Change parental control password

You can set a password to restrict play of certain discs.

- 1 Press **SYSTEM MENU**.
- 2 Select **[SYSTEM SETUP]** (system setup) > **[PASSWORD]** (password), and then press **▶▶**.
- 3 Enter a four-digit password with **Numeric keypad 0-9** and then press **OK**.
- 4 Press **SYSTEM MENU** to exit.



### Note

- The default password (1234) remains valid even if a new password is set.

---

## View DivX VOD registration code

DivX is a popular media technology created by DivX, Inc. DivX media files contain highly compressed video with high visual quality that maintains a relatively small file size. DivX files can also include advanced media features like menus, subtitles, and alternate audio tracks. Many DivX media files are available for download online, and you can rent and purchase DivX videos with the DivX VOD (Video on Demand) service. To use this service, you need the DivX VOD registration code of the unit. For more information and instructions, visit [www.divx.com/vod](http://www.divx.com/vod).

- 1 Press **SYSTEM MENU**.
- 2 Select **[SYSTEM SETUP]** (system setup) > **[DIVX[R] VOD]**, and then press **▶▶**.  
↳ The registration code appears.
- 3 Write down the code for future use.
- 4 Press **SYSTEM MENU** to exit.

### Note

- All the downloaded videos from DivX® VOD can only be played on this unit.

---

## Video settings

### Select video signal

You can select video signal output to a display or TV.

- 1 Press **SYSTEM MENU**.
- 2 Select **[VIDEO SETUP]** (video setup) > **[COMPONENT]** (component), and then press **▶▶**.
- 3 Select an option and then press **OK**.
  - **[S-VIDEO]**  
If the S-Video connection is used, select this option
- 4 Press **SYSTEM MENU** to exit.

---

## Adjust picture quality

During DVD play, you can adjust brightness, contrast, hue, and saturation to improve picture quality.

- 1 Press **SYSTEM MENU**.
- 2 Select **[VIDEO SETUP]** (video setup).
- 3 Select one of the following options, and then press **▶▶**.
  - **[BRIGHTNESS]** (brightness)  
Adjust the brightness level.
  - **[CONTRAST]** (contrast)  
Adjust the contrast level.
  - **[HUE]** (hue)  
Adjust the hue level.
  - **[SATURATION]** (saturation)  
Adjust the saturation level.
- 4 Press **▲▼** to adjust value and then press **OK**.
- 5 Press **SYSTEM MENU** to exit.

---

## Audio settings

### Select digital output

Select a suitable setting if you have connected an audio/video device to the COAXIAL (DIGITAL AUDIO) socket on the unit.

- 1 Press **SYSTEM MENU**.
- 2 Select **[AUDIO SETUP]** (audio setup) > **[DIGITAL OUT]** (digital output), and then press **▶▶**.
- 3 Select an option and then press **OK**.
  - **[DIGITAL/OFF]** (digital/off)  
Select this option to turn off digital output.
  - **[DIGITAL/RAW]** (digital/RAW)  
Select this option if the connected device is a multi-channel decoder/receiver.
  - **[DIGITAL/PCM]** (digital/PCM)  
Select this option if the connected device cannot decode multi-channel audio.
- 4 Press **SYSTEM MENU** to exit.

---

## Select audio downmix

Select a suitable audio downmix when you are playing a DVD recorded in Dolby Digital format.

- 1** Press **SYSTEM MENU**.
- 2** Select **[AUDIO SETUP]** (audio setup) > the **[DOWNMIX]** (downmix), and then press **▶▶**.
- 3** Select an option and then press **OK**.
  - **[LT/RT]**  
Select this if the unit is connected to a Dolby Pro Logic or Dolby Pro Logic II decoder.
  - **[STEREO]** (stereo)  
Select this when output delivers sound from only the two front speakers.
  - **[VSS]**  
Allows the DVD player to use virtual surround sound effects.
- 4** Press **SYSTEM MENU** to exit.

---

## Select reverb mode

3D processing provides a virtual surround sound experience using just two speakers.

- 1** Press **SYSTEM MENU**.
- 2** Select **[AUDIO SETUP]** (audio setup) > **[3D PROCESSING]** (3d processing), and then press **▶▶**.
- 3** Select an option and then press **OK**.
  - **[OFF]** (off), **[CONCERT]** (concert), **[CHURCH]** (church), **[PASSIVE]** (passive), **[WIDE]** (wide), or **[LIVE]** (live)
- 4** Press **SYSTEM MENU** to exit.

---

## Select sampling rate

You can select the Linear Pulse Code Modulation (LPCM) output sampling rate. The higher the sampling rate, the better the sound quality.

- 1** Press **SYSTEM MENU**.
- 2** Select **[AUDIO SETUP]** (audio setup) > **[LPCM]**, and then press **▶▶**.
- 3** Select an option and then press **OK**.
  - **[48K]**  
For discs recorded at sampling rate of 48kHz.
  - **[96K]**  
For discs recorded at sampling rate of 96 kHz.
  - **[192K]**  
For discs recorded at sampling rate of 192 kHz.
- 4** Press **SYSTEM MENU** to exit.

---

## Enable night mode

### [NIGHT MODE]

Makes loud sound level softer and soft sound level louder so that you can watch the DVD movies at a low volume, without disturbing others.

- 1** Press **SYSTEM MENU**.
- 2** Select **[AUDIO SETUP]** (audio setup) > **[NIGHT MODE]** (night mode), and then press **▶▶**.
- 3** Select an option and then press **OK**.
  - **[ON]** (on)  
Enjoy quiet viewing at night.
  - **[OFF]** (off)  
Enjoy surround sound with its full dynamic range.
- 4** Press **SYSTEM MENU** to exit.

# 8 Other features

---

## Set the sleep timer

This unit can switch to standby automatically after a set period of time.

- 1 When the unit is turned on, press **SLEEP/TIMER** repeatedly to select a set period of time (in minutes).
  - ↳ When sleep timer is activated, the display shows **zZ**.

### To deactivate sleep timer

- 1 Press **SLEEP/TIMER** repeatedly until "SLEEP OFF" is displayed.
  - ↳ When sleep timer is deactivated, **zZ** disappears on the display.

---

## Set the alarm timer

This unit can be used as an alarm clock. The DISC, TUNER or USB is activated to play at a preset time.

- 1 Ensure that you have set the clock correctly.
- 2 In standby mode, press and hold **SLEEP/TIMER** for more than 2 seconds.
- 3 Press **DISC**, **TUNER** or **USB** to select a source.
- 4 Press **SLEEP/TIMER** to confirm.
  - ↳ The hour digits are displayed and begin to blink.
- 5 Press **VOL +/-** to set the hour.
- 6 Press **SLEEP/TIMER** to confirm.
  - ↳ The minute digits are displayed and begin to blink.
- 7 Press **VOL +/-** to set the minute.
- 8 Press **SLEEP/TIMER** to confirm.
  - ↳ The timer is set and activated.

---

## Activate and deactivate the alarm timer

- 1 In standby mode, press **SLEEP/TIMER** repeatedly to activate or deactivate the timer.
  - ↳ If the timer is activated, the display shows **⌚**.
  - ↳ If the timer is deactivated, **⌚** disappears on the display.



### Note

- If DISC/USB source is selected and the track cannot be played, tuner is activated automatically.

---

## Listen to an external device

You can also listen to an external audio device through this unit.

### For an audio device with a headphone socket:

- 1 Press **AUX/MP3 LINK** to select the MP3 link source.
- 2 Connect the supplied MP3 link cable to
  - the **MP3 LINK** socket on this unit.
  - the headphone socket on an MP3 player.
- 3 Start to play the MP3 player. (See the user manual of the MP3 player)

### For other audio devices:

- 1 Press **AUX/MP3 LINK** to select the AUX source.
- 2 Connect the audio cables to
  - the **LINE IN** sockets on this unit.
  - the audio out sockets on the audio device.
- 3 Start to play the device. (See the device user manual)

---

## Listen through headphone

- 1 Plug a headphone into the **🎧** socket on the unit.

# 9 Product information



## Note

- Product information is subject to change without prior notice.

## Specifications

### Amplifier

Rated Output Power	4X50W RMS
Frequency Response	63 - 14000 Hz, $\pm 3$ dB
Signal to Noise Ratio	> 62dB

### Tuner (FM)

Tuning Range	87.5 - 108 MHz
Tuning grid	50 KHz
Sensitivity	<22 dBu
- Mono, 26dB S/N Ratio	
Search Selectivity	<28 dBu
Total Harmonic Distortion	<3%
Signal to Noise Ratio	> 45 dB

### Speakers

Speaker Impedance	6ohm
-------------------	------

## Disc

Laser Type	Semiconductor
Disc Diameter	12cm/8cm
Video Decoding	MPEG-1 / MPEG-2 / DivX
Video DAC	12Bits
Signal System	PAL / NTSC
Video Format	4:3 / 16:9
Video S/N	> 48dB
Audio DAC	24Bits / 96kHz
Total Harmonic Distortion	<1% (1 kHz)
Frequency Response	4Hz - 20kHz (44.1kHz)
	4Hz - 22kHz (48kHz)
	4Hz - 24kHz (96kHz)
S/N Ratio	> 65dBA

## General information

AC power	110 - 127V/220 - 240V, 50/60Hz
Dimensions	
- Main Unit (W x H x D)	173 x 257 x 240mm
- Speaker Box (W x H x D)	173 x 257 x 240mm
Weight	
- With Packing	10.8 kg
- Main Unit	2.3 kg
- Speaker Box	2 x 2.8 kg



---

## Supported disc formats

- Digital Video Discs (DVDs)
- Video CDs (VCDs)
- Super Video CDs (SVCDs)
- Digital Video Discs + Rewritable (DVD+RW)
- Compact Discs (CDs)
- Picture (Kodak, JPEG) files on CDR(W)
- DivX® disc on CD-R(W):
- DivX 3.11, 4.x and 5.x, 6
- WMA

### Supported MP3-CD formats:

- ISO 9660
- Max. title/album name: 12 characters
- Max. title number plus album: 255.
- Max. nested directory: 8 levels.
- Max. album number: 32.
- Max. MP3 track number: 999.
- Supported sampling frequencies for MP3 disc: 32 kHz, 44.1 kHz, 48 kHz.
- Supported Bit-rates of MP3 disc are: 32, 64, 96, 128, 192, 256 (kbps).
- The following formats are not supported:
  - Files like \*.VMA, \*.AAC, \*.DLF, \*.M3U,
  - \*.PLS, \*.WAV
  - Non-English Album/Title name
  - Discs recorded in Joliet format
  - MP3 Pro and MP3 with ID3 tag

---

## USB playability information

### Compatible USB devices:

- USB flash memory (USB 2.0 or USB1.1)
- USB flash players (USB 2.0 or USB1.1)
- memory cards (requires an additional card reader to work with this apparatus)

### Supported formats:

- USB or memory file format FAT12, FAT16, FAT32 (sector size: 512 bytes)
- MP3 bit rate (data rate): 32-320 Kbps and variable bit rate
- WMA v9 or earlier
- Directory nesting up to a maximum of 8 levels
- Number of albums/ folders: maximum 99
- Number of tracks/titles: maximum 999
- ID3 tag v2.0 or later
- File name in Unicode UTF8 (maximum length: 128 bytes)

### Unsupported formats:

- Empty albums: an empty album is an album that does not contain MP3/WMA files, and is not be shown in the display.
- Unsupported file formats are skipped. For example, Word documents (.doc) or MP3 files with extension .dlf are ignored and not played.
- AAC, WAV, PCM audio files
- DRM protected WMA files (.wav, .m4a, .m4p, .mp4, .aac)
- WMA files in Lossless format

# 10 Troubleshooting



## Caution

- Never remove the casing of this apparatus.

To keep the warranty valid, never try to repair the system yourself.

If you encounter problems when using this apparatus, check the following points before requesting service. If the problem remains unsolved, go to the Philips web site ([www.philips.com/support](http://www.philips.com/support)). When you contact Philips, ensure that your apparatus is nearby and the model number and serial number are available.

### No power

- Ensure that the AC cord of the apparatus is connected properly.
- Ensure that there is power at the AC outlet.
- As a power-saving feature, the system switches off automatically 15 minutes after track play reaches the end and no control is operated.

### No disc detected

- Insert a disc.
- Check if the disc is inserted upside down.
- Wait until the moisture condensation at the lens has cleared.
- Replace or clean the disc.
- Use a finalized CD or correct format disc.

### No picture

- Check the video connection.
- Turn on the TV to the correct Video-In channel.

### Black and white or distorted picture

- The disc does not match the TV color system standard (PAL/NTSC).
- Sometimes a slight picture distortion may appear. This is not a malfunction.
- Clean the disc.

The aspect ratio of the TV screen cannot be changed even though you have set the TV display format.

- The aspect ratio is fixed on the loaded DVD disc.
- The aspect ratio may not be changed for some TV systems.

### No sound or poor sound

- Adjust the volume.
- Disconnect the headphone.

### Remote control does not work

- Before pressing any function button, first select the correct source with the remote control instead of the main unit.
- Reduce the distance between the remote control and the apparatus.
- Insert the battery with its polarities (+/- signs) aligned as indicated.
- Replace the battery.
- Aim the remote control directly at the sensor on the front of the apparatus.

### Disc does not play

- Insert a readable disc with the label side facing you.
- Check the disc type, color system and regional code. Check for any scratches or smudges on the disc.
- Press **SYSTEM** to exit the system setup menu.
- Disable the password for parental control or change the rating level.
- Moisture has condensed inside the system. Remove the disc and leave the system turned on for about an hour. Disconnect and reconnect the AC power plug, and then turn on the system again.
- As a power-saving feature, the system turns off automatically 15 minutes after disc play reaches the end and no control is operated.

### Poor radio reception

- Increase the distance between the apparatus and your TV or VCR.
- Fully extend the FM antenna.
- Connect an outdoor FM antenna instead.

**USB device or SD/MMC card not supported**

- The USB device is incompatible with the apparatus. Try another one.

**Audio or subtitle languages cannot be set**

- The disc is not recorded with sound or subtitles in multiple languages.
- The audio or subtitle language setting is prohibited on the disc.

**USB device or SD/MMC card not supported**

- The USB device is incompatible with the apparatus. Try another one.

**Cannot display some files in USB device**

- The number of folders or files in the USB device has exceeded a certain limit. This phenomenon is not a malfunction.
- The formats of these files are not supported.

**Timer does not work**

- Set the clock correctly.
- Switch on the timer.

**Clock/timer setting erased**

- Power has been interrupted or the power cord has been disconnected.
- Reset the clock/timer.

# 11 Glossary

---

## A

### **Analog audio**

Sound that has not been turned into numbers. Analog sound is available when you use the AUDIO LEFT/RIGHT. These red and white jacks send audio through two channels, the left and right.

### **Aspect ratio**

Aspect ratio refers to the length to height ratio of TV screens. The ratio of a standard TV is 4:3, while the ratio of a high-definition or wide TV is 16:9. The letter box allows you to enjoy a picture with a wider perspective on a standard 4:3 screen.

### **AUDIO OUT sockets**

Red and white sockets that send audio to another system (TV, Stereo, etc).

---

## B

### **Bit rate**

Bit rate is the number of bits that are conveyed or processed per unit of time. The bit rate is usually measured in some multiple of bits per second (kilobits per second: kbps). The term bit rate is a synonym for data transfer rate (or simply data rate).

---

## C

### **Chapter**

Chapter

Sections of a picture or a music piece on a DVD that are smaller than titles. A title is composed of several chapters. Each chapter is assigned a chapter number that enables you to locate a specific chapter.

---

## D

### **Digital Audio**

Digital Audio is a sound signal that has been converted into numerical values. Digital sound can be transmitted through multiple channels. Analog sound can only be transmitted through two channels.

### **Disc menu**

A screen display that allows election of images, sounds, subtitles, multi-angles, etc., recorded on a DVD.

### **DivX®**

DivX® is a digital video format created by DivX, Inc. This is an official DivX Certified device that plays DivX video. Visit [www.divx.com](http://www.divx.com) for more information and software tools to convert your files into DivX video.

### **Dolby Digital**

A surround sound system developed by Dolby Laboratories that contains up to six channels of digital audio (front left and right, surround left and right, center and subwoofer).

---

## J

### **JPEG**

A very common digital still picture format. A still-picture data compression system proposed by the Joint Photographic Expert Group, which features small decrease in image quality in spite of its high compression ratio. Files are recognized by their file extension '.jpg' or '.jpeg.'

---

## M

### **MP3**

A file format with a sound data compression system. MP3 is the abbreviation of Motion Picture Experts Group 1 (or MPEG-1) Audio Layer 3. With the MP3 format, one CD-R or CD-RW can contain about 10 times more data than a regular CD.

---

---

## **Multichannel**

Usually DVD is specified to have each sound track constitute one sound field. Multichannel refers to a structure of sound tracks having three or more channels.

---

## **P**

### **Parental control**

A function of the DVD to limit playback of the disc by the age of the users according to the limitation level in each country. The limitation varies from disc to disc; when it is activated, playback will be prohibited if the software's level is higher than the user-set level.

### **PBC**

Playback Control. A system where you navigate through a Video CD/Super VCD with on-screen menus that are recorded onto the disc. You can enjoy interactive playback and search.

### **PCM**

Pulse Code Modulation. A digital audio encoding system.

---

## **R**

### **Region code**

A system that allows discs to be played only in the region designated. This unit only plays discs that have compatible region codes. You can find the region code of your unit on the product label. Some discs are compatible with more than one region (or ALL regions.)

---

## **S**

### **Surround**

A system that creates realistic, three-dimensional sound fields. It is usually achieved with multiple speakers that are arranged around the listener.

---

## **T**

### **Title**

On commercial DVDs, this is the longest section of a movie or music feature on DVD. Each title is assigned a title number, so that you can locate the title you want.

When you record programs, they are stored as titles. Depending on the recording settings, recorded titles may automatically contain several chapters.

---

## **V**

### **VIDEO OUT socket**

Yellow socket that sends the DVD picture video to a TV.

