

Quick Start Guide



Step A *Connect*

Step B *Setup*

Step C *Enjoy*

What's in the Box?

You should find these items upon opening the box.

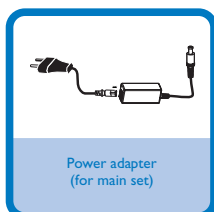
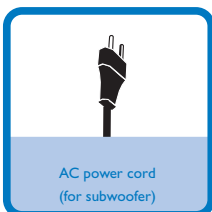
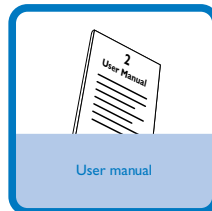
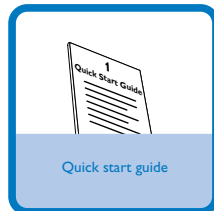
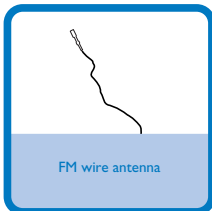
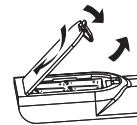
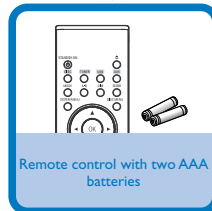
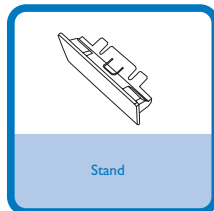
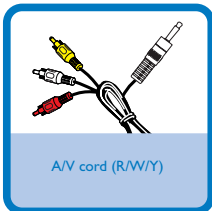

PHILIPS

Step A Connect

Tips

- See the User Manual for other TV connection options.
- For connecting to a Progressive Scan TV, refer to the user manual for proper connections and detailed setup.
- In case of wireless connection failure between the main set and subwoofer, see the User Manual for manual pairing (“Installation - Step 1: Connecting speakers - Connecting the wireless subwoofer”).

- 1 Connect the speaker cables.
- 2 Connect the FM antenna.
- 3 Connect the A/V cord to a TV.
- 4 Connect the power cords of the system and TV.
- 5 Power on both the main set and subwoofer.
→ Wireless connection will set up automatically.

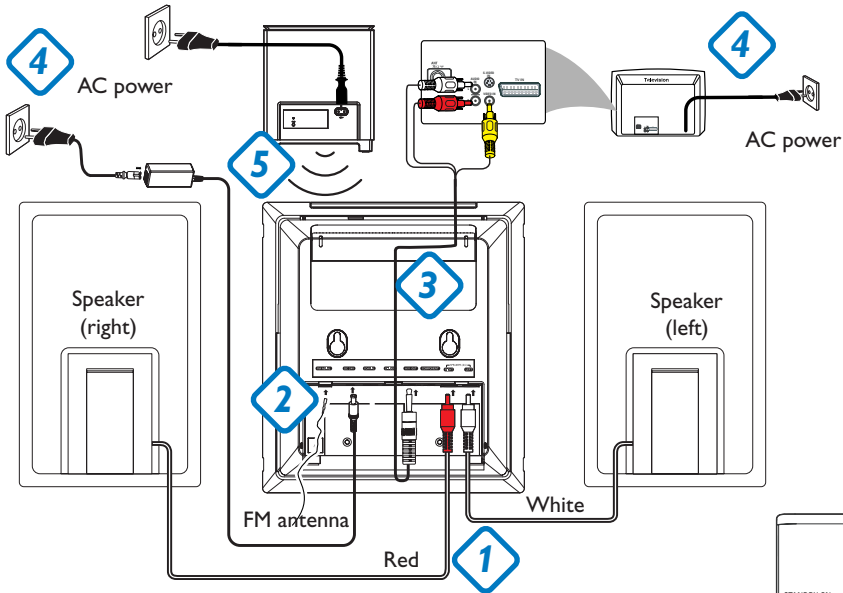

Step B Setup

Setting up the TV

- 1 Press **SOURCE** (**DISC** on the remote control) to select disc source.
- 2 Turn on the TV and set it to the correct Video In channel.

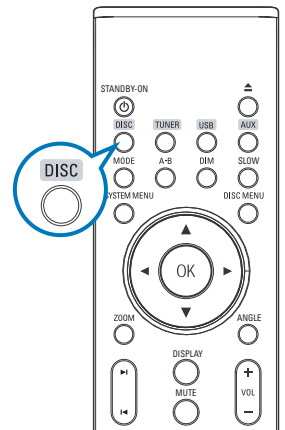

Step B Setup

Setting the clock

1

In standby mode, press and hold **CLOCK** on the remote control.

2

When the hour digits flash, press **VOLUME+/+** (**VOL+/+** on the remote control) to set the hours.

3

Press **CLOCK** again and the minute digits flash. Then press **VOLUME+/+** (**VOL+/+** on the remote) to set the minutes.

4

Press **CLOCK** again to confirm the time setting.

Setting DVD menu options

IMPORTANT!

If the progressive scan feature is activated but the connected TV does not support progressive signals or the cables are not connected accordingly, see the user manual for proper progressive scan setup or deactivate the progressive scan feature as below:

- 1) Turn off your TV progressive scan mode or turn on to interlaced mode.
- 2) Press **SYSTEM MENU** on the remote to exit the system menu and then **DISC** and **"1"** to exit progressive scan.

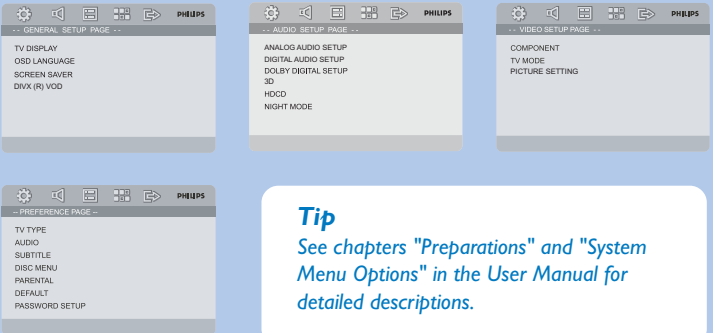

The image shows four screenshots of the Philips TV setup menu. The top row contains three screens: 'GENERAL SETUP PAGE' (with options: TV DISPLAY, OSD LANGUAGE, SCREEN SAVER, DIVX (R) VOD), 'AUDIO SETUP PAGE' (with options: ANALOG AUDIO SETUP, DIGITAL AUDIO SETUP, DOLBY DIGITAL SETUP, 3D, HDCD, NIGHT MODE), and 'VIDEO SETUP PAGE' (with options: COMPONENT, TV MODE, PICTURE SETTING). The bottom row contains one screen: 'PREFERENCE PAGE' (with options: TV TYPE, AUDIO, SUBTITLE, DISC MENU, PARENTAL, DEFAULT, PASSWORD SETUP). A 'Tip' box is overlaid on the bottom right of the screenshots.

Tip
See chapters "Preparations" and "System Menu Options" in the User Manual for detailed descriptions.

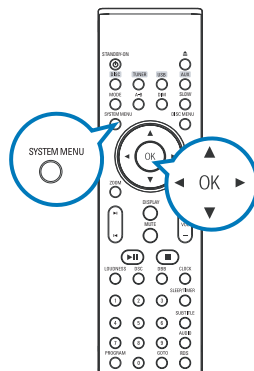

Step C Enjoy

Playing a disc

1

Insert a disc into the slot loader.

→ Make sure the label side is facing you.

→ Make sure you have removed any other disc from the slot loader.

2

Playback will start automatically. If not press ►||.

3

To stop playback, press ■.

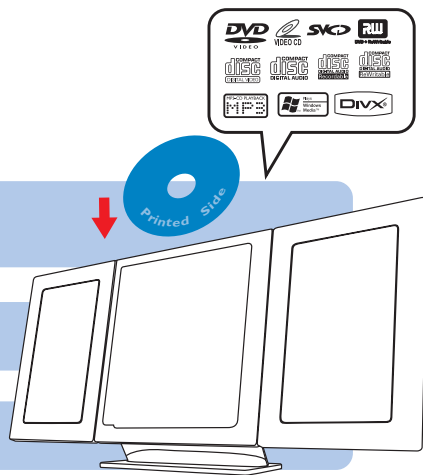

Programming and tuning to radio stations

1

Press **SOURCE** (TUNER on the remote control) to select tuner source.

2

Press **PROGRAM** for more than two seconds to program all available stations in order of waveband.

3

Press **PRESET** ◀▶ until the desired preset station is displayed.

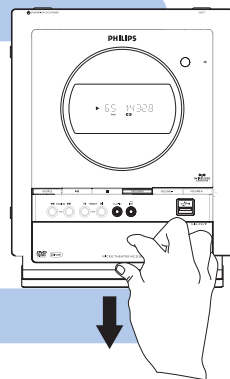

Playing a USB mass storage device

With the Hi-Fi system, you can use USB flash memory (USB 2.0 or USB1.1), USB flash players (USB 2.0 or USB1.1), memory cards (requires an additional card reader to work with this Hi-Fi system).

1

Insert the USB device's USB plug into the socket ↔ on the set.

2

Press **SOURCE** once or more to select **USB** (or **USB** on the remote control).

3

Play the USB's audio files as you do with the albums/tracks on a CD.

IMPORTANT!
Slide down to expose some buttons and jacks on the front panel!



Tip

Detailed playback features and additional functions are described in the accompany owner's manual.