

# Quick Start Guide



Step A *Connect*

Step B *Setup*

Step C *Enjoy*

## What's in the Box?

You should find these items upon opening the box.



Remote Control



MW antenna

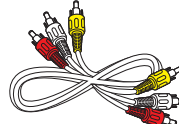

Audio/video cable



Quick Start Guide



User Manual

**PHILIPS**

## Step A *Connect*

- 1 Connect the speaker cables.
- 2 Connect the AC power cord to the wall socket.

### Tip

See the User Manual for how to connect other equipment to this apparatus.

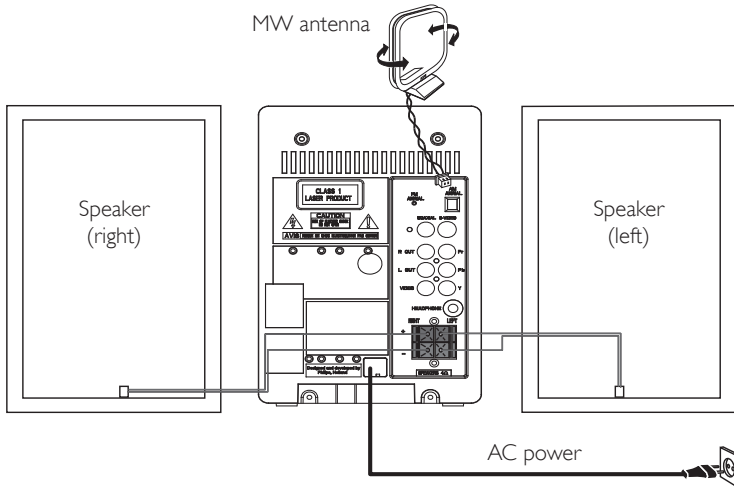

## Step B *Setup*

### Setting the clock

- 1 In standby mode, press and hold **CLOCK/DISPLAY**.
- 2 Press **PROG** repeatedly to select 12 hour or 24 hour format.
- 3 Press **CLOCK/DISPLAY** to confirm.
- 4 When the hour digits flash, press **◀ / ▶** to set the hours.
- 5 Press **CLOCK/DISPLAY** again and the minute digits flash. Then press **◀ / ▶** to set the minutes.
- 6 Press **CLOCK/DISPLAY** again to confirm the time setting.

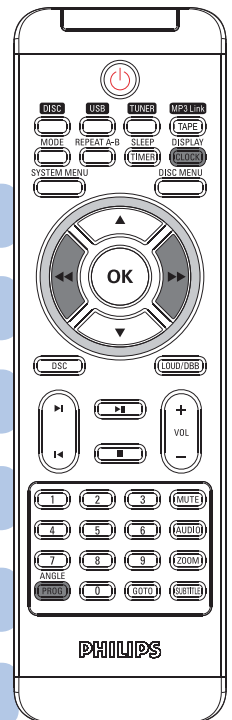

## Step C Enjoy

### Playing a disc

- 1 Press **DISC** to select DISC.
- 2 Lift the disc door on the top of the unit.
- 3 Insert a disc with the printed side facing up, then close the disc door.
- 4 Playback will start automatically. If not, press **▶||**.
- 5 To stop playback, press **■**.

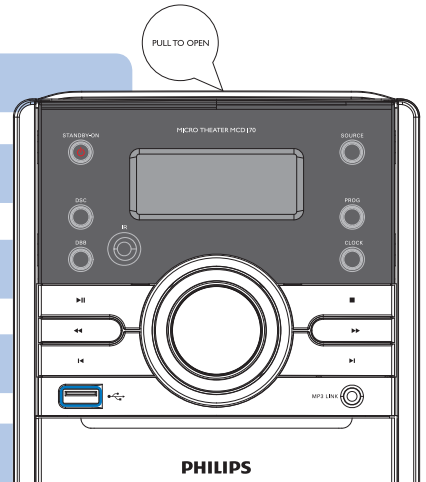

### Playing a USB mass storage device

With the apparatus, you can use USB flash memory (USB 2.0 or USB1.1), USB flash players (USB 2.0 or USB1.1), memory cards (requires an additional card reader to work with this apparatus).

- 1 Insert the USB device's USB plug into the socket  on the main unit.
- 2 Press **USB** to select USB.
- 3 Play the USB's audio files as you do with the albums/tracks on a CD.

## Programming and tuning to radio stations

- 1 Press **TUNER** to select tuner source.
- 2 Press **PROG/ANGLE** for more than two seconds to program all available stations in order of waveband.
- 3 Press **◀** or **▶** until the desired preset station is displayed.

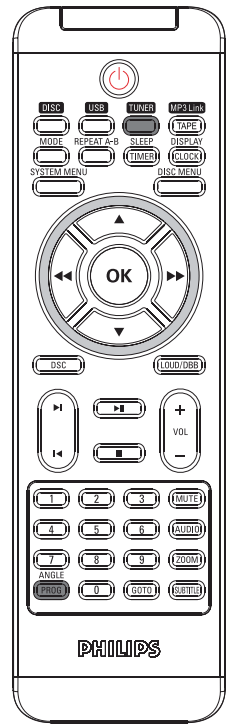

### Tip

Detailed playback features and additional functions are described in the accompanied owner's manual.



© Royal Philips Electronics N.V. 2009  
All rights reserved.

<http://www.philips.com>

