

Register your product and get support at

www.philips.com/welcome

M550

M555



Short user manual

PHILIPS



Important safety instructions

Warning

- The Electrical network is classified as hazardous. The only way to power down the charger is to unplug the power supply from the electrical outlet. Ensure that the electrical outlet is always easily accessible.
- Refer to safety information before using the product.
- This product complies with European R&TTE directive 1999/5/EC
- Use only the power supply listed in the user instructions.
- Use only the batteries listed in the user instructions.
- Do not allow the product to come into contact with liquids.
- Risk of explosion if battery is replaced by an incorrect type.
- Dispose of used batteries according to the instructions.
- When the handset rings or when the handsfree is activated, keep the handset away from your ear to avoid hearing damage.

1 Overview

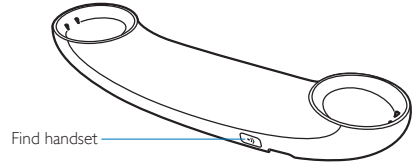
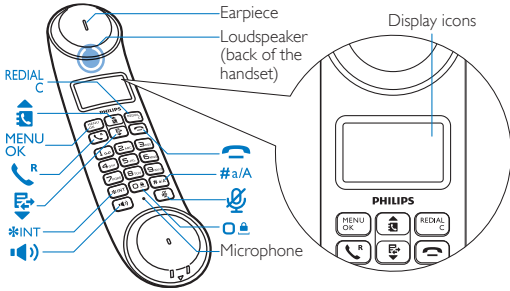

In call

- MENU OK Phonebook
- REDIAL C Access the redial list.
- ↑ Increase the volume.
- ↓ Decrease the volume.
- ☎ End calls.
- 🔊 Turn the speaker on/off.
- 🔇 Mute/unmute the microphone.
- #a/A Enter a pause (press and hold).

Standby

- MENU OK Access the main menu.
- REDIAL C Access the redial list.
- 📖 Phonebook
- 📅 Call log
- 📞 R Make and receive calls.
- *INT Make an intercom call (press and hold).
For multi-handset version only.
- 🔇 Switch the handset on or off (press and hold).
- 🔒 Lock the keypad (press and hold).
- 🔊 Make and receive calls.

In menu

- MENU OK Confirm / Select / Enter the option menu.
- REDIAL C Cancel
- ⬆️ Up / down
- ☎ Exit menu.

In text input

- REDIAL C Delete a character.
Delete all characters (press and hold).
- ␣ Enter a space.
- #a/A Switch upper/lower case (press and hold).

Display icons

- 📶 The number of bars indicates the connection status between the handset and base station. The more bars are shown, the better the signal strength is.
 - 📞 It remains steadily on when browsing answered incoming calls in the call log.
 - 📞 It indicates an outgoing call in the redial list.
 - 📞 It flashes when there is a new missed call or when browsing new missed calls. It remains steadily on when browsing the missed calls in call log that are already read.
 - 📞 It flashes when receiving incoming call. It remains steadily on during a call.
 - 🔊 The speaker is on.
 - 🔇 The ringer is off.
 - 📞 Answering machine: it flashes when there is a new message or when the memory is full. It remains steadily on when the telephone answering machine is turned on.
 - ✉️ Voice messages indicator: flashes for new messages, is steady for reviewed messages.
*This is network dependent
 - ▲ It displays when you scroll up/down a list or increase and decrease the volume.
 - ▶ There are more digits on the right. Press REDIAL C to read.
- ECO+ The ECO+ mode is activated.

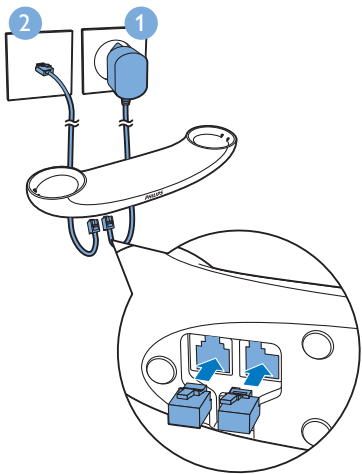

2 Connect

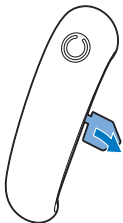

3 Get started

Configure your phone



- 1 The batteries are pre-installed in the handset. Pull the battery tape off from the battery door before charging.
- 2 When using your phone for the first time, you see a welcome message (country dependent).
- 3 Set the country and language if prompted.
- 4 Set the date and time.
 - If the time is in 12-hour format, press   key to select **[am]** or **[pm]** (country dependent).

Charge your phone

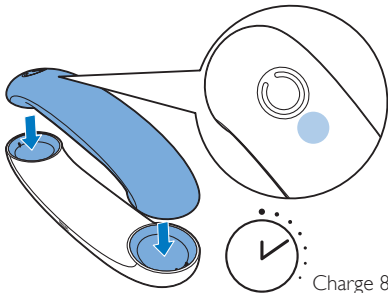

Charge your handset by docking it in either direction.

 > 75%

 25% - 50%

 50% - 75%

 < 25%

Flashing: low battery

Scrolling: charging in progress

4 Enjoy

Phonebook

Add record

- 1 Press MENU OK > **[Phonebook]** > **[Add new]**.
- 2 Follow on-screen instructions.

Call from the phonebook

- 1 Press C .
- 2 Select a record and press R .

Direct access memory

You have 2 direct access memories (Keys 1 and 2). To dial the saved phone number automatically, press and hold on the keys in standby mode.

Depending on your country, keys 1 and 2 are preset to **[1_voicemail]** (voice mail number) and **[2_info svc]** (information service number) of your network operator respectively (network dependent).

Call log

Call from the call log

- 1 Press C .
- 2 Select a record and press R .

View record

Press F > MENU OK > **[View]**.

Save record

- 1 Press F > MENU OK > **[Save number]**.
- 2 Follow on-screen instructions.

Delete record

- 1 Press F > MENU OK > **[Delete]**.
- 2 Follow on-screen instructions.

Redial list

Call from the redial list

- 1 Press REDIAL C .
- 2 Select a record and press R .

Save record

- 1 Press REDIAL C > MENU OK > MENU OK > **[Save number]**.
- 2 Follow on-screen instructions.

Delete record

- 1 Press REDIAL C > MENU OK > MENU OK > **[Delete]**.
- 2 Follow on-screen instructions.

Telephone answering machine (for M555 only)

Record an announcement

- 1 Press MENU OK > **[Answ. Machine]** > **[Announcement]**.

- 2 Follow on-screen instructions.

Listen to the incoming messages

Press MENU OK > **[Answ. Machine]** > **[Play]**, then press MENU OK to confirm.

Delete an incoming messages

- 1 When you listen to the message, press MENU OK to enter the options menu.
- 2 Select **[Delete]**, then press MENU OK to confirm.

Register additional handsets

You can register up to 3 additional handsets to the base station.

- 1 Press MENU OK > **[Services]** > **[Register]**.

- 2 Press and hold C on the base station for 5 seconds.

- 3 Enter the system PIN (0000).

- 4 Press MENU OK to confirm the PIN.

↳ Registration is complete in less than 2 minutes.

ECO+ mode

It eliminates radiation in standby mode (causes 2 seconds ring delay, 50% shorter standby time).

- 1 Press MENU OK > **[Phone setup]** > **[ECO+ mode]**.

- 2 Follow on-screen instructions.



Technical data

Battery

- Philips: 2 x AAA NiMH 1.2V Rechargeable 550mAh batteries

Use only the supplied batteries.

Adapter

Base and charger:

- Philips:
S003EB06000302:
Input: 100-240Vac 50/60Hz 0.2A;
Output: (i)6Vdc 0.3A, (ii)6Vdc 0.2A

Phonebook with 100 entries

Call log with 50 entries

Talk time: 16 hours

Standby time: 250 hours



Note

- You can install a DSL (digital subscriber line) filter to prevent noise and caller ID problems caused by the DSL interference.
- You can find the Declaration of Conformity on www.p4c.philips.com.

? Frequently asked questions

No signal bar is displayed on the screen.

- The handset is out of range. Move it closer to the base station.
- If the handset displays **[Register your handset]**, register your handset. (See the section on Register the hands).

If I fail to pair (register) the additional handsets to the base station, what do I do?

Your base memory is full. Access **MENU** **OK** > **[Services]** > **[Register your handset]** to unregister the unused handsets and try again.

My handset is in searching status, what do I do?

- Make sure that the base station has power supply.
- Register the handset to the base station.
- Move the handset closer to the base station.

I cannot change the settings of my voice mail, what do I do?

The voice mail service is managed by your service provider but not the phone itself. Contact your service provider to change the settings.

No display

- Make sure the batteries are charged.
- Make sure there are power and phone connections.

The handset on the charger does not charge.

- Make sure the batteries are inserted correctly.
- Make sure the handset is placed properly on the charger. The handset event LED flashes for a few seconds when charging.
- Make sure the docking tone setting is turned on. When the handset is placed correctly on the charger, you can hear a docking tone.
- The charging contacts are dirty. Disconnect the power supply first and clean the contacts with a damp cloth.
- Batteries are defective. Purchase new ones with the same specifications.

Bad audio (crackles, echo, etc.)

- The handset is nearly out of range. Move it closer to the base station.
- The phone receives interference from the nearby electrical appliances. Move the base station away from them.
- The phone is at a location with thick walls. Move the base away from them.

The handset does not ring.

Make sure the handset ringtone is turned on.

The caller ID does not display.

- The service is not activated. Check with your service provider.
- The caller's information is withheld or unavailable.

i



www.philips.com/support

For information, refer to the extended user documentation online.



CE 0168

Reproduction in whole or in part is prohibited without the written consent of the copyright owner. Trademarks are the property of Koninklijke Philips Electronics N.V. or their respective owners. All rights reserved.
© 2012 Koninklijke Philips Electronics N.V.



QSG_M550-555
90_EN_V1.0
WK12322