

Register your product and get support at
www.philips.com/welcome

Immersive
3000 series



Quick start guide

PHILIPS

1

EN Stand mount the speakers

ES Montaje de los altavoces en el soporte

PT Montar as caixas acústicas

1

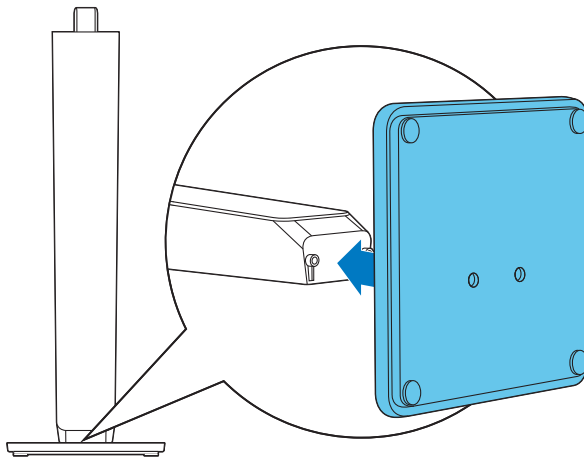

2

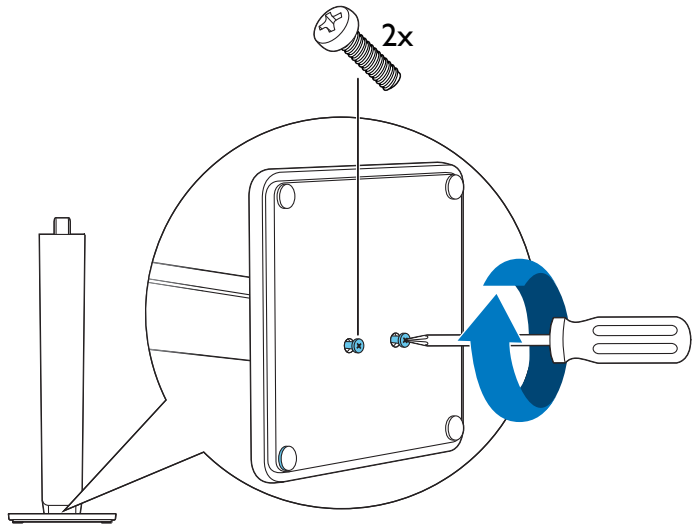

3

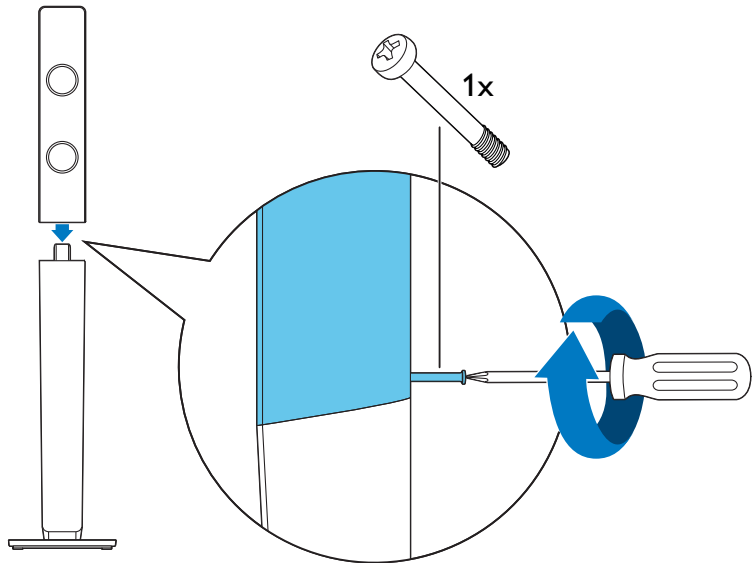

2

- EN** Connect the home theater
- ES** Conecte el sistema de cine en casa
- PT** Conectar o Home Theater

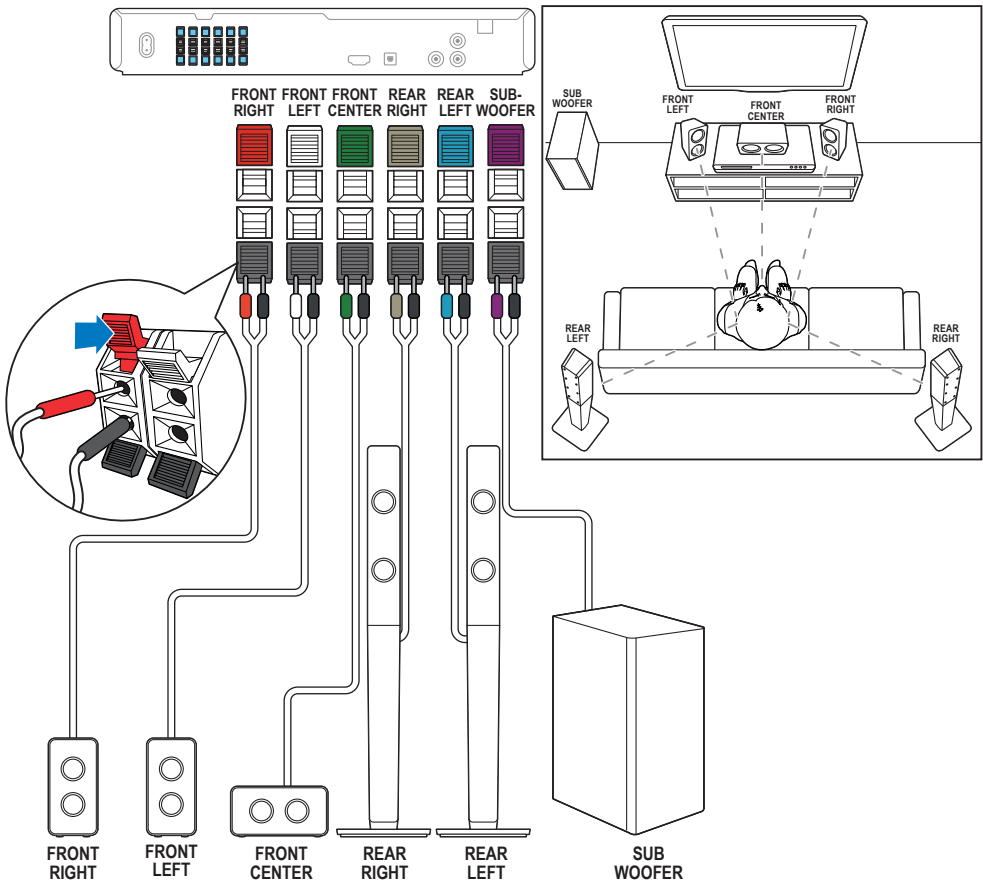

3

EN Connect to TV in one of these ways

ES Conecte al TV de alguna de las siguientes maneras

PT Conecte à TV de uma destas maneiras

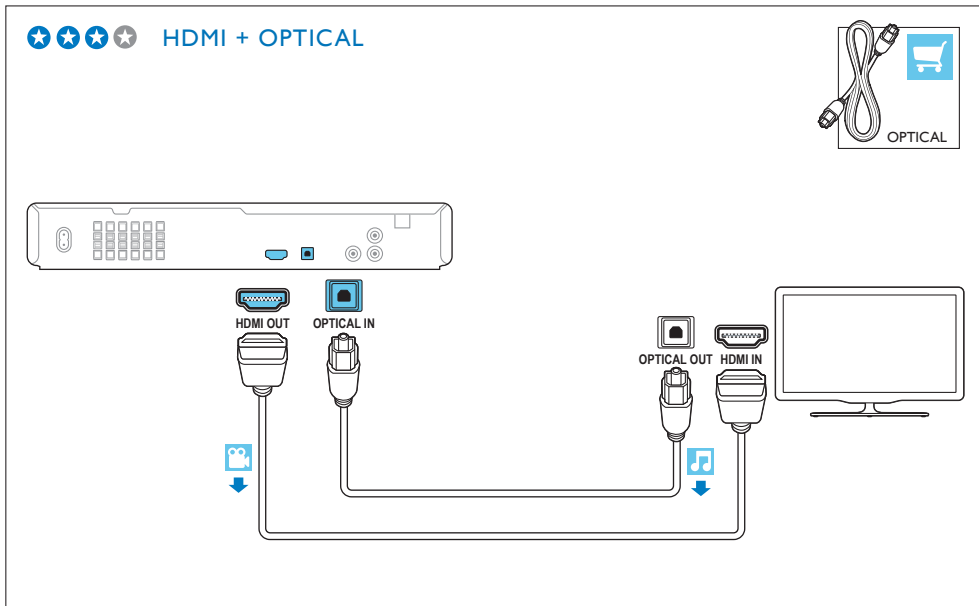

★ ★ ★ ★ HDMI + AUDIO L/R

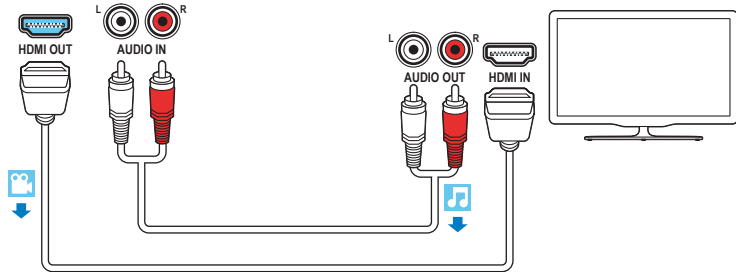
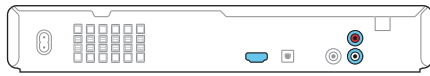

★ ★ ★ ★ VIDEO + AUDIO L/R

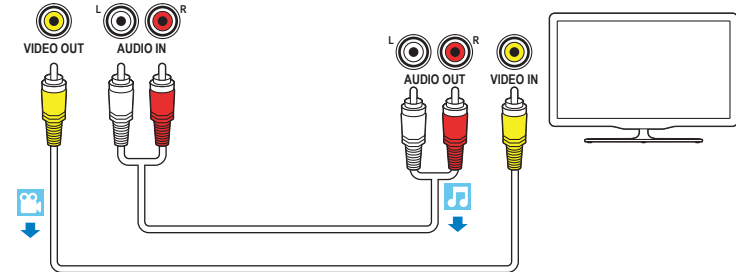
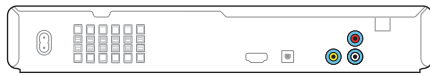

4

- EN** Switch on the home theater
- ES** Encienda el sistema de cine en casa
- PT** Ligar o Home Theater

1

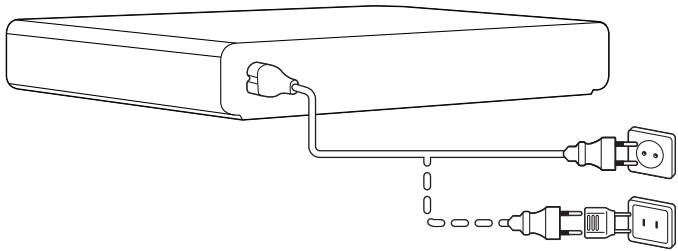

2

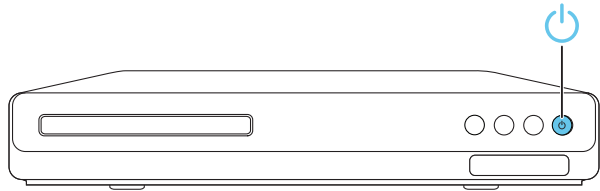

3

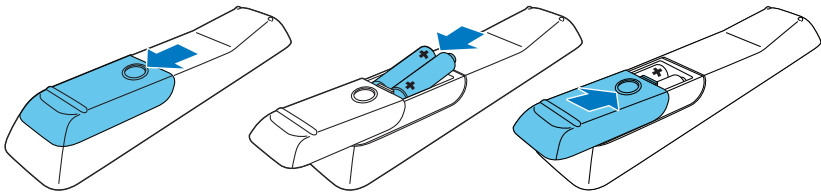

5

- EN** Complete the first time setup
- ES** Complete la configuración inicial
- PT** Fazer a configuração inicial

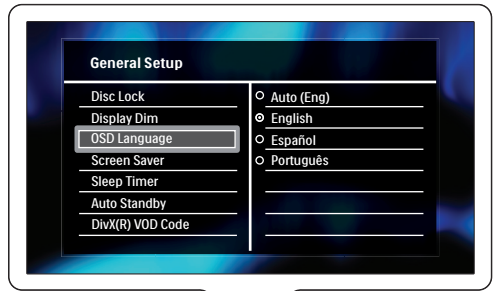
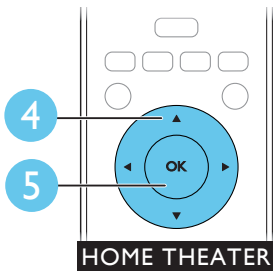
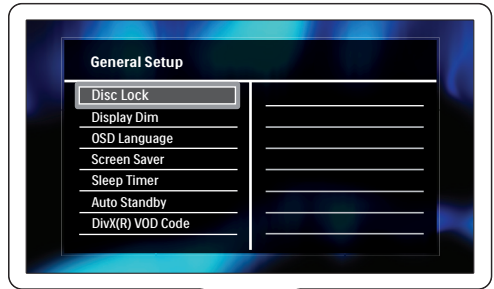
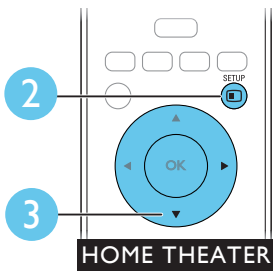
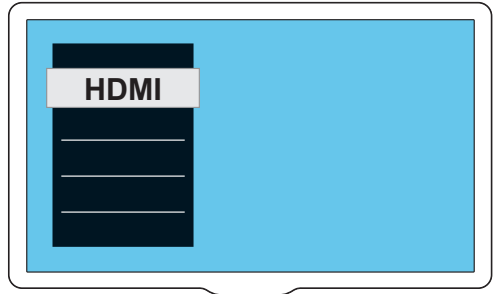
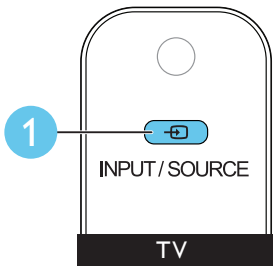

6

EN Use your home theater

ES Use el sistema de cine en casa

PT Usar o Home Theater

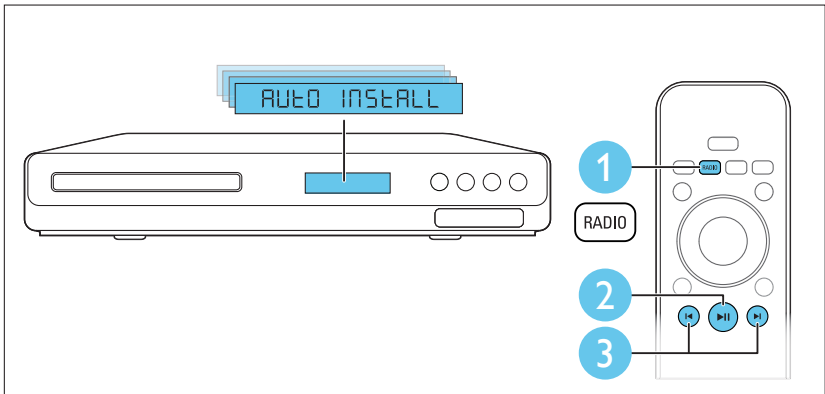
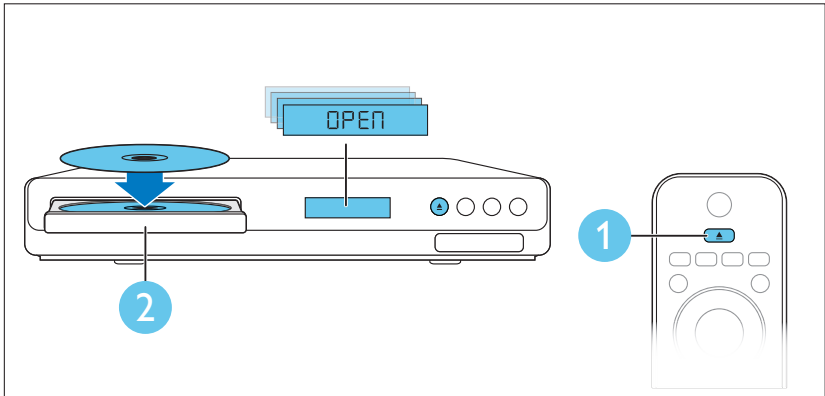

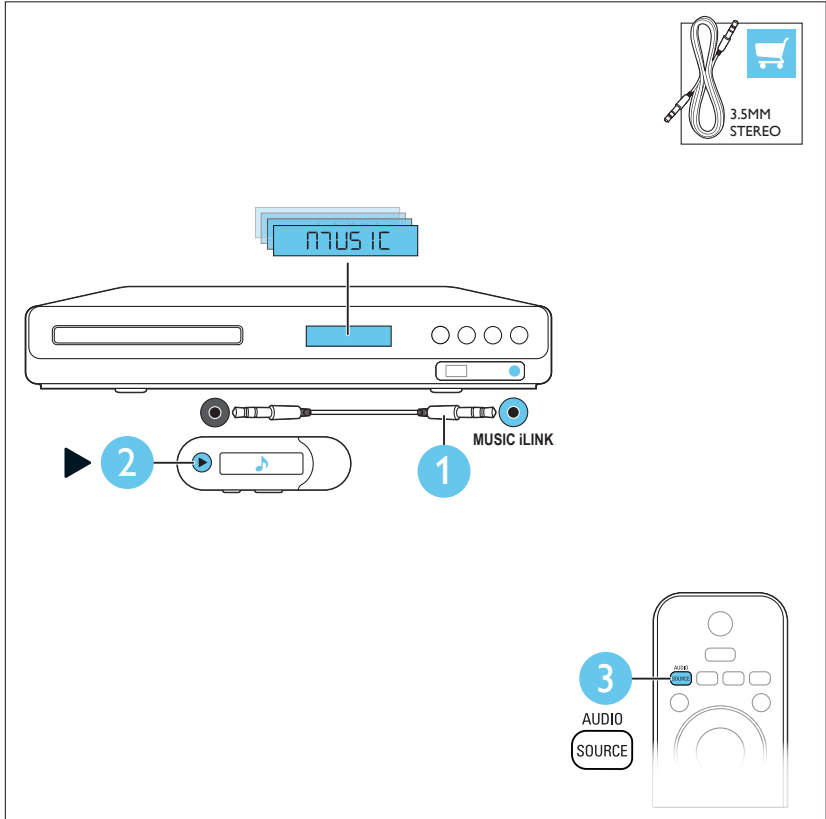
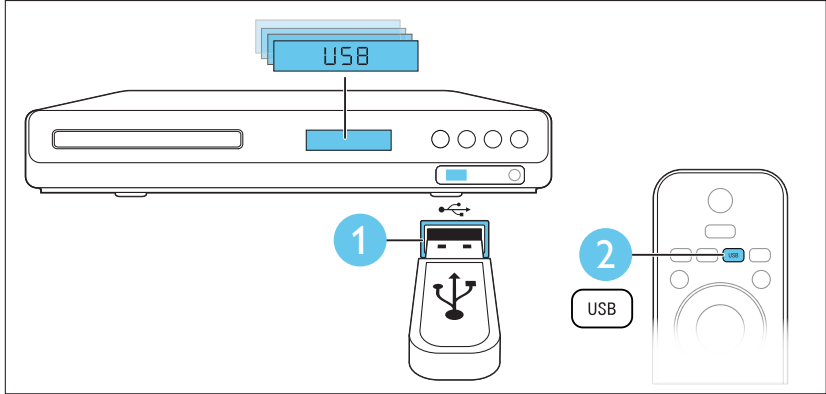



EN For more information about using this product visit www.philips.com/support

ES Para obtener más información sobre el uso de este producto, visite www.philips.com/support

PT Para obter mais informações sobre o uso deste produto, visite o site www.philips.com/support



www.philips.com/support



Non-contractual images. / Images non contractuelles. / Außervertragliche Bilder.

All registered and unregistered trademarks are property of their respective owners.

Specifications are subject to change without notice
Trademarks are the property of Koninklijke Philips Electronics N.V. or their respective owners
2012 © Koninklijke Philips Electronics N.V. All rights reserved
www.philips.com
sgsn_1151/55_v1

