

PHILIPS

phone accessories

*genie*TM



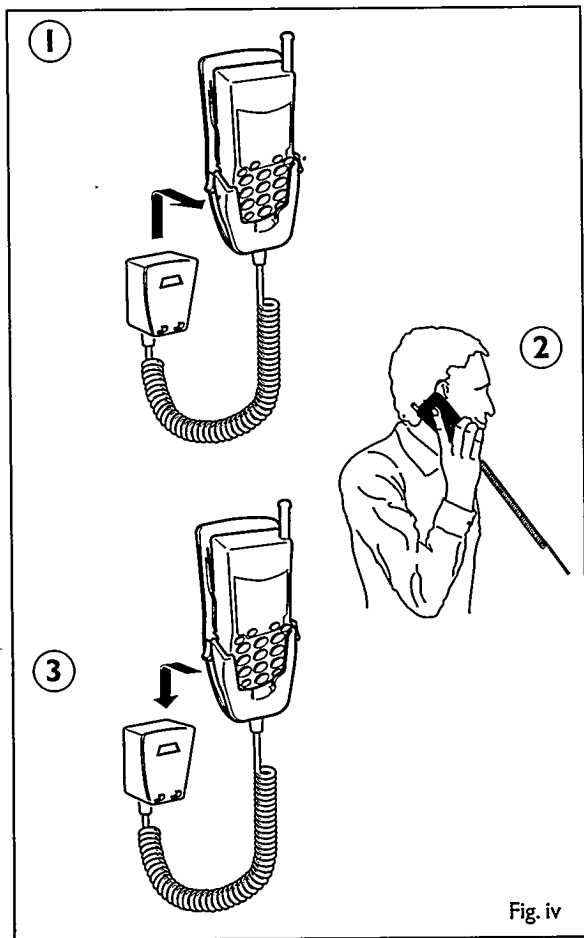

Fig. iv



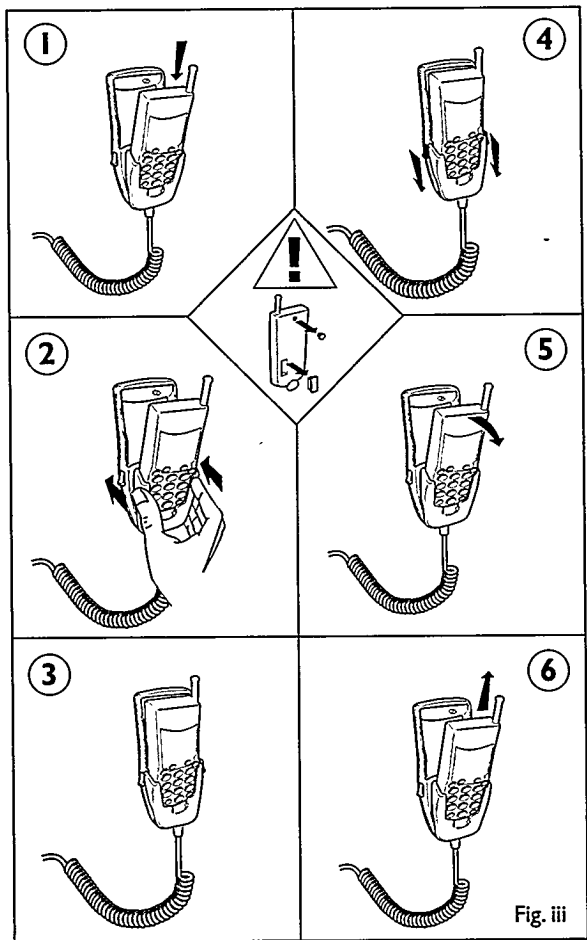

Fig. iii



EXECUTIVE HANDSFREE CAR-KIT • KIT MAINS-LIBRE



CE

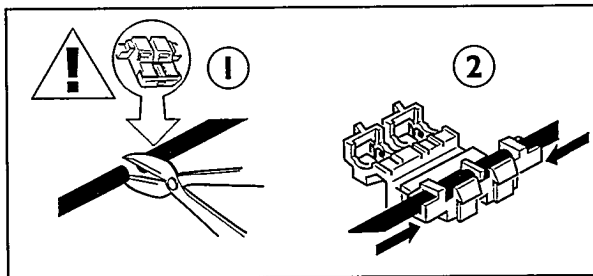
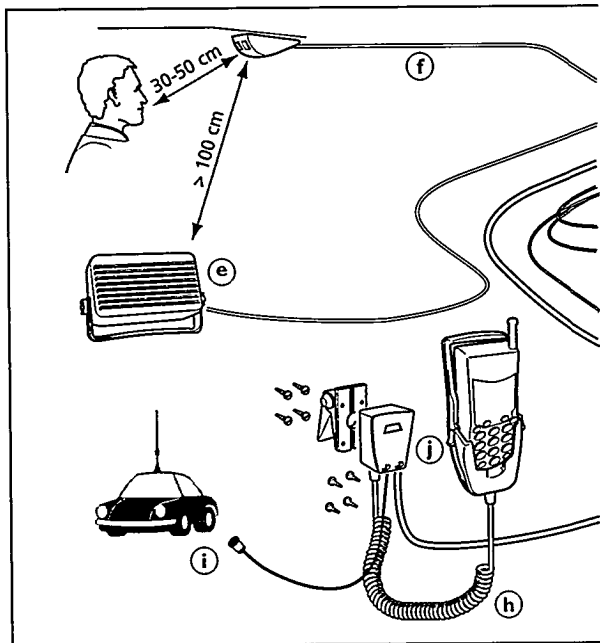



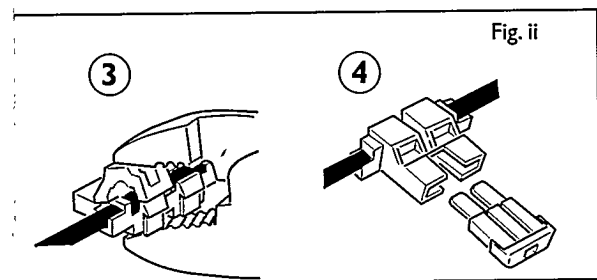
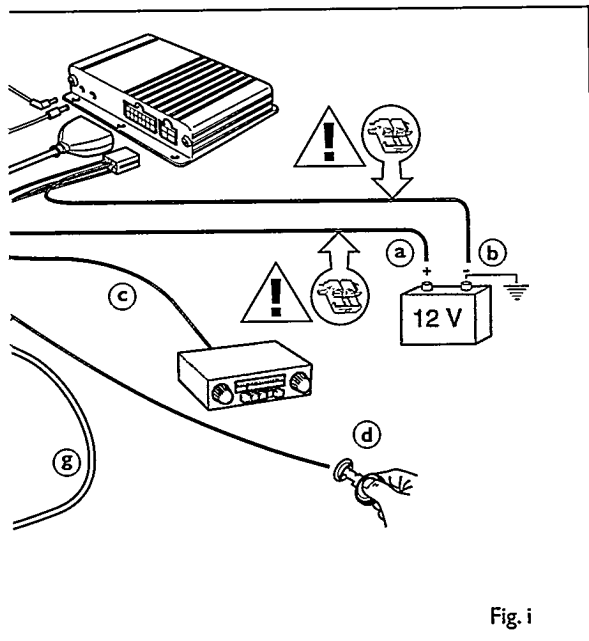

1

2

3



ENGLISH	2
DEUTSCH	6
FRANÇAIS	11
ESPAÑOL	16



Introduction

You now own the Executive Hands Free CarKit from Philips which offers full duplex operation. This special feature supports normal conversations in hands free mode, it allows either party to interrupt during the dialogue, just like you're used to with a normal telephone.

The carkit offers many features for both convenience and safety:

- Gives safe, convenient hands free telephone use with an external speaker and microphone.
- Maintains your telephones' battery charge while allowing you to use your telephone in the vehicle.
- Offers the opportunity to personalise the operation of the carkit via your telephones' accessory menu.
- Lets you remove the phone cradle from the phone mount and continue a conversation in privacy mode.
- Activates audio mute in your vehicles entertainment system when you send or receive a call.
- Provides a convenient holder cup for securing your telephone in the vehicle.

CarKit Use

Before placing your telephone in the carkit, please remove the plastic dust cover positioned over the connector on the back of the telephone, see figure (iii).

For insertion and extraction of the telephone from the carkit, see figure (iii).

If your phone cradle is not on the phone mount, you will automatically be in privacy mode, see figure (iv).

Placing a telephone into the carkit will automatically activate the carkit charging and handsfree functions. If the vehicle ignition is not turned on within 3 hours the carkit will turn off after this time, to avoid draining the vehicles battery. Please see explanation below of the Power Down' feature, for a description of the carkits operation after the ignition is turned off.

Data Connection

The phone mount has a data/ fax port for use on digital cellular networks, see figure (i). To use a Philips Data Card with the carkit simply plug the data card cable into the data/ fax port and follow the instructions in your data card manual.

Carkit Programmable Features

The Executive Carkit contains many unique and useful features which can be programmed via the Telephones' Accessory Menu;

Power Down

You can define a time period between switching off the car ignition and automatic phone switch off. To enable this function select one of the default periods (10, 30, 60 seconds, or 5 minutes). However, the Carkit will automatically turn the phone off after 3 hours to avoid draining the vehicles battery.

Radio Mute

If this function is enabled, an incoming or outgoing call will automatically lower the volume of the car radio.

Auto-volume control

If this function is enabled, the carkit speaker during communication is automatically adjusted according to the level of background noise in your vehicle.

Auto-answer

When this function is enabled, you can accept a call in handsfree mode. 5 seconds after a call arrives it is automatically answered and you can speak into the carkit microphone. Alternatively the call can be accepted or rejected manually during this period.

Auto pick-up

When the Answer call option is enabled, the first call can be accepted by removing the phone holder from the mounting cradle.

When the End call option is enabled, the last call can be ended by replacing the phone holder on the mounting cradle.

For further details on the Accessory Menu see the telephones' user manual

Installation Instructions

Warning

Ensure that one fuse (4amp) is installed in the power cable (red, +ve) and one fuse (4amp) in the ground (black, -ve) cable, see figure (ii) , before connecting the carkit to the vehicles power supply.

- Only for use with 12 volt vehicle electrical supplies.
- Philips recommends that this carkit is professionally installed.
- Read the instructions fully before attempting to install the carkit.
- Do not position the carkit where it may interfere with normal driving operation.
- Do not expose to hot air directly from the heater.
- Do not obstruct airbag deployment.
- Do not place over existing wire or pipelines.
- After installation verify that all components are secure.

The performance of electrically controlled breaking, guidance systems, and air bags can be subject to interference from radio telephone operations. If in doubt contact the manufacturer of the vehicle for verification.

Kit Contents

- I Phone cradle, phone interface cable (coiled cord), phone mount, screws (4) , and interface cable (straight cord)
- II Phone mount bracket and screws (4)
- III Microphone (includes screw and Velcro attachment options)
- IV Speaker and screws (2)
- V Junction box and screws (4)
- VI Cable loom
- VII User manual
- VIII Fuse set (2)

Installation

Important

Unfold and refer to the illustrations on pages i, ii, iii, and iv as you read these instructions.

1. Determine the cable layout. See figure (i).
2. Attach the phone mount to the phone mount bracket, using the 4 screws on the phone mount. If necessary the phone mount bracket can be disassembled by removing the 2 side adjustment screws, and reassembled in the vehicle.
3. Attach the phone mount bracket to the vehicle with the screws provided.
4. Determine where to mount the junction box. This is typically under the dashboard or seat.

5. Secure the junction box with the 4 screws provided to the vehicle.
6. Install the fuses, one in the power cable (red, +ve), and one in the ground cable (black, -ve). Cut the wires where the fuses should be installed and attach the fuse assemblies, see figure (ii).
7. Make the power, audio mute, and ignition sense cable connections, see figure (i).
 - a Power cable (red, +ve)
 - b Ground cable (black, -ve)
 - c Audio mute (yellow). Refer to sound system manufacturers installation instructions.
 - d Ignition sense (blue). Connect to fuse panel ignition terminal.
 - e Speaker
 - f Microphone
 - g Interface cable (straight cord)
 - h Phone interface cable (coiled cord)
 - i Antenna connector, FME type (an external vehicle antenna is not included in the carkit)
 - j Data/ Fax port
8. Determine where to mount the microphone and speaker. Ensure they are mounted at least 1m apart, and not directly facing each other.
9. The microphone must be mounted in a fixed position, do not mount it on the sunvisor as this will allow movement. It should be positioned between 30-50cm from the usual position of the drivers' mouth, see figure (i).
10. Route the lead away from the microphone and into the interior trim joints and gaskets. Connect the microphone plug into the microphone jack socket on the junction box.
11. Attach the speaker to a flat surface using the 2 self tapping screws provided.
12. Install the antenna and connect to the carkit as indicated. For best results follow the antenna manufacturers instructions.
13. Place the phone in the phone cradle, and the phone cradle on the phone mount.
14. Make a phone call to test the handsfree operation.

ENGLISH

Product manufactured in France

User manual printed in France

Philips, Route d'Angers - 72081 Le Mans cedex 9 - France

Copyright © 1997 Philips - all rights reserved

This product is covered by a 12 months warranty

Philips reserves the right to modify specifications without prior notice

DEUTSCH

Hergestellt in Frankreich

Benutzerhandbuch in Frankreich gedruckt

Philips, Route d'Angers - 72081 Le Mans Cedex 9 - France

Copyright © 1997 Philips - Alle Rechte vorbehalten

Dieses Produkt ist mit einer Garantie von 12 Monaten versehen.

Philips behält sich das Recht vor, die Spezifikationen ohne Vorankündigung zu ändern.

FRANÇAIS

Produit fabriqué en France

Manuel imprimé en France

Philips, route d'Angers - 72081 Le Mans cedex 9, France

Copyright © 1997 Philips - Tous droits réservés

Ce produit s'accompagne d'une garantie de 12 mois.

Philips se réserve le droit de modifier ces caractéristiques sans préavis.

ESPAÑOL

Producto fabricado en Francia

Manual del usuario impreso en Francia

Philips, Route d'Angers - 72081 Le Mans cedex 9 - Francia

Copyright © 1997 Philips - todos los derechos reservados

Este producto está cubierto por una garantía de 12 meses

Philips se reserva el derecho de modificar las especificaciones sin previo aviso



© 1997 PHILIPS