

PHILIPS

FB 208W Wireless Surround Loudspeaker System

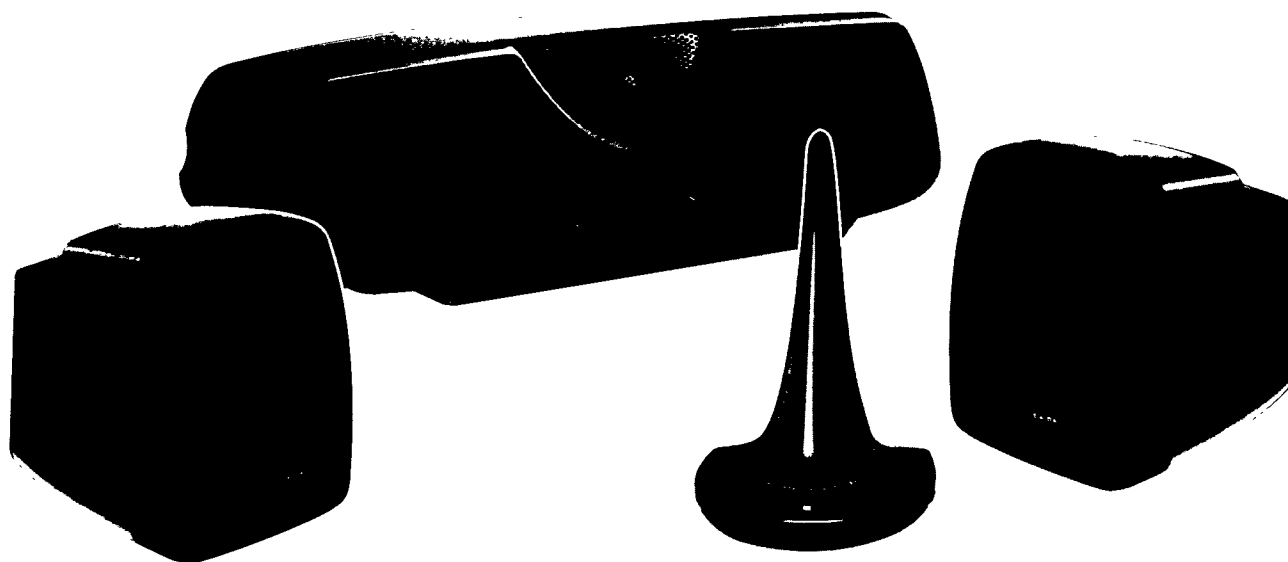

Instructions for use
Mode d'emploi
Instrucciones de manejo
Bedienungsanleitung
Gebruiksaanwijzing
Istruzioni per l'uso
Brugsanvisning
Bruksanvisning
Käyttöohje
Manual de utilização
Οδηγίες χρήσεως



PHILIPS

Important notes for users in the U.K.

Mains plug

This apparatus is fitted with an approved 13 Amp plug. To change a fuse in this type of plug proceed as follows:

- 1 Remove fuse cover and fuse.
- 2 Fix new fuse which should be a BS1362 5 Amp, A.S.T.A. or BSI approved type.
- 3 Refit the fuse cover.

If the fitted plug is not suitable for your socket outlets, it should be cut off and an appropriate plug fitted in its place.

If the mains plug contains a fuse, this should have a value of 5 Amp. If a plug without a fuse is used, the fuse at the distribution board should not be greater than 5 Amp.

Note: The severed plug must be disposed of to avoid a possible shock hazard should it be inserted into a 13 Amp socket elsewhere.

How to connect a plug

The wires in the mains lead are coloured with the following code. blue = neutral (N), brown = live (L).

As these colours may not correspond with the colour markings identifying the terminals in your plug, proceed as follows:

- Connect the blue wire to the terminal marked N or coloured black.
- Connect the brown wire to the terminal marked L or coloured red.
- Do not connect either wire to the earth terminal in the plug, marked E (or \equiv) or coloured green (or green and yellow)

Before replacing the plug cover, make certain that the cord grip is clamped over the sheath of the lead - not simply over the two wires.

Copyright in the U.K.

Recording and playback of material may require consent. See Copyright Act 1956 and The Performer's Protection Acts 1958 to 1972.

Norge

Typeskilt finnes på apparatens underside.

Observer: Nettbryteren er sekundert innkoplet. Den innebygde nettdelen er derfor ikke frakoplet nettet så lenge apparatet er tilsluttet nettkontakten.

For å redusere faren for brann eller elektrisk støt, skal apparatet ikke utsettes for regn eller fuktighet.

English4

English

Français.....10

Français

Español16

Español

Deutsch.....22

Deutsch

Nederlands28

Nederlands

Italiano.....34

Italiano

Svenska.....40

Svenska

Dansk.....46

Dansk

Suomi.....52

Suomi

Português.....58

Português

Ἑλληνικά64

Ἑλληνικά

EQUIPMENT SUPPLIED

English

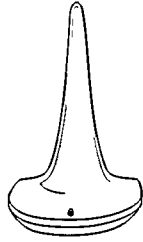

Transmitter unit

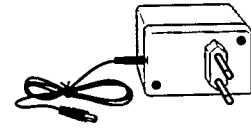

AC/DC adapter

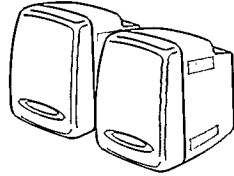

2 Surround speakers

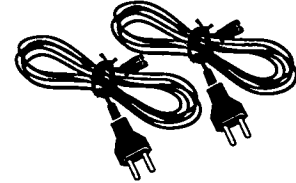

2 Mains cables for active speaker

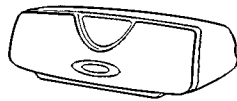

Centre speaker

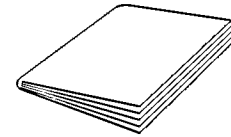

Instructions for use

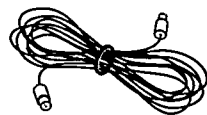

Cinch cable

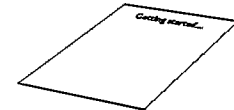

"Getting Wireless" card

Environmental information

All redundant packing material has been omitted. We have done our utmost to make the packaging easy separable into three mono materials: cardboard (box), polystyrene foam (buffer) and polyethylene (bags, protective foam sheet).

Your set consists of material which can be recycled if disassembled by a specialized company. Please observe the local regulations regarding the disposal of packing materials, exhausted batteries and old equipment.

This product complies with the radio interference requirements of the EU (European Union).

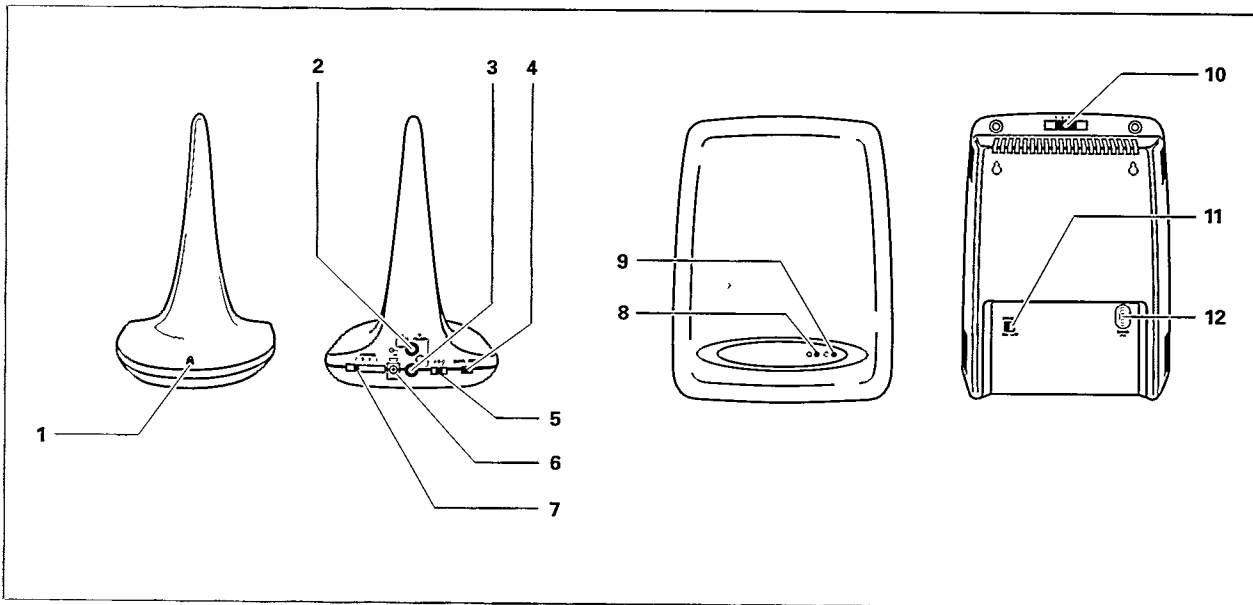

Transmitter unit

- 1 Status light.....**RED:** Transmitter is on.
BLINKING: Transmitter is on and input level is too high (see 5).
OFF: Transmitter is in standby mode or not connected to the AC/DC adapter.
- 2 L (SUB).....Not used with the delivered configuration.
- 3 R (SURR).....To connect the transmitter unit to the SURROUND OUT (SURR PRE OUT) of your set.
- 4 SURR / MULTI.....Set this selector to SURR, the position MULTI is not used with the delivered configuration.
- 5 A·B·C.....To set the input sensitivity of the transmitter unit.
A: maximum sensitivity
B: medium sensitivity
C: minimum sensitivity
- 6 14 V.....To connect the transmitter unit to the AC/DC-adaptor provided.
- 7 CHANNEL.....7 step channel selector for setting the transmitting channel in case of interferences.

Note: – Always be sure that the transmitter unit and the active surround speakers are switched to the same transmitting channel, otherwise no sound or only a distorted sound will be heard on the surround speakers.

– You have to switch off the active surround speakers before setting the transmitting channel.

Active surround speakers

- 8 ①.....**GREEN LIGHT:** If this is on, the active speaker is on.
- 9 ②.....**RED LIGHT:** If this is on, the active speaker is in standby mode.

Note: – If both lights are off the active speaker is switched off or not connected to the mains.

- 10 CHANNEL.....7 step channel selector for setting the transmitting channel in case of interferences.
- 11 POWER.....To switch the active surround speaker on and off.
- 12 MAINS.....To connect the active surround speaker to the mains.

For users in the U.K.: please follow the instructions on page 2.

CONNECTIONS

English

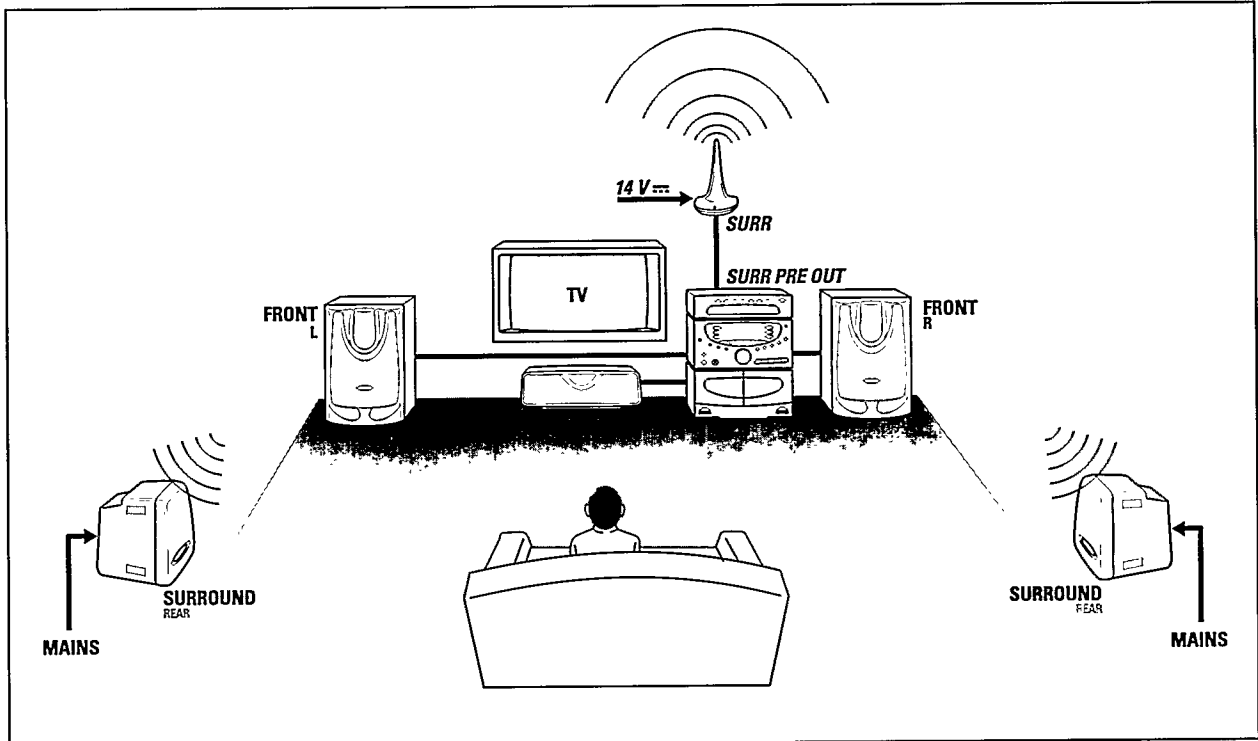

Important!

Always switch off all your equipment before making any connections!

For connecting your wireless speaker system refer to the picture above.

The loudspeaker connections on the appliance may be screw connectors or click-fit connectors.

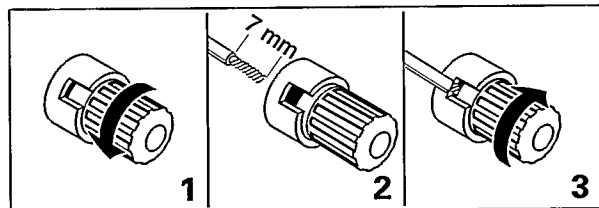
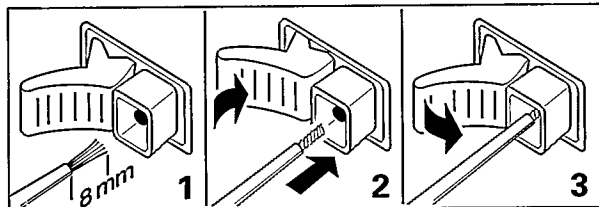

At the rear of the appliance you will find a coloured or ⊕ terminal and a black or ⊖ terminal for each speaker.

Note: – After connecting all the speakers, do not forget to adjust the relative sound level between them.

Front speakers (not included) and centre speaker

Connect the coloured speaker wire to the coloured or ⊕ terminal, and the black wire to the black or ⊖ terminal of the appliance.

Surround speakers

Connect the active speakers to the mains with the mains cables provided. Switch on the active speakers with the POWER switch.

Transmitter unit

Connect the SURR terminal of the transmitter unit with the PRE OUT (SURROUND) terminal of the appliance using the supplied cinch cable. Connect the AC/DC adapter supplied to the 14V socket of the transmitter unit. Then connect the AC/DC adapter to the mains.

Note: – The SUB terminal of the transmitter unit is not used with this set.

Positioning of the transmitter unit

Position the unit in a way that you are able to "see" the active surround speaker from the position of the unit.

To avoid sound distortions caused by magnetic fields do not place the transmitter unit on your TV set.

Positioning of the speakers

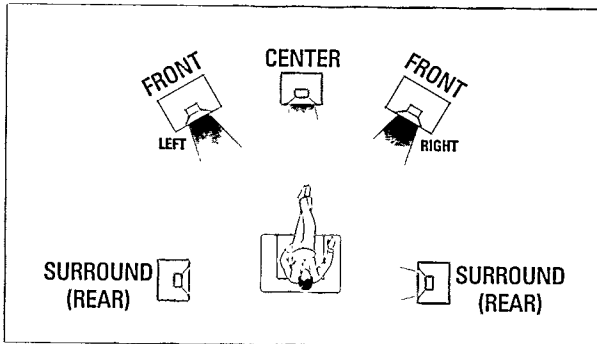

Important!

To avoid overheating do not cover any vents and leave a minimum distance of 5 centimeters (2 inches) for ventilation.

General hints for positioning

Avoid positioning the speakers in a corner or on the floor, as this will boost the bass tones too much. Placing the speakers behind curtains, furniture etc. will reduce the treble response, thus reducing the stereo effect considerably. The listener should always be able to "see" the speakers.

Each room has different acoustic characteristics and the positioning possibilities are often limited. You can find the best position for your speakers by following the picture above. The speakers should always be arranged as symmetrically as possible in the room.

Positioning the centre speaker

The centre speaker should be placed in the centre between both front speakers, e. g. underneath or on top of the TV. The best height for the centre speaker is at the height of the listener's ears (while seated).

Positioning the surround speakers

The surround speakers should face each other and be in line with, or at most 1.5m (4ft 6ins) behind the listener.

Adjusting the relative sound level

After installing your speakers, you will have to find a good sound balance between the surround, the centre and the front speakers.

In the instruction booklet of your appliance you will find a section describing how to adjust the sound of the different speakers. Follow those instructions to get the most out of your new PHILIPS speakers.

Setting the input sensitivity A-B-C

Depending on which sound source you use, the signals delivered have different strengths.

If the red light on the front of the transmitter unit **starts to blink**, the incoming signal is too strong. This will cause distortions! Set the A-B-C switch to adjust the input sensitivity to a lower level. If the red light in front of the transmitter unit **goes off** during play, the incoming signal is not strong enough. Set the A-B-C switch to adjust the input sensitivity to a higher level.

Setting the transmitting channel

In case of interferences of the signal from the transmitter unit it is possible to shift to another transmitting channel.

- 1 Switch off **both** active surround speakers.
- 2 Set the CHANNEL slide at the back of the transmitter unit to another number.
- 3 Set the CHANNEL slide at the back of **both** active surround speakers to the same number as on the transmitter.
- 4 Switch on **both** active surround speakers.

Note: – Always be sure that the transmitter unit and the active surround speakers are switched to the same transmitting channel, otherwise no sound or only a distorted sound will be heard on the surround speakers.

Switching On-Standby-Off

The transmitter unit is equipped with a sensitive input. If there is no signal on the SUB and SURR input the transmitter and the surround speakers will switch to standby after approximately 100 seconds.

The green light on the front of the active surround speakers shows that the speakers are on. If the red light is on, the speakers has switched to standby. To switch the active speakers off, use the POWER switch.

If the red light on the front of the transmitter is off, it has switched to standby. To switch the transmitter off, unplug the AC/DC adapter from the mains.

Power handling

Any amplifier or receiver used at high power can produce distortions which may seriously damage your speakers. If distortion occurs, reduce the volume and the tone control to a level where the sound is acceptable again.

When using microphones, avoid feedback which occurs when a microphone picks up sound from the speakers, resulting in a howling noise. Keep the microphone away from the speakers or reduce the volume.

Maintenance

A chamois leather slightly moistened with water is sufficient for cleaning the speaker cabinet. Do not use cleaning agents containing alcohol, spirits, ammonia or abrasives.

Do not leave the speakers for a long time in direct sunlight or other places where high temperatures can occur.

Do not expose the speakers to humidity or rain.

More wireless products...

The transmitter is also equipped to drive an optional wireless subwoofer, wireless stereo loudspeakers or wireless headphones.

Please ask your dealer for this products, and refer to the bypacked instructions enclosed for setting up your transmitter for use with them.

Technical data

subject to change without notice

Surround speakers

Impedance	3Ω
Frequency range	100–15,000Hz
Output power	2 × 22W RMS/3Ω/1kHz/THD 10%
Music power	2 × 40W
Sensitivity	87dB
Drivers	1 × 4" full range
Dimensions (h × w × d)	219 × 174 × 209mm
Weight active	approx. 3kg

" ±1 dB

Magnetically shielded centre speaker

Impedance	6Ω
Frequency range	75–20,000Hz
Power handling capacity	50W
Sensitivity	89dB
Drivers	2 × 4" woofers, 1 × 1 1/4" tweeter
Crossover frequencies	8,000Hz
Dimensions (h × w × d)	152 × 400 × 160mm
Weight	approx. 3.4kg

Transmitter unit

System	Radio frequency (RF)
Modulation	Frequency modulation (FM)
S/N in signal	95dB
Step channel frequency	433.375–434.500MHz
Transmission power	< 10mW
Working range	up to 100m
Dimensions (h × w × d)	206 × 130 × 134mm
Weight	approx. 0.26kg

WARNING

Under no circumstances should you try to repair the speakers yourself, as this will invalidate the guarantee.

If a fault occurs, first check the points listed below before taking the speakers for repair.

If you are unable to solve a problem by following these hints, consult your dealer or service centre.

PROBLEM	POSSIBLE CAUSE	SOLUTION
No sound	VOLUME is not correctly adjusted.	Adjust the VOLUME.
	Headphones are connected to the appliance.	Disconnect headphones.
	Speakers are not (or wrongly) connected.	Connect the speakers securely.
No sound on the left or right side	One speaker is wrongly connected.	Connect the speaker properly.
	A speaker cable is damaged.	Replace the cable.
Poor sound or no sound at the centre or surround speakers	SURROUND mode is not switched on.	Switch to the surround mode on the appliance.
	Surround and/or centre speakers are not (properly) connected.	Connect the speakers properly.
	A speaker cable is damaged.	Replace the cable.
	Transmitter unit or active surround speakers are switched off.	Switch on transmitter and active surround speakers.
	Transmitter unit and/or active surround speakers are not securely connected to the mains.	Connect the mains cables properly.
	CHANNEL switch of the transmitter unit and the active speakers are not switched to the same number.	Set the CHANNEL slides on the transmitter unit and on both active speakers to the same number.
	Transmitter unit is connected to the wrong output on the appliance.	Connect the transmitter unit to the correct terminal on the appliance.
	SURR/MULTI switch of the transmitter unit is in the wrong position.	Set the SURR/MULTI switch to the SURR position.
	The signal from the transmitter unit is interfered through electric appliances.	Set the transmitter unit and the active surround speaker to another transmitting channel.
The signal from your appliance is too strong.	Set the input sensitivity of the transmitter unit to the next level.	
Poor bass sound	Speakers are not in phase.	Connect speakers properly; coloured cable to ⊕-pole, black cable to ⊖-pole.
Bad sound	Badly matching setting for the given type of music or sound.	Correct the sound settings on the appliance.
Surround sound level is too low or too high	The level of the surround sound is not properly adjusted.	Adjust the level and delay time of the surround sound on the appliance.
Centre sound level is too low or too high	The sound level of the centre channel is not properly adjusted.	Adjust the level of the centre channel on the appliance.

Meet PHILIPS at the Internet
<http://www.philips.com>

English

Français

Español

Deutsch

Nederlands

Italiano

Svenska

Dansk

Suomi

Português

Ελληνικά

