

3 Enjoy

Video Cassette Playback

- 1 Insert a tape in the cassette compartment of the DVD/VCR. Playback will start automatically.
- If playback does not start automatically, press **VCR** (VCR), then press **PLAY** (▶).
- Press **STOP** (■) to stop playback.
- Press **REW** (◀) to rewind the tape.
- After the tape stops, press **STOP/EJECT** (■) on the front of the DVD/VCR to remove the tape.

Disc Playback

- 1 Press **DVD** (DVD) so DVD light appears on the front of the DVD/VCR.
- 2 Press **OPEN/CLOSE** (▲) to open the disc tray.
- 3 Place a disc onto the tray. If the DVD is recorded on only one side, place the disc on the tray with the label facing up and the shiny side facing down.
- 4 Press **PLAY** (▶) to close the tray. The tray will close and playback will begin. If playback does not start automatically, press **PLAY** (▶) again. You also can close the tray by pressing **OPEN/CLOSE** (▲).
- Press **STOP** (■) to stop playback.
- If you are trying to play a DVD recorded on other recorder unit, make sure it is finalized on that unit.

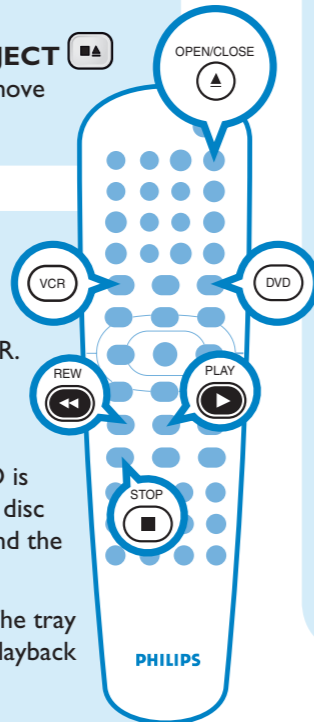

Playable Discs

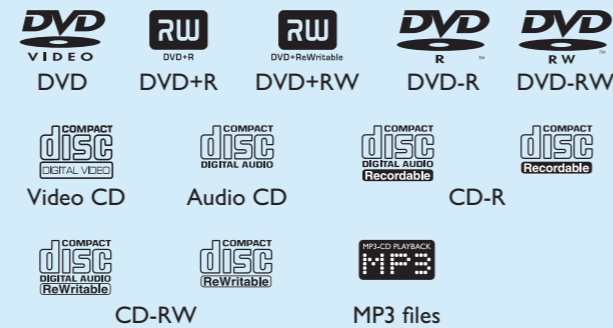

DVD is a trademark of DVD Format/Logo Licensing Corporation.

Region Codes

DVDs must be labeled for ALL regions or for Region 1 in order to play on this DVD player. You cannot play DVDs that are labeled for other regions. Look for the symbols below on your DVDs. If these region symbols do not appear on your DVD, you cannot play the DVD in this player.



Need help?

User Manual

See the user manual that came with your Philips DVD/VCR.

Online

Go to www.philips.com/welcome.



2007 © Philips Consumer Electronics Company
Marietta, GA 30006 0026
All rights reserved.

Printed in China
12 NC 8239 300 58381
E8E20UD
1VMN23998

Quick Start Guide



- 1 Connections
- 2 Basic Setup
- 3 Enjoy

What's in the box?

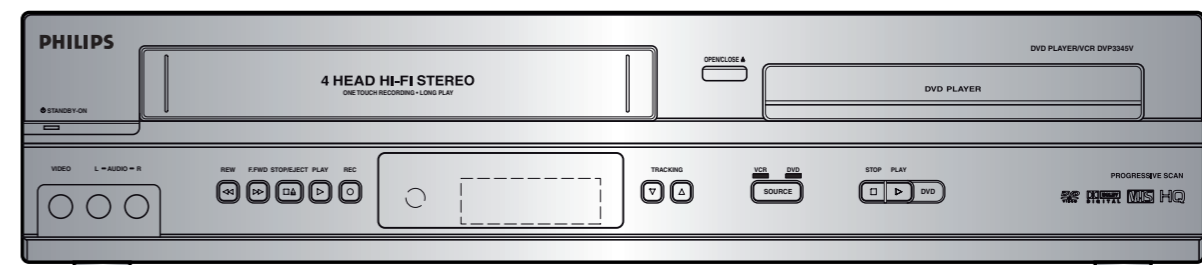

Digital Video Disc Player & Video Cassette Recorder

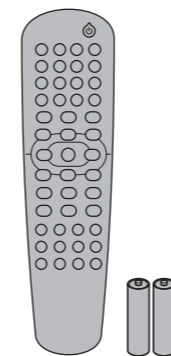

Remote Control
with Batteries
(AAx2)



Video Cable



Audio Cable

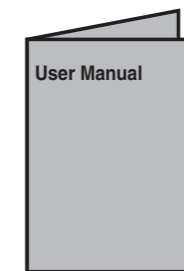

User Manual

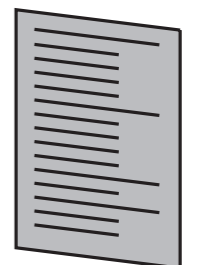

Quick Start Guide

PHILIPS

1 Connections

Connection to an External Tuner

A Before Connecting

Disconnect the power cords of the devices from the AC outlet.

B Connecting

Make the connection as illustrated below.

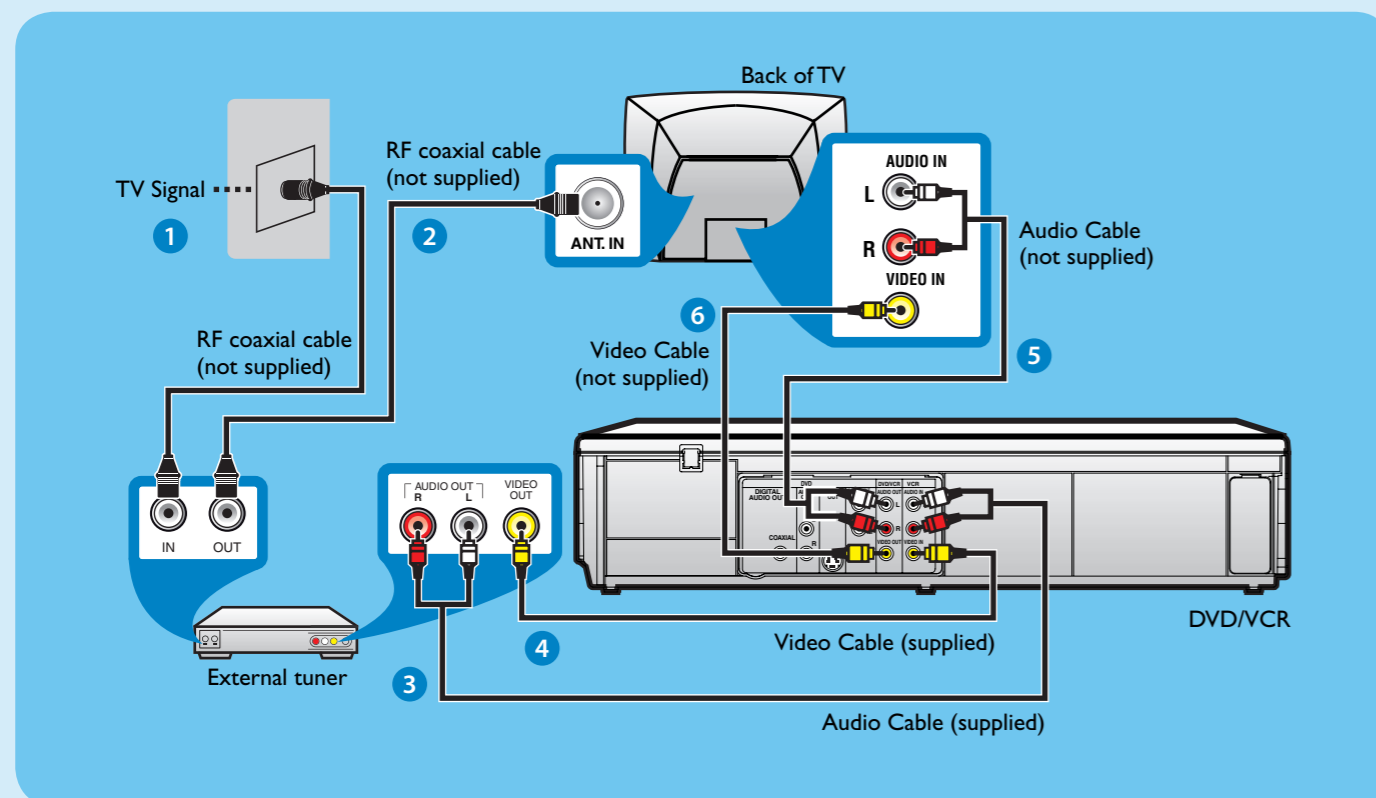

- 1 Connect a TV signal to the IN jack on the external tuner.
- 2 Use an RF coaxial cable (not supplied) to connect the OUT jack on the external tuner to the ANT. IN jack on the TV.
- 3 Connect the red and white audio cable (supplied) to the red and white AUDIO OUT jacks on the external tuner and to the red and white VCR AUDIO IN jacks on the DVD/VCR.
- 4 Connect the yellow video cable (supplied) to the yellow VIDEO OUT jack on the external tuner and to the VCR VIDEO IN jack on the DVD/VCR.
- 5 Connect another red and white audio cable (not supplied) to the red and white DVD/VCR AUDIO OUT jacks on the DVD/VCR and to the red and white AUDIO IN jacks on the TV.
- 6 Connect another yellow video cable (not supplied) to the DVD/VCR VIDEO OUT jack on the DVD/VCR and to the VIDEO IN jack on the TV. If your TV has antenna in jack only, it is still possible to connect this unit to your TV by using a commercially available stereo audio/video RF modulator. Refer to the manual accompanying the modulator for more information.
- 7 Connect the power cords of the TV and the DVD/VCR to a power outlet. Turn on the TV and set it to the correct Video In channel.

For additional connection diagrams, see the accompanying User Manual.

This DVD/VCR does not have a tuner input jack. To record TV programs on your DVD/VCR, you need to connect this DVD/VCR to an external tuner device (e.g., set top box, cable box or satellite receiver) that has audio/video output jacks.

2 Basic Setup

Finding the Viewing Channel

- 1 Press to turn on the DVD/VCR.
- 2 Turn on your TV.
- 3 Press "2" on the TV's remote control, then press channel down button repeatedly until you see the Language Select Menu. This is the correct viewing channel (Video In channel) for the recorder.

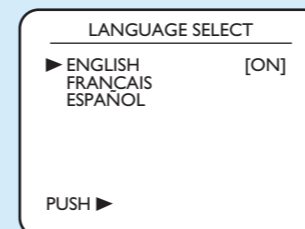

* Refer to your TV's user manual for details.

Initial Settings

A LANGUAGE - VCR

- 1 Press . VCR light will appear on the front of the DVD/VCR. The display shown below will appear.

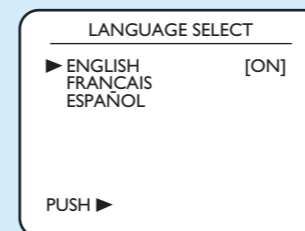

- 2 Press or to select ENGLISH, FRANCAIS (French) or ESPAÑOL (Spanish) as the language for VCR On-Screen Displays and menus. Then, press .

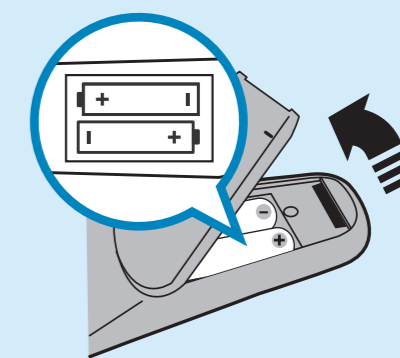
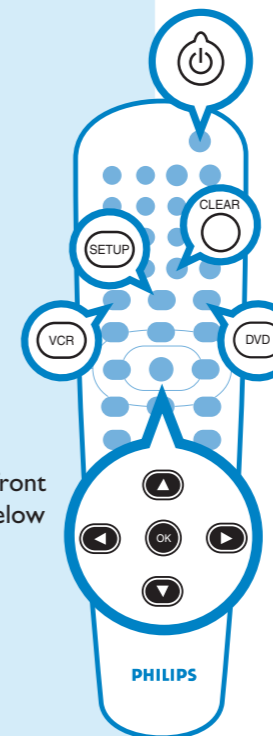

B CLOCK

- 1 Press then press so CLOCK SET Menu appear.
- 2 While the MONTH space is flashing, press or until the month appears. Then, press .

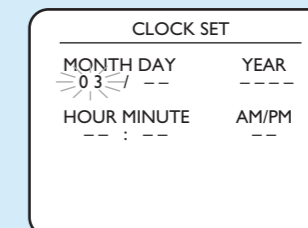

- 3 Likewise, set the DAY, YEAR, HOUR and MINUTE. Then press .
- 4 While the AM or PM space is flashing, press or to point to AM or PM.
- 5 Press or to start the clock.

C LANGUAGE - DVD

- 1 Press to put the DVD/VCR in DVD mode.
- 2 While playback is stopped, press .
- 3 Press or to select CUSTOM at the top of the menu, then press .
- 4 With (LANGUAGE) selected, press .

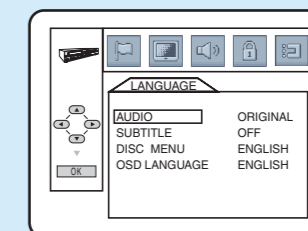

- 5 Press or to select OSD LANGUAGE. Press .
- 6 Press or to select a language, then press .
- If you select OTHER for AUDIO, SUBTITLE, or DISC MENU, press four **Number buttons** to enter the code for the language you desire. Use one of the Language Codes listed on page 49 in the User Manual.