

3 Enjoy

Start Playback

- 1 Press **OPEN/CLOSE** on the remote control, load in a disc and close the disc tray.
- 2 Press **DISC MENU** and use up or down keys to select a title.
- 3 Press **PLAY/PAUSE** to start playback.
- 4 To stop playback, press **STOP** .

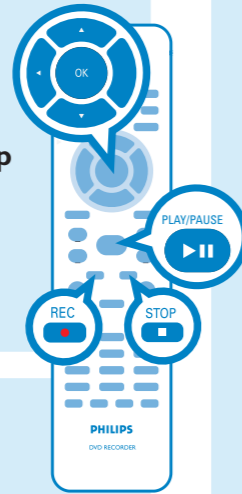

Start Recording

A Recording from the TV or an external device

- 1 Insert a recordable DVD disc in the tray.

Types of discs for recording



- 2 Press **SOURCE** repeatedly to select the source to record from. (eg, TUNER, CAM1, CAM2, DV, EXT1, EXT2 or EXT3.)
 - To record a TV programme, use **P + / -** to scroll through the channels, or press **0** **-9** to select the channel that you want to record.
- 3 Press **REC MODE** repeatedly to select the mode of recording quality.
- 4 Press **REC** to start recording, press **REC** again to automatically record 30 minutes.

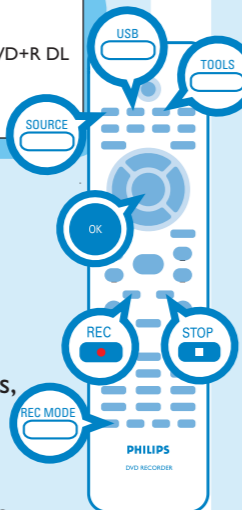

A Recording from the TV or an external device (continued)

- 5 To end recording, press **STOP** . 'UPDATE' will be displayed on the recorder.
- 6 To playback the recording, press **DISC MENU** , select the title and press **PLAY/PAUSE** .

B Archiving from a USB device

- 1 Insert a recordable DVD disc in the tray.
- 2 Connect the USB flash drive into the USB port on the front panel of the recorder.
- 3 Press **TOOLS** to access the USB mode.
 - Select { **Copy to DVD** } and press **OK** .
 - The USB content menu appears.

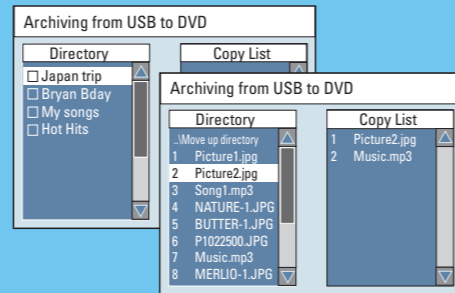

- 4 Select the folder you want and press **OK** to access the folder/ album.
- 5 Create a copy list, highlight the file you want to copy and press **SELECT** .
 - The selected files will appear on the right { **Copy List** } screen.
 - To remove the file from the copy list, press **CLEAR** .
- 6 Once the copy list selection is complete, press **REC** to start archiving.
 - A message will appear. Select **OK** in the menu and press **OK** to proceed.

Quick Start Guide



- 1 Connect
- 2 Set up
- 3 Enjoy

What's in the box?

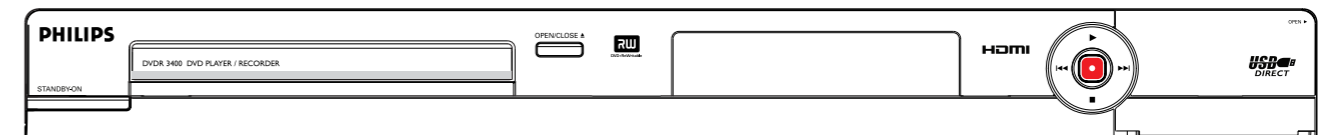

DVD Player/ Recorder

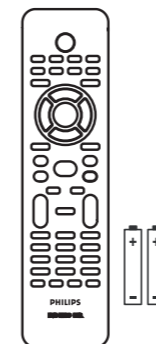

Remote Control and 2 batteries



RF Coaxial Cable

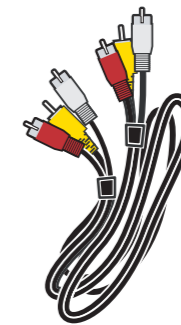

Audio/video cable

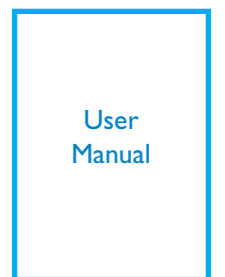

User Manual

Need help?

User Manual

See the user manual that came with your Philips recorder.

Hotline

Call 1-888-PHILIPS (1-888-744-5477) for our operators.

Online

Go to www.philips.com/usasupport.



2006 © Philips Consumer Electronics
A Division of Philips Electronics North
America Corp
P.O. Box. 671539 Marietta, GA 30006 0026
All rights reserved.

Printed in China
12 NC 3139 245 22141



1 Connect

Start with the 'Basic Connection.'

If you have a VCR, follow the instructions for 'Connection with a VCR or similar device'.

Basic Connection

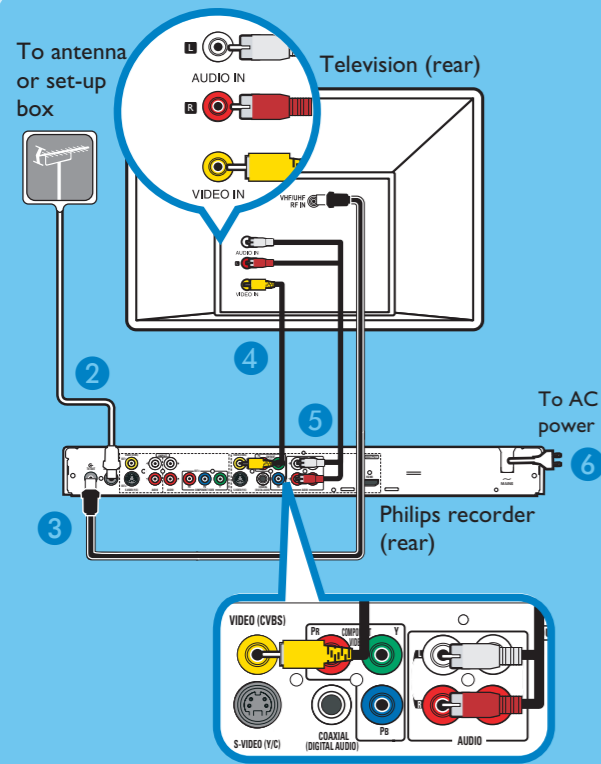

- 1 Before connecting, unplug the antenna cable that is currently connected to your TV.
- 2 Connect the antenna cable to the **ANTENNA-IN** jack on the recorder.
- 3 Use the supplied RF coaxial cable to connect the **TV-OUT** jack on this recorder to the Antenna In jack on the TV.
- 4 Use the supplied video cable (yellow plug) to connect the **VIDEO (CVBS) OUTPUT** jack on this recorder to the VIDEO IN jack on the TV.
- 5 Use the supplied audio/video cable (red/ white plugs) to connect the **AUDIO OUTPUT** jacks on this recorder to the AUDIO IN jacks on the TV.
- 6 Connect the power cable from the recorder to an AC power outlet.

Connection with a VCR or similar device

Your new Philips recorder replaces the VCR for your recording needs. First, unplug all the connections from your VCR.

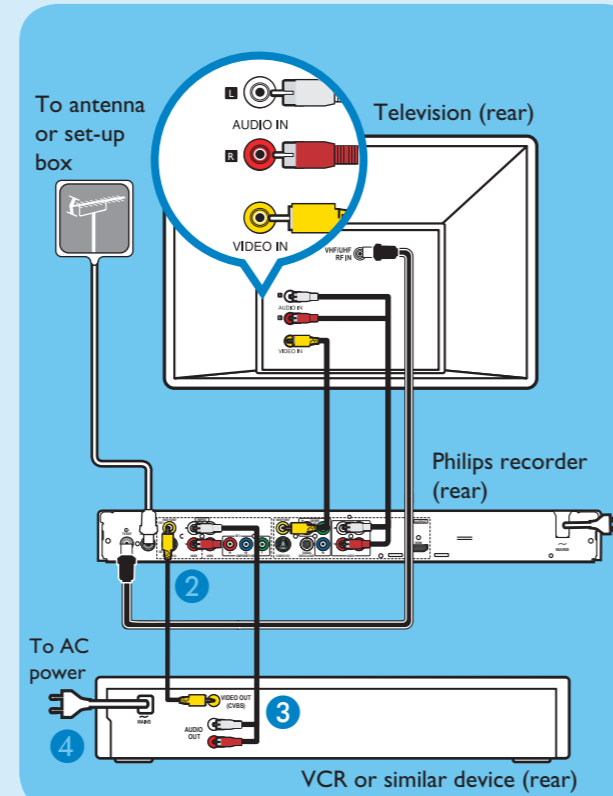

- 1 Follow the steps under 'Basic Connections' to before you proceed to step 2 below.
- 2 Use a yellow video cable (not supplied) to connect the **VIDEO (CVBS) INPUT** jack on this recorder to the yellow VIDEO OUT jack on the VCR.
- 3 Use another red and white audio cable (not supplied) to connect the **AUDIO INPUT** jacks on this recorder to the red and white AUDIO OUT jacks on the VCR.
- 4 Connect the power cable from your VCR to an AC power outlet.

Note In this setup, the VCR cannot record TV programs.

For additional connection diagrams, see the accompanying User Manual.

2 Set up

A Finding the viewing channel

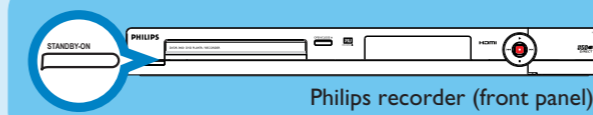

- 1 Press **STANDBY-ON** on the recorder.

- 2 Turn on the TV set.

Note If connected to your VCR, make sure it is turned off or in standby mode before proceeding.

- 3 Press '0' and then the Channel Down button on the TV's remote control repeatedly until you see this screen. This is the correct viewing channel for the recorder.



Note You may press the AV or SELECT button on the TV's remote control (if available) to select the correct viewing channel. See your TV's user manual.

B Initial Installation

- 1 Press **SETUP** on the remote control.



Note Use up and down keys to toggle through the options. Select an item by pressing right. To confirm a setting, press **OK**.

- 2 Select the OSD language.

- Remain in **Settings** mode, select { **On Screen Display Language** } and press **right** to access the options.
→ Select the desired language option and press **OK** to confirm your selection.

- 3 Setup and install TV channels.

- Highlight **Tuner Input Source** and press **right**. Select { **Tuner Input Source** } and press **OK**.
 - { **Cable** } – if the recorder is connected directly to the cable signal or through a set-top box.
 - { **Air** } – if the recorder is connected directly to an indoor or outdoor antenna.

Note Press **OK** to confirm your selection.

- Select { **Channel Search** } and press **OK** on the remote control to start automatic TV channel search.

- 4 Set the date and time.

- Highlight **Date/Time** and press **right**. Select { **Date (mm/dd/yy)** } or { **Time (hh:mm:ss)** } and press **OK**.
Use the **numeric keypad** 0-9 to input the date/time, then press **OK** to confirm.

Note To further fine-tune the date and time settings, see the user manual "CLOCK Settings".

- 5 Press **SETUP** to exit.