

# Quick Use Guide



Let's make things better



PHILIPS

There are many ways to connect your new DVD/SACD Player to your Television and other equipment. This Quick Use Guide shows the easiest, most common connection between the Player and a TV. Higher quality connections are explained in the accompanying owner's manual and will provide better sound or picture if your TV and/or audio system is compatible.

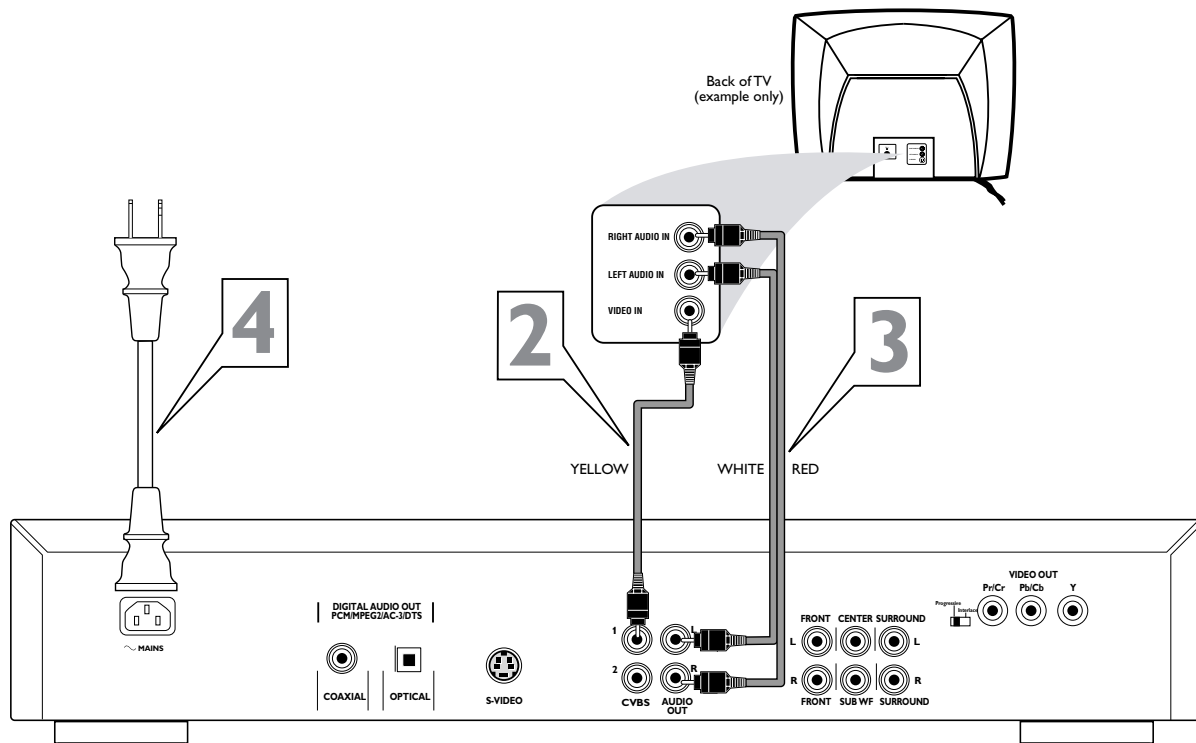

- 1** Disconnect all equipment from the power outlets. Connect the equipment to the power outlets only after you have finished hooking up everything. Never make or change connections with equipment connected to the power outlet.
- 2** Connect the yellow CVBS I (VIDEO OUT) jack of the Player to the corresponding VIDEO IN jack on your TV. Use the supplied video cable, which has yellow ends. On the TV, the VIDEO IN jack is usually yellow and might be labeled video, CVBS, composite, or baseband.
- 3** Connect the supplied audio cable to the red and white AUDIO OUT (right and left) jacks on the Player and to the right/left AUDIO IN jacks on the TV. The supplied audio cable has red and white ends. Match the cable colors to the jack colors. On the TV, the AUDIO IN jacks are usually labeled Audio. The red jack is the right (stereo channel) and the white jack is the left (stereo channel).
- 4** Plug the power cords of the Player and the TV into an active power outlet. Press the **STANDBY-ON** button on the front of the Player to turn on the Player.
- 5** Turn on the TV power. Set the TV to the correct Video In channel. Such channels may be called AUX or AUXILIARY IN, AUDIO/VIDEO or A/V IN, EXT1 or EXT2 or External In, etc. These channels are often near channel 00. See your TV manual for details. Or, change TV channels until you see the Player's blue screen saver on the TV.

## Remember...

- Connect the Player directly to the TV. For example, do not connect the Player to a VCR, then connect the VCR to a TV. This type of connection may distort the picture and sound or give you a black and white picture. Also, your VCR might have the copy protection system, which could distort the DVD image or prevent playback of some Discs.
- If your TV does not have red, white, and yellow Audio and Video In jacks, refer to the owner's manual for other hookup options. If your TV only has a single Antenna In or RF In jack, you will need an RF modulator. See the owner's manual for details.

# Quick Use Guide (cont'd)

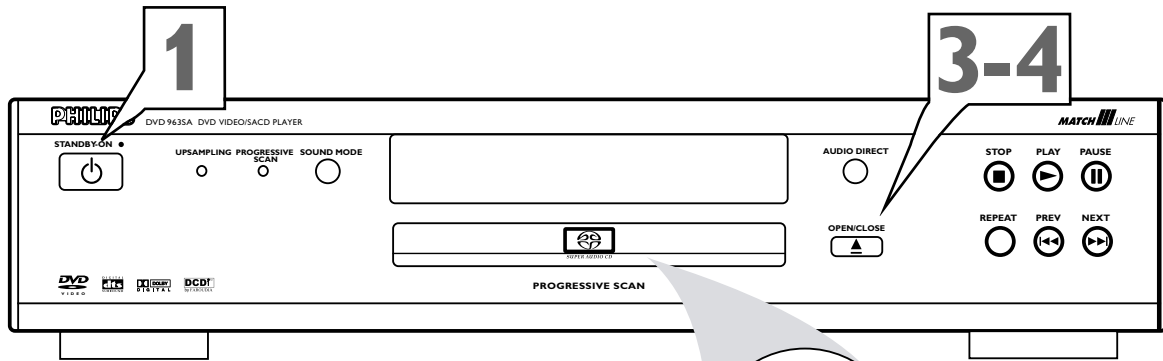

To simply play a Disc, follow these steps. Additional playback features are described in the accompanying owner's manual.

- 1** Press **STANDBY-ON** on the front of the Player to turn on the Player. (You can turn on the Player by pressing **POWER** on the remote control only if the **STANDBY-ON** button on the front of the Player is depressed.)
- 2** Turn on your TV. Set it to the correct **Video In** channel. You should see the Player's blue screen saver on the TV (if no Disc is in the Player).
- 3** Press **OPEN/CLOSE** on the front of the Player to open the disc tray.
- 4** Load your Disc in the tray, with the label facing up. If the Disc (DVD) is two-sided, make sure the side you want to play is facing up. Press **OPEN/CLOSE** again to close the tray.
- 5** Playback may start automatically. If not, press **PLAY** . If a Disc menu appears, use the and **OK** buttons or the Number buttons to select features or start playback from a menu. Follow the instructions in the Disc menu.
- 6** To stop playing the Disc, press **STOP** .

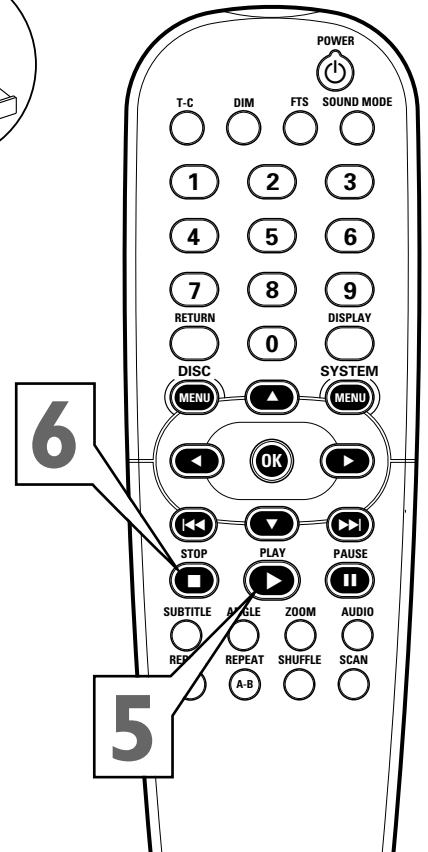
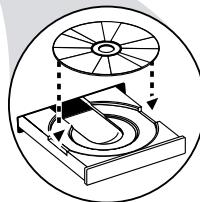

## Playable Discs

This DVD Player will play the following types of Discs:

DVD (Digital Video Disc)	MP3 files	Video CD	CD-R (CD-Recordable)
Super Audio CD (Compact Disc Digital Super Audio)	Audio CD (Compact Disc Digital Audio)	Super Video CD	CD-RW (CD-Rewritable)

## Region Codes

DVDs must be labeled for **ALL** regions or for **Region 1** in order to play on this Player. You cannot play Discs that are labeled for other regions. If one of these logos appears on your DVD or its case, it should play on this Player.



## Color Systems

Recordings are made according to a color system. The most common color system in the United States is NTSC. This Player is compatible with NTSC and PAL. **Make sure the Discs you play were recorded in NTSC or PAL and your TV is NTSC or PAL compatible.** Look for the color system of the DVD on the DVD or on the Disc case.

