

Quick Start Guide



- Step A *Connect*
- Step B *Setup*
- Step C *Enjoy*

What's in the Box?

You should find these items upon opening the box.

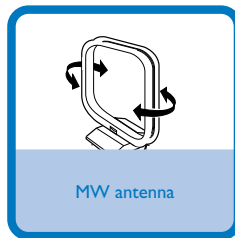
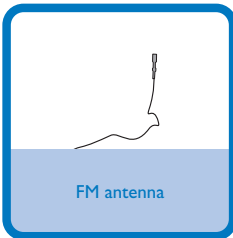

Pull out the plastic protective sheet before use.

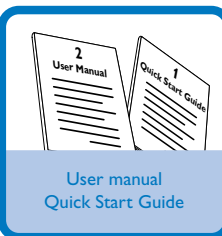
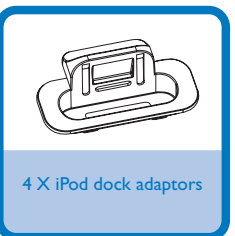
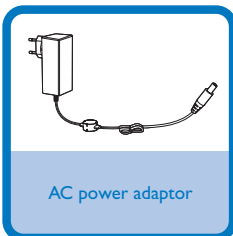
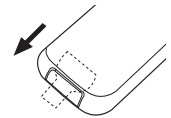

PHILIPS

Step A *Connect*

1 Connect the MW and FM antennas.

2 Connect the AC power adaptor of the system.

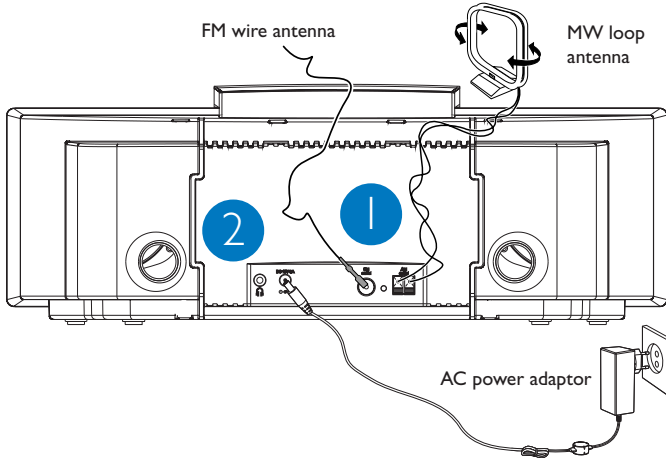

Tip

– See the User Manual for how to connect other equipment to this system.

– Use the supplied AC power adaptor only! Using any other power connection device may damage your main set!

Step B *Setup*

Setting the clock

1 In standby mode, press **PROG**.
→ **SET CLOCK** is displayed briefly. Then, **12HR** or **24HR** is displayed.

2 Press **ALBUM/PRESET +/-** (or **◀/▶** on the remote control) to select clock mode.
→ The clock digits for the hours continue to flash.

3 Press **ALBUM/PRESET +/-** (or **◀/▶** on the remote control) to set the hours.

4 Press **PROG** again.
→ The clock digits for the minutes flash.

5 Press **ALBUM/PRESET +/-** (or **◀/▶** on the remote control) to set the minutes.

6 Press **PROG** to confirm the time.



Playing a disc

- 1 Insert a disc into the disc loader.
→ Make sure the label side is facing up.
- 2 Press **▶||** to start playback.
- 3 To stop playback, press **■**.

Playing a USB mass storage device

With the Hi-Fi system, you can use USB flash memory (USB 2.0 or USB1.1), USB flash players (USB 2.0 or USB1.1), memory cards (requires an additional card reader to work with this Hi-Fi system).

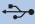
- 1 Insert the USB device's USB plug into the socket  on the set.
- 2 Press **SOURCE** once or more (or **USB** on the remote control) to select **USB**.
- 3 Play the USB's audio files as you do with the albums/tracks on a CD.

Programming and tuning to radio stations

- 1 Press **SOURCE** repeatedly (or **TUNER** on the remote control) to select the tuner source.
- 2 Press **PROG** for more than two seconds to program all available stations in order of waveband.
- 3 Press **ALBUM/PRESET +/-** (or **▲ / ▼** on the remote control) until the desired preset station is displayed.

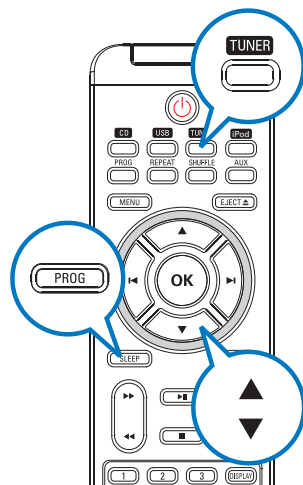

Playing Apple iPod using DCM230

1 Select the correct dock adaptor, as indicated on each adaptor, then fit it in the dock.

2 Correctly place the compatible iPod player into the dock.

3 Press **SOURCE** on the system repeatedly or **iPod** on the remote control to select the iPod source.

4 Power on your iPod player.

5 Select and play your favourite songs stored in the iPod player.

Tip

Detailed playback features and additional functions are described in the accompany owner's manual.

Notes for remote control:

- First select the source you wish to control by pressing one of the source select keys on the remote control (for example CD, FM).
- Then select the desired function (for example ► II, ◀◀, ▶▶).

