

Register your product and get support at

www.philips.com/welcome

CSP410
CSP510
CSP610
CSP6910



EN User manual

PHILIPS

1. Important

Safety

- Read and understand all instructions before you use the apparatus. If damage is caused by failure to follow instructions, the warranty does not apply.
- Use only the supplied mounting hardware for a safe and secure installation.
- Do not continuously use the speaker system beyond the peak power handling capacity.
- Keep credit cards, watches, recorded tapes etc. with magnetic coding away from the speaker system to prevent damage caused by the magnets in the speakers.
- Clean the apparatus with soft, damp cloth. Never use substances such as alcohol, chemicals or household cleaners on the apparatus.

Notice

Environmental information

All unnecessary packaging has been omitted. We have tried to make the packaging easy to separate into three materials: cardboard (box), polystyrene foam (buffer) and polyethylene (bags, protective foam sheet.) Your system consists of materials which can be recycled and reused if disassembled by a specialized company. Please observe the local regulations regarding the disposal of packaging materials, exhausted batteries and old equipment.

Any changes or modifications made to this device that are not expressly approved by Philips Consumer Lifestyle may void the user's authority to operate the equipment.

2009 © Koninklijke Philips Electronics N.V. All rights reserved.

Specifications are subject to change without notice. Trademarks are the property of Koninklijke Philips Electronics N.V. or their respective owners. Philips reserves the right to change products at any time without being obliged to adjust earlier supplies accordingly.

2. Your car stereo speakers

Congratulations on your purchase, and welcome to Philips! To fully benefit from the support that Philips offers, register your product at www.philips.com/welcome.

Introduction

With the speakers, you can enjoy high power music with vivid sound.

What's in the box

Check and identify the contents of your package:

- ① Speakers (x2)
- ② Grille net + Frame (x2)
- ③ Speaker wire (x2)
- ④ Screw (x8)
- ⑤ Shrapnel (x8)

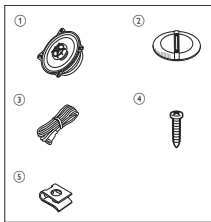

3. Installation

A depth of at least 48mm is required to mount the subwoofer. Measure the depth of the area where you are to mount the subwoofer, and ensure that the subwoofer does not obstruct any other components of the car.

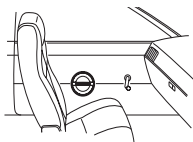

Option 1: Mount on door (front or rear)

You can mount the speakers on the front/rear door of your car.

Note

- Make sure that nothing obstructs around the mounting location of the door.
- A hole for mounting may already be cut out of the inner panel of the door (front or rear). In this case, you need to modify the board only.
- Ensure that the speaker terminals, frame or magnet do not interfere with any inner parts, such as the window mechanism in the door (when you open or close the window), etc. Also ensure that the speaker grille does not touch any inner fittings, such as the window cranks, door handles, arm rests etc.

- 1 Turn off the car ignition key.
 - If the power is on, the click noise generated by the connection may damage the speakers.
- 2 Cut out the mounting template from the packing box.
- 3 Paste the template on the location selected for mounting the speaker.
- 4 Mark the cut-off hole and the 4 bolt holes.

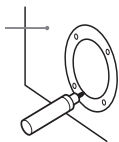

- 5 Cut out the marked area and drill the bolt holes.

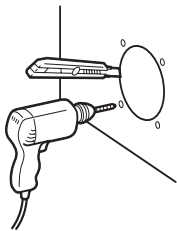

6 Remove the grille net.

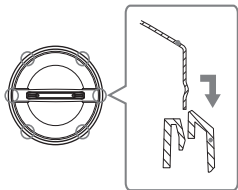

7 Strip the speaker wires and connect them to the amplifier.

- Black wire: connect to left speaker
- Black (white lined): connect to right speaker

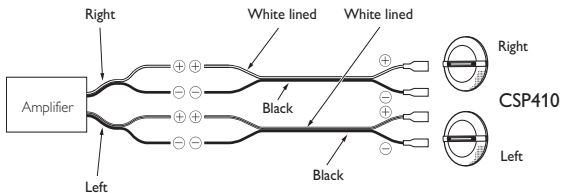

Note

- Match the "left", "right", "+" and "-" terminals correctly. Revised polarity may degrade sound quality.
- Two 4-ohm speakers, wired in stereo, present a 4 ohm load to each channel of the amplifier. Most two channel amplifiers work well in this configuration. However, if two 4-ohm speakers, wired in parallel to a bridged two -channel amplifier, present a 2-ohm mono load to the amplifier. Most 2-channel amplifiers do not support 2-ohm mono operation! Amplifier damage may result!

8 Mount on the speaker as shown below.

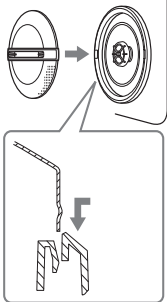
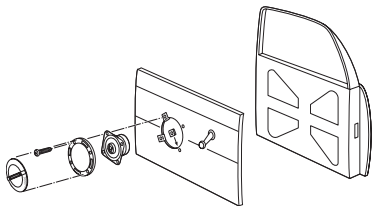

9 Press and insert the edges of the grille net.



Tip

- The speaker grille can be mounted without the grille net, if you like.

Option 2: Mount on rear tray

You can also mount the speakers into the surface of the rear tray.

Follow the steps in section “Option 1: Mount in door” to mount the speakers into the rear tray:

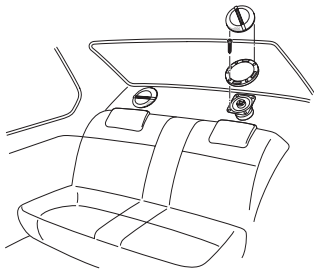

4. Product information

Note

- Product information is subject to change without prior notice.

Model	CSP410	CSP510
Speaker type	10cm 2-way coaxial speaker	13cm, 2-way coaxial speaker
RMS power (Watts)	30W	35W
Peak music power (Watts)	150W	180W
Sensitivity (dB/W/m)	88dB	89dB
Frequency response (Hz)	50-30kHz	45-30kHz
Impedance (ohms)	4 ohms	4 ohms
Magnet mass (Oz)	4.4Oz	6.4Oz

Model	CSP610	CSP6910
Speaker type	16.5cm, 2-way coaxial speaker	16x24cm, 3-way triaxial speaker
RMS power (Watts)	40W	50W
Peak music power (Watts)	210W	300W
Sensitivity (dB/W/m)	90dB	90dB
Frequency response (Hz)	40-30kHz	28-32kHz
Impedance (ohms)	4 ohms	4 ohms
Magnet mass (Oz)	7.6Oz	12.6Oz

5. Troubleshooting

To keep the warranty valid, never try to repair the system yourself. If you encounter problems when using this apparatus, go to the Philips web site (www.philips.com/welcome). When you contact Philips, ensure that the apparatus is nearby and the model number and serial number are available.

Name of the Parts	Hazardous/toxic Substance					
	Pb, Lead	Hg, Mercury	Cd, cadmium	Chromium 6+	PBB	PBDE
Housing	○	○	○	○	○	○
Loudspeakers	○	○	○	○	○	○
PWBs	×	○	○	○	○	○
Accessories (Remote control & cables)	×	○	○	○	○	○

- O: Indicates that this toxic or hazardous substance contained in all of the homogeneous materials for this part is below the limit requirement in SJ/T11363 - 2006.
- X: Indicates that this toxic or hazardous substance contained in at least one of the homogeneous materials used for this part is above the limit requirement in SJ/T11363 - 2006.



Environmental Protection Use Period

This logo refers to the period (10 years) during which the toxic or hazardous substances or elements contained in electronic information products will not leak or mutate so that the use of these [substances or elements] will not result in any severe environmental pollution, any bodily injury or damage to any assets.

