

Welcome

Quick start guide

- 1 Prepare
- 2 Connect
- 3 Set up
- 4 Enjoy



PHILIPS

What's in the box

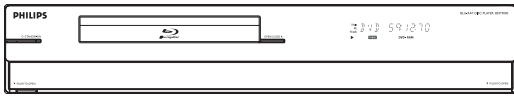

a. BDP9000
Blu-ray Disc player

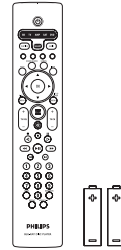

b. Remote control
RC4380

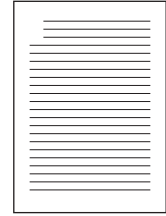

c. Quick start guide

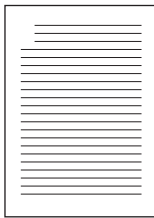

d. BDP9000
User manual

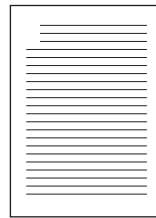

e. RC4380
User manual

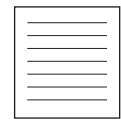

f. Product
registration card

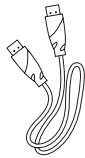

g. HDMI cable

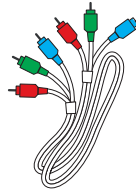

h. Component
video cable

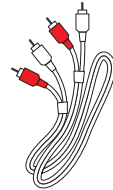

i. Audio cable

What else you'll need



HDTV

Television

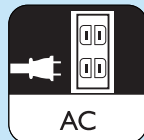

AC

Power outlet

Result after installation



Optional components (not supplied)

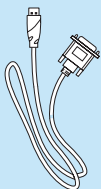

HDMI-DVI
cable

NOTE:

Refer to the user manual for:

- Important safety instructions.
- Other possible connections (for example, digital audio).

I

Prepare

A Prepare the remote control

- 1 Open the battery compartment of the remote control.
- 2 Insert the batteries correctly.
- 3 Close the battery compartment.

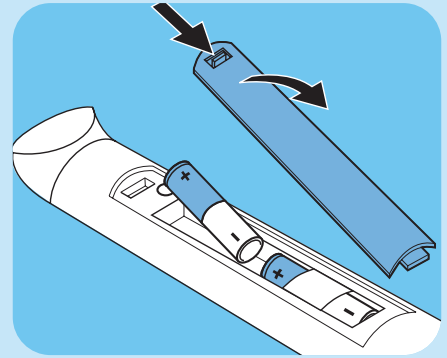

2

Connect

For more information about the ports on your TV, refer to the user manual of your TV.

A Connect the TV

Option 1 - Best high-definition quality - For TVs with an HDMI port:

1. Take the supplied HDMI cable (g).
2. Plug one end of the HDMI cable into the **HDMI OUT** port.
3. Plug the other end of the HDMI cable into the TV.

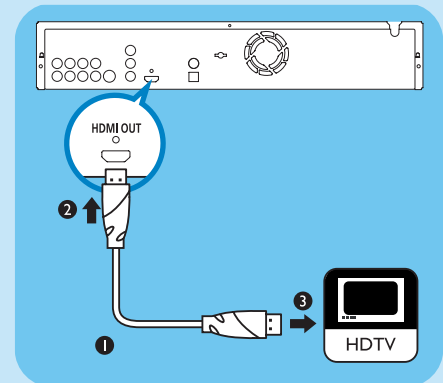

Option 2 - Best high-definition quality - For TVs with a DVI port:

1. Take a HDMI-DVI cable (not supplied).
2. Plug one end of the HDMI-DVI cable into the **HDMI OUT** port.
3. Plug the other end of the HDMI-DVI cable into the TV.

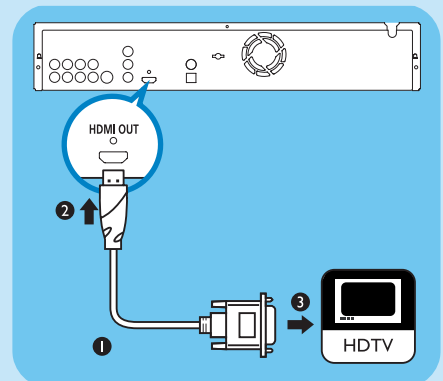

4. Take the supplied audio cable (i).
5. Plug one end of the audio cable into the **AUDIO-L** and **AUDIO-R** ports.
6. Plug the other end of the audio cable into the TV.

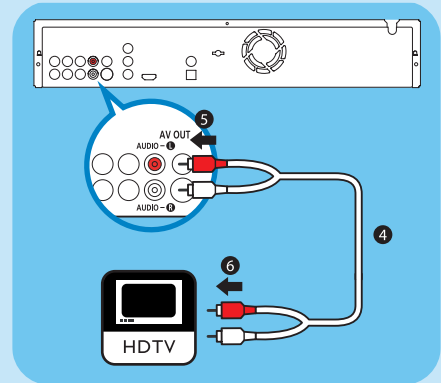

Option 3 - Good quality - For TVs with component video ports:

1. Take the supplied component video cable (h).
2. Plug one end of the component video cable into the **Y**, **Pb** and **Pr** ports.
3. Plug the other end of the component video cable into the TV.

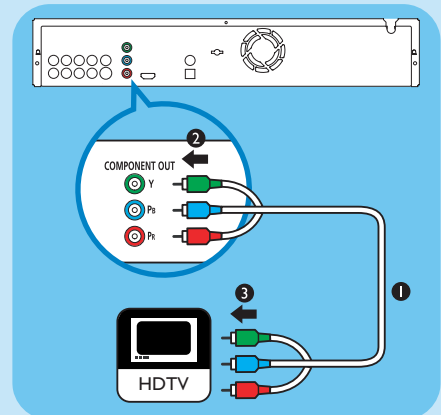

4. Take the supplied audio cable (i).
5. Plug one end of the audio cable into the **AUDIO-L** and **AUDIO-R** ports.
6. Plug the other end of the audio cable into the TV.

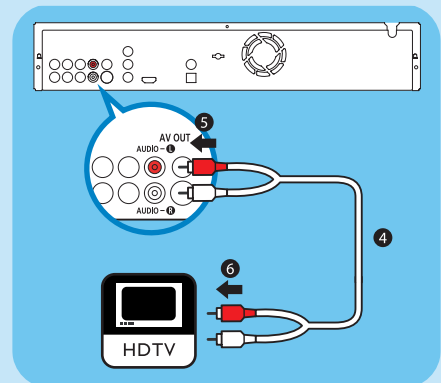

B Connect to the power outlet

1. Plug the power cable into the power outlet.
 > The **STANDBY-ON** light comes on as red.

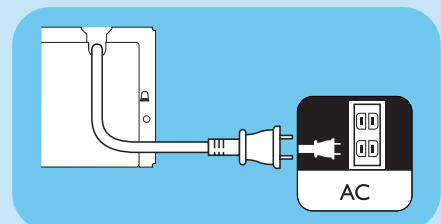

3

Set up

1. Turn the TV on.
2. Set the TV to the correct external input.
3. Press the **STANDBY-ON** button.
 - > The **STANDBY-ON** light comes on as blue.

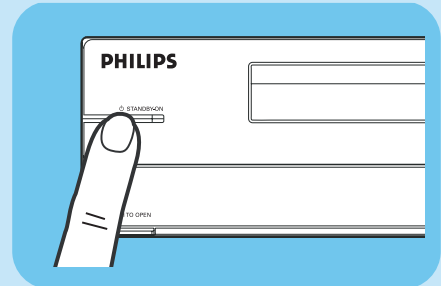

4. Open the user access panel.

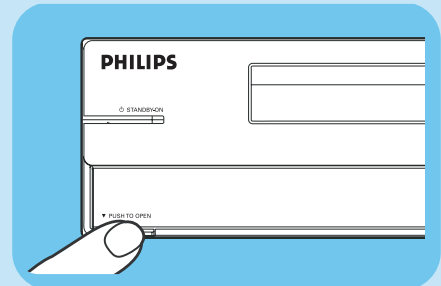

5. If the TV connection is HDMI (refer to 1A), press the **VIDEO OUTPUT SELECTION** button until the **HDMI** light comes on.
 - > The video signal of the Blu-ray Disc player shows.

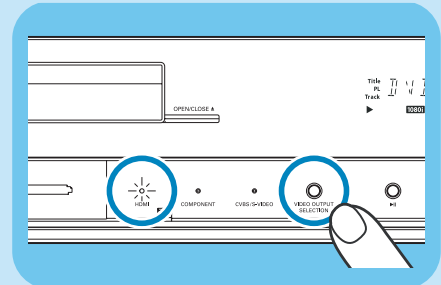

6. If the TV connection is component video (refer to 1B), press the **VIDEO OUTPUT SELECTION** button until the **COMPONENT** light comes on.
 - > The video signal of the Blu-ray Disc player shows.

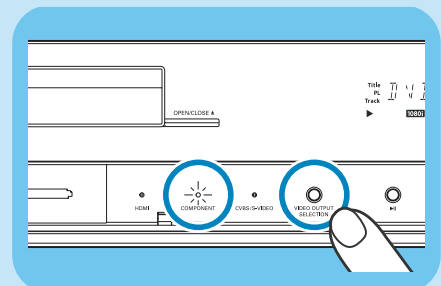

7. Follow the on-screen instructions.

Menu language selection

Press 1 for English
Pulsar 2 para Español
Touche 3 pour Français

4

Enjoy

A Load a disc

1. Press the **OPEN/CLOSE** button.
> *The disc tray opens.*

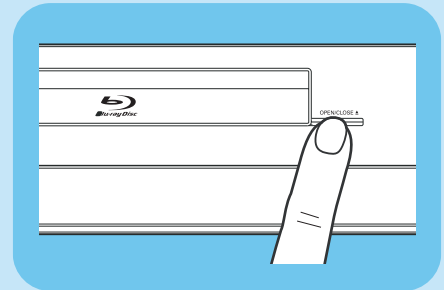

2. Put the disc in the disc tray with the label on the top.

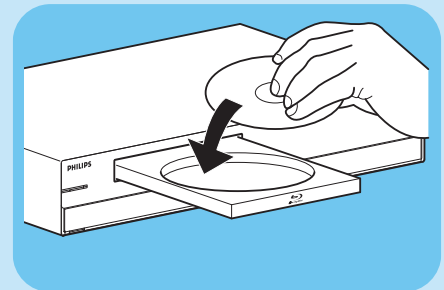

3. Press the **OPEN/CLOSE** button again.
> *The disc tray closes.*

B Control a disc

You can now enjoy your Blu-ray Disc player. Control the disc with:

- The supplied universal remote control.
- The buttons on the front of the Blu-ray Disc player.

Troubleshooting

Problem

Tip

Cannot play a disc

- Put the disc in the disc tray with the label on the top.
- Make sure that the Blu-ray Disc player supports the disc type.
- Make sure that the Blu-ray Disc player supports the region code of the DVD or BD.

No video signal on the connected TV

- Turn the TV on.
- Set the TV to the correct external input.
- Use the **VIDEO OUTPUT SELECTION** button to set up the video output. Refer to 3. Set up.
- Do as follows:
 1. Press-and-hold the ►► button on the front panel for 5 seconds.
> *The factory default settings are restored.*
 2. Do the set-up again. Refer to 3. Set up.

Bad video signal on the connected TV

- Clean the disc.
- Make sure all cables are firmly inserted.

Incorrect aspect ratio on the connected TV

- Change the aspect ratio of the TV. Refer to the user manual of your TV.
- Change the aspect ratio on the Blu-ray Disc player. Refer to the user manual.

No audio signal

- Increase the volume level.
- Make sure that the audio settings of the TV are correct. Refer to the user manual of your TV.
- Try another track on the disc.



Need help?

User manuals

Refer to the supplied user manuals

Online help

www.usasupport.philips.com

Helpline

English	1-888-PHILIPS (1-888-744-5477)
French	1-800-661-6162
Spanish	1-888-PHILIPS (1-888-744-5477)

Specifications are subject to change without notice.
Trademarks are the property of Koninklijke Philips Electronics N.V. or their respective owners.
2006 © Koninklijke Philips Electronics N.V. All rights reserved.
www.philips.com

3122 337 03242