

MP3-CD Soundmachine

AZ1316

User Manual
Manuel d'utilisation
Manual del usuario
用戶手冊

Meet Philips at the Internet
<http://www.audio.philips.com>

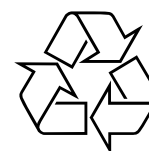

AZ 1316

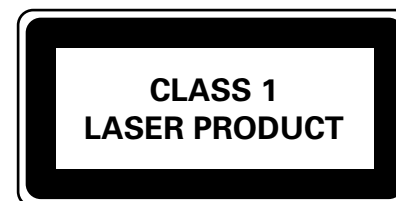

PHILIPS



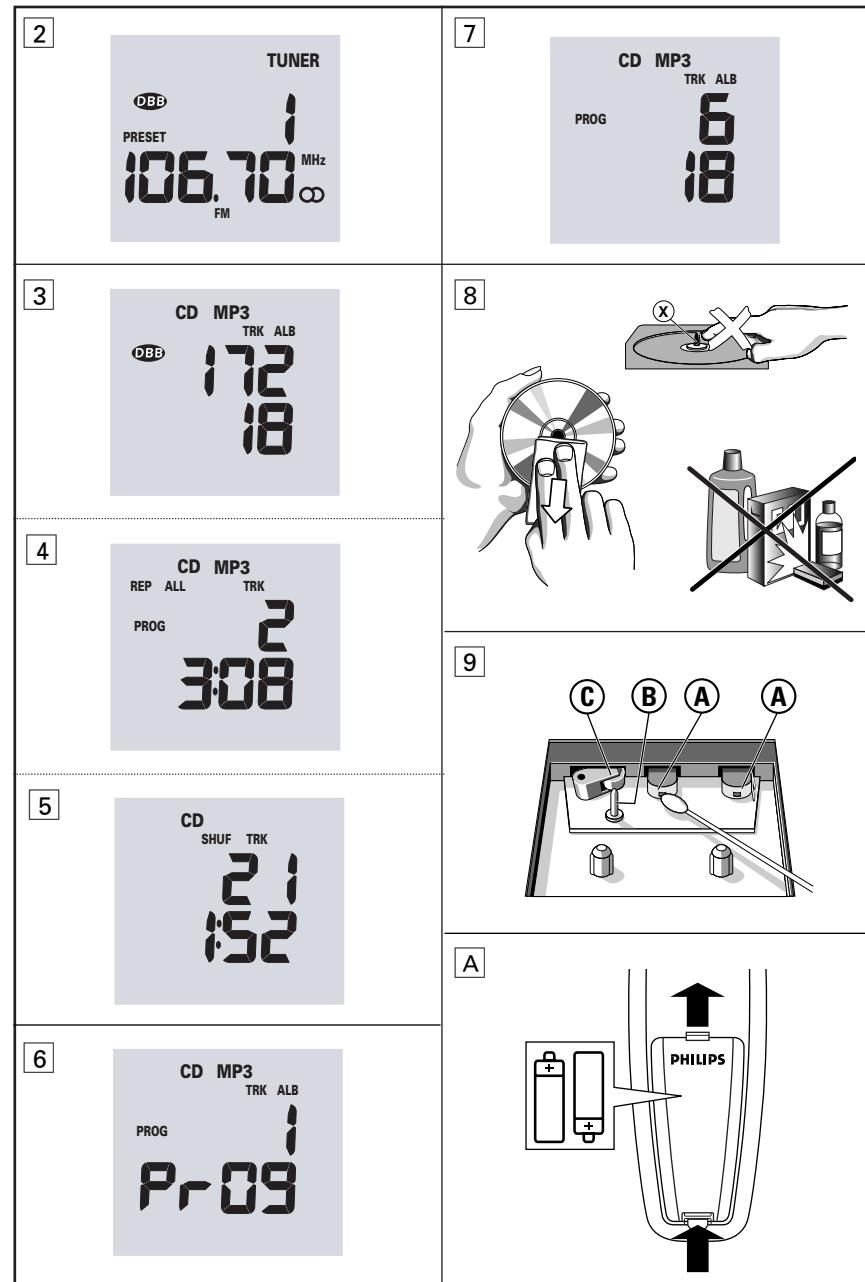
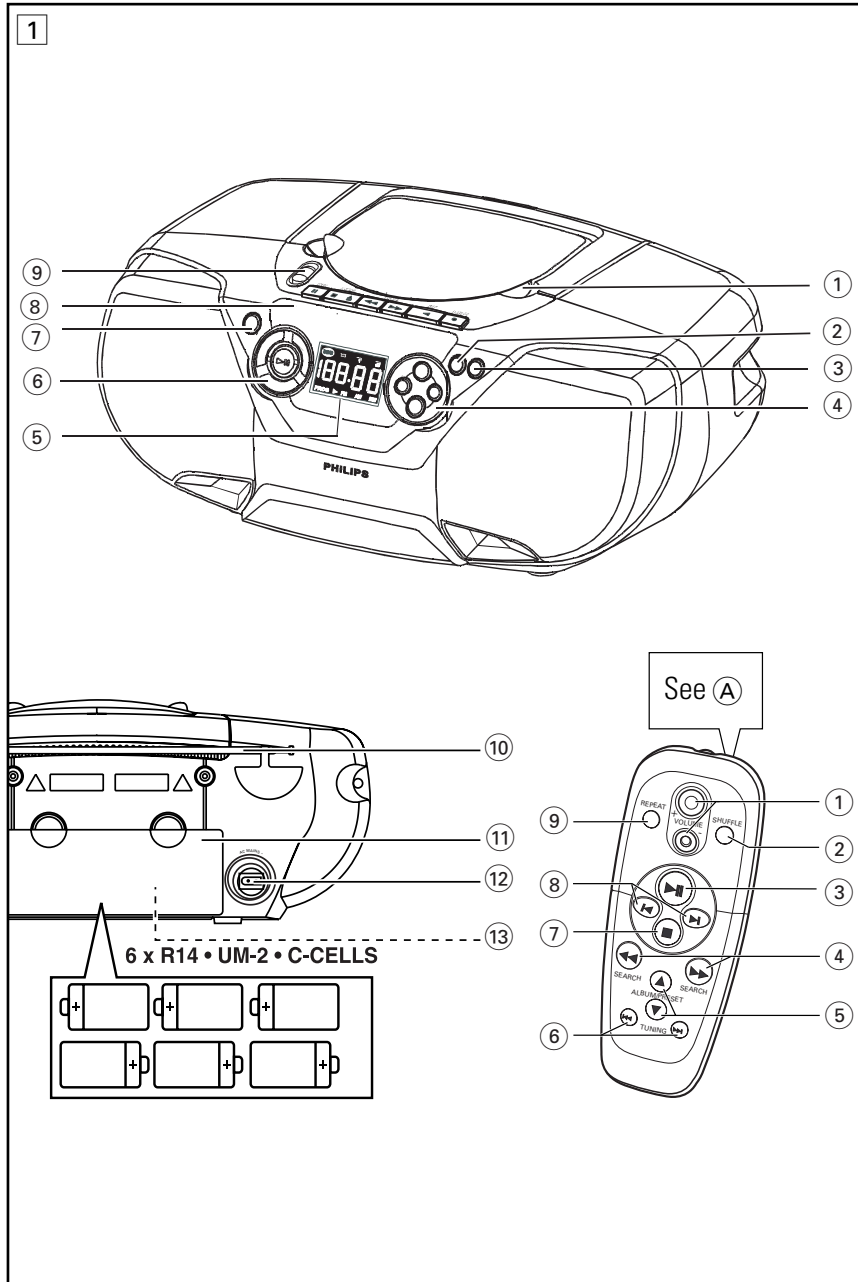

English

SUPPLIED ACCESSORIES

- AC mains lead
- remote control

TOP AND FRONT PANELS (See [1])

- PUSH TO OPEN** - press to open/close CD door
- PROG** -
CD/MP3: programs tracks and reviews the program
MW/FM: programs preset radio stations
- MODE** - selects different play modes: e.g. **REP** or **SHUF** (random order)
- VOL ▲, ▼** - adjusts volume level
ALBUM/PRESET +, - (up, down) -
MP3 only: selects albums
MW/FM: selects a preset radio station
- Display** - shows the status of the set
- ▶II** - starts or pauses CD playback.
■ - stops CD playback;
- erases a CD program
◀◀, ▶▶ TUNING DOWN, TUNING UP -
CD/MP3: - searches backward and forward within a track;
- skips to the beginning of a current track/
previous/ later track
MW/FM: - tunes to radio stations
- DBB (DYNAMIC BASS BOOST)** -turns the bass enhancement on / off
- CASSETTE RECORDER keys:**
RECORD ● - starts recording
PLAY ◀ - starts playback
SEARCH ◀◀ / ▶▶ - fast winds/ rewinds tape.
STOP•OPEN ▲ ■ - stops the tape;
- open the cassette compartment
PAUSE II - pauses playback or recording
- Source selector: CD/MP3, MW, FM, TAPE/OFF**
– selects CD/MP3-CD, radio or tape source of sound;
– switches off the set

CONTROLS/POWER SUPPLY

BACK PANEL

- Telescopic aerial** - improves FM reception
- Battery compartment** - for 6 batteries, type **R-14, UM2** or **C-cells**
- AC MAINS** - inlet for mains lead.
- Voltage selector** (inside the battery compartment, some versions only) - adjust to match the local voltage 110/220V before plugging in the set

REMOTE CONTROL

- VOLUME +, -** – adjusts volume level (up, down)
- SHUFFLE** – plays all CD tracks in random order
- ▶II** – starts/ pauses CD playback
- SEARCH ◀◀, ▶▶** – searches backwards/ forwards within a track
- ALBUM/PRESET ▲, ▼**
MP3 only: selects albums
MW/FM: selects a preset radio station (up, down)
- TUNING ◀◀, ▶▶** – tunes to tuner stations
- – stops CD playback;
– erases a CD programme
- ◀, ▶** – skips to the beginning of a current track previous/ subsequent track
- REPEAT** –selects repeat modes

CAUTION

Use of controls or adjustments or performance of procedures other than herein may result in hazardous radiation exposure or other unsafe operation.

MAINS SUPPLY

Whenever convenient, use the mains supply to conserve battery life. Make sure you remove the power plug from the set and wall socket before inserting batteries.

Batteries (not included)

Main set (See [1])

- Insert 6 batteries, type **R-14, UM2** or **C-cells**, (preferably alkaline) with the correct polarity.

Remote control (See [A])

- Insert 2 batteries, type **AAA, R03** or **UM4** (preferably alkaline).

POWER SUPPLY/BASIC FUNCTIONS

Incorrect use of batteries can cause electrolyte leakage and will corrode the compartment or cause the batteries to burst.

- Do not mix battery types: e.g. alkaline with carbon zinc. Only use batteries of the same type for the set.
- When inserting new batteries, do not try to mix old batteries with the new ones.
- **Batteries contain chemical substances, so they should be disposed of properly.**

Using AC Mains

- 1 Check if the mains supply, as shown on **the type plate located on the bottom of the set**, corresponds to your local mains supply. If it does not, consult your dealer or service centre.
- 2 If your set is equipped with a voltage selector, adjust the selector so that it matches with the local mains.
- 3 Connect the mains lead to the wall socket.
- 4 To disconnect the mains supply, unplug the set from the wall socket.

The type plate is located on the bottom of the set.

Helpful hints:

- To avoid unnecessary energy consumption, always adjust the **source selector** to **TAPE/OFF** after using the set. Also check that the tape deck keys are released.

BASIC FUNCTIONS

Switching on and off and selecting function

- 1 To switch on, adjust the **source selector** to **CD/MP3, MW, FM** or **TAPE/OFF** as desired.
- 2 To switch off, adjust the **source selector** to **TAPE/OFF** and check the cassette keys are released.

Helpful hints:

- To change from **TAPE** to **FM, MW** or **CD/MP3** function, or when you are switching off the set: first, make sure you press the **tape ▲ ■** key to end playback and all the cassette keys are released.
- The tone, sound settings, tuner presets and the volume level (up to a maximum volume level of 20) will be retained in the set's memory.

DIGITAL TUNER

Adjusting volume and sound

1. Adjust the volume with the **VOL ▲, ▼** controls. (or **VOLUME +, -** on the remote control)
→ Display shows **Vol** and the volume level in number from 00-32.
2. Press **DBB** once or more to select dynamic bass boost on or off.
→ Display: shows **DBB** when activated.

DIGITAL TUNER

Tuning to radio stations

- 1 Push the **source selector** to **MW** or **FM**.
– **FM** is displayed briefly and then the radio station frequency, waveband and, if programmed, a preset number are shown. (See [2])
 - 2 Press and hold **◀◀** or **▶▶** until the frequency in the display starts running.
→ The radio automatically tunes to a station of sufficient reception. Display shows **Search** during automatic tuning.
 - 3 Repeat step 2 if necessary until you find the desired station.
- To tune to a weak station, press **◀◀** or **▶▶** briefly and repeatedly until you have found optimal reception.

To improve radio reception:

- For **FM**, extend, incline and turn the telescopic aerial. Reduce its length if the signal is too strong.
- For **MW**, the set uses a built-in aerial. Direct this aerial by turning the whole set.

Programming radio stations

You can store up to a total of 20 radio stations in the memory (10 FM and 10 MW), manually or automatically (Autostore).

Manual programming

- 1 Tune to your desired station (see **Tuning to radio stations**).
 - 2 Press **PROG** to activate programming.
→ Display: **PROG** flashes.
 - 3 Press **-, +** (on the remote control **▲, ▼**) once or more to allocate a number from 1 to 10.
 - 4 Press **PROG** to confirm.
 - 5 Repeat steps 1-4 to store other stations.
- Helpful hints:** You can erase a preset station by storing another frequency in its place.

DIGITAL TUNER

Autostore

Autostore automatically starts programming radio stations from preset 1. Any previous presets e.g. manually programmed will be erased.

- 1 Select **MW** or **FM**.
- 2 Press **PROG** until **Auto** flashes.

→ Available stations are programmed (MW or FM). After all stations are stored, the first autostore preset station will then automatically play.

To listen to a preset or autostore station

Press the **ALBUM/PRESET - , +** (on the remote control **▲, ▼**) buttons once or more until the desired preset station is displayed.

Changing tuning grid (some versions only)

In North and South America the frequency step between adjacent channels in the MW (AM) and FM band are **10 KHz** and **100 KHz** respectively. In the rest of the world this step is **9 KHz** and **50 KHz**. Usually the frequency step has been preset in the factory for your area.

1. Select **MW** source.
2. Press **MODE** on the set for at least 5 seconds.
→ The display shows either **5-9** or **5-10**.

Helpful hints: All preset stations will be affected and you may need to reprogramme stations.

CD PLAYER

About MP3

The music compression technology MP3 (MPEG1 Audio Layer 3) significantly reduce the digital data of an audio CD while maintaining CD quality sound.

- **Getting MP3 files:** you can either download legal music files from the internet to your computer hard disc, or create such files by converting audio CD files in your computer through appropriate encoder software. (128kbps bit rate or higher is recommended for MP3 files.)
- **Creating a MP3 CD:** burn the music files from your computer hard disc on a CDR or CDRW using your CD burner.

CD/MP3 PLAYER

Helpful hints:

- Make sure that the file names of the MP3 files end with **.mp3**.
- Total number of music files and albums: around 350 (with a typical file name length of 20 characters)
- The length of file names affects the number of tracks for playback. With shorter file names, more files can be burned on a disc.

Playing a CD

This player plays Audio Discs including CD-R/ CD-RW, and MP3 CD. Do not try to play a CD-ROM, CD-I, CDV, VCD, DVD or computer CD.

IMPORTANT!

- CDs encoded with **copyright protection technologies** by some record companies may be unplayable by this product.
- **For a disc with CD Audio tracks and MP3 files, the MP3 files may be unplayable, depending on the encoding software.**
- **Total number of albums + tracks: Max. 500** (for MP3)

- 1 Push the **source selector** to **CD/MP3**.

- 2 Insert a CD with the printed side facing up and close the CD door.

→ **READY** is displayed as the CD player scans the contents of a disc and then

Audio CD: total playing time and total number of tracks appear.

MP3: total number of tracks/albums appear. (See **[3]**)

- 3 Press **▶II** to start playback.

- 4 To pause playback press **▶II**. Press **▶II** again to resume play.

- 5 To stop CD playback, press **■**.

Helpful hints: CD play will also stop when:

- the CD door is opened
- the CD has reached the end
- you select tuner or tape source.

CD/MP3 PLAYER

Selecting a different track

- Press **◀◀** or **▶▶** (on the remote control **◀** or **▶**) once or repeatedly until the desired track number appears in the display.

For MP3-CD: first press **ALBUM/PRESET - , +** (on the remote control **▲, ▼**) once or more to find your album.

- In the pause/stop position, press **▶II** to start playback.

Finding a passage within a track

- 1 During playback, press and hold **◀◀** or **▶▶** (or **SEARCH ◀◀, ▶▶** on the remote control).

→ The CD is played at high speed and low volume.

- 2 When you recognize the passage you want, release **◀◀** or **▶▶** to resume normal playback.

Different play modes: SHUFFLE and REPEAT

(See **[4]**, **[5]**)

You can select and change the various play modes before or during playback, and combine **REP ALL** and **REP** with **PROG**.

SHUF – tracks of the entire CD are played in random order

REP ALL – repeats the entire CD/program

REP – plays the current track continuously

For MP3 only:

REP ALB – all tracks of current album play repeatedly.

- 1 To select play mode, press **MODE (SHUFFLE or REPEAT)** on the remote control) once or more.

- 2 Press **▶II** to start playback if in the stop position.

- 3 To select normal playback, press **MODE** repeatedly until the various modes are no longer displayed.
– You can also press **■** to cancel your play mode.

Helpful hints: In shuffle mode, press **◀◀** (**◀** on the remote control) to go to the beginning of current track

Programming track numbers

You may store up to 20 tracks (for MP3-CD: 10 tracks) in the desired sequence. If you like, store any track more than once.

- 1 In the stop position, press **◀◀** or **▶▶** (on the remote control **◀** or **▶**) to select your desired track number.

For MP3-CD: first press **ALBUM/PRESET - , +** (on the remote control **▲, ▼**) once or more to find your album.

- 2 Press **PROG**.

→ Display first shows the number of program location and then, track/album number stored here. (See **[6]**, **[7]**)

- If you attempt to program without first selecting a track number, **NOSE** is shown.

- 3 Repeat steps 1-2 to select and store all desired tracks.

- Display: **FULL** if you try to program more than 20 tracks (for MP3-CD: 10 tracks).

Helpful hints:

– When the **PROG** or **SHUF** mode is active, use of the **- , +** keys (or **▲, ▼** on the remote control) are void.

Reviewing the programme

In the stop position, press **PROG** repeatedly to see your stored track numbers.

→ Display first shows the number of program location and then, track/album number stored here.

Erasing a programme

You can erase the contents of the memory by:

- opening the CD door;
- selecting **MW, FM** or **TAPE** sound sources;
- pressing **■** twice during playback or once in the stop position.

→ **PROG** disappears.

CASSETTE RECORDER

CASSETTE RECORDER

Cassette playback

- 1 Push the **source selector** to **TAPE**.
- 2 Insert a cassette and close the door.
- 3 Press **PLAY** ◀ to start playback.
Display: shows **TAPE** throughout tape operation.
- 4 To pause, press **PAUSE II**. Press again to resume.
- 5 To stop the tape, press **STOP/OPEN** ■▲.

Fast forwarding/rewinding

- 1 Press **SEARCH** ◀◀ or ▶▶ until you reach your desired passage.
- 2 Press ■▲ to stop fast forwarding/rewinding.

Helpful hints:

- During playback, the keys are automatically release at the end of a tape, and the set is switched off (except if **II** has been activated).
- During fast winding/rewinding, the keys will not be released at the end of a tape. To switch off the set, make sure the cassette keys are also released.

GENERAL INFORMATION ON RECORDING

- Recording is permissible insofar as copyright or other rights of third parties are not infringed.
- For recording, use only **NORMAL** type cassettes (IEC type **I**) on which the tabs have not yet been broken. This deck is not suited for recording on **CHROME** (IEC **II**) or **METAL** (IEC **IV**) type cassettes.
- The best recording level is set automatically. Altering the **VOL** or **DBB** controls will not affect the recording.
- To protect a tape from accidental erasure, break out the tabs. If you wish to record again, cover the tabs with a piece of adhesive tape.

CD Synchro Start recording

- 1 Select **CD/MP3** function.
- 2 Insert a CD and if desired, programme track numbers.
- 3 Open the cassette door.
- 4 Insert a suitable tape into the cassette deck and close the door.
- 5 Press **RECORD** ● to start recording.
→ Playing of the CD/program starts automatically from the beginning. You don't need to start the CD player separately.
→ Display: shows **REC** briefly.
- 6 To pause recording, press **PAUSE II**. Press **PAUSE II** again to resume recording.
- 7 To stop recording, press **STOP/OPEN** ■▲.

Recording from the Radio

- 1 Tune to the desired radio station (see Tuning to radio stations).
- 2 Follow steps 3-7, under CD Synchro Start recording.

MAINTENANCE & SAFETY

Maintenance & Safety (See [8], [9])

CD player and CD handling

- If the CD player cannot read CDs correctly, use a cleaning CD to clean the lens before taking the set to repair.
- The lens of the CD player should never be touched!
- Sudden changes in the surrounding temperature can cause condensation on the lens of your CD player. Playing a CD is then not possible. Do not attempt to clean the lens but leave the set in a warm environment until the moisture evaporates.
- Always close the CD door to avoid dust on the lens.
- To clean the CD, wipe in a straight line from the centre towards the edge using a soft, lint-free cloth. Do not use cleaning agents as they may damage the disc.
- Never write on a CD or attach any stickers to it.

Safety Information

- Place the set on a hard, flat and stable surface so that the system does not tilt.
- Do not expose the set, batteries, CDs to humidity, rain, sand or excessive heat caused by heating equipment or direct sunlight.
- The apparatus shall not be exposed to dripping or splashing.
- Adequate ventilation with a minimum gap of 15 cm between the ventilation holes and surrounding surfaces is necessary to prevent heat build-up.
- The ventilation should not be impeded by covering the ventilation openings with items, such as newspapers, table-cloths, curtains, etc..
- No objects filled with liquids, such as vases, shall be placed on the apparatus.

- No naked flame sources, such as lighted candles, should be placed on the apparatus.
- The mechanical parts of the set contain self-lubricating bearings and must not be oiled or lubricated.
- To clean the set, use a dry cloth. Do not use any cleaning agents containing alcohol, ammonia, benzene or abrasives as these may harm the housing.

Tape deck maintenance

- To ensure quality recording and playback of the tape deck, clean parts (A), (B) and (C) as shown, once a month. Use a cotton bud slightly moistened with alcohol or a special head cleaning fluid to clean the deck.
- 1 Open the cassette door.
 - 2 Press **PLAY** ◀ and clean the roller (C).
 - 3 Press **PAUSE II** and clean the heads (A), and the capstan (B).
 - 4 After cleaning, press **STOP/OPEN** ■▲.

Environmental information

We have done our best to reduce the packaging and make it easy to separate into 3 materials: cardboard, expandable polystyrene, polyethylene. Your set consists of materials which can be recycled if disassembled by a specialized company. Please observe the local regulations regarding the disposal of packaging, exhausted batteries and old equipment.

TROUBLESHOOTING

WARNING

Do not open the set as there is a risk of electric shock! Under no circumstances should you try to repair the set yourself, as this will invalidate the guarantee.

If a fault occurs, first check the points listed below before taking the set for repair.

If you are unable to remedy a problem by following these hints, consult your dealer or service centre.

Remote control does not function properly

- Batteries exhausted/ incorrectly inserted
- Insert (fresh) batteries correctly
- Distance/ angle between the set too large
- Reduce the distance/ angle

No sound /power

- Volume not adjusted
- Adjust the VOLUME
- Power cord not securely connected
- Connect the AC power cord properly
- Batteries dead/ incorrectly inserted
- Insert (fresh) batteries correctly

Severe radio hum or noise

- Electrical interference: set too close to TV, VCR or computer
- Increase the distance

Poor radio reception

- Weak radio signal
- FM: Adjust the FM telescopic aerial

noCd indication

- CD badly scratched or dirty
- Replace/ clean CD, see Maintenance
- Laser lens steamed up
- Wait until lens has cleared
- CD-R/CD-RW is blank/ not finalized
- Use a finalized CD-R(W)
- CD-ROM disc inserted/
CD contains non-audio files
- Use CD Audio discs/MP3-CD only/
press ◀ or ▶ once or more to skip to a CD audio track instead of the data files

Note:

Make sure the CD is not encoded with Copyright protection technologies, as some do not conform to the Compact Disc standard.

The disc skips tracks

- Disc damaged or dirty
- Replace or clean disc
- SHUF or PROG is active
- Switch off SHUF/PROG

Note:

For a disc with CD Audio tracks and MP3 files, the MP3 files may be unplayable, depending on the encoding software.

Sound skips during MP3 playback

- MP3 file made at compression level exceeding 320kbps
- Use a lower compression level to record CD tracks into MP3 format
- Disc damaged or dirty
- Replace or clean disc

Poor cassette sound quality

- Dust and dirt on the heads, etc.
- Clean deck parts, see Maintenance
- Use of incompatible cassette types (METAL or CHROME)
- Only use NORMAL (IEC I) for recording

Recording does not work

- Cassette tab(s) may be broken
- Apply adhesive tape over the missing tab space