



Philips Norelco Shaver  
4200  
Wet & dry electric shaver,  
Series 4000 with Aquatec  
wet and dry and Pop-up  
trimmer  
**DualPrecision heads**  
Flexing heads  
50 min shaving, 1 hour charge  
AquaTec Wet & Dry

AT811



## Series 4000 - Protects skin

Shave wet or dry

Designed for wet or dry use, the Philips Norelco Shaver 4200 (formerly called PowerTouch) provides a comfortable shave while protecting your skin. The cordless shaver features blades that lift hairs to cut comfortably below skin level.

### Close shaving performance

- Patented Super Lift & Cut blade raise hairs to cut closer
- Effectively shave long hairs & short stubble

### Comfort Contour Following

- Flexing heads follow the curve of your face

### Easy to use

- Anti-slip grip provides complete control
- Up to 50 shaving minutes, 1 hour charge
- For easy cleaning, and wet & dry use
- Perfect for trimming your sideburns and moustache

### Skin friendly

- Aquatec: refreshing wet shave with foam or an easy dry shave
- Glides smoothly over the curves of your face
- Low- friction SkinGlide for an extra smooth shave

**PHILIPS**  
**NORELCO**

# Highlights

## (Patented) Super Lift & Cut



The first blade raises each hair while the second blade comfortably cuts it below skin level, for a really smooth result.

## Anti-slip grip

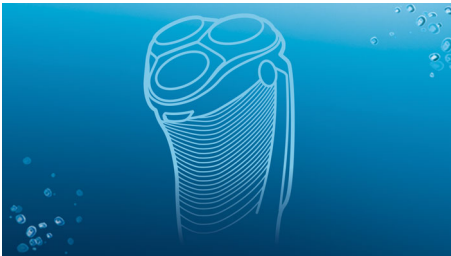

The grip's unique, ergonomic design and anti-slip materials make it easy to shave with precision and comfort.

## Aquatec wet and dry



The AquaTec seal on the Philips electric shaver makes it 100% waterproof. Use it in the shower with your favorite shaving gel or foam for extra skin comfort. Naturally you can also shave dry for convenience.

## Cordless use only



An efficient, powerful lithium-ion battery gives you more shaves per charge. Charge it for an hour and you'll have up to 50 minutes of shaving time – that's around 17 shaves. Charge it for 3 minutes and you'll have enough power for one shave.

## DualPrecision heads

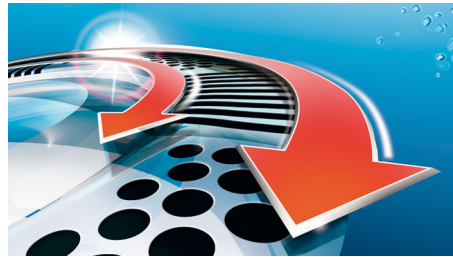

DualPrecision heads comfortably shave both long hairs and short stubble. 1. Slots cut long hairs. 2. Holes cut stubble.

## Flexing heads



The flexing heads of your Philips shaver keep the shaving surface in close contact with your skin for a fast and efficient shave.

## Skin protection system

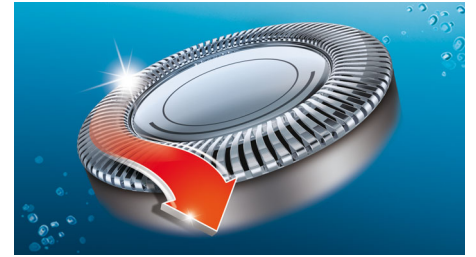

Rounded low-friction heads adjust to the contours of your face to limit skin irritation.

## SkinGlide system

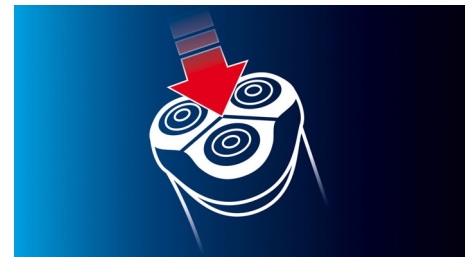

The low-friction SkinGlide shaving surface slides smoothly along your skin for a close, easy shave.

## Water-resistant

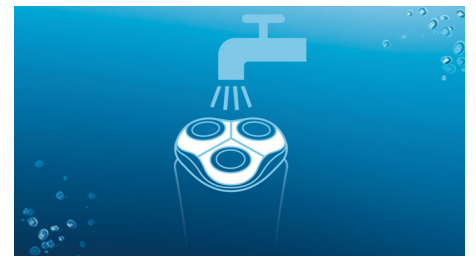

For easy cleaning, and wet & dry use

## Pop-up trimmer

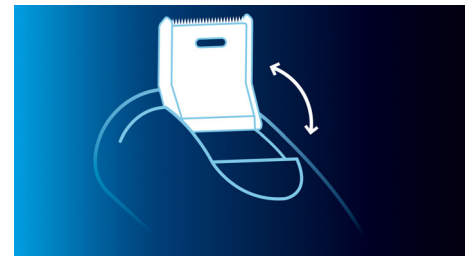

Complete your look by using the Pop-up trimmer. Perfect for maintaining a moustache and trimming sideburns.

# Specifications

## Accessories

- Maintenance: Cleaning brush, Protective cap
- Pouch: Travel pouch

## Ease of use

- Shaving minutes: 50+
- Shaving time: Up to 17 days
- Display: 1 LED indication, Battery full indication, Battery low indication, Charging indication, Quick charge indication

## Service

- Replacement head: HQ8 has been replaced by SH50, Replace every yr with HQ8

## Shaving Performance

- Contour-following: Dynamic contour response
- Shaving system: Super Lift&Cut, DualPrecision heads
- Styling: Integrated pop up trimmer



Issue date 2017-08-10

Version: 3.0.1

12 NC: 8670 001 11924  
UPC: 0 75020 03618 6

© 2017 Koninklijke Philips N.V.  
All Rights reserved.

Specifications are subject to change without notice.  
Trademarks are the property of Koninklijke Philips N.V.  
or their respective owners.

[www.philips.com](http://www.philips.com)