

Always there to help you
Register your product and get support at
www.philips.com/support



AJ3232



Quick start guide

PHILIPS



Specifications are subject to change without notice.
This product has been manufactured by, and is sold under the responsibility of Gibson Innovations Ltd., and Gibson Innovations Ltd. is the warrantor in relation to this product. Philips and the Philips Shield Emblem are registered trademarks of Koninklijke Philips N.V. and are used under license.

AJ3232_79_QSG_V2.0



1 Important

Safety

Know these safety symbols



This 'bolt of lightning' indicates uninsulated material within your unit may cause an electrical shock. For the safety of everyone in your household, please do not remove product covering. The 'exclamation point' calls attention to features for which you should read the enclosed literature closely to prevent operating and maintenance problems.

WARNING: To reduce the risk of fire or electric shock, this apparatus should not be exposed to rain or moisture and objects filled with liquids, such as vases, should not be placed on this apparatus.
CAUTION: To prevent electric shock, match wide blade of plug to wide slot, fully insert.

Warning

- Never remove the casing of this radio.
- Never lubricate any part of this radio.
- Never place this radio on other electrical equipment.
- Keep this radio away from direct sunlight, naked flames or heat.
- Make sure that you always have easy access to the power cord, plug or adapter to disconnect the radio from the power.

- Read these instructions.
- Follow all instructions.
- Do not use this product near water.
- Clean only with dry cloth.
- Do not block any ventilation openings. Install in accordance with the manufacturer's instructions.
- Only use attachments or accessories specified by the manufacturer.
- Unplug this product during lightning storms or when unused for long periods of time.
- Refer all servicing to qualified service personnel. Servicing is required when the product has been damaged in any way, such as liquid has been spilled or objects have fallen into the product, the product has been exposed to rain or moisture, does not operate normally, or has been dropped.
- Battery usage **CAUTION** – To prevent battery leakage which may result in bodily injury, property damage, or damage to the product:
 - Install all batteries correctly, + and - as marked on the product.
 - Do not mix batteries (old and new or carbon and alkaline, etc.).
 - Remove batteries when the product is not used for a long time.
- Batteries shall not be exposed to excessive heat such as sunshine, fire or the like.

- The product shall not be exposed to dripping or splashing.
- Do not place any sources of danger on the product (e.g. liquid filled objects, lighted candles).
- Where the MAINS plug or an appliance coupler is used as the disconnect device, the disconnect device shall remain readily operable.

Note

- The type plate is located on the bottom of the product.

2 Notice

Any changes or modifications made to this device that are not expressly approved by Gibson Innovations may void the user's authority to operate the equipment.

Disposal of your old product



Your product is designed and manufactured with high quality materials and components, which can be recycled and reused.



This symbol on a product means that the product is covered by European Directive 2012/19/EU. Inform yourself about the local separate collection system for electrical and electronic products. Follow local rules and never dispose of the product with normal household waste. Correct disposal of old products helps prevent negative consequences for the environment and human health.

Environmental information

All unnecessary packaging has been omitted. We have tried to make the packaging easy to separate into three materials: cardboard (box), polystyrene foam (buffer) and polyethylene (bags, protective foam sheet).

Your system consists of materials which can be recycled and reused if disassembled by a specialized company. Please observe the local regulations regarding the disposal of packaging materials, exhausted batteries and old equipment.

PHILIPS

Warranty against Defects

In this warranty:

We or us means Gibson Innovations ABN 531 651 059 75, and our contact details are set out at the end of this warranty;

You means the purchaser or the original end-user of the Goods;

Supplier means the authorised distributor or retailer of the Goods that sold you the Goods in Australia or New Zealand; and

Goods means the product or equipment which was accompanied by this warranty and purchased in Australia or New Zealand.

If you require assistance with the operation of the product, its features or specifications please call the Philips Consumer Care Centre on 1300 850 633 in Australia or 0800 639 953 in New Zealand.

Australia: Our Goods come with guarantees that cannot be excluded under the Australian Consumer Law. You are entitled to a replacement or refund for a major failure and for compensation for any other reasonably foreseeable loss or damage. You are also entitled to have the Goods repaired or replaced if the goods fail to be of acceptable quality and the failure does not amount to a major failure. This is not a complete statement of your legal rights as a consumer.

New Zealand: Our Goods come with guarantees that cannot be excluded under the Consumer Guarantees Act 1993. This guarantee applies in addition to the conditions and guarantees implied by that legislation.

Additional Warranty:

In addition to the rights and remedies that you have under the Australian Consumer Law, Consumer Guarantees Act of New Zealand or any other applicable law, we provide the following warranty against defects:

1. If, during the first **12 months** from their date of purchase from the Supplier (**Warranty Period**), the Goods prove defective by reason of improper workmanship or materials and none of your statutory rights or remedies apply, we will repair or replace the Goods without charge.
2. We do not have to repair or replace the Goods under this Additional Warranty if the Goods have been used for a commercial purpose; misused, improperly or inappropriately installed, operated or repaired; abused; damaged; or not maintained in accordance with the manufacturer's instructions.
3. Even when we do not have to repair or replace the Goods, we may decide to do so anyway. In some cases, we may decide to substitute the Goods with a similar alternative product of our choosing. All such decisions are at our absolute discretion.
4. All such repaired, replaced or substituted Goods continue to receive the benefit of this Additional Warranty for the time remaining on the original Warranty Period.
5. This Additional Warranty is limited to repair, replacement or substitution only. As far as the law permits, we will not be liable for any loss or damage caused to property or persons arising from any cause whatsoever.
6. In order to claim under this Additional Warranty you must telephone us on 1300 850 633 in Australia or 0800 639 953 in New Zealand within the Warranty Period. You will be asked for details of the Goods, a description of the defect and your personal details. Upon accepting your claim, we shall assist you with either returning the Goods to the Supplier for replacement or to the most convenient Philips Authorised Service Centre for your Goods to be repaired. In some case we may require that you return to the Goods to us (at the address below) for repair, replacement or substitution.
 - * All returned Goods must be accompanied by satisfactory proof of purchase which clearly indicates the name and address of the Supplier, the date and place of purchase and identifies product. It is best to provide a legible and unmodified receipt or sales invoice.
 - * You must bear any expense for return of the Goods or otherwise associated with making your claim under this Additional Warranty.
7. This warranty is only valid and enforceable in Australia and New Zealand.

Contact us or the place of purchase for further details.

Australia
Gibson Innovations
305/4 Columbia Court,
Baulkham Hills, NSW, 2153

New Zealand

Consumer Care: 1300 850 633
E-mail: PhilipsSound_APAC@gibson.com
Website: www.philips.com/support

Consumer Care: 0800 639 953
Email: PhilipsSound_APAC@gibson.com
Website: www.philips.com/support

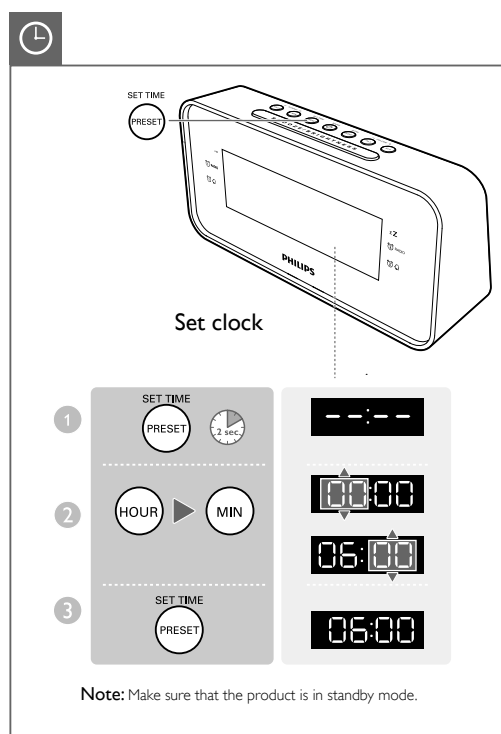
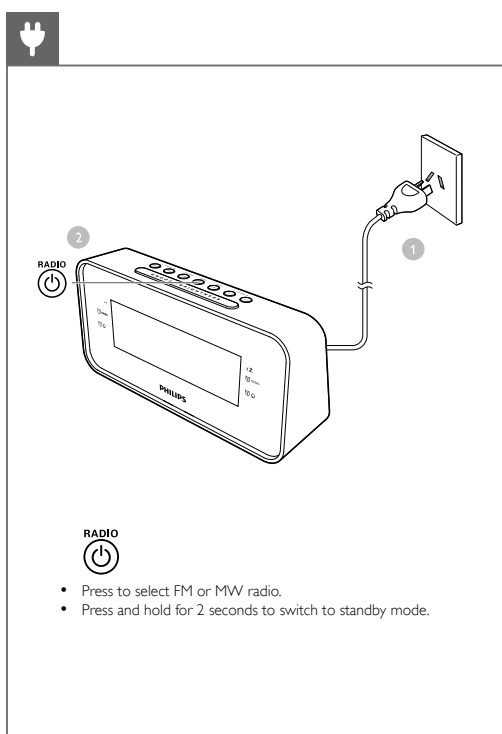
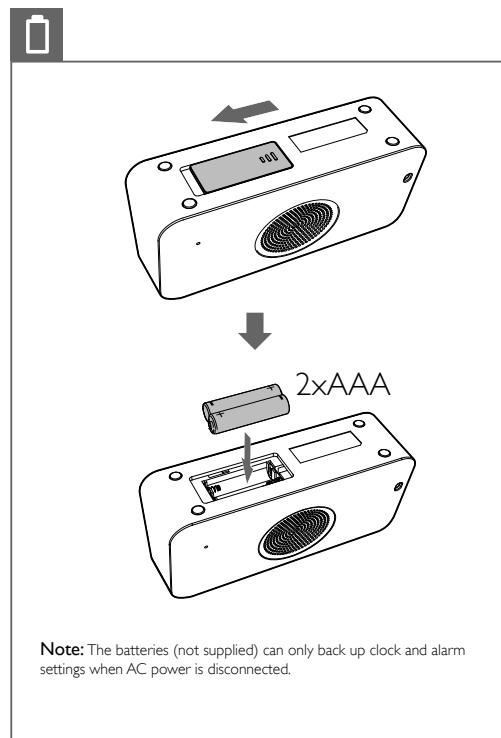
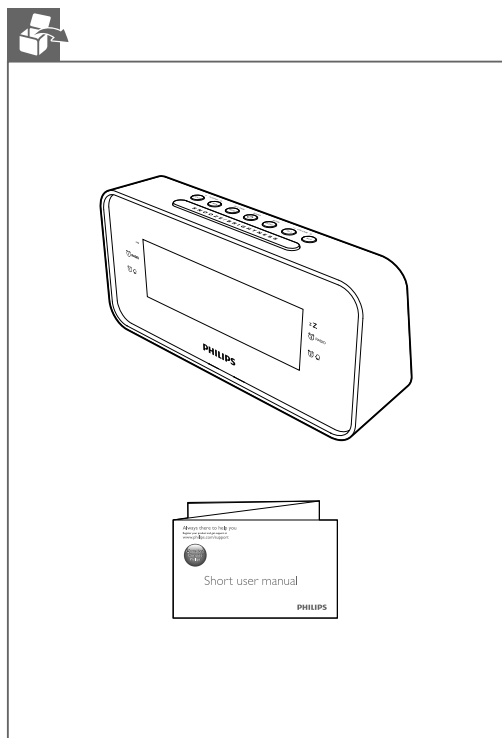

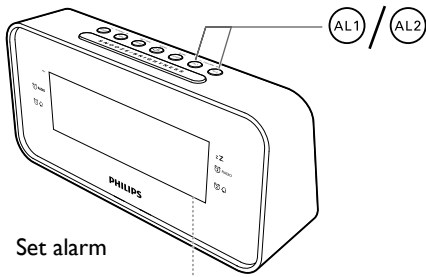

Set alarm

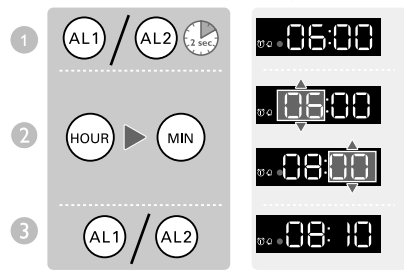

Note:

- You can only set the alarm in standby mode.
- Make sure that you have set the clock correctly.

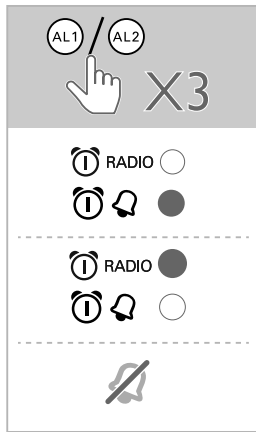

Press **AL1** or **AL2** repeatedly to activate or deactivate the alarm timer.

- If the alarm timer is activated, the alarm indicator for the radio or buzzer is displayed.
- If the alarm timer is deactivated, the alarm indicator disappears.
- To stop the alarm, press the corresponding **AL1** or **AL2**.
- The alarm repeats ringing for the next day.

Note: When the alarm sounds, volume increases gradually to the maximum alarm volume. You cannot adjust the alarm volume manually.

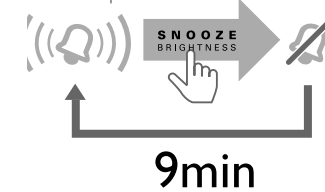
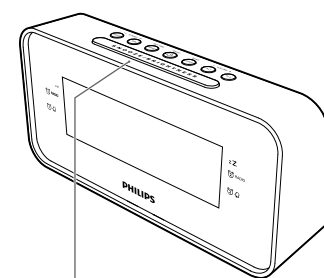

When the alarm sounds, press **SNOOZE**.
The alarm snoozes and repeats ringing nine minutes later.



Prepare radio antenna

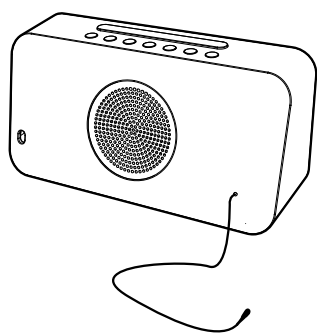

Tip: For better reception, fully extend and adjust the position of the antenna.

Select FM/MW radio

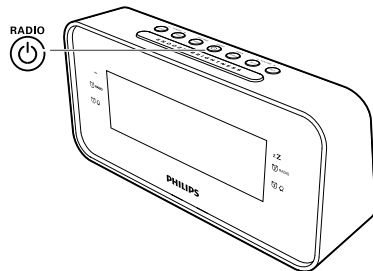

Tune to FM/MW radio stations

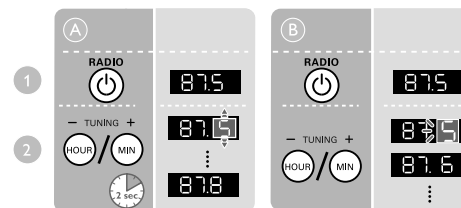

Store FM/MW radio stations automatically

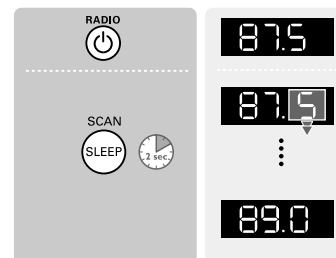

Store FM/MW radio stations manually

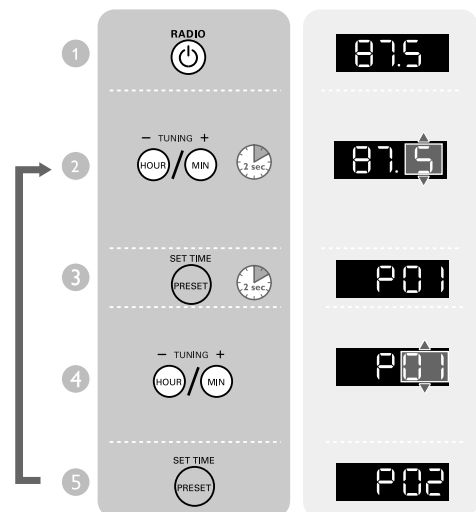

- Select FM or MW radio.
 - Tune to a radio station.
 - Press and hold **PRESET** for two seconds.
The preset number begins to blink.
 - Press **- TUNING +** to select a number.
 - Press **PRESET** again to confirm.
 - Repeat steps 2 to 5 to store other stations.
- Note:**
- You can store a maximum of 20 FM radio stations and 20 MW radio stations.
 - To overwrite a pre-stored radio station, store another one with its sequence number.

Select a preset radio station

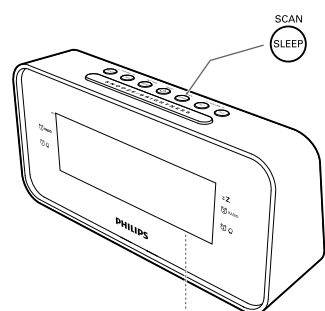
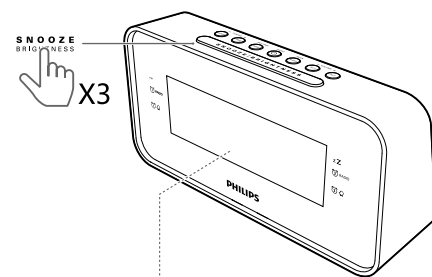
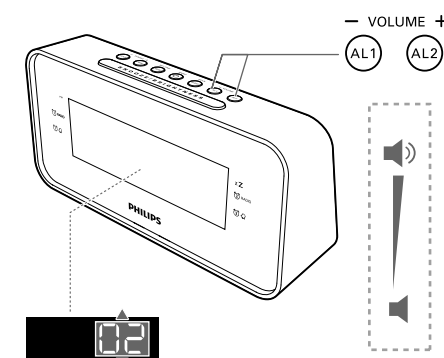

Press **SLEEP** repeatedly to select a time period (in minutes).
The product switches to standby mode automatically after the preset period.
When **[OFF]** is displayed, the sleep timer is deactivated.

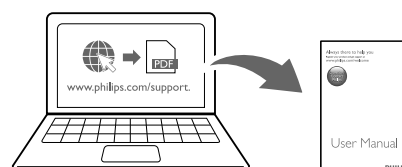
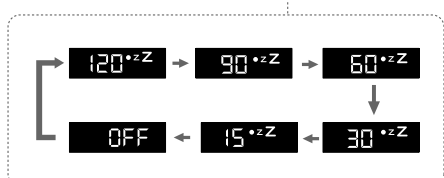

To download the full user manual, visit www.philips.com/support



Specifications

Amplifier	
Rated Output Power	0.4 W RMS
Tuner	
Tuning Range	FM: 87.5-108 MHz; MW: 531-1602 KHz
Tuning Grid	FM: 50 KHz; MW: 9 KHz
Number of presets	FM: 20; MW: 20
General information	
AC power	220-240V~ 50/60Hz
Operation Power	8 W
Consumption	
Standby Power Consumption	<1 W
Dimensions:	
- Main Unit (W x H x D)	190 x 94 x 62 mm
Weight: - Main Unit	0.55 kg