

Always there to help you

Register your product and get support at
www.philips.com/support

AJ2000



User manual

PHILIPS

Contents

1 Important	2
Safety	2

2 Your clock radio	3
Introduction	3
What's in the box	3
Overview of the clock radio	4

3 Get started	5
Install battery	5
Connect power	5
Set clock	6
Turn on	6

4 Listen to FM radio	7
Prepare FM antenna	7
Tune to FM radio stations	7
Store FM radio stations automatically	7
Store FM radio stations manually	7
Select a preset FM radio station	7
Adjust volume	8

5 Set alarm timer	9
Set alarm	9
Activate/deactivate alarm timer	9
Snooze the alarm	9

6 Other features	10
Set sleep timer	10
Adjust display brightness	10

7 Product information	11
Specifications	11

8 Troubleshooting	12
--------------------------	----

9 Notice	13
Care of the environment	13

1 Important

Safety



Warning

- Never remove the casing of this clock radio.
 - Never lubricate any part of this clock radio.
 - Never place this clock radio on other electrical equipment.
 - Keep this clock radio away from direct sunlight, naked flames or heat.
 - Make sure that you always have easy access to the power cord, plug or adaptor to disconnect the clock radio from the power.
-
- Read and follow these instructions.
 - Make sure that there is enough free space around the clock radio for ventilation.
 - Only use attachments/accessories specified by the manufacturer.
 - Use only power supplies listed in the user manual.
 - Unplug this clock radio during lightning storms or when unused for long periods of time.
 - Battery usage CAUTION – To prevent battery leakage which may result in bodily injury, property damage, or damage to the clock radio:
 - Install the battery correctly, + and - as marked on the clock radio.
 - Remove the battery when the clock radio is not used for a long time.
 - The battery shall not be exposed to excessive heat such as sunshine, fire or the like.
 - The clock radio shall not be exposed to dripping or splashing.
 - Do not place any sources of danger on the clock radio (e.g. liquid filled objects, lighted candles).
 - Where the plug of the Direct Plug-in Adapter is used as the disconnect device, the disconnect device shall remain readily operable.

Risk of swallowing batteries!

- The device may contain a coin/button type battery, which can potentially be swallowed. Keep the battery out of reach of children at all times! If swallowed, the battery can cause serious injury or death. Severe internal burns can occur within two hours of ingestion.
- If you suspect that a battery has been swallowed or placed inside any part of the body, seek immediate medical attention.
- When you change the batteries, always keep all new and used batteries out of reach of children. Make sure that the battery compartment is completely secure after you replace the battery.
- If the battery compartment cannot be completely secured, discontinue use of the product. Keep out of reach of children and contact the manufacturer.



Note

- The type plate is located on the bottom of the apparatus.

2 Your clock radio

Congratulations on your purchase, and welcome to Philips! To fully benefit from the support that Philips offers, register your product at www.philips.com/welcome.

Introduction

With this clock radio, you can:

- listen to FM radio;
- view time; and
- set two alarms.

What's in the box

Check and identify the contents of your package:



- Clock radio
- Quick start guide

Overview of the clock radio

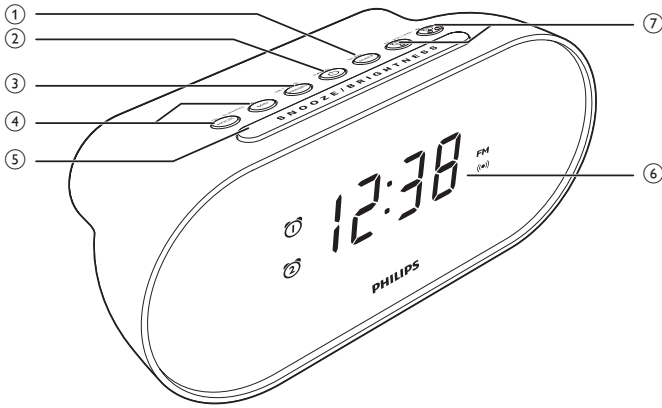

① SCAN/SLEEP

- Scan and store radio stations automatically.
- Set sleep timer.

② ⏻ / RADIO

- Turn the radio on or off.

③ SET TIME/PRESET

- Set time.
- Store FM radio stations manually.
- Select a preset radio station.

④ HOUR/MIN/- TUNING +

- Adjust hour and minute.
- Adjust 12/24 hour format.
- Tune to FM radio stations.

⑤ SNOOZE/BRIGHTNESS

- Snooze the alarm.
- Adjust display brightness.

⑥ Display panel

- Show current status.

⑦ ⏰ / @ / - VOLUME +

- Set alarm.
- Activate or deactivate alarm timer.
- Adjust volume.

3 Get started

Always follow the instructions in this chapter in sequence.

Install battery

! Caution

- Risk of explosion! Keep the battery away from heat, sunshine or fire. Never discard battery in fire.
- Danger of explosion if battery is incorrectly replaced. Replace only with the same or equivalent type.
- The battery contains chemical substances, so it should be disposed of properly.

☰ Note

- You can only use AC power as power supply. The lithium CR2032 battery can only back up clock and alarm settings.
- When power is disconnected, the display backlight is off.

For first-time use:

Remove the protective tab to activate the battery.

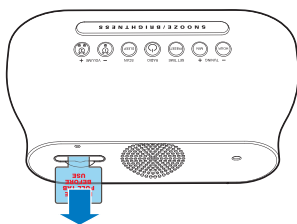

To replace the battery:

- 1 Push the clip to the left and pull out the battery tray.

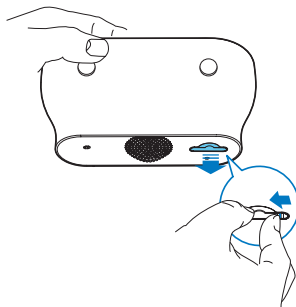

- 2 Insert 1 x CR2032 battery as illustrated.



Connect power

! Caution

- Risk of product damage! Make sure that the power voltage corresponds to the voltage printed on the back or underside of the clock radio.
- Risk of electric shock! When you unplug the AC plug, always pull the plug from the socket. Never pull the cord.

Connect the power adaptor to the wall outlet.

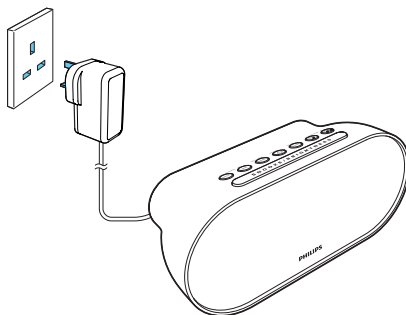

Set clock

- 1** In standby mode, press and hold **SET TIME** for two seconds to activate clock setting mode.
↳ [24H] begins to blink.
- 2** Press **HOUR** or **MIN** to set 12/24 hour format.
- 3** Press **SET TIME** to confirm.
- 4** Press **HOUR** and **MIN** repeatedly to set hour and minute respectively.
- 5** Press **SET TIME** to confirm.
↳ The set time is displayed.

Turn on

Press ϕ to turn on the radio.

- ↳ The product switches to FM tuner mode.

Switch to standby mode

Press ϕ again to switch to standby mode.

- ↳ The clock (if set) is displayed.

4 Listen to FM radio

Prepare FM antenna

- 1 Fully extend and adjust the position of the pig-tail antenna until you find the best reception.
- 2 Fix the antenna as illustrated.

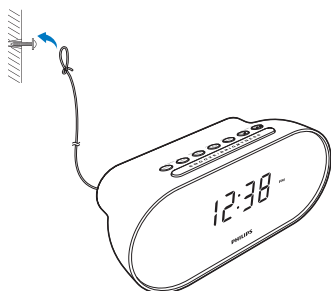

Note

- To prevent interference, position the antenna as far as possible from any other electrical appliances.

Tune to FM radio stations

- 1 Press **RADIO** to turn on FM radio.
- 2 Press and hold **-TUNING +** for two seconds.
 - ↳ The clock radio tunes to a station with strong reception automatically.
- 3 Repeat step 2 to tune to more radio stations.

To tune to a station manually:

In tuner mode, press **-TUNING +** repeatedly to select a frequency.

Store FM radio stations automatically

Note

- You can store a maximum of 20 FM radio stations.

In FM tuner mode, press and hold **SCAN** for two seconds.

- ↳ The clock radio stores all the available FM radio stations automatically.
- ↳ The first available station broadcasts automatically.

Store FM radio stations manually

Note

- You can store a maximum of 20 FM radio stations.

- 1 In FM tuner mode, tune to an FM radio station.
- 2 Press and hold **PRESET** for two seconds.
 - ↳ The preset number begins to blink.
- 3 Press **HOUR** or **MIN** to select a number.
- 4 Press **PRESET** to confirm.
- 5 Repeat steps 1 to 4 to store other stations.

Note

- To remove a pre-stored station, store another station in its place.

Select a preset FM radio station

In FM tuner mode, press **PRESET** repeatedly to select a preset radio station.

Adjust volume

While listening to FM radio, press **-VOLUME +** repeatedly to increase or decrease volume.

5 Set alarm timer

Snooze the alarm

When the alarm goes off, press **SNOOZE**.

↳ The alarm snoozes and repeats ringing nine minutes later.

Set alarm

You can set two alarms to ring at different time.

Note

- Make sure that you have set the clock correctly.

- 1 In standby mode, press and hold **⏰** or **⌚** for two seconds to activate alarm setting mode.
↳ The hour and minute digits and the alarm icon (**⏰** or **⌚**) begin to blink.
- 2 Press **HOUR** and **MIN** repeatedly to set hour and minute.
- 3 Press **⏰** or **⌚** to confirm.
- 4 Press **HOUR** or **MIN** to select alarm source: buzzer or your last listened FM station.
- 5 Press **⏰** or **⌚** again to confirm.

Tip

- The alarm volume is not adjustable, but will go up gradually to gently wake you up.

Activate/deactivate alarm timer

Press **⏰** or **⌚** repeatedly to activate or deactivate the alarm timer:

- ↳ The alarm icon (**⏰** or **⌚**) appears if the alarm timer is on and disappears if it is off.
- To stop the alarm, press the corresponding **⏰** or **⌚**.
- ↳ The alarm repeats itself in subsequent days.

6 Other features

Set sleep timer

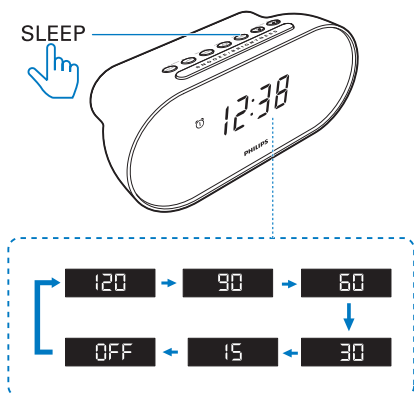

Press **SLEEP** repeatedly to select the sleep timer period (in minutes).

↳ The clock radio switches to standby mode automatically after the preset period.

To deactivate the sleep timer:

In sleep timer setting mode, press **SLEEP** repeatedly until **[OFF]** (off) appears.

Adjust display brightness

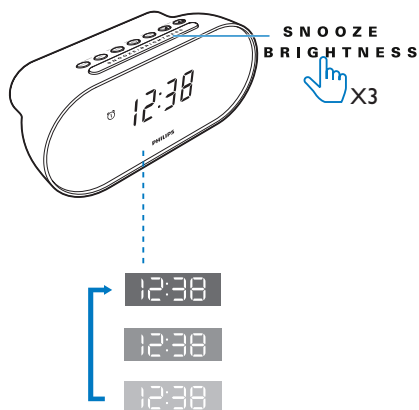

Press **BRIGHTNESS** repeatedly to select different brightness levels:

- High
- Medium
- Low

7 Specifications



Note

- Product information is subject to change without prior notice.

Specifications

Rated Output Power	0.7W RMS @ 10% THD
Acoustic Frequency Response	250 Hz - 13 kHz
Speaker Driver	1 × 1.5", 8 Ω
Tuner Frequency Range	FM: 87.5 - 108 MHz
Preset Station	20
Power Supply (Power Adapter)	Brand name: PHILIPS; Model: GQ05-050050-AB; Input: 100-240V~, 50/60 Hz, 0.3 A Max; Output: DC 5V, 500 mA;
Battery	1 × CR2032 battery for time/alarm backup
Standby Power Consumption	<1 W
Dimensions - Main Unit (W × H × D)	185 × 85 × 81 mm
Weight - Main Unit	0.3 kg

8 Troubleshooting



Warning

- Never remove the casing of this device.

To keep the warranty valid, never try to repair the system yourself.

If you encounter problems when using this device, check the following points before requesting service. If the problem remains unsolved, go to the Philips Web page (www.philips.com/support). When you contact Philips, make sure that the device is nearby and the model number and serial number are available.

No power

- Make sure that the AC power plug of the clock radio is connected properly.
- Make sure that there is power at the AC outlet.

No response from the clock radio

- Disconnect and reconnect the AC power plug, then turn on the clock radio again.

Poor radio reception

- Keep the clock radio away from other electronic devices to avoid radio interference.
- Fully extend and adjust the position of the pig-tail antenna.

Alarm does not work

- Set the clock/alarm correctly.

9 Notice

Any changes or modifications made to this device that are not expressly approved by Gibson Innovations may void the user's authority to operate the equipment.

Hereby, Gibson Innovations declares that this product is in compliance with the essential requirements and other relevant provisions of Directive 2014/53/EU. You can find the Declaration of Conformity on www.philips.com/support.

Care of the environment

Disposal of your old product and battery



Your product is designed and manufactured with high quality materials and components, which can be recycled and reused.



This symbol on a product means that the product is covered by European Directive 2012/19/EU.



This symbol means that the product contains batteries covered by European Directive 2013/56/EU which cannot be disposed of with normal household waste.

Inform yourself about the local separate collection system for electrical and electronic products and batteries. Follow local rules and never dispose of the product and batteries with normal household waste. Correct disposal of old products and batteries helps prevent

negative consequences for the environment and human health.

Removing the disposable batteries

To remove the disposable batteries, see battery installation section.

Environmental information

All unnecessary packaging has been omitted. We have tried to make the packaging easy to separate into three materials: cardboard (box), paper pulp (buffer) and polyethylene (bags, protective foam sheet.)

Your system consists of materials which can be recycled and reused if disassembled by a specialized company. Please observe the local regulations regarding the disposal of packaging materials, exhausted batteries and old equipment.



Copyright © 2016 Gibson Innovations Limited. Revised Edition © 2017
This product has been manufactured by, and is sold under the responsibility
of Gibson Innovations Ltd., and Gibson Innovations Ltd. is the warrantor in
relation to this product.
Philips and the Philips Shield Emblem are registered trademarks of Koninklijke
Philips N.V. and are used under license.

AJ2000_05_UM_V3.0

