

# Always there to help you

Register your product and get support at  
[www.philips.com/welcome](http://www.philips.com/welcome)

AE1500



## User manual

# PHILIPS



# Contents

---

<b>1</b>	<b>Safety</b>	<b>2</b>
	Important Safety Instructions	2
	Hearing safety	2

---

<b>2</b>	<b>Get started</b>	<b>4</b>
	Overview	5
	Install batteries	6
	Power on	6

---

<b>3</b>	<b>Listen through the headphone</b>	<b>6</b>
----------	-------------------------------------	----------

---

<b>4</b>	<b>Listen to radio</b>	<b>7</b>
----------	------------------------	----------

---

<b>5</b>	<b>Product information</b>	<b>7</b>
	Specifications	7

---

<b>6</b>	<b>Troubleshooting</b>	<b>8</b>
----------	------------------------	----------

---

<b>7</b>	<b>Notice</b>	<b>8</b>
	Disposal of your old product	9

# 1 Safety

---

## Important Safety Instructions

- ① Read these instructions.
- ② Keep these instructions.
- ③ Heed all warnings.
- ④ Follow all instructions.
- ⑤ Do not use this apparatus near water.
- ⑥ Clean only with dry cloth.
- ⑦ Do not install near any heat sources such as radiators, heat registers, stoves, or other apparatus (including amplifiers) that produce heat.
- ⑧ Only use attachments/accessories specified by the manufacturer.
- ⑨ Refer all servicing to qualified service personnel. Servicing is required when the apparatus has been damaged in any way, such as liquid has been spilled or objects have fallen into the apparatus, the apparatus has been exposed to rain or moisture, does not operate normally, or has been dropped.
- ⑩ **Battery usage CAUTION – To prevent battery leakage which may result in bodily injury, property damage, or damage to the unit:**
  - Install all batteries correctly, + and - as marked on the unit.
  - Do not mix batteries (old and new or carbon and alkaline, etc.).
  - Remove batteries when the unit is not used for a long time.

- ⑪ Apparatus shall not be exposed to dripping or splashing.
- ⑫ Do not place any sources of danger on the apparatus (e.g. liquid filled objects, lighted candles).
- ⑬ The batteries shall not be exposed to excessive heat such as sunshine, fire or the like.

---

## Hearing safety



### Listen at a moderate volume.

- Using headphones at a high volume can impair your hearing. This product can produce sounds in decibel ranges that may cause hearing loss for a normal person, even for exposure less than a minute. The higher decibel ranges are offered for those that may have already experienced some hearing loss.
- Sound can be deceiving. Over time your hearing 'comfort level' adapts to higher volumes of sound. So after prolonged listening, what sounds 'normal' can actually be loud and harmful to your hearing. To guard against this, set your volume to a safe level before your hearing adapts and leave it there.

### To establish a safe volume level:

- Set your volume control at a low setting.
- Slowly increase the sound until you can hear it comfortably and clearly, without distortion.

### Listen for reasonable periods of time:

- Prolonged exposure to sound, even at normally 'safe' levels, can also cause hearing loss.
- Be sure to use your equipment reasonably and take appropriate breaks.

**Be sure to observe the following guidelines when using your headphones.**

- Listen at reasonable volumes for reasonable periods of time.
- Be careful not to adjust the volume as your hearing adapts.
- Do not turn up the volume so high that you can't hear what's around you.
- You should use caution or temporarily discontinue use in potentially hazardous situations. Do not use headphones while operating a motorized vehicle, cycling, skateboarding, etc.; it may create a traffic hazard and is illegal in many areas.



**Note**

- The type plate is located on the back of the product.

## 2 Get started

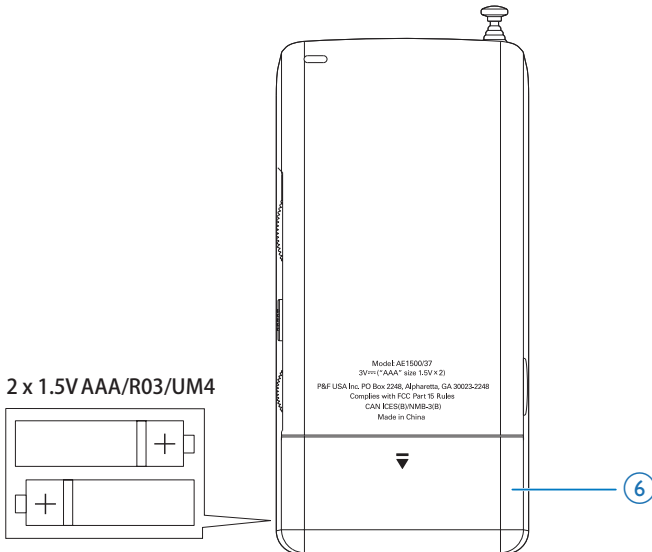
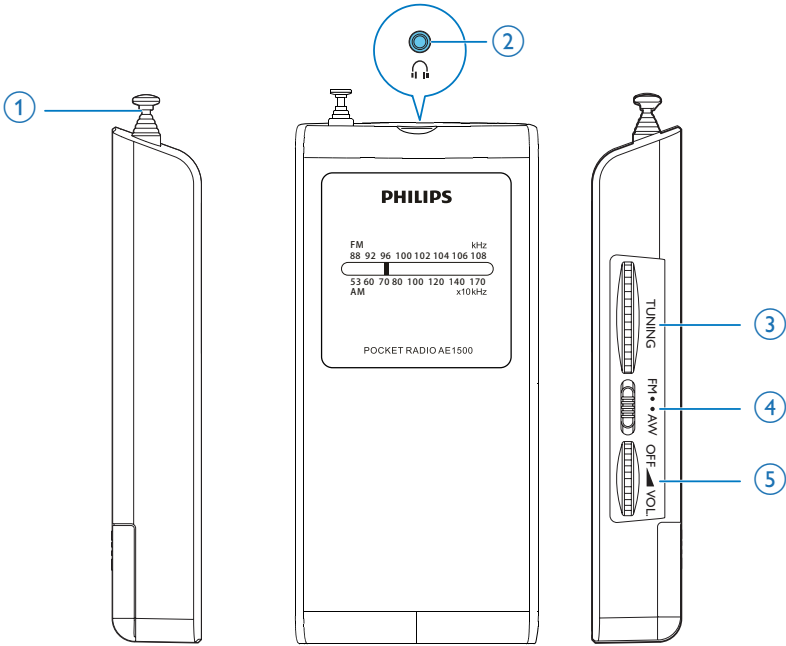

Always follow the instructions in this chapter in sequence.

# Overview



## 3 Listen through the headphone

Plug a headphone into the  socket on the unit.

- ① **Telescopic antenna**
  - Improve FM reception.
- ② 
  - 3.5 mm stereo headphone socket.
- ③ **TUNING**
  - In FM/AM mode, tune to a radio station.
- ④ **Band selector**
  - Select the waveband : FM or AM.
- ⑤ **OFF  VOL**
  - Switch on/off the set.
  - Adjust the sound level.
- ⑥ **Battery compartment**

---

### Install batteries



#### Caution

- Risk of explosion! Keep batteries away from heat, sunshine or fire. Never discard batteries in fire.
- Risk of product damage! When the product is not used for a long period, remove the batteries.
- Batteries contain chemical substances, so they should be disposed of properly.

- 1 Open the battery compartment.
- 2 Insert 2 AAA batteries (not supplied) with correct polarity (+/-) as indicated.
- 3 Close the battery compartment.

---

### Power on

Switch **OFF  VOL** to turn on the speaker.



## 4 Listen to radio

### Note

- For optimal reception, fully extend the antenna and adjust its position.

- 1 Set the band selector to **FM** or **AM**.
  - 2 Turn the **TUNING** wheel to tune to the target radio station.
- To increase or decrease volume, turn the **OFF**  **VOL** wheel.

## 5 Product information

### Note

- Product information is subject to change without prior notice.

## Specifications

Total Output Power	0.2W RMS
Tuning range	FM: 87.5-108 MHz AM: 540-1710 KHz
Sensitivity	FM : 26dB S/N Ratio<22 dBf AM : 26dB S/N Ratio<70 dBf
Total Harmonic Distortion	<2%
Signal to Noise Ratio (FM)	>50 dBA
Power supply	Type AAA; R03 or UM4 batteries x 2 pcs(not included)
Dimensions : Main Unit (W x H x D)	57 x 133 x 20 mm

## 6 Troubleshooting

### Warning

- Never remove the casing of this product.

To keep the warranty valid, never try to repair the product yourself.

If you encounter problems when using this device, check the following points before requesting service. If the problem remains unsolved, go to the Philips Web page ([www.philips.com/support](http://www.philips.com/support)). When you contact the Consumer Care, make sure that the product is nearby and the model number and serial number are available.

#### No power

- The batteries are not installed correctly. Insert the batteries correctly as indicated on the battery compartment.
- The batteries are out of energy. Replace with new ones.

#### No sound

- Adjust volume.
- Disconnect the headphone from the unit.

#### Poor radio reception

- For FM, fully extend the telescopic antenna and adjust its position for better reception.
- For AM, a built-in antenna works. Adjust the position of the unit for better reception.

## 7 Notice

Any changes or modifications made to this device that are not expressly approved by WOOX Innovations may void the user's authority to operate the equipment.

#### Notice for the USA

**This equipment has been tested and found to comply with the limits for a Class B digital device, pursuant to part 15 of the FCC Rules.**

These limits are designed to provide reasonable protection against harmful interference in a residential installation. This equipment generates, uses, and can radiate radio frequency energy and, if not installed and used in accordance with the instruction manual, may cause harmful interference to radio communications.

However, there is no guarantee that interference will not occur in a particular installation. If this equipment does cause harmful interference to radio or television reception, which can be determined by turning the equipment off and on, the user is encouraged to try to correct the interference by one or more of the following measures:

- Relocate the receiving antenna.
- Increase the separation between equipment and receiver.
- Connect the equipment into an outlet on a circuit different from that to which the receiver is connected.
- Consult the dealer or an experienced radio/TV technician for help.

This device complies with Part 15 of the FCC Rules. Operation is subject to the following two conditions:

- This device may not cause harmful interference, and
- This device must accept any interference received, including interference that may cause undesired operation.

---

## Disposal of your old product

Your product is designed and manufactured with high quality materials and components, which can be recycled and reused. Never dispose of your product with other household waste. Please inform yourself about the local rules on the separate collection of electrical and electronic products and batteries. The correct disposal of these products helps prevent potentially negative consequences on the environment and human health. Please visit [www.recycle.philips.com](http://www.recycle.philips.com) for additional information on a recycling center in your area.

### Environmental information

All unnecessary packaging has been omitted. We have tried to make the packaging easy to separate into three materials: cardboard (box), polystyrene foam (buffer) and polyethylene (bags, protective foam sheet.) Your system consists of materials which can be recycled and reused if disassembled by a specialized company. Please observe the local regulations regarding the disposal of packaging materials, exhausted batteries and old equipment.



#### Note

- The type plate is located on the bottom of the apparatus.



Specifications are subject to change without notice.  
2014 © WOOX Innovations Limited. All rights reserved.  
Philips and the Philips' Shield Emblem are registered  
trademarks of Koninklijke Philips N.V. and are used by WOOX  
Innovations Limited under license from Koninklijke Philips N.V.

AE1500\_37\_UM\_V1.0

