

PHILIPS
NORELCO

REFLEXPLUS 6
SHAVING SYSTEM



6618X
6616X
6615X
6614X
6613X

*Rechargeable
Cordless Razor*



6618X/6616X/6615X/6614X/6613X

ENGLISH 4
ESPAÑOL 20

IMPORTANT SAFETY INSTRUCTIONS

When using an electric razor, basic safety precautions should always be followed, including the following:

Read all instructions before using this appliance.

DANGER

To reduce the risk of electric shock:

1. Do not reach for a razor that has fallen into water. Unplug immediately.
2. Do not use razor while bathing or in a shower.
3. Do not place or store razor where it can fall or be pulled into a tub or sink. Do not place in or drop into water or other liquid.
4. Always unplug this razor from the electrical outlet immediately after using, except when razor is recharging.
5. Remove power supply cord from razor before cleaning.
6. When **discarding** razor, unplug razor and remove rechargeable battery.

WARNING

To reduce the risk of burns, fire, electric shock, or injury to persons:

1. Close supervision is necessary when this razor is used by, on, or near children or invalids.
2. Use this razor for its intended household use as described in this manual. Do not use attachments not recommended by Philips Electronics North America Corporation.
3. Never operate this razor if it has a damaged cord or plug, if it is not working properly, if it has been dropped or damaged, or dropped into water. Return the razor to an Authorized Norelco Service Location for examination and repair.

4. Keep the razor and cord away from heated surfaces.
5. Never drop or insert any object into any opening.
6. Do not charge or plug in razor outdoors or operate where aerosol (spray) products are being used or where oxygen is being administered.
7. Do not use this razor with a damaged or broken comb, as facial injury may occur.
8. Always attach plug to razor first, then to outlet. Be certain that plug is inserted firmly into razor, up to mark indicated on plug. To disconnect, turn razor off then remove plug from outlet.
9. To prevent possible damage to the cord, do not wrap cord around the razor.
10. Never put razor in direct sunlight or store in a pouch at a temperature above 140°F.

SAVE THESE INSTRUCTIONS

IMPORTANT

YOUR RAZOR CONTAINS A NICKEL-CADMIUM RECHARGEABLE BATTERY. See Battery Removal instruction sheet.

PHILIPS
NORELCO

60 - DAY MONEY-BACK GUARANTEE

To enjoy the closest and most comfortable shave from your new Norelco Men's Razor, the razor should be used exclusively for 3 weeks. This allows your hair and skin enough time to adapt to the Norelco Shaving System. If, after that period of time, you are not fully satisfied with your Norelco Men's Razor, send the product back and we'll refund you the full purchase price.

The razor must be shipped prepaid by insured mail, insurance prepaid, and have the sales slip, indicating purchase price and the date of purchase, enclosed. The razor must be postmarked no later than 60 days after the date of purchase. Norelco reserves the right to verify the purchase price of the razor and limit refunds not to exceed suggested retail price.

Send dated sales slip, your complete name and address as indicated below, and the razor, prepaid to:

Philips Domestic Appliances and Personal Care Company
A Division of Philips Electronics North America Corporation
450 North Medinah Rd, Dock 16
Roselle, IL 60172-2329

Please allow 4-6 weeks for delivery of check. (Please Print)

Name _____

Address _____

City _____

State _____ Zip _____

Daytime Telephone No. (____) _____
Area Code

E-mail Address _____

REASON FOR RETURNING: _____

Table of Contents

Features.....8-9

LED Charge Indicator10

Charging10-11

Put It To The Test & Shaving Tips11

How To Shave With An Electric Razor12

Trimming.....13

Cleaning.....13-16

Assistance.....17

Accessories.....17

Battery Removal.....18

Storage18

Warranty.....19

Spanish20

Features

Reflex Plus Shaving System

Razor Head Assembly

Protective Razor Head Cap

Individually Floating Heads

Razor Head Release Button

- Hair Chamber captures shaven hair

Locking ON/OFF Switch

LED Charge Indicator Light

Built-in Charger

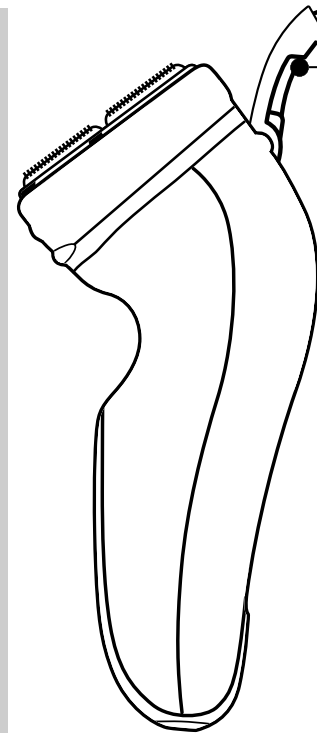
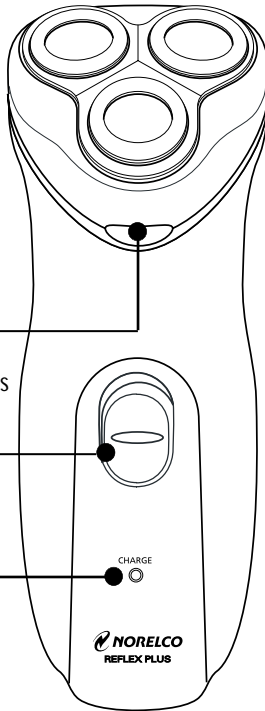

Full Width Pop-Up Trimmer

Automatic Worldwide Voltage 100V to 240V AC

Cleaning Brush

Travel/Storage Pouch

Rechargeable - 16 hour full charge for up to 30 minutes of cordless shave time

Cordless - To shave without a cord

Full 2-Year Warranty

60-Day Money-Back Guarantee

How the unique Norelco  Lift and Cut® Shaving System Makes Close Comfortable:

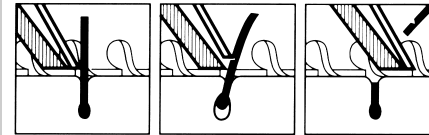

Groove channels beard closer to cutting system

Lifter raises hair

Blade cuts hair which then drops below skin level

Indications

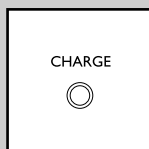

- ▶ **LED Charging Indicator Light**
The red Charging Indicator Light will light up to indicate razor is (re)charging.

Charging

- ▶ Battery performance is best if you recharge only when the batteries are (almost) completely empty.
- ▶ Charging or recharging at temperatures below 40°F and higher than 95°F adversely affects lifetime of batteries.
- ▶ Continuously recharging will reduce life of batteries.
- ▶ Charging and recharging requires a full 16 hours.
- ▶ Do not recharge razor in a pouch.

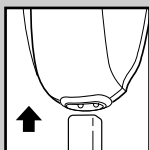

- 1** Connect cord to razor.
Plug into any 120V to 240V AC outlet. Use only the cord provided. The red Indicator Light lights up to indicate razor is (re)charging.

- ▶ An adaptor plug may be necessary for cord charging in some foreign countries. Use an attachment plug adaptor of the proper configuration for power outlet.
Your new razor will automatically convert internally to work on 100V to 240V AC systems.

- 2** Charging and recharging requires a full 16 hours.

Put It To The Test & Shaving Tips

- ▶ **21 Day Trial and Conversion Process.** It is a fact that your skin and beard need time to adjust to any new shaving system.
- ▶ Use your new razor exclusively for 3 weeks to fully enjoy the closeness of a Norelco shave.
- ▶ At first you may not get as close a shave as you expect, or your face may even become slightly irritated. This is normal since your beard and skin will need time to adjust. Invest 3 weeks and you'll soon experience the full joy of your new razor.
- ▶ Stick with it! If you alternate shaving methods during the adjustment period, it may make it more difficult to adapt to the Norelco shaving system.
- ▶ If you are not convinced after 21 days, Norelco will refund you the full purchase price, guaranteed.

How To Shave With An Electric Razor

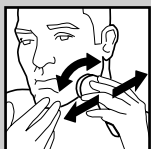

- ▶ Use this razor for its intended household use as described in this manual.
- ▶ Shaving with a clean, dry face gives the best results.

- 1** Turn razor to ON (1) position. Shave against the direction of beard growth using both straight and circular movements.
- 2** Stretch your skin with your free hand so blades can lift and cut whiskers. Gently press razor to skin, so the floating heads can follow the contours of your face. **DO NOT** press too hard. Too much pressure can pinch the skin into the heads.
- 3** Turn razor to OFF (O) position.
- 4** Put the protective razor head cap on the razor to protect razor heads.

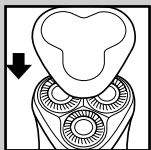

Replace your Norelco Reflex Plus razor heads (model # HQ55 PLUS) once a year for optimal shaving results.

Trimming

To groom sideburns and moustache:

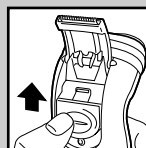

- 1** Turn razor to ON (1) position.

2 Push up trimmer slide switch. The trimmer can be activated while the razor is running.



- 3** Hold trimmer as shown and move in downward strokes with gentle pressure.

4 Close trimmer by sliding trimmer switch down.

- 5** Turn razor to OFF (O) position.

Cleaning

Once a week: Razor

- ▶ Regular cleaning guarantees better shaving results.

Always turn razor off, unplug from outlet and remove cord from razor before cleaning.

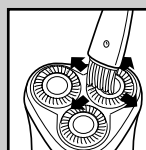

- 1** Clean the top of the razor with the supplied brush.

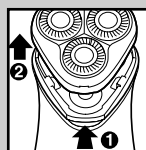

- 2** Press the Razor Head Release Button and remove Razor Head Assembly from the razor unit.

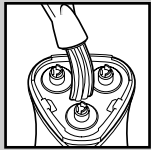

- 3** Brush out hairs from the inside of Razor Head Assembly and hair chamber.

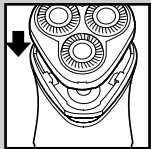

- 4** Replace the Razor Head Assembly back on razor.

Every Two Months: Razor Heads

Do not mix up the cutters and combs as the shaving performance may be adversely affected for several weeks before optimal shaving performance is restored.

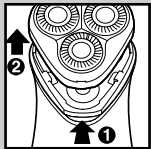

- 1** Turn razor to OFF (O) position and disconnect from outlet.



- 2** Press the Razor Head Release Button and remove Razor Head Assembly from the razor unit.

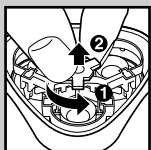

- 3** Brush the inside of the razor housing.

- 4** Turn Razor Head Assembly over so that underside is exposed.

- 5** Turn wheel of frame counterclockwise.

- 6** Remove the frame and brush clean.

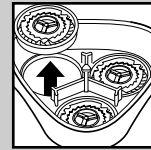

- 7** Remove and clean one cutter and comb at a time.

Do not clean more than one cutter and comb at time, since they are all matching sets. If you accidentally interchange the cutters and combs, it could take several weeks before optimal shaving performance is restored.

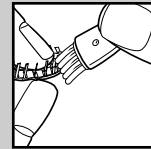

- 8** Separate the cutter from the comb.

- 9** Only brush the cutter in an upward motion. Use the short bristled side of the brush.

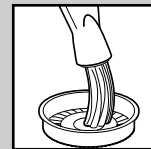

- 10** Brush the slots of the comb.

For optimum performance, razor cutters and combs should be cleaned in a degreasing liquid (e.g. Norelco Razor Head Cleaner, model RC1776 or alcohol) and lubricated with Norelco Razor Lubricant, model AL80, or one drop of mineral oil (in the center of the head). This helps prevent wear of the shaving heads.

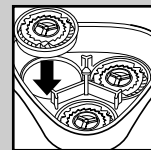

- 11** Replace the cutter and comb into the Razor Head Assembly.

- 12** Repeat the process for the other two sets of cutters and combs.

- 13** Replace the frame.

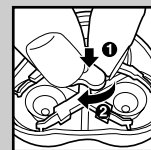

- 14** Turn the wheel clockwise until it locks into place.

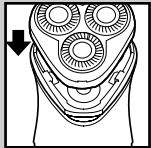

15 Replace the Razor Head Assembly back on razor.

16 Put the protective razor head cap on the razor to protect heads.

After Each Use: Trimmer

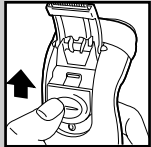

1 Turn razor to OFF (O) position.

2 Push trimmer slide switch up to pop up trimmer.

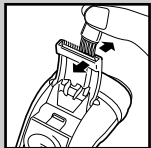

3 Clean trimmer with the brush every time you used it.



4 Lubricate the trimmer teeth with Norelco Razor Lubricant (model AL80) or with one drop of mineral oil every 6 months.

5 Close trimmer by sliding trimmer switch down.

This razor has no other user-serviceable parts. Any other service should be performed by an Authorized Norelco Service Location.

Assistance

► For assistance or the Authorized Norelco Service Location nearest you, call toll free:

1-800-243-3050

or visit our website: www.norelco.com

► Authorized Norelco Service Location information is available 24 hours a day, 7 days a week.

Accessories

- **NOTE:** Model HQ5 Reflex Action Replacement Heads **DO NOT** fit this razor.
- **Replacement Heads**
Model HQ55 PLUS - For maximum razor performance, replace your Norelco Reflex Plus razor heads once a year.
- **Razor Head Cleaner**
RC1776 - Norelco Razor Cleaner
- **Razor Lubricant**
AL80 - Norelco Razor Lubricant
- **Norelco Razor Accessories may be purchased at a store near you, an Authorized Norelco Service Location, or on our website www.norelco.com**

Battery Removal

- ▶ This Norelco Razor contains Nickel-Cadmium battery, which must be disposed of properly.
- ▶ Batteries should only be removed when razor is to be discarded.
- ▶ Refer to Battery Removal instruction sheet for directions on removing the rechargeable batteries.

Storage

- ▶ Be sure razor is turned off. Remove cord from outlet and razor before storing in a safe, dry location where it will not be crushed, banged, or subject to damage.
- ▶ Do not wrap cord around razor when storing.
- ▶ Store cord in a safe location where it will not be cut or damaged.
- ▶ Do not place or store razor where it can fall or be pulled into a tub or sink, water or other liquid while plugged in.
- ▶ Put the Protective Razor Head Cap on razor to protect heads.

FULL TWO YEAR WARRANTY

Philips Electronics North America Corporation warrants each new Norelco Product, Model 6618, 6616X, 6615X, 6614X, 6613X(except cutters and combs) against defects in materials or workmanship for a period of two years from the date of purchase, and agrees to repair or replace any defective product without charge.

IMPORTANT: This warranty does not cover damage resulting from accident, misuse or abuse, lack of reasonable care, the affixing of any attachment not provided with the product or loss of parts or subjecting the product to any but the specified voltage.* Use of unauthorized replacement parts will void this warranty.

PHILIPS ELECTRONICS NORTH AMERICA CORPORATION WILL NOT PAY FOR WARRANTY SERVICE PERFORMED BY A NON-AUTHORIZED REPAIR SERVICE AND WILL NOT REIMBURSE THE CONSUMER FOR DAMAGE RESULTING FROM WARRANTY SERVICE PERFORMED BY A NON-AUTHORIZED REPAIR SERVICE. NO RESPONSIBILITY IS ASSUMED FOR ANY SPECIAL, INCIDENTAL OR CONSEQUENTIAL DAMAGES.

In order to obtain warranty service, simply take or ship the product postage prepaid to the nearest Authorized Norelco Service Center Location. It is suggested that for your protection you return shipments of product by insured mail, insurance prepaid. Damage occurring during shipment is not covered by this warranty.

NOTE: No other warranty, written or oral, is authorized by Philips Electronics North America Corporation.

This warranty gives you specific legal rights, and you may also have other rights which vary from state to state. Some states do not allow the exclusion or limitation of incidental or consequential damages, so the above exclusion and limitations may not apply to you.

* Read enclosed instructions carefully.

Manufactured for:

Philips Domestic Appliances and Personal Care Company
A Division of Philips Electronics North America Corporation
1010 Washington Blvd., Stamford, CT 06912-0015



This symbol on the product's nameplate means it is listed by Underwriters' Laboratories, Inc.

Norelco, Tripleheader, Lift and Cut, and  are Registered Trademarks of Philips Electronics North America Corporation.



and Reflex Plus are Trademark of Philips Electronics North America Corporation.

PHILIPS is a Registered Trademark of Koninklijke Philips Electronics N.V.

© 2005 Philips Electronics North America Corporation. All Rights Reserved.
Rev. 2-6/05

PHILIPS
NORELCO