



Philips 8500 series
4K UHD LED Android TV
with Ambilight 3 sided

146 cm (58") Ambilight TV
Major HDR formats supported
P5 Perfect Picture Engine
Android TV/AI voice control



58PUS8555

Performance Series: the one to watch

4K UHD LED Android TV

This is the one you're looking for. Superb picture quality. Elegant design with immersive Ambilight. Great sound. AI voice control and the QWERTY keyboard on the back of the remote makes entering your app passwords nice and easy.

Slim TV. Beautiful light.

- Philips 4K UHD TV. Vibrant HDR picture.
- The magic of Ambilight. Only from Philips.
- Remote control with QWERTY keyboard. Makes text input easy.

Smooth motion. Real colour. Incredible depth.

- Philips P5 Engine. Whatever the source, always perfection.
- HDR10+ supported. See more of what the director intended.
- Dolby Vision and Dolby Atmos. Cinematic vision and sound.
- Well-balanced audio. Crisp, clear dialogue. Punchy effects.

Android TV-content at your command

- Voice control. Google Assistant built-in. Works with Alexa.
- Android TV. Simply smart.
- DTS Play-Fi. Multi-room audio.

PHILIPS

4K UHD LED Android TV

146 cm (58") Ambilight TV Major HDR formats supported, P5 Perfect Picture Engine, Android TV/AI voice control

Highlights

Ambilight 3 sided



With Philips Ambilight, every moment feels closer. Intelligent LEDs around the edge of the TV respond to the on-screen action and emit an immersive glow that's simply captivating. Experience it once and wonder how you enjoyed TV without it.

Dolby Vision and Dolby Atmos

Support for Dolby's premium sound and video formats means the HDR content you watch will look—and sound—gloriously real. Whether it's the latest streaming series or a Blu-Ray disc set, you'll enjoy contrast, brightness and colour that reflect the director's original intentions. And hear spacious sound with clarity, detail and depth.

Android TV.



Make your Philips Android TV your own. If it's all about Amazon and YouTube this week and Rakuten TV and Netflix next week - no problem. A clear, intuitive interface lets you put the content you love front and centre. Easily pick up where you left off in the latest series, or check out the new movie releases.

P5 Perfect Picture Engine

The Philips P5 engine delivers a picture as brilliant as the content you love. Details have noticeably more depth. Colours are vivid, while skin tones look natural. Contrast is so crisp you'll feel every detail. Motion is perfectly smooth.

4K UHD HDR



Your Philips 4K UHD TV is compatible with all major HDR formats, including HDR10+ and

58PUS8555/12

Dolby Vision. Whether it's a must-watch series or the latest video game, shadows will be deeper. Bright surfaces will shine. Colours will be truer.

Voice assistant

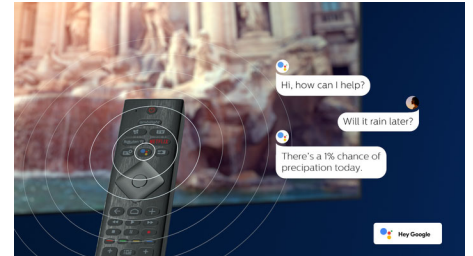

Control your Philips Android TV with your voice. Want to play a game, watch Netflix or find content and apps in the Google Play store? Just tell your TV. You can even command all Google Assistant-compatible smart home devices, like dimming the lights and setting the thermostat on movie night. Without leaving the sofa. The days of searching for the TV remote are over. Now you can use your voice to control your Philips smart TV via Alexa-enabled devices, like Amazon Echo. Turn your TV on, change the channel, switch to your gaming console and more with Alexa.

HDR10+ supported

Your Philips TV is primed to get the most out of the HDR10+ video format. Contrast, colour and brightness levels are adjusted from frame to frame. Whether it's a must-watch series or the new blockbuster, shadows will be deeper. Bright surfaces will shine. Colours will be truer.



4K UHD LED Android TV

146 cm (58") Ambilight TV Major HDR formats supported, P5 Perfect Picture Engine, Android TV/AI voice control

Specifications

Ambilight

- Ambilight Version: 3 sided
- Ambilight Features: Built-in Ambilight+hue, Ambilight Music, Game Mode, Wall colour adaptive, Lounge mode, AmbiWakeUp

Picture/Display

- Display: 4K Ultra HD LED
- Diagonal screen size: 58 inch / 146 cm
- Panel resolution: 3840 x 2160
- Aspect ratio: 16:9
- Pixel engine: P5 Perfect Picture Engine
- Picture enhancement: Ultra Resolution, HDR10+, Dolby Vision, 2100 PPI

Supported Display Resolution

- Computer inputs on all HDMI: HDR supported, HDR10/HLG, up to 4K UHD 3840 x 2160 @60 Hz
- Video inputs on all HDMI: up to 4K UHD 3840 x 2160 @60 Hz, HDR supported, HDR10/HLG (Hybrid Log Gamma), HDR10+/Dolby Vision

Android TV

- OS: Android TV™ 9 (Pie)
- Pre-installed apps: Google Play Movies*, Google Play Music*, Google Search, YouTube, Netflix, Amazon instant video, BBC iPlayer
- Memory size (Flash): 16 GB*

Smart TV Features

- User Interaction: SimplyShare
- Interactive TV: HbbTV
- Programme: Pause TV, USB recording*
- Ease of Installation: Auto detect Philips devices, Device connection wizard, Network installation wizard, Settings assistant wizard
- Ease of Use: One-stop smart menu button, On-screen user manual
- Firmware upgradeable: Firmware auto upgrade wizard, Firmware upgradeable via USB, Online firmware upgrade
- Screen Format Adjustments: Basic - Fill Screen, Fit to screen, Advance - Shift, Zoom, stretch, Wide screen
- Remote Control: with Voice, with Keyboard
- Voice assistant*: Google Assistant built in, RC with Mic., Works with Alexa

Processing

- Processing Power: Quad Core

Tuner/Reception/Transmission

- HEVC support
- Digital TV: DVB-T/T2/T2-HD/C/S/S2

- MPEG Support: MPEG2, MPEG4
- Video Playback: PAL, SECAM
- TV Programme guide*: 8-day Electronic Programme Guide
- Signal strength indication
- Teletext: 1000 page Hypertext

Connectivity

- Number of HDMI connections: 4
- Number of USBs: 2
- Wireless connections: Bluetooth 4.2, Wi-Fi 802.11ac, 2 x 2, Dual band
- Other connections: Satellite Connector, Common Interface Plus (CI+), Digital audio out (optical), Ethernet-LAN RJ-45, Headphone out, Service connector
- HDMI features: 4K, Audio Return Channel
- EasyLink (HDMI-CEC): Remote control pass-through, System audio control, System standby, One touch play
- HDCP 2.3: Yes on all HDMI

Multimedia Applications

- Video Playback Formats: Containers: AVI, MKV, H264/ MPEG-4 AVC, MPEG-1, MPEG-2, MPEG-4, WMV9/ VC1, VP9, HEVC (H.265)
- Subtitles Formats Support: .SRT, .SUB, .TXT, .SMI
- Music Playback Formats: AAC, MP3, WAV, WMA (v2 up to v9.2), WMA-PRO (v9 and v10)
- Picture Playback Formats: JPEG, BMP, GIF, PNG, 360 photo, HEIF

Power

- Mains power: AC 220 - 240 V 50/60 Hz
- Standby power consumption: <0.3 W
- Ambient temperature: 5°C to 35°C
- Power Saving Features: Auto switch-off timer, Picture mute (for radio), Light sensor, Eco mode
- Mercury content: 0 mg
- Presence of lead: Yes*
- Off mode power consumption: N/A

EU Energy card

- EPREL registration numbers: 357060
- Diagonal screen size (inch): 58
- Diagonal screen size (metric): 146
- Energy class for SDR: G
- On mode power demand for SDR: 88 W
- Energy class for HDR: G
- On mode power demand for HDR: 172 W
- Networked standby mode: <2.0 W
- Off mode power consumption: n.a.
- Panel technology used: LED LCD

58PUS8555/12

Sound

- Output power (RMS): 20 W
- Sound Enhancement: Auto Volume Leveller, Dolby Atmos®, 5 Band Equalizer, A.I. Sound, Bass Enhancement, Clear Dialogue, Night mode
- Speaker configuration: 2 x 10 W full-range speaker

Dimensions

- Box dimensions (W x H x D): 1445 x 880.0 x 160.0 mm
- Set dimensions (W x H x D): 1298.7 x 765.1 x 81.9 mm
- Set dimensions with stand (W x H x D): 1298.7 x 830.1 x 253.6 mm
- Stand dimensions (W x H x D): 750.0 x 65.0 x 253.6 mm
- Product weight: 18.0 kg
- Product weight (+stand): 21.0 kg
- Weight incl. Packaging: 26.0 kg
- VESA wall mount compatible: 300 x 200 mm

Design

- Colours of TV: Light-silver metal bezel
- Stand design: Silver chrome arch stand, Swivel +/- 15 degree

Accessories

- Included accessories: Remote Control, Quick start guide, Legal and safety brochure, Power cord, Tabletop stand
- Included batteries: 2 x AAA Batteries



Connections

Side

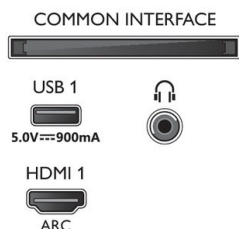

Bottom

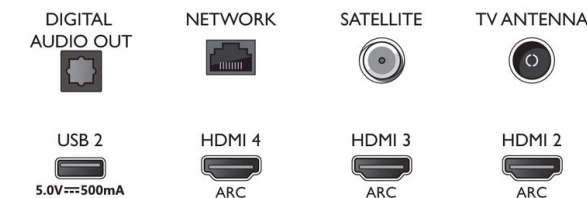

Issue date 2021-07-14

Version: 7.1.1

12 NC: 8670 001 65573
EAN: 87 18863 02308 2

© 2021 Koninklijke Philips N.V.
All Rights reserved.

Specifications are subject to change without notice.
Trademarks are the property of Koninklijke Philips N.V.
or their respective owners.

www.philips.com

* EPG and actual visibility (up to 8 days) is country- and operator-dependent.

* Android App offerings vary per country. For more details please visit your local Google Play Store.

* Energy consumption in kWh per year based on the power consumption of the television operating 4 hours per day for 365 days. The actual energy consumption will depend on how the television is used.

* The TV supports DVB reception for 'Free to air' broadcast. Specific DVB operators may not be supported. An up to date list can be found in the FAQ section of the Philips support website. For some operators Conditional Access and subscription are required. Contact your operator for more information.

* Philips TV Remote app and related functionalities vary per TV model, operator and country, as well as smart device model and OS. For more details please visit: www.philips.com/TVRemoteapp.

* Smart TV app availability varies per TV model and country. For more details please visit: www.philips.com/smarttv.

* USB recording for digital channels only, recordings may be limited by broadcast copy protection (CI+). Country and channel restrictions may apply.

* Please note that your Amazon Apps may not always be available in your country. (Currently Amazon apps works only in the UK, Germany and Austria)

* This television contains lead only in certain parts or components where no technology alternatives exist in accordance with existing exemption clauses under the RoHS Directive.

* *Memory size (Flash): 16 GB (the actual available disk space may differ depending on e.g. (pre-)installed apps, installed operating system etc.)