

PHILIPS

Professional TV

48" Studio

DVB-T2/T/C HEVC

48HFL2869T



Delight your guests

with pure taste

Show your guests how much you care with this affordable Hospitality TV. You will enjoy dedicated hospitality features like a branded welcome page, installation via USB and menu and control locking.

Great viewing experience and guest comfort

- LED TV for images with incredible contrast
- Low power consumption
- USB for multimedia playback

Advanced hotel features and future proof

- Greet your guests with a customizable welcome page
- USB cloning of all settings for quick installation
- Off-line channel editor to edit a channel list on a PC
- One combined channel list for Analog and Digital channels
- Installation menu locking
- Prevent unauthorized use by joystick control locking
- Advanced volume control to avoid guest disturbance

Highlights

Welcome page



A welcome page is displayed each time the TV set is switched on. The welcome page can be branded and customized easily at the time of installation via a simple welcome image in .png format.

USB Cloning

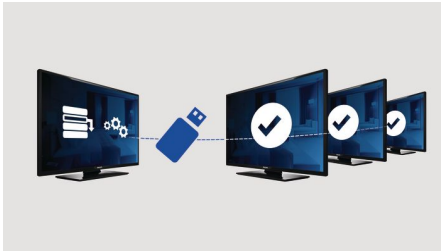

Provides the ability to easily copy all programming and channel programming settings from one TV into other TV sets in less

than a minute. The feature ensures uniformity between TV sets and significantly reduces installation time and costs.

USB (photos, music, video)



Share the fun. Connect your USB memory-stick, digital camera, mp3 player or other multimedia device to the USB port on your TV to enjoy photos, videos and music with the easy to use onscreen content browser.

One combined channel list

One integrated channel list for digital and analogue channels. This allows the guest to zapp seamless between Analogue and Digital channels.

Advanced volume control

With advanced volume control you can install the start-up volume of the TV and predifine the volume range with which the TV set is allowed to operate, preventing excessive volume adjustments and avoiding disturbance of next door guests.

Joystick control locking

By disabling or enabling the joystick control locking, the administrator can prevent unauthorized use of the TV via the joystick, saving the hotelier overheads.

Installation menu locking

Prevents unauthorized access to installation and configuration settings, to ensure maximum guest convenience and avoid unnecessary reinstalling costs.

Low power consumption

Philips TVs are desgined to minimize power consumption. This will not only reduce environmental impact but also lower operating costs.

Specifications

Picture/Display

Display: LED Full HD
 Diagonal screen size: 48 inch / 121 cm
 Aspect ratio: 16:9
 Panel resolution: 1920x1080p
 Brightness: 300 cd/m²
 Viewing angle: 178° (H) / 178° (V)
 Contrast ratio (typical): 4000

Audio

Sound output Power: 16 (2x8) W
 Speakers: 2.0, Down Firing
 Sound Features: Equalizer, Balance, AVL, Incredible surround, Dynamic Bass

Design

Colour: Black

Tuner/Reception/Transmission

Digital TV: DVB-T/T2/C, HEVC FHD (up to 1080p60)
 Analog TV: PAL, SECAM

Connectivity Rear

Antenna: IEC-75
 HDMI1: HDMI 1.4, ARC
 HDMI2: HDMI 1.4
 Digital Audio out: Optical
 Scart: CVBS, RGB, SVHS
 VGA input: 15 pin D-sub

Connectivity Side

Common Interface Slot: CI+ 1.3
 AV input: CVBS+L/R (Cinch)
 Headphone out: Mini-Jack
 USB1: USB 2.0

Connectivity Enhancements

EasyLink (HDMI CEC): One touch play, System Standby, RC pass through

Features

Digital services: Subtitles, Teletext, MHEG, 8d EPG, Now&Next
 Ease of use: Picture Style, Sound Style
 Local control: Joystick

Hospitality Features

Hotel mode: Joystick Control Lock, Menu lock, Installation Menu Lock, Volume limitation (incl. HP)

Prison mode: high security mode, TXT/MHEG/USB/EPG/Subtitle Lock
 Your brand: Welcome Logo
 Cloning and Firmware update: via USB, Instant Initial Cloning

Switch On control: Channel/Source, Picture Style, Volume (incl. HP)

Timer: Sleep Timer, Wake Up Alarm

Channels: Combined List, Off-Line Channel Editor

Control: Block Automatic Channel Update

Power control: Green/fast startup

Remote Control: Cable Strap Ready, RC Battery Door Lock

Anti-Theft: Kensington Lock

Healthcare features

Control: Multi-Remote Control

Convenience: Headphone out

Multimedia

Multimedia connections: USB

Video playback supported: Containers: AVI, MKV, Formats: H.264/MPEG4 AVC, MPEG1, MPEG2, MPEG4, HEVC, TS

Subtitle formats supported: SRT, SSA SUB, ASS, SMI, TXT

Music formats supported: MP3, AAC, WAV, WMA (v2 up to v9.2)

Picture formats supported: BMP, JPG, PNG

Supp. Video Resolution on USB: up to 1920x1080p@30Hz

Accessories

Included: Remote Control 22AV1407A/12, 2xAAA Batteries, Tabletop Stand, Warranty Leaflet, Legal and Safety brochure

Optional: Setup RC 22AV9573A, Remote Control 22AV1601A/12

Power

Mains power: AC 220-240V; 50-60Hz

Energy Label Class: A++

Eu Energy Label power: 46 W

Annual energy consumption: 67 kW·h

Standby power consumption: <0.3 W

Power Saving Features: Eco mode

Ambient temperature: 5 °C to 45 °C

Dimensions

Set dimensions (W x H x D):

1093 x 642 x 81/97 mm

Set dimensions with stand (W x H x D):

1093 x 681 x 220 mm

Product weight: 10.1 kg

Product weight (+stand): 11.0 kg

VESA wall mount compatible: M6, 200 x 200 mm

